

# Ge Quietpower 3 Dishwasher Manual

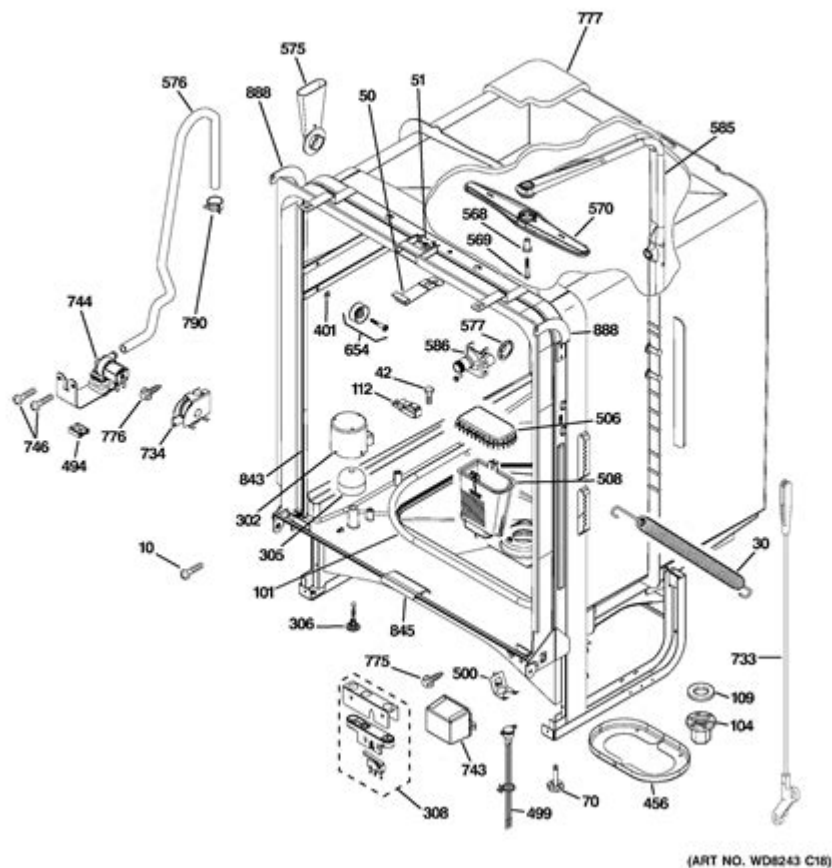

## GE QuietPower 3 Dishwasher Manual

The GE QuietPower 3 dishwasher is a popular choice for many households due to its efficiency, quiet operation, and advanced features. To maximize its performance and longevity, understanding the comprehensive manual is essential. This article dives into the essential aspects of the GE QuietPower 3 dishwasher manual, including installation, operation, maintenance, troubleshooting, and tips to enhance your dishwasher experience.

## Overview of the GE QuietPower 3 Dishwasher

The GE QuietPower 3 dishwasher is engineered to deliver a powerful cleaning performance while maintaining a low noise level, making it ideal for family kitchens. It comes equipped with several features that enhance usability, such as adjustable racks, multiple wash cycles, and energy efficiency.

## Key Features

- Quiet Operation: Designed to operate at low decibel levels, ensuring minimal disruption during use.
- Multiple Wash Cycles: Offers a variety of wash cycles including Heavy, Normal, and Light, catering to different cleaning needs.
- Adjustable Racks: Features customizable rack positions to accommodate dishes of different sizes.
- Energy Efficient: Meets ENERGY STAR standards, promoting energy conservation while providing excellent cleaning results.
- SaniWash Option: Provides an extra layer of sanitation by heating water to high temperatures.

## Installation Instructions

Proper installation is crucial for the optimal functioning of your GE QuietPower 3 dishwasher. Below are the steps for a successful installation:

### Tools Required

- Adjustable wrench
- Screwdriver
- Level
- Tape measure
- Bucket or towel (for water spill)

### Installation Steps

1. Preparation:
  - Ensure the installation area is clear and has access to an electrical outlet, water supply, and drain.
2. Connect the Water Supply:
  - Shut off the water supply.
  - Connect the water inlet hose to the dishwasher and the water supply valve.
3. Electrical Connection:
  - Plug the dishwasher into the electrical outlet. Ensure the voltage matches the specifications in the manual.
4. Drain Hose Installation:
  - Attach the drain hose to the sink or garbage disposal, ensuring no kinks or bends that could restrict water flow.
5. Leveling the Dishwasher:
  - Use a level to check the alignment and adjust the legs if necessary to ensure proper drainage.
6. Final Checks:

- Turn on the water supply and check for leaks.
- Run a short cycle to ensure all connections are secure and the dishwasher operates correctly.

## Operating Your Dishwasher

Understanding how to operate your GE QuietPower 3 dishwasher effectively will enhance your cleaning experience.

### Control Panel Overview

- Power Button: Turns the dishwasher on and off.
- Cycle Selection Buttons: Choose from various cleaning cycles (e.g., Heavy, Normal, Light).
- Delay Start: Allows you to set a timer for the dishwasher to start later.
- SaniWash Button: Activates the sanitizing wash option.

### Loading the Dishwasher

Proper loading is crucial to ensure efficient cleaning. Here are some tips:

- Top Rack: Ideal for smaller items such as cups, glasses, and small bowls.
- Bottom Rack: Designed for larger items like pots, pans, and dinner plates.
- Silverware Basket: Place forks, knives, and spoons with handles down for better cleaning and to prevent injury.

### Selecting a Wash Cycle

- Heavy Cycle: Use for heavily soiled pots and pans.
- Normal Cycle: Suitable for everyday dishes with moderate soil.
- Light Cycle: Best for lightly soiled items such as glasses and lightly used plates.
- SaniWash: Use for items that require extra sanitation, such as baby bottles.

## Maintenance Tips

Regular maintenance can prolong the life of your GE QuietPower 3 dishwasher. Here are some essential maintenance tips:

### Cleansing the Filter

- Frequency: Clean the filter every month.

- Method:

1. Remove the filter from the bottom of the dishwasher.
2. Rinse under warm water to remove food particles.
3. Reinstall the filter securely.

## **Inspecting the Spray Arms**

- Check for Blockages: Ensure that the spray arms can rotate freely and are not blocked by food debris.
- Cleaning: Remove and clean the spray arms if necessary. Soak in warm soapy water and rinse thoroughly.

## **Checking the Door Seal**

- Inspection: Regularly check the rubber door seal for wear or damage.
- Cleaning: Wipe the seal with a damp cloth to remove any residue that could cause leaks.

## **Troubleshooting Common Issues**

Even the best appliances may encounter issues. Here are some common problems with the GE QuietPower 3 dishwasher and their solutions:

### **Dishwasher Won't Start**

- Check the Power Supply: Ensure the dishwasher is plugged in and the outlet is functioning.
- Door Latch: Make sure the door is securely closed; the dishwasher won't start if it's ajar.

### **Poor Cleaning Performance**

- Check Load: Ensure dishes are loaded correctly and not blocking the spray arms.
- Detergent: Verify that you are using the appropriate dishwasher detergent and that the dispenser is functioning.

### **Strange Noises During Operation**

- Inspect for Foreign Objects: Check for any items that may be obstructing the spray arms.
- Loose Parts: Tighten any loose components that could be vibrating during operation.

# Energy Efficiency and Water Savings

The GE QuietPower 3 dishwasher is designed with energy efficiency in mind. Here are some features that contribute to its eco-friendliness:

- Water-Saving Wash Cycles: Uses less water than traditional washing methods while still delivering excellent cleaning results.
- ENERGY STAR Rated: Meets strict energy efficiency guidelines set by the U.S. Environmental Protection Agency.

## Conclusion

The GE QuietPower 3 dishwasher is a reliable and efficient appliance that can make your dishwashing experience more manageable. By following the guidelines set out in the manual, you can ensure proper installation, operation, and maintenance, leading to optimal performance over the years. With the right care and attention, your GE QuietPower 3 dishwasher will continue to serve your household effectively, providing clean dishes with minimal noise and energy consumption.

## Frequently Asked Questions

### Where can I find the GE QuietPower 3 dishwasher manual?

You can find the GE QuietPower 3 dishwasher manual on the official GE Appliances website under the 'Customer Support' section, or by searching for the model number followed by 'manual' in a search engine.

### What should I do if my GE QuietPower 3 dishwasher is not starting?

If your GE QuietPower 3 dishwasher is not starting, check if it is properly plugged in, ensure the door is securely closed, and verify that the circuit breaker has not tripped. Refer to the troubleshooting section of the manual for more detailed steps.

### How do I properly load my GE QuietPower 3 dishwasher?

To properly load your GE QuietPower 3 dishwasher, place larger items on the bottom rack and smaller items on the top rack. Avoid blocking the spray arms and ensure that items are secured and not touching each other to allow for proper water circulation.

### What are the key features of the GE QuietPower 3 dishwasher?

The key features of the GE QuietPower 3 dishwasher include a quiet operation, multiple wash cycles, adjustable racks, and a delay start option. These features help enhance cleaning efficiency while minimizing noise.

## How do I troubleshoot error codes on my GE QuietPower 3 dishwasher?

To troubleshoot error codes on your GE QuietPower 3 dishwasher, refer to the manual's error code section. Each code corresponds to a specific issue, and the manual will provide guidance on how to resolve it.

Find other PDF article:

<https://soc.up.edu.ph/05-pen/Book?dataid=dYA27-7790&title=american-revolution-study-guide-answer-key.pdf>

# Ge Quietpower 3 Dishwasher Manual

## Download and install Google Chrome

How to install Chrome Important: Before you download, you can check if Chrome supports your operating system and other system requirements.

□□□□□□□□□? - □□

16  
 # ...

*GE Online* □□□□ *R* □□□ - □□□□

GE Online R

**Under review** - Awaiting Recommendation

under review [REDACTED] under review [REDACTED] awaiting  
recommendaion[REDACTED] ...

**edge**□□□□□□□□ - □□

```

edge[0] edge[1] win10
...

```

## Download and install Google Chrome

How to install Chrome Important: Before you download, you can check if Chrome supports your operating system and other system requirements.

□□□□□□□□□□? - □□

0000000000000000 000000000000 00000000000000000000160000000000000000000000000000000  
...

GE Online  $\square\square\square\square R \square\square\square - \square\square\square\square$

GE Online R

Under review Awaiting Recommendation ...

under review [REDACTED] under review [REDACTED] awaiting

recommendaion

edge -

edge win10

M -

Dec 27, 2023 · M

GeForceMX150 -

Jun 10, 2017 · MX1502GBGDDR51469mhzboost1532mhz6008mhzGP1083SM384SP

? -

[1] “XXX” “XXX” “XXX” [2] “”

Gemini Apps Help - Google Help

Official Gemini Apps Help Center where you can find tips and tutorials on using Gemini Apps and other answers to frequently asked questions.

win11? -

win11

Find the GE QuietPower 3 dishwasher manual for easy troubleshooting and maintenance tips. Discover how to maximize your dishwasher's performance today!

[Back to Home](#)