

Galanz Mini Fridge Parts Diagram

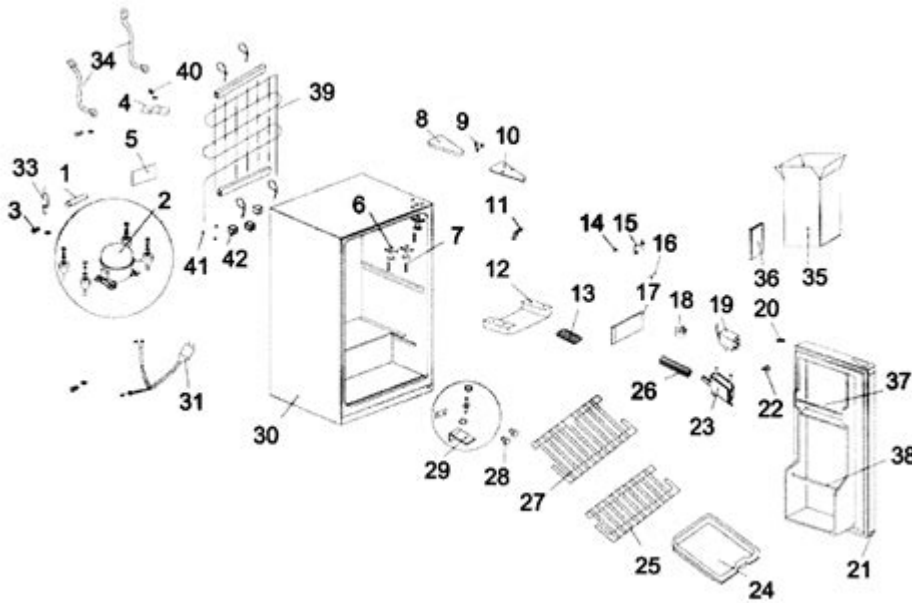

Galanz mini fridge parts diagram is an essential tool for understanding the inner workings of your refrigerator, especially if you're planning to troubleshoot issues, replace parts, or simply learn more about how your appliance operates. Galanz mini fridges, known for their compact size and efficiency, have gained popularity in homes, offices, and dorms. This article will delve into the various components of a Galanz mini fridge, provide a detailed parts diagram, and offer insights into maintenance and repair.

Understanding the Components of a Galanz Mini Fridge

Before diving into the parts diagram, it's crucial to understand the primary components of a Galanz mini fridge. Each part plays a vital role in the overall operation of the appliance, contributing to its cooling efficiency, energy consumption, and durability.

Key Components of a Mini Fridge

1. **Compressor:** The heart of the refrigeration system, the compressor compresses refrigerant gas and circulates it through the system.
2. **Condenser Coils:** Located at the back or bottom of the fridge, these coils dissipate heat from the refrigerant, allowing it to cool down.
3. **Evaporator Coils:** These coils are inside the fridge, where the refrigerant absorbs heat from the interior, causing the temperature to drop.
4. **Thermostat:** This component regulates the temperature inside the fridge by turning the compressor on and off based on the preset temperature.
5. **Fan:** The fan helps circulate cool air throughout the fridge and often aids in the cooling of the condenser coils.

6. Shelves: Adjustable shelves provide storage flexibility for various food and drink items.
7. Door Seal: This rubber gasket ensures that the fridge remains airtight, preventing cold air from escaping.
8. Drip Pan: The drip pan collects excess water from the defrost cycle, helping to maintain a clean and dry environment.
9. Light Bulb: Provides illumination when the fridge door is opened, allowing you to see inside easily.

Galanz Mini Fridge Parts Diagram

Understanding the parts diagram is crucial for identifying specific components when performing repairs or maintenance. Here's a breakdown of the Galanz mini fridge parts diagram, which typically includes:

- Front View: Showing the exterior features including door, shelves, and light bulb.
- Side View: Illustrating the compressor, condenser coils, and evaporator coils.
- Back View: Highlighting the electrical components and the fan.

Below is a simplified description of the parts typically found in the diagram:

Front View Components

- Door: The main access point for retrieving and storing food.
- Shelves: Often adjustable to accommodate different sizes of items.
- Control Panel: The interface for temperature settings and other functions.
- Light Bulb: Located at the top interior, it activates when the door opens.

Side View Components

- Compressor: Usually located at the bottom, it can be identified by its cylindrical shape.
- Evaporator Coils: Found inside the fridge, these coils are often covered by a panel for safety.
- Fan: Positioned near the evaporator coils to ensure proper air circulation.

Back View Components

- Condenser Coils: These coils are often found at the back or bottom and can appear as a series of metal fins.
- Electrical Components: Including wiring and the power supply unit, which are essential for the functioning of the fridge.
- Drip Pan: Located at the bottom, it collects condensation and prevents water buildup.

Common Issues and Their Solutions

Understanding the parts diagram not only helps in identifying components but also in diagnosing common issues that may arise with a Galanz mini fridge. Here are some typical problems and their solutions:

1. Not Cooling Properly

Possible Causes:

- Dirty condenser coils
- Faulty thermostat
- Low refrigerant levels

Solution:

- Clean the condenser coils to improve heat dissipation.
- Check and replace the thermostat if defective.
- Consult a professional to check refrigerant levels and refill if necessary.

2. Excessive Noise

Possible Causes:

- Loose parts or components
- Faulty fan

Solution:

- Inspect and tighten any loose screws or components.
- Replace the fan if it is malfunctioning or making abnormal noises.

3. Water Leakage

Possible Causes:

- Clogged defrost drain
- Improper door seal

Solution:

- Clear any debris from the defrost drain to ensure proper drainage.
- Inspect and replace the door seal if it does not close tightly.

Maintenance Tips for Your Galanz Mini Fridge

Regular maintenance can prolong the life of your Galanz mini fridge and enhance its efficiency. Here are some tips:

- **Clean the Condenser Coils:** At least once a year, remove dust and debris from the coils to improve cooling efficiency.
- **Check the Door Seal:** Inspect the door seal for any cracks or tears to ensure an airtight fit.
- **Defrost Regularly:** If the appliance is not frost-free, defrost it regularly to prevent excessive ice buildup.
- **Keep it Level:** Ensure that the fridge is level to prevent improper door closure and cooling issues.
- **Monitor Temperature:** Regularly check the temperature settings to maintain optimal cooling.

Finding Replacement Parts

When it comes time to replace parts in your Galanz mini fridge, it's essential to source high-quality components. Here's how to find replacement parts:

1. **Manufacturer's Website:** The best source for authentic parts is the Galanz official website. They often have a dedicated section for replacement parts.
2. **Authorized Retailers:** Check with local appliance stores or online retailers that specialize in refrigerator parts.
3. **Online Marketplaces:** Websites like Amazon or eBay often carry a wide range of parts, but ensure they are compatible with your specific model.
4. **Repair Shops:** Local appliance repair shops may have parts or can order them for you.

Conclusion

Understanding the **Galanz mini fridge parts diagram** is invaluable for anyone who owns this appliance. Familiarity with its components can empower you to troubleshoot issues, perform maintenance, and even replace parts when necessary. By taking the time to learn about your fridge's inner workings, you can ensure its longevity and optimal performance. Always remember that regular maintenance and using high-quality replacement parts can significantly enhance your fridge's efficiency and lifespan.

Frequently Asked Questions

What are the main components of a Galanz mini fridge?

The main components include the compressor, evaporator, condenser, thermostat, shelves, door seals, and the interior light.

Where can I find a parts diagram for my Galanz mini fridge?

You can find a parts diagram on the official Galanz website, in the user manual, or through appliance repair websites.

How do I interpret the parts diagram of a Galanz mini fridge?

The parts diagram typically labels each component, showing its location and how it connects to other parts; look for a legend or key for specific part names.

Are there common replacement parts for Galanz mini fridges?

Yes, common replacement parts include door seals, shelves, thermostats, and compressor units.

Can I use a parts diagram to troubleshoot my Galanz mini fridge?

Yes, a parts diagram can help identify components related to specific issues, allowing for easier troubleshooting.

What should I do if I can't find the parts diagram for my specific model?

Contact Galanz customer service or check online forums for assistance, as users may have shared diagrams for similar models.

Is there a difference in parts diagrams between different models of Galanz mini fridges?

Yes, parts diagrams can vary between models, so it's important to use the diagram that corresponds to your specific model.

Can I download a Galanz mini fridge parts diagram in PDF format?

Yes, many websites offer downloadable PDF versions of parts diagrams, including the Galanz official site or appliance repair resources.

Find other PDF article:

<https://soc.up.edu.ph/49-flash/Book?docid=MPf46-9506&title=quest-diagnostics-semen-analysis.pdf>

[Galanz Mini Fridge Parts Diagram](#)

Movies & TV - YouTube

Find the latest and greatest movies and shows all available on YouTube.com/movies. From award-winning hits to independent releases, watch on any device and from the comfort of your ...

YouTube Help - Google Help

Official YouTube Help Center where you can find tips and tutorials on using YouTube and other answers to frequently asked questions.

YouTube

As Israeli cities wake up to ballistic missiles from the Houthis, Yair and Mati dig deep into the threat rising from the Red Sea. WATCH: https://youtube.com/live/NULa4F_oZQ0

The Music Channel - YouTube

Videos you watch may be added to the TV's watch history and influence TV recommendations. To avoid this, cancel and sign in to YouTube on your computer.

YouTube

Share your videos with friends, family, and the world

YouTube - Apps on Google Play

Enjoy your favorite videos and channels with the official YouTube app.

YouTube - Wikipedia

YouTube is an American social media and online video sharing platform owned by Google. YouTube was founded on February 14, 2005, [7] by Chad Hurley, Jawed Karim, and Steve ...

Explore our detailed Galanz mini fridge parts diagram to simplify your repairs and maintenance. Learn more about each component and enhance your fridge's performance!

[Back to Home](#)