

# Ge Oven 229c6112p001 1 Manual

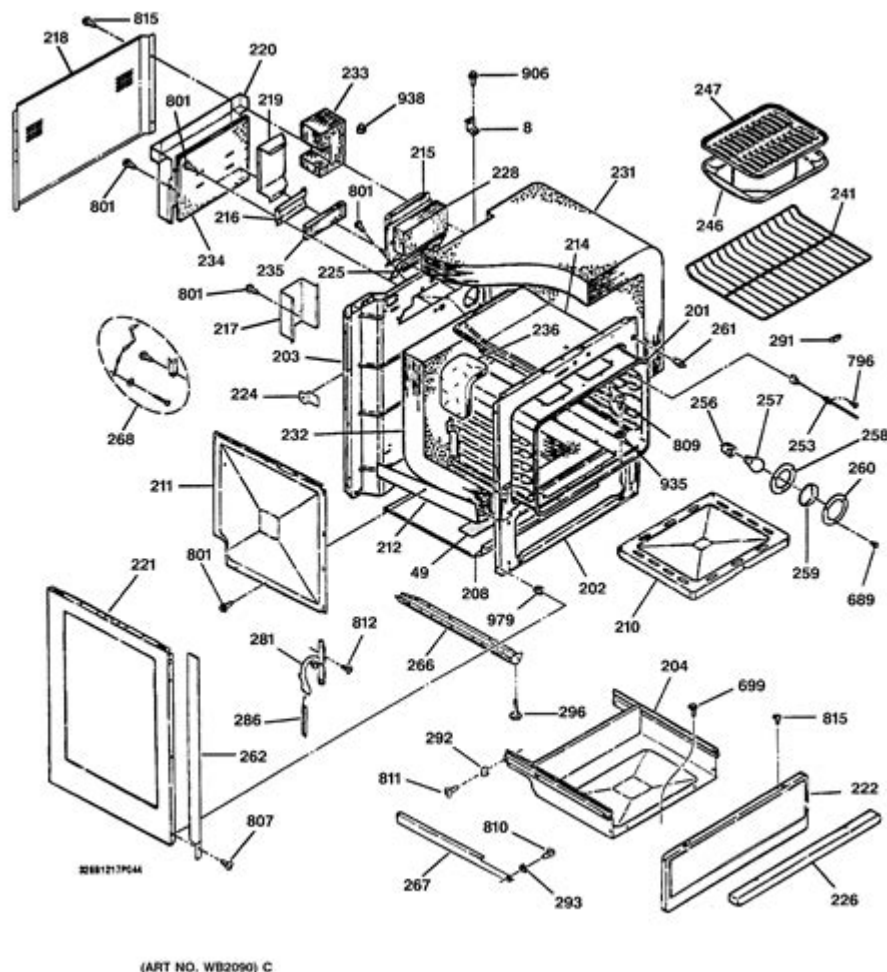

# Introduction to the GE Oven 229C6112P001 Manual

**GE Oven 229C6112P001 manual** is an essential resource for anyone who owns this specific model of oven. Whether you are a seasoned chef or a home cook, understanding your oven's features, functions, and troubleshooting steps can significantly enhance your cooking experience. This article aims to provide a comprehensive overview of the manual, covering its content, key features of the oven, and troubleshooting tips to ensure you get the most out of your appliance.

## Overview of the GE Oven 229C6112P001

The GE Oven 229C6112P001 is a versatile kitchen appliance designed to meet the cooking needs of modern households. It combines functionality with user-friendly features, making it a popular choice among consumers. Here are some key aspects of this oven:

- **Type:** The GE Oven 229C6112P001 is typically a wall oven, which saves space and allows for easier access while cooking.
- **Cooking Options:** This model offers multiple cooking modes including bake, broil, and sometimes convection options, providing versatility in meal preparation.
- **Capacity:** The oven has a spacious interior, accommodating large dishes, perfect for family dinners or entertaining guests.
- **Design:** With a sleek and modern design, this oven fits well in most kitchen decors, enhancing the overall aesthetic of your culinary space.

## Understanding the GE Oven 229C6112P001 Manual

The manual for the GE Oven 229C6112P001 serves as a comprehensive guide that includes various sections aimed at helping users maximize the oven's potential. Here's a breakdown of the manual's primary sections:

### 1. Safety Information

Safety is paramount when using any kitchen appliance. The manual begins with important safety guidelines, which include:

1. Always keep the oven clean to prevent fires.
2. Ensure that the oven is properly installed and grounded.
3. Avoid using aluminum foil to line the oven as it can cause overheating.
4. Never leave the oven unattended while in use.

### 2. Oven Features

Understanding the features of your oven can help in utilizing it more effectively. This section typically covers:

- **Control Panel:** Describes the buttons and settings available, including temperature control and timer functions.
- **Oven Racks:** Information on how to adjust and position racks for optimal cooking.

- **Self-Cleaning Function:** Detailed instructions on how to use the self-cleaning feature safely.
- **Convection Cooking:** If applicable, this section explains how convection cooking works and its benefits.

### 3. Cooking Tips

This section provides valuable cooking tips tailored to the GE Oven 229C6112P001. Key points may include:

- Preheating the oven for better baking results.
- Using the right cookware to enhance heat distribution.
- Adjusting cooking times and temperatures for different recipes.

### 4. Troubleshooting Guide

Even the best appliances can encounter issues. The troubleshooting section is a critical part of the manual, offering solutions for common problems. Here are some examples:

1. **Oven not heating:** Check the power supply and ensure that the oven is set correctly.
2. **Uneven cooking:** Ensure that the racks are positioned correctly and avoid overcrowding.
3. **Timer not working:** Verify that the timer settings have been properly adjusted.

## Maintenance and Care for Your GE Oven

Proper maintenance is essential to ensure the longevity and efficiency of your GE Oven 229C6112P001. Here are some recommended practices:

### Regular Cleaning

Cleaning your oven regularly prevents the buildup of grease and food particles. The manual includes guidelines for:

- Wiping down the exterior with a damp cloth.
- Using appropriate cleaners for the interior, especially after using the self-cleaning function.

## Checking the Elements

Regularly inspecting the heating elements can prevent cooking issues. The manual advises:

- Looking for any visible damage or wear.
- Ensuring that the elements are clean and functioning.

## Professional Servicing

If you encounter persistent issues that cannot be resolved through troubleshooting, the manual recommends seeking professional help.

## Conclusion

The GE Oven 229C6112P001 manual is an invaluable resource for maximizing the capabilities of your oven. By familiarizing yourself with its features, cooking tips, and maintenance guidelines, you can enhance your culinary skills and ensure the longevity of your appliance. Remember that safety should always be your first priority while cooking. With proper care and attention, your GE oven can serve you well for many years, making meal preparation a delightful experience. Whether you are baking, roasting, or broiling, understanding your oven through its manual can lead to delicious outcomes in the kitchen.

## Frequently Asked Questions

### **What is the purpose of the GE oven model 229C6112P001 manual?**

The manual provides essential information on the installation, operation, maintenance, and troubleshooting of the GE oven model 229C6112P001.

## **Where can I find the GE oven 229C6112P001 manual online?**

The manual can typically be found on the official GE Appliances website or by searching for 'GE oven 229C6112P001 manual PDF' in a search engine.

## **What are some common troubleshooting tips provided in the GE oven 229C6112P001 manual?**

Common troubleshooting tips include checking the power supply, ensuring the oven door is closed properly, and resetting the oven if it displays an error code.

## **Does the GE oven 229C6112P001 manual include installation instructions?**

Yes, the manual includes detailed installation instructions to help users safely and correctly install the oven.

## **What types of cooking modes are available in the GE oven 229C6112P001?**

The manual outlines various cooking modes such as bake, broil, and self-cleaning, along with instructions on how to use each mode.

## **Is there a section on maintenance in the GE oven 229C6112P001 manual?**

Yes, the manual includes a maintenance section that provides guidelines on how to clean the oven and maintain its components for optimal performance.

## **How can I reset the GE oven 229C6112P001 according to the manual?**

To reset the oven, you can turn off the power to the appliance for a few minutes and then turn it back on, as detailed in the troubleshooting section of the manual.

## **What safety precautions are mentioned in the GE oven 229C6112P001 manual?**

The manual emphasizes safety precautions such as keeping flammable materials away from the oven, ensuring proper ventilation, and using oven mitts when handling hot items.

## **Does the GE oven 229C6112P001 manual provide warranty information?**

Yes, the manual typically includes warranty information, detailing the terms and conditions of the warranty coverage for the oven.

<https://soc.up.edu.ph/24-mark/Book?trackid=QtL35-4810&title=geekvape-aegis-nano-manual.pdf>

## Download and install Google Chrome

□□□□□□□□□? - □□

GE Online  R  -

Under review Awaiting Recommendation ...

edge□□□□□□□□ - □□

□□□□ **M** □□□□ - □□□□

GeForce MX150 - 4GB

□ □ □ □ □ □ □ □ □ ? - □ □

## Gemini Apps Help - Google Help

win11????????? - ??

## Download and install Google Chrome

How to install Chrome Important: Before you download, you can check if Chrome supports your operating system and other system requirements.

16
 ...

**GE Online**
**R**
 GE Online

Under review
 Awaiting Recommendation
 ...
 under review
 awaiting
 recommendaion
 ...

edge
 win10
 ...

M
 Dec 27, 2023
 M

**GeForce**
**MX150**
 Jun 10, 2017
 MX150
 2GB
 GDDR5
 1469mhz
 boost
 1532mhz
 6008mhz
 GP108
 3
 SM
 384SP
 ...

?
 [1]
 "XXX"
 "XXX"
 "XXX"
 [2]
 "
 "
 ...

**Gemini Apps Help - Google Help**
 Official Gemini Apps Help Center where you can find tips and tutorials on using Gemini Apps and other answers to frequently asked questions.

win11
 win11
 ...

Find the GE Oven 229C6112P001 1 manual here! Access detailed instructions and tips for optimal use. Learn more to enhance your cooking experience today!

[Back to Home](#)