

Electro Freeze Ice Cream Machine Manual

ELECTRO FREEZE Soft Serve Model 30T-RMT

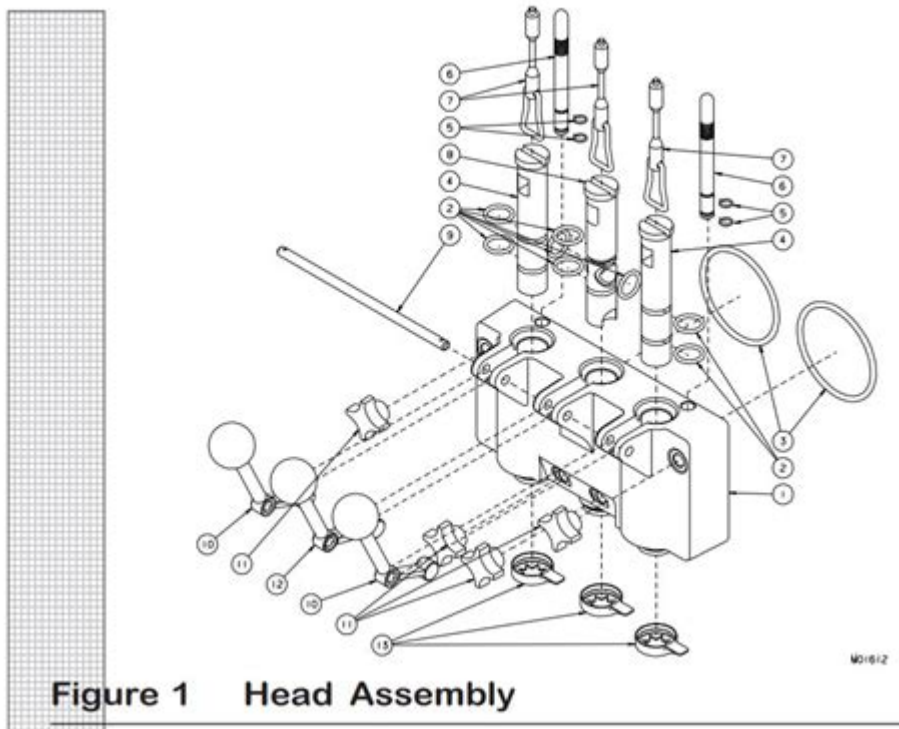

Electro Freeze ice cream machine manual provides essential guidance for both novice and experienced operators who wish to master the art of making delicious frozen treats. Understanding how to properly use and maintain your Electro Freeze machine can significantly enhance your ice cream-making experience, ensuring that you produce high-quality products consistently. This article will delve into the various aspects of the Electro Freeze ice cream machine manual, covering its features, operational guidelines, maintenance tips, and troubleshooting tactics.

Understanding Your Electro Freeze Ice Cream Machine

Electro Freeze machines are renowned for their durability and efficiency in producing soft serve ice cream, frozen yogurt, and other frozen desserts. These machines come in various models, each with its unique set of features and specifications. However, all models share common components that are crucial for their operation.

Key Components

Here are some key components you will find in most Electro Freeze ice cream machines:

- **Mix Hopper:** This is where the ice cream mix is loaded before it gets churned and frozen.
- **Freezing Cylinder:** This is the main area where the mix is frozen and churned to create a smooth texture.
- **Beater Assembly:** This stirs the mix within the freezing cylinder, preventing ice crystals from forming and ensuring a creamy consistency.
- **Control Panel:** The interface that allows you to set the desired parameters for freezing and serving.
- **Dispensing Valve:** This is the mechanism that lets you serve the ice cream once it reaches the desired consistency.

Operating Your Electro Freeze Ice Cream Machine

To successfully operate an Electro Freeze ice cream machine, it's essential to follow the guidelines outlined in the manual. These instructions ensure optimal performance and product quality.

Preparation Steps

Before starting the machine, ensure you have all the necessary ingredients and equipment ready. Here's a checklist of what you need:

1. Ice cream mix or base (pasteurized and ready to use)
2. Flavorings, if desired (vanilla, chocolate, fruit purees, etc.)
3. Mixing tools (whisk, measuring cups)
4. Cleaning supplies (sanitizer, cloths, etc.)

Starting the Machine

1. Power Up: Ensure the machine is plugged in and properly connected to a power source. Turn on the power switch located on the control panel.
2. Set Temperature: Adjust the temperature settings according to the manufacturer's recommendations. Each model may have specific requirements for optimal freezing.
3. Load the Mix: Pour the ice cream mix into the mix hopper. Do not exceed the maximum

fill line to avoid overflow during operation.

4. Start Mixing: Activate the machine to begin the mixing and freezing process. Monitor the consistency through the viewing window, if available.

5. Serve the Ice Cream: Once the ice cream reaches the desired softness, use the dispensing valve to serve it in cones or cups.

Maintenance of Your Electro Freeze Ice Cream Machine

Proper maintenance is crucial for the longevity and efficiency of your Electro Freeze ice cream machine. Regular cleaning and servicing can prevent breakdowns and ensure that your frozen treats maintain the highest quality.

Daily Maintenance

At the end of each day or after heavy use, perform the following maintenance tasks:

1. Clean the Machine:

- Turn off and unplug the machine.
- Disassemble the beater assembly and dispensing valve.
- Use a sanitizing solution to clean all removable parts.
- Wipe down the exterior surfaces with a damp cloth.

2. Check for Wear and Tear:

- Inspect the beater assembly and gaskets for any signs of damage.
- Ensure that all moving parts are functioning correctly.

Weekly Maintenance

Every week, conduct a more thorough inspection and cleaning:

1. Deep Clean:

- Perform all daily cleaning tasks.
- Use a specialized cleaning solution recommended by the manufacturer to remove any buildup in the freezing cylinder.

2. Lubricate Moving Parts:

- Apply food-safe lubricant to the moving components as indicated in the manual.

Monthly Maintenance

1. Professional Servicing:

- Schedule a professional service check to inspect electrical components, refrigerant levels, and overall machine performance.
- Replace filters and check the refrigerant system if applicable.

Troubleshooting Common Issues

Even with proper use and maintenance, issues can arise with your Electro Freeze ice cream machine. Here are some common problems and their potential solutions:

Ice Cream is Too Soft

- Cause: The machine may not be set to the correct freezing temperature.
- Solution: Check and adjust the temperature settings. Allow the machine more time to freeze the mix.

Machine Not Starting

- Cause: Power supply issues or malfunctioning power switch.
- Solution: Ensure the machine is plugged in and the outlet is functioning. If the power switch is broken, consult the manual for troubleshooting or repair instructions.

Strange Noises During Operation

- Cause: Loose components or foreign objects in the machine.
- Solution: Turn off the machine immediately and inspect for any loose parts. Remove any foreign objects that may have fallen inside.

Conclusion

The Electro Freeze ice cream machine manual serves as an invaluable resource for users who want to maximize their ice cream-making potential. By understanding the machine's components, following operational guidelines, and adhering to maintenance protocols, you can ensure that your machine operates efficiently and produces high-quality frozen desserts.

Whether you are running a commercial establishment or simply making ice cream at home, mastering the use of your Electro Freeze machine can bring joy and satisfaction to both you and your customers. Remember that regular maintenance and prompt troubleshooting are key to enjoying a seamless ice cream-making experience. Embrace the art of frozen treats, and let your creativity shine as you experiment with flavors and textures!

ELECTRO X... ELECTRO X...
... ..

Electro - ElectroYou

Electro ha aggiunto una risposta all'argomento Router Telecom ADSL2+ WiFi N non si connette a internet alle 13.38 Franco012 ha taggato Electro nel post Re: Mi consigliate cronotermostato ...

Indice • Il Forum di ElectroYou

Elettrotecnica: circuiti e macchine Argomenti Messaggi Ultimo messaggio Elettrotecnica generale Circuiti, campi elettromagnetici e teoria delle linee di trasmissione e distribuzione dell'energia ...

ElectroYou: elettronica, elettrotecnica, impianti elettrici ...

ElectroYou è il miglior modo per i professionisti e gli appassionati del settore elettrico per discutere, scambiarsi idee, contatti, opportunità e per gestire la propria identità professionale online.

EMC...? -

EMS (Electro Magnetic Susceptibility) "..." ..

Nord piano electro stage ...

Nord Electro 6HP Nord Stage ... Nord Lead A1 ...

... -

... ..

Elettrotecnica di base - ElectroYou

Indice del corso Premessa "Questa nuova sezione di Electroportal nasce da una collaborazione con la rivista di punta del settore elettrico, edita da Reed Business Information S.p.a., il "Giornale ...

Polar... -

Polar 1977 POLAR Polar Electro Oy 1979 ...

Funzioni L, S, I, G? - ElectroYou

Cosa sono le funzioni L, S, I, G? Risponde MASSIMO-G Sono le funzioni di protezione di cui è dotato uno sganciatore elettronico associato a un interruttore. La funzione L è quella contro il ...

ELECTRO X... ..

ELECTRO X... ELECTRO X... ..

Electro - ElectroYou

Electro ha aggiunto una risposta all'argomento Router Telecom ADSL2+ WiFi N non si connette a internet alle 13.38 Franco012 ha taggato Electro nel post Re: Mi consigliate cronotermostato ...

Indice • Il Forum di ElectroYou

Elettrotecnica: circuiti e macchine Argomenti Messaggi Ultimo messaggio Elettrotecnica generale Circuiti, campi elettromagnetici e teoria delle linee di trasmissione e distribuzione dell'energia ...

ElectroYou: elettronica, elettrotecnica, impianti elettrici ...

ElectroYou è il miglior modo per i professionisti e gli appassionati del settore elettrico per discutere, scambiarsi idee, contatti, opportunità e per gestire la propria identità professionale ...

EMC? -

EMS (Electro Magnetic Susceptibility)" " ...

Nordpianoelectrostage ...

Nord Electro 6HP Nord Stage ...Nord ...

-

...

Elettrotecnica di base - ElectroYou

Indice del corso Premessa "Questa nuova sezione di Electroportal nasce da una collaborazione con la rivista di punta del settore elettrico, edita da Reed Business Information S.p.a., il ...

Polar -

Polar1977POLARPolar Electro Oy1979 ...

Funzioni L, S, I, G? - ElectroYou

Cosa sono le funzioni L, S, I, G?Risponde MASSIMO-G Sono le funzioni di protezione di cui è dotato uno sganciatore elettronico associato a un interruttore. La funzione L è quella contro il ...

Unlock the full potential of your Electro Freeze ice cream machine with our comprehensive manual. Discover how to optimize performance and create delicious treats!

[Back to Home](#)