

Dp Winch 30 Parts Manual

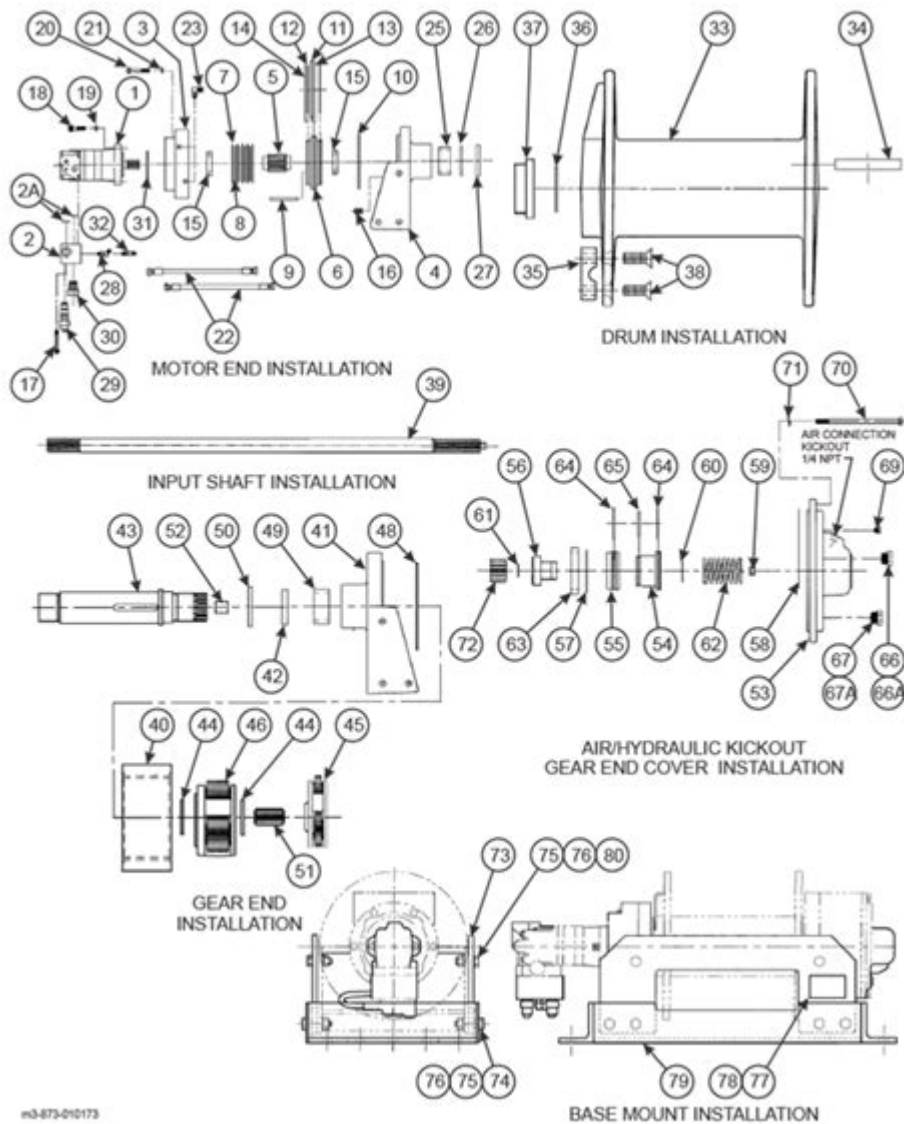

DP Winch 30 Parts Manual

The DP Winch 30 is a robust and versatile winching solution widely used in various industries, including marine, construction, and automotive applications. This comprehensive parts manual is designed to provide operators and maintenance personnel with all the necessary information to effectively understand, maintain, and repair the DP Winch 30. By detailing its components, functions, and maintenance procedures, this guide aims to ensure optimal performance and longevity of the winch.

Overview of DP Winch 30

The DP Winch 30 is engineered to handle heavy loads with ease, featuring a powerful motor and advanced hydraulic systems that improve efficiency and safety. With its durable construction, it is ideal for use in demanding environments. This section provides an introduction to its key features and specifications.

Key Features

- Load Capacity: Capable of handling loads up to 30 tons.
- Motor Type: Heavy-duty electric or hydraulic motor options.
- Construction Material: High-strength steel for durability and corrosion resistance.
- Control Mechanism: Remote control operation for enhanced safety.
- Safety Features: Includes emergency stop button, overload protection, and automatic braking system.

Specifications

- Dimensions: Varies based on specific model configurations.
- Weight: Approximately 500 kg (varies by configuration).
- Power Supply: 380V or 480V options available.
- Cable Type: Steel wire rope or synthetic rope, depending on application.

Parts Breakdown of DP Winch 30

Understanding the individual components of the DP Winch 30 is crucial for effective maintenance and repair. This section categorizes the parts into major assemblies.

1. Motor Assembly

The motor assembly is the heart of the DP Winch 30, responsible for providing the necessary power to lift and pull heavy loads. Key parts include:

- Electric Motor: Converts electrical energy into mechanical energy.
- Hydraulic Pump: Used in hydraulic models to generate pressure.
- Gearbox: Reduces motor speed while increasing torque.

2. Drum Assembly

The drum assembly is where the winch cable is wound. It consists of:

- Drum: Houses the winch cable.
- Drum Bearings: Allow for smooth rotation of the drum.
- Drum End Caps: Secure the cable and protect the drum.

3. Control System

The control system facilitates the operation of the winch. It includes:

- Remote Control Unit: Wireless control for user convenience.
- Control Panel: Houses switches for operational commands.
- Electrical Wiring: Connects all electrical components.

4. Frame and Mounting Hardware

The frame provides structural support to the winch. Its components include:

- Base Plate: Provides stability and support.
- Mounting Brackets: Allows for secure installation to various surfaces.
- Protective Covers: Shields critical components from debris and weather.

5. Safety Features

Safety is paramount in winching operations. The DP Winch 30 includes:

- Overload Protection: Prevents operation beyond rated capacity.
- Emergency Stop Button: Instantly halts operations in emergencies.
- Safety Lock Mechanism: Ensures secure locking of the drum when not in use.

Maintenance Guidelines

Regular maintenance is essential to ensure the longevity and reliability of the DP Winch 30. This section outlines the recommended practices.

Daily Inspections

Before each use, perform the following checks:

- Inspect the winch cable for frays or damage.
- Ensure the motor and hydraulic systems are functioning correctly.

- Check for any visible leaks in hydraulic components.

Weekly Maintenance

Conduct more thorough inspections, including:

- Lubricating all moving parts, including bearings and gears.
- Tightening loose bolts and hardware.
- Testing safety features to ensure they are operational.

Monthly Maintenance

Every month, perform the following:

- Replace worn or damaged cables.
- Inspect electrical connections for signs of wear or corrosion.
- Calibrate the control system if necessary.

Annual Maintenance

At least once a year, a comprehensive inspection should be conducted, which includes:

- Full disassembly and inspection of the motor and gearbox.
- Hydraulic system flush and replacement of filters.
- Full system testing under load conditions.

Troubleshooting Common Issues

Despite regular maintenance, operators may encounter issues with the DP Winch 30. This section provides troubleshooting tips for common problems.

1. Winch Does Not Operate

- Check Power Supply: Ensure that the winch is connected to a power source.
- Inspect Control System: Verify that the remote control and control panel are functioning correctly.
- Look for Tripped Breakers: Reset any circuit breakers that may have tripped.

2. Slow Operation

- Check for Overload: Ensure the load does not exceed the winch's capacity.
- Inspect Hydraulic Fluid Levels: Low fluid levels can affect performance.
- Examine Motor Functionality: Ensure the motor is not overheating or malfunctioning.

3. Cable Issues

- Inspect for Kinks or Twists: Correct any kinks or twists in the cable.
- Check Drum Alignment: Ensure the cable is properly aligned on the drum.
- Replace Worn Cable: If frayed or damaged, replace the winch cable immediately.

Ordering Replacement Parts

When it comes time to replace parts, it is essential to source the correct components to maintain the performance of the DP Winch 30. This section provides guidance on how to order parts effectively.

1. Identify Part Numbers

Refer to the parts manual that comes with the winch to identify the specific part numbers needed for replacement.

2. Choose Authorized Dealers

Always purchase replacement parts from authorized dealers or directly from the manufacturer to ensure quality and compatibility.

3. Keep a Maintenance Log

Maintaining a log of all parts replacements and repairs helps track the winch's maintenance history, making it easier to identify recurring issues.

Conclusion

The DP Winch 30 is a powerful and reliable tool for various lifting and pulling applications.

Understanding its components, proper maintenance practices, and troubleshooting techniques are vital for ensuring its optimal performance. By adhering to the guidelines outlined in this parts manual,

operators can maximize the efficiency and longevity of their DP Winch 30, ensuring it remains a valuable asset in their operations.

Frequently Asked Questions

What is included in the DP Winch 30 parts manual?

The DP Winch 30 parts manual typically includes a detailed list of parts, diagrams, maintenance instructions, and specifications for the winch.

Where can I find the DP Winch 30 parts manual?

The DP Winch 30 parts manual can usually be found on the manufacturer's official website, in the product packaging, or through authorized dealers.

How do I troubleshoot issues using the DP Winch 30 parts manual?

The manual provides troubleshooting steps and common issues related to the winch, along with part identification and repair procedures.

Is the DP Winch 30 parts manual available in digital format?

Yes, many manufacturers offer the DP Winch 30 parts manual in PDF format for easy download and access.

Can I order replacement parts for the DP Winch 30 through the manual?

Yes, the manual will often include part numbers and ordering information for replacement parts.

Does the DP Winch 30 parts manual cover installation instructions?

Yes, the parts manual typically includes installation instructions and guidelines to ensure proper setup

What safety precautions are mentioned in the DP Winch 30 parts manual?

How often should I refer to the DP Winch 30 parts manual?

Are there any common issues documented in the DP Winch 30 parts manual?

What type of maintenance does the DP Winch 30 parts manual recommend?

<https://soc.up.edu.ph/68-fact/pdf?ID=mha18-6381&title=yrc-freight-going-out-of-business.pdf>

Dp Winch 30 Parts Manual

$\prod_{i=1}^n \left(\frac{1}{2} + \frac{1}{2} \cos \frac{2\pi i}{n} \right) = \frac{1}{2^n} \sum_{k=0}^{n-1} \cos \frac{2\pi k}{n} = \frac{1}{2^n} \cos \frac{2\pi n}{n} = \frac{1}{2^n} \cos 2\pi = \frac{1}{2^n} \cdot 1 = \frac{1}{2^n}$

HDMI	DP	HDMI+DP
...		

DP DP1.0 HDMI1.3 2K 2009 DP1.2 4K 60Hz HDMI 2013
2.0 4K 60hz HDMI DP ...

Type-C + DP DP 2 DP 3 USB PD ...

DP 2021 100 HDMI 2.2 8K120Hz DSC ...

D/P $\frac{D}{A}$ 1 D/P ...

DP DP ViaLA ViaLA DP HDMI 0.2 ViaLA
HEVC ...

[Back to Home](#)