

# Dorma 669g Door Closer Installation Instructions

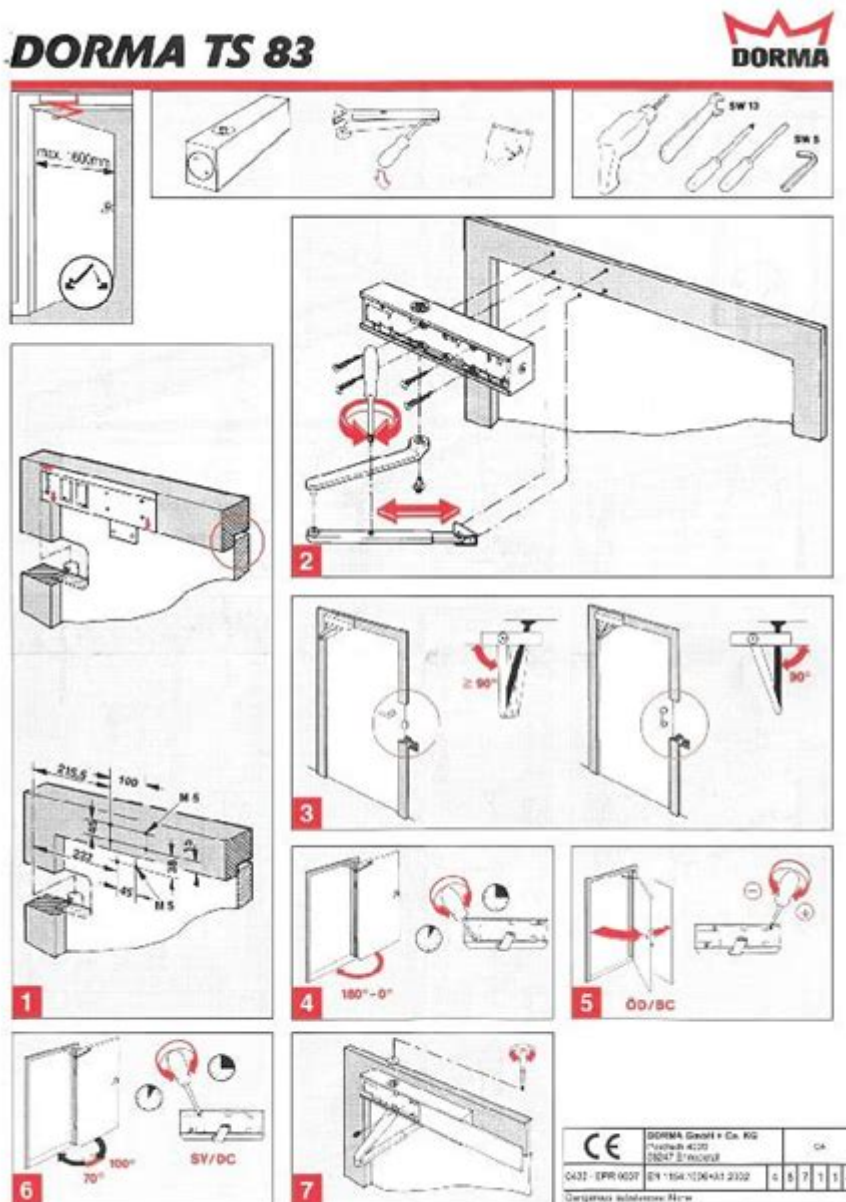

DORMA GmbH + Co. KG • Postfach 4009 • D - 58247 Ennepetal • Telefon (02333) 7930 • Änderungen vorbehalten

Dorma 669G door closer installation instructions are essential for anyone looking to install a reliable and efficient door closer in their home or office. The Dorma 669G model is a highly regarded product known for its durability, smooth operation, and adaptability to various door types. This article will guide you through the installation process in a detailed manner, ensuring you can successfully install the door closer with confidence.

# Understanding the Dorma 669G Door Closer

Before diving into the installation process, it's important to understand what a door closer is and the specific features of the Dorma 669G model.

## What is a Door Closer?

A door closer is a mechanical device that automatically closes a door after it has been opened. This is particularly useful in commercial buildings, where fire safety and energy efficiency are paramount. Door closers help maintain building security and climate control, enhancing the overall functionality of the door.

## Features of the Dorma 669G Model

The Dorma 669G door closer offers several notable features:

- Adjustable Closing Speed: Allows for customization based on user preference and door weight.
- Backcheck Function: Prevents the door from opening too forcefully, protecting walls and door hardware.
- Durability: Designed for high traffic areas, ensuring longevity.
- Modern Aesthetic: Sleek design that complements various architectural styles.

## Tools and Materials Required

Before starting the installation, gather the necessary tools and materials. This will make the process smoother and more efficient.

### Tools Needed

1. Phillips screwdriver
2. Flathead screwdriver
3. Drill with appropriate bits
4. Tape measure
5. Level
6. Pencil
7. Wrench set

### Materials Required

- Dorma 669G door closer kit (includes closer body, arm, mounting brackets, and screws)
- Door mounting template (usually included in the packaging)
- Safety goggles
- Wood or metal shims (if needed)

## **Installation Overview**

The installation of the Dorma 669G door closer can be broken down into several key steps. Follow these instructions carefully to ensure a successful installation.

### **Step 1: Preparing the Door and Frame**

Before you begin the actual installation, it's essential to prepare the door and frame.

1. Select the Mounting Position: The Dorma 669G can be installed in various configurations. Typically, it is mounted on the pull side of the door.
2. Check Door Swing: Ensure the door swings freely and is not obstructed by any hardware.
3. Verify the Door Height: Use a tape measure to confirm the height of the door and frame, ensuring the closer will fit correctly.

### **Step 2: Marking the Mounting Points**

Using the provided mounting template:

1. Position the Template: Place the template against the door and frame, aligning it with the top edge of the door.
2. Mark the Holes: Use a pencil to mark the locations for the mounting holes as indicated on the template.

### **Step 3: Drilling the Holes**

1. Drill Pilot Holes: Using an appropriate drill bit, carefully drill pilot holes at the marked locations.
2. Ensure Accuracy: Double-check the alignment before drilling all the way through.

### **Step 4: Installing the Door Closer Body**

1. Attach the Closer Body: Align the closer body with the drilled holes and secure it using the provided screws. Use a level to ensure the closer is straight.
2. Tighten the Screws: Once aligned, tighten the screws firmly.

## **Step 5: Attaching the Arm**

1. Connect the Arm to the Body: Use the provided hardware to attach the arm to the closer body.
2. Adjust the Arm Position: Depending on your installation preference, the arm may need to be positioned at a specific angle.

## **Step 6: Mounting the Arm Bracket**

1. Position the Bracket: Using the template, mark and drill holes for the arm bracket on the door frame.
2. Attach the Bracket: Secure the arm bracket to the frame with screws, ensuring it is level with the closer body.

## **Step 7: Adjusting the Closing Speed and Force**

1. Locate the Adjustment Screws: The Dorma 669G features adjustment screws for both closing speed and backcheck.
2. Make Adjustments: Use a screwdriver to adjust the speed to your preference. Start with small adjustments and test the door's operation.

## **Testing the Installation**

After completing the installation, it's crucial to test the door closer to ensure it operates as intended.

1. Open the Door: Gently open the door and let it close on its own.
2. Observe the Speed: Check if the door closes at the desired speed.
3. Check for Backcheck: Open the door quickly to test the backcheck function. The door should not swing open too forcefully.
4. Adjust If Necessary: If the door does not operate as expected, revisit the adjustment screws to fine-tune the performance.

## **Maintenance Tips for the Dorma 669G Door Closer**

To ensure the longevity and optimal performance of your Dorma 669G door closer, consider the following maintenance tips:

- Regular Inspection: Check for any loose screws or damaged components regularly.
- Lubrication: Periodically apply lubricant to moving parts to prevent wear and tear.

- Clean the Closer: Wipe down the closer with a damp cloth to remove dust and debris.
- Monitor Adjustment Settings: Reassess the closing speed and force settings occasionally, especially after heavy use.

## **Conclusion**

Installing the Dorma 669G door closer can significantly enhance the functionality and safety of your door. By following the detailed installation instructions outlined in this article, you can ensure a proper and efficient setup. Remember that proper maintenance is key to keeping your door closer in top shape for years to come. With the right tools, a little patience, and this guide, you will have a perfectly functioning door closer that meets all your needs.

## **Frequently Asked Questions**

### **What tools are required for installing the Dorma 669G door closer?**

You will need a drill, screwdriver, measuring tape, level, and possibly a chisel for mortising, depending on your installation type.

### **Is it necessary to adjust the Dorma 669G door closer after installation?**

Yes, after installation, you should adjust the closing speed and latching speed to ensure the door operates smoothly and securely.

### **Can the Dorma 669G door closer be installed on both left and right swinging doors?**

Yes, the Dorma 669G is designed for universal installation and can be adjusted for both left and right swinging doors.

### **What is the recommended height for mounting the Dorma 669G door closer?**

The recommended height for mounting the Dorma 669G door closer is typically 6 to 8 inches above the top of the door, but you should consult the specific installation instructions for exact measurements.

### **Are there any specific surface preparations needed before installing the Dorma 669G door closer?**

Yes, the installation surface should be clean and smooth. Ensure that the door and frame are properly aligned, and any old hardware should be removed to prevent interference.

Find other PDF article:

<https://soc.up.edu.ph/33-gist/pdf?trackid=jhx35-2564&title=interpretation-and-overinterpretation-in-terpretation-and-overinterpretation.pdf>

## **Dorma 669g Door Closer Installation Instructions**

*Security and access solutions | dormakaba*

Established in 1980, with the acquisition of Reading Door Closers by Dorma, dormakaba currently has operating sites across the United States, Canada, Mexico, and Brazil.

### **dormakaba Group | Safe, secure & seamless access solutions**

The dormakaba Group is a globally leading provider of smart & secure access solutions. They provide everything for secure access to buildings & rooms.

### **dormakaba - Exterior Door Hardware & Interior Door Hardware**

Security, function, and visual appeal are the foundation of door hardware that architects, builders, and designers, and end users expect from dormakaba. dormakaba door hardware is ...

### **Dorma Bedding® Sets, Sheets, Curtains UK Official Website**

Dorma Bedding has been setting the standard for luxurious, heirloom-quality bedding and home textiles since 1921. Based in the UK but with roots in Ireland, Dorma brings generations of ...

*About us | dormakaba Group*

Our purpose reflects the contribution we make to society: we are where our communities come together - from locations across town to locations across the world. At schools and ...

### **dormakaba Group - Security and access solutions**

4 days ago · Do you have a question about our products & services? Then visit your local dormakaba website where you find all country-specific information.

### **Security and access solutions | dormakaba**

Established in 1980, with the acquisition of Reading Door Closers by Dorma, dormakaba currently has operating sites across the United States, Canada, Mexico, and Brazil.

*Dorma Sleep Clinics - Sleep Apnea*

Dorma Lab is your trusted clinic for sleep apnea testing and snoring solutions. Get a FREE Consultation with one of Dorma's sleep specialists today. Start with our simple online sleep ...

*DORMA Americas - ACCESS HARDWARE*

DORMA Americas, a leading manufacturer of premium access solutions that enable better buildings, produces a full range of products and services providing safety and security as well ...

### **24/7 Automatic Door Service - dormakaba**

We have over 160 skilled service technicians and the most extensive service networks in the industry. There is an enormous amount of work to be done in a building where everything is ...

### **Security and access solutions | dormakaba**

Established in 1980, with the acquisition of Reading Door Closers by Dorma, dormakaba currently has operating sites across the United States, Canada, Mexico, and Brazil.

*dormakaba Group | Safe, secure & seamless access solutions*

The dormakaba Group is a globally leading provider of smart & secure access solutions. They provide everything for secure access to buildings & rooms.

*dormakaba - Exterior Door Hardware & Interior Door Hardware*

Security, function, and visual appeal are the foundation of door hardware that architects, builders, and designers, and end users expect from dormakaba. dormakaba door hardware is ...

*Dorma Bedding® Sets, Sheets, Curtains UK Official Website*

Dorma Bedding has been setting the standard for luxurious, heirloom-quality bedding and home textiles since 1921. Based in the UK but with roots in Ireland, Dorma brings generations of ...

*About us | dormakaba Group*

Our purpose reflects the contribution we make to society: we are where our communities come together - from locations across town to locations across the world. At schools and ...

### **dormakaba Group - Security and access solutions**

4 days ago · Do you have a question about our products & services? Then visit your local dormakaba website where you find all country-specific information.

Security and access solutions | dormakaba

Established in 1980, with the acquisition of Reading Door Closers by Dorma, dormakaba currently has operating sites across the United States, Canada, Mexico, and Brazil.

### **Dorma Sleep Clinics - Sleep Apnea**

Dorma Lab is your trusted clinic for sleep apnea testing and snoring solutions. Get a FREE Consultation with one of Dorma's sleep specialists today. Start with our simple online sleep ...

### **DORMA Americas - ACCESS HARDWARE**

DORMA Americas, a leading manufacturer of premium access solutions that enable better buildings, produces a full range of products and services providing safety and security as well ...

### **24/7 Automatic Door Service - dormakaba**

We have over 160 skilled service technicians and the most extensive service networks in the industry. There is an enormous amount of work to be done in a building where everything is ...

Discover how to install your Dorma 669G door closer with our step-by-step instructions. Ensure optimal performance and security. Learn more today!

[Back to Home](#)