

Delupet Dog Training Collar Manual

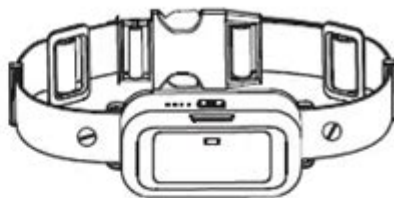

1 Handheld Remote



2 Receiver

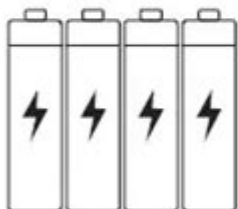

3 Battery



4 Neck Strap



5 User Manual

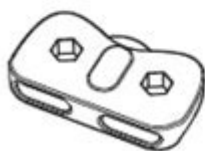

6 Test Light Tool



7 Long Contact Point



8 Conductive Silicone Cap

Delupet dog training collar manual is an essential guide for pet owners looking to enhance their dog training experience. The Delupet dog training collar is designed to provide effective communication between the owner and the dog, promoting better behavior and obedience. This article will cover the features of the collar, how to set it up, training methods, safety precautions, and troubleshooting tips.

Overview of the Delupet Dog Training Collar

The Delupet dog training collar is a versatile tool that can assist in training dogs of various sizes and temperaments. It comes with several features that make it user-friendly and effective.

Key Features

1. **Adjustable Levels of Stimulation:** The collar offers multiple levels of vibration, sound, and static shock to accommodate different training needs.
2. **Waterproof Design:** Suitable for dogs that love water or for training in wet conditions.
3. **Long-Range Control:** Effective for training at distances up to 1000 feet, allowing for outdoor training sessions.
4. **Rechargeable Battery:** The collar is equipped with a long-lasting battery that can be easily recharged.
5. **Ergonomic Remote:** The remote control is designed for ease of use, fitting comfortably in the hand.

Setting Up the Delupet Dog Training Collar

Setting up the Delupet dog training collar is a straightforward process. Follow these steps to ensure a proper setup.

Unboxing and Initial Checks

- Upon receiving your Delupet collar, carefully unbox it and check for the following items:
 - Training collar
 - Remote control
 - USB charging cable
 - User manual
 - Extra contact points (if applicable)
- Inspect the collar for any visible damage and ensure all components are present.

Charging the Collar and Remote

1. **Locate the Charging Ports:** Both the collar and remote should have a charging port.
2. **Connect the USB Cable:** Use the supplied USB cable to connect both devices to a power source.
3. **Charging Indicators:** Look for LED indicators that show when the devices are charging and when they are fully charged.

Adjusting the Collar for Your Dog

- **Measuring Your Dog's Neck:** Use a measuring tape to determine the circumference of your dog's neck to

ensure the collar fits properly.

- **Fitting the Collar:** Place the collar around your dog's neck, ensuring it fits snugly but is not too tight. You should be able to fit two fingers between the collar and your dog's neck.
- **Contact Points:** If your dog has a thick coat, consider using the longer contact points provided in the package.

Training Techniques with the Delupet Collar

Using the Delupet dog training collar effectively requires understanding the training techniques associated with it.

Positive Reinforcement Approach

1. **Reward Good Behavior:** Pair the use of the collar with treats and praise when your dog responds correctly to commands.
2. **Gradual Introduction:** Start with the lowest stimulation level, gradually increasing it only if necessary.
3. **Consistency is Key:** Use the same commands and training sessions regularly to reinforce learning.

Basic Commands Training

- **Sit:**
 - Hold a treat above your dog's head.
 - As they look up, their bottom will lower; give the command "sit" and reward when they comply.
- **Stay:**
 - Begin with your dog in the sitting position.
 - Use the command "stay" and take a few steps back. Reward if they remain in place.
- **Recall:**
 - Use a long leash initially. Call your dog using the command "come" while gently pulling the leash.
 - As they approach, reward them with praise and treats.

Using the Collar for Behavior Correction

- **Identify Problem Behaviors:** Recognize behaviors that require correction, such as excessive barking or jumping.

- Use the Collar Sparingly: When your dog exhibits unwanted behavior, use the collar's sound or vibration feature first.
- Timing is Crucial: Ensure that you activate the collar immediately after the undesired behavior for it to be effective.

Safety Precautions

While the Delupet dog training collar is a helpful tool, safety must always come first.

Monitoring Your Dog's Response

- Watch for Signs of Distress: If your dog appears anxious or fearful, discontinue use immediately and consult a professional trainer.
- Limit Usage Time: Do not leave the collar on for extended periods to avoid skin irritation.

Regular Checks and Maintenance

- Inspect the Collar: Regularly check the collar for wear and tear, especially the contact points.
- Clean the Collar: Wipe down the collar with a damp cloth to keep it clean and hygienic.

Troubleshooting Common Issues

Even with proper setup and usage, you might encounter some issues. Here are some common problems and solutions.

Collar Not Responding

1. Check Battery Level: Ensure that both the collar and remote are fully charged.
2. Sync Issues: If the collar is not responding to the remote, try re-synching them according to the user manual.

Dog Does Not Respond to Stimulation

- **Adjust Sensitivity Levels:** Increase the stimulation level gradually until you find an effective level for your dog.
- **Behavioral Assessment:** Consult a professional dog trainer if your dog continues to ignore commands.

Conclusion

The Delupet dog training collar manual provides pet owners with an essential resource for effective dog training. With its various features, ease of use, and safety precautions, this collar can significantly improve your dog's behavior and obedience. Remember to combine collar training with positive reinforcement techniques and maintain a consistent training schedule. By following the guidelines in this manual, you can create a strong, communicative bond with your dog, leading to a happier and more obedient pet.

Frequently Asked Questions

What is the Delupet dog training collar used for?

The Delupet dog training collar is used for training dogs by providing adjustable stimulation levels to help correct unwanted behaviors and reinforce positive training.

How do I charge the Delupet dog training collar?

To charge the Delupet collar, connect the provided charging cable to the collar's charging port and plug it into a USB power source until fully charged, usually indicated by a solid light.

What settings are available on the Delupet dog training collar?

The Delupet collar typically features multiple settings including beep, vibration, and static stimulation, allowing you to choose the appropriate level for your dog's training.

Is the Delupet dog training collar waterproof?

Yes, the Delupet dog training collar is designed to be waterproof, making it suitable for outdoor use in various weather conditions.

How do I fit the Delupet collar on my dog?

To fit the Delupet collar, adjust the strap to ensure it sits snugly but comfortably around your dog's neck, with enough room to fit two fingers underneath.

What is the range of the Delupet dog training collar?

The Delupet dog training collar typically has a range of up to 1,000 feet, allowing you to train your dog effectively at a distance.

Can I use the Delupet collar for small dogs?

Yes, the Delupet collar is suitable for small dogs, but it's important to ensure the collar fits properly and that the stimulation levels are appropriate for your dog's size.

How do I reset the Delupet dog training collar?

To reset the Delupet collar, locate the reset button (usually found in the collar's manual) and press it for a few seconds until the collar powers off and restarts.

Where can I find the manual for the Delupet dog training collar?

The manual for the Delupet dog training collar can typically be found in the product packaging or downloaded from the manufacturer's official website under the support or resources section.

Find other PDF article:

<https://soc.up.edu.ph/42-scope/Book?trackid=uJr98-4181&title=music-and-the-brain-studies.pdf>

[Delupet Dog Training Collar Manual](#)

Guldborgsund Kommune

Strategisk retning for Guldborgsund Byrådet har udarbejdet strategier for byrådsperioden 2022-2025, og herunder kan du læse en status fra hvert udvalg. Du kan også læse mere om ...

Guldborgsund Kommune - Wikipedia, den frie encyklopædi

Købstaden Nykøbing Falster ligger midt i Guldborgsund Kommune og er på alle måder kommunens centrum. Den er uddannelsesby for hele Lolland-Falster og Sydsjælland og du ...

Guldborgsund - Kommune.dk

Guldborgsund Kommune er beliggende i Region Sjælland og udgør et centralt bindeled mellem øerne Lolland og Falster. Kommunen dækker et areal på 90.697 hektar og har pr. 1. januar ...

Vores Guldborgsund

En kalender og portal, hvor du kan dykke ned i det rige hverdagsliv og de mange aktiviteter i Guldborgsund Kommune - se mere for oplevelsernes skyld

Guldborgsundlisten - Guldborgsundlisten

Kultur Sport og idræt Job og erhverv Lær os at kende Guldborgsundlisten er en lokalliste, og vi har en erklæret tværpolitisk og midtsøgende grundholdning. Vi arbejder for, at Guldborgsund ...

Forside - Guldborgsund Netavis

I Guldborgsund Kommune er der flere børn som håber på at opleve mere nærvær...

Ledige job - Guldborgsund Kommune

Som medarbejder i Guldborgsund træder du ind på en arbejdsplads med knapt 6.000 kolleger, hvor vi arbejder ud fra en fælles kerneopgave, som handler om at styrke borgerne i at mestre ...

Guldborgsund - Kort og rute | Krak.dk

Opdag Guldborgsund med vores kort. Udforsk lokale virksomheder, grundgrænser, historiske flyfotos, cykelstier, ladestandere med mere. Begynd din rejse nu!

Naturområde Guldborgsund

Naturområde Guldborgsund strækker sig ad og langs det smalle sund mellem Lolland og Falster fra Østersøen i øst til Smålandsfarvandet i vest. Området byder på et rigt og varieret landskab ...

Midlertidig færgeløsning snart på plads over Grønsund

3 hours ago · Fra i morgen onsdag bliver der igen mulighed for at krydse Grønsund mellem Stubbekøbing og Bogø med færge.

QUERY function - Google Docs Editors Help

QUERY(A2:E6,F2,FALSE) Syntax QUERY(data, query, [headers]) data - The range of cells to perform the query on. Each column of data can only hold boolean, numeric (including date/time ...

Función QUERY - Ayuda de Editores de Documentos de Google

Función QUERY Ejecuta una consulta sobre los datos con el lenguaje de consultas de la API de visualización de Google. Ejemplo de uso QUERY(A2:E6,"select avg(A) pivot B") ...

QUERY - Справка - Редакторы Google Документов

Выполняет запросы на базе языка запросов API визуализации Google. Пример использования QUERY (A2:E6; "select avg (A) pivot B") QUERY (A2:E6; F2; ЛОЖЬ) Синтаксис QUERY (данные; ...

[video] [GOOGLE SHEETS] FUNCIÓN QUERY: FUNCIONES DE ...

Ver en [GOOGLE SHEETS] FUNCIÓN QUERY: FUNCIONES DE AGREGACIÓN: SUM, AVG, COUNT, MIN y MAX 652 visualizaciones 4 votos a favor

Set default search engine and site search shortcuts

Set your default search engine On your computer, open Chrome. At the top right, select More Settings. Select Search engine. Next to "Search engine used in the address bar," select the Down ...

[GOOGLE SHEETS] FUNCIÓN QUERY: USO DE LA CLÁUSULA ...

[GOOGLE SHEETS] FUNCIÓN QUERY: USO DE LA CLÁUSULA SELECT Compartir Si la reproducción no empieza en breve, prueba a reiniciar el dispositivo. Los vídeos que veas podrían aparecer en ...

QUERY - Guida di Editor di documenti Google

QUERY(dati; query; [intestazioni]) dati - L'intervallo di celle su cui eseguire la query. Ogni colonna di dati può contenere solo valori booleani, numerici (inclusi i tipi data/ora) o valori stringa. In caso di ...

Scrivere e modificare una query - Guida di Editor di documenti Google

Per creare query in Fogli connessi, puoi accedere alle query salvate dai progetti BigQuery. Scopri di più sulle query salvate. Nel menu, nella parte superiore del foglio di lavoro, fai clic su Dati ...

Eseguire una ricerca avanzata su Google

Dal computer, esegui una ricerca su google.com. Sotto la casella di ricerca, seleziona il tipo di risultati: Tutti, Immagini, Video o Libri. Nella parte inferiore della casella di ricerca, fai clic su ...

BigQuery - Google Cloud Platform Console Help

Use datasets to organize and control access to tables, and construct jobs for BigQuery to execute (load, export, query, or copy data). Find BigQuery in the left side menu of the Google Cloud ...

Unlock the full potential of your Delupet dog training collar with our comprehensive manual. Discover how to train effectively and enhance your dog's behavior today!

[Back to Home](#)