

# Craftsman Lt1000 Mower Deck Diagram

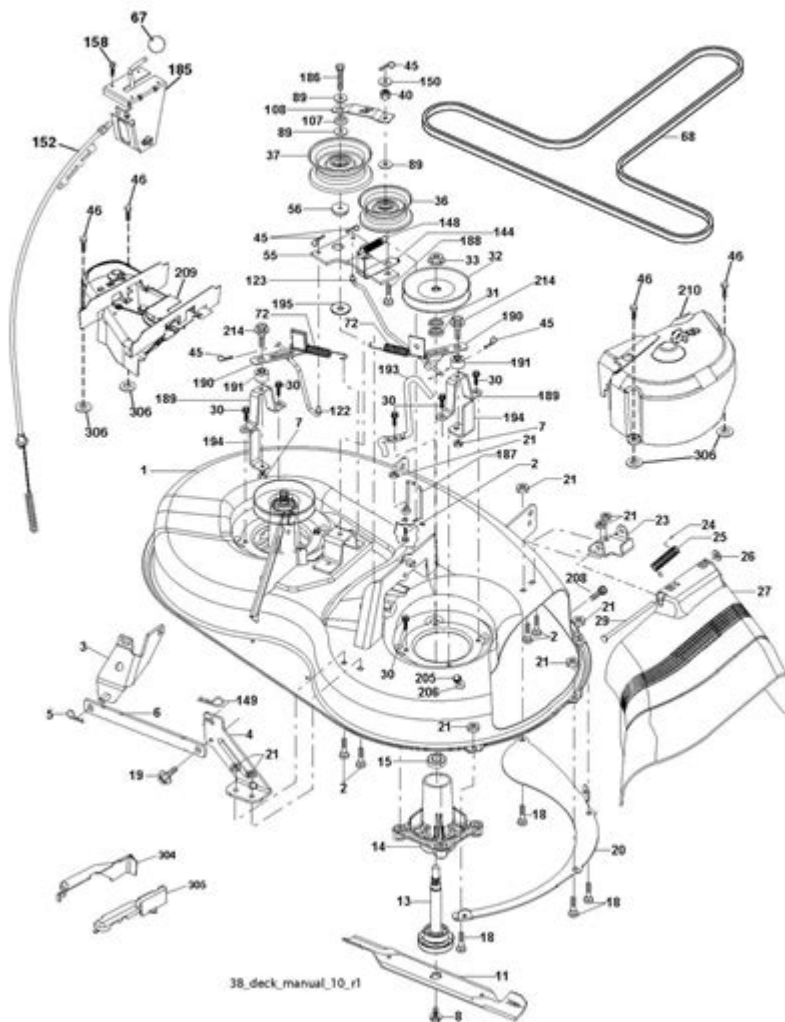

**Craftsman LT1000 mower deck diagram** is a crucial aspect for anyone who owns this popular lawn mower model. Understanding the components and layout of the mower deck can enhance maintenance, troubleshooting, and overall performance. In this article, we will explore the various parts of the Craftsman LT1000 mower deck, provide a detailed diagram, and offer maintenance tips to ensure your mower operates efficiently.

## Overview of the Craftsman LT1000 Mower

The Craftsman LT1000 is a riding lawn mower designed for residential use. It features a robust engine and a reliable cutting system, making it a favored choice among homeowners. The mower is equipped with a cutting deck, which is

essential for achieving a clean and even cut on your lawn. Understanding the mower deck's components is vital for effective maintenance and repairs.

## Components of the Mower Deck

The mower deck consists of several important components that work together to cut grass effectively. Below is a list of the main parts found in the Craftsman LT1000 mower deck:

- **Deck Housing:** The outer shell that houses the blades and other components.
- **Blades:** Sharp metal components that rotate to cut the grass.
- **Spindles:** The mechanisms that hold the blades in place and enable them to rotate.
- **Belt:** A rubber component that transmits power from the engine to the blades.
- **Deck Wheels:** Support the mower deck and allow for smooth movement over uneven terrain.
- **Grass Chute:** A discharge opening that directs cut grass away from the mower.
- **Adjustment Mechanism:** Allows users to adjust the height of the cut.

## Mower Deck Diagram Explanation

To better understand how these components fit together, a diagram is often a helpful visual aid. Below, we will describe a typical Craftsman LT1000 mower deck diagram.

### Understanding the Diagram

The mower deck diagram illustrates the layout and relationships between various parts. Here's a breakdown of key features you would typically see:

1. **Deck Housing:** The main part of the diagram, often shown as a rectangular shape that encases the cutting blades.
2. **Blades:** Typically depicted as three horizontal lines within the deck

housing, representing the blades that cut the grass.

3. Spindles: Shown as circles at the ends of the blades, indicating where the blades are attached and rotated.

4. Belt Path: A dashed line illustrating the route of the belt that connects the engine to the spindles.

5. Adjustment Mechanism: Often represented with arrows indicating the direction for raising or lowering the deck.

6. Deck Wheels: Small circles attached to the lower sides of the deck housing, showing where they make contact with the ground.

When looking at the diagram, it's important to note that each part has a specific function and location, which is essential for proper operation and maintenance.

## **Maintenance Tips for the Craftsman LT1000 Mower Deck**

Proper maintenance of the mower deck is key to ensuring the longevity and performance of your Craftsman LT1000. Below are some essential maintenance tips to keep your mower deck in top condition:

### **Regular Cleaning**

Maintaining a clean mower deck is crucial for optimal performance. Grass clippings, dirt, and debris can accumulate, affecting the mower's efficiency. Follow these steps for cleaning:

1. Turn Off the Engine: Always ensure the mower is turned off and the key is removed before performing any maintenance.
2. Use a Hose: After mowing, use a hose to wash off grass clippings from the deck.
3. Scrape Off Build-Up: Use a plastic scraper to remove any stubborn clumps of dirt or grass that may have stuck to the underside of the deck.

### **Inspecting Blades**

The blades are a critical component of the mower deck. Regular inspection and maintenance of the blades can enhance cutting performance. Consider the following:

- Sharpening: Blades should be sharpened at least once a season. Dull blades tear the grass rather than cut it, leading to a poor appearance.
- Balancing: After sharpening, ensure the blades are balanced to prevent vibration during operation.

- Replacement: If blades are excessively worn or damaged, they should be replaced immediately.

## Checking the Belt and Spindles

The belt and spindles are vital parts of the mower deck that require regular checks:

- Belt Inspection: Check the belt for any signs of wear, cracks, or fraying. A damaged belt should be replaced to avoid loss of power to the blades.
- Spindle Condition: Inspect the spindles for signs of wear or damage. Lubricate them as necessary to ensure smooth operation.

## Adjusting the Mower Deck Height

Proper cutting height is essential for maintaining a healthy lawn. The Craftsman LT1000 allows for height adjustments:

- Height Adjustment Lever: Familiarize yourself with the lever or mechanism used to adjust the height of the mower deck.
- Testing Heights: Experiment with different cutting heights based on the type of grass and the season.

## Regular Lubrication

Lubrication is necessary to reduce friction and wear on moving parts. Make it a habit to:

- Lubricate Spindles and Wheels: Use appropriate grease or oil on spindles and deck wheels as recommended in the owner's manual.
- Check for Wear: While lubricating, check for any signs of wear or damage and replace parts as needed.

## Conclusion

Understanding the **Craftsman LT1000 mower deck diagram** and the various components involved is essential for effective maintenance and repair. By familiarizing yourself with the parts, regularly cleaning, inspecting, and maintaining your mower deck, you can ensure that your Craftsman LT1000 continues to perform well for years to come. Adhering to these practices not only improves the efficiency of your lawn mower but also contributes to a healthier and more beautiful lawn.

By taking the time to understand and care for your mower's deck, you can enjoy a well-manicured lawn while extending the life of your equipment. Whether you are a seasoned lawn care expert or a novice, these maintenance tips will help you get the most out of your Craftsman LT1000 mower.

## **Frequently Asked Questions**

### **What is a Craftsman LT1000 mower deck diagram used for?**

The Craftsman LT1000 mower deck diagram is used to provide a visual representation of the mower's deck components, helping users understand the assembly and disassembly processes for maintenance or repair.

### **Where can I find a reliable Craftsman LT1000 mower deck diagram?**

Reliable Craftsman LT1000 mower deck diagrams can be found in the owner's manual, on the Craftsman official website, or through various online forums and repair websites that specialize in lawn equipment.

### **What are the common issues that can be diagnosed using the Craftsman LT1000 mower deck diagram?**

Common issues that can be diagnosed using the diagram include improper belt alignment, blade mounting problems, and difficulties with the height adjustment mechanism.

### **Can I use a Craftsman LT1000 mower deck diagram for troubleshooting?**

Yes, the Craftsman LT1000 mower deck diagram can be very useful for troubleshooting as it shows the layout and connections of various components, making it easier to identify and fix issues.

### **Is the mower deck diagram the same for all LT1000 models?**

No, the mower deck diagram may vary slightly between different LT1000 models due to changes in design or features, so it's important to ensure you're using the correct diagram for your specific model.

### **What components are typically labeled in a Craftsman LT1000 mower deck diagram?**

Typically labeled components in a Craftsman LT1000 mower deck diagram include the mower blades, spindles, belts, pulleys, and height adjustment mechanisms.

Find other PDF article:

<https://soc.up.edu.ph/25-style/files?trackid=tpP03-9573&title=got-lactase-the-co-evolution-of-genes-and-culture-answer-key.pdf>

## **Craftsman Lt1000 Mower Deck Diagram**

[Home | CRAFTSMAN®](#)

Official website for CRAFTSMAN®. Explore power tools, outdoor equipment, hand tools, storage products and more.

*Find A Retailer | CRAFTSMAN*

Find a CRAFTSMAN® authorized provider near you and discover who sells CRAFTSMAN® tools online or in a retail store near you.

**Shop Parts | CRAFTSMAN**

Sometimes products wear down and need repair or maintenance. Fortunately, you have several options to fix your products with Craftsman Parts & Service.

**Power Tools and Accessories | CRAFTSMAN**

Browse high-performance power tools and accessories, including drivers, impacts, saws and more. Get the best quality for the job from Craftsman.

**V20\* 5.0AH Lithium Ion Battery | CRAFTSMAN**

This V20\* 5.0Ah Lithium Ion Battery is compatible with the CRAFTSMAN® V20\* cordless power tool and outdoor tool lineup. The professional grade high performance cells provide improved ...

*Home & Outdoor - Garden Tools, Mowers & More | CRAFTSMAN*

When it comes to shaping up your yard, look no further than CRAFTSMAN® to find the right equipment for you. Browse cordless and gas tools at CRAFTSMAN®. Take on large lawns ...

*Shop All Mowers | CRAFTSMAN*

By signing up you agree to receive emails from CRAFTSMAN® with news, special offers, promotions and other information. You can unsubscribe at any time. See our Privacy Policy or ...

*Customer Support | CRAFTSMAN*

Find out more information about CRAFTSMAN® tools, warranty, parts, service, and more with our customer support resources.

42 in. Gas Zero-Turn Riding Mower (Z3200) | CRAFTSMAN

Transform your yard and mow up to 3 times faster than a walk behind\*. The high-performance 42 in. Gas Zero-Turn Riding Mower (Z3200) features a powerful 547cc single-cylinder engine ...

*V20\* System Cordless Power Tools | CRAFTSMAN*

Explore the CRAFTSMAN® V20\* System of cordless power tools and products. The V20\* System has the battery power, range and reliability to get your projects done.

*Home | CRAFTSMAN®*

Official website for CRAFTSMAN®. Explore power tools, outdoor equipment, hand tools, storage products and more.

#### *Find A Retailer | CRAFTSMAN*

Find a CRAFTSMAN® authorized provider near you and discover who sells CRAFTSMAN® tools online or in a retail store near you.

#### **Shop Parts | CRAFTSMAN**

Sometimes products wear down and need repair or maintenance. Fortunately, you have several options to fix your products with Craftsman Parts & Service.

#### Power Tools and Accessories | CRAFTSMAN

Browse high-performance power tools and accessories, including drivers, impacts, saws and more. Get the best quality for the job from Craftsman.

#### **V20\* 5.0AH Lithium Ion Battery | CRAFTSMAN**

This V20\* 5.0Ah Lithium Ion Battery is compatible with the CRAFTSMAN® V20\* cordless power tool and outdoor tool lineup. The professional grade high performance cells provide improved power and a longer cycle life.

#### **Home & Outdoor - Garden Tools, Mowers & More | CRAFTSMAN**

When it comes to shaping up your yard, look no further than CRAFTSMAN® to find the right equipment for you. Browse cordless and gas tools at CRAFTSMAN®. Take on large lawns and rough terrain with CRAFTSMAN® riding lawn mowers designed to let you take charge of your yard.

#### *Shop All Mowers | CRAFTSMAN*

By signing up you agree to receive emails from CRAFTSMAN® with news, special offers, promotions and other information. You can unsubscribe at any time. See our Privacy Policy or Contact Us by ...

#### *Customer Support | CRAFTSMAN*

Find out more information about CRAFTSMAN® tools, warranty, parts, service, and more with our customer support resources.

#### **42 in. Gas Zero-Turn Riding Mower (Z3200) | CRAFTSMAN**

Transform your yard and mow up to 3 times faster than a walk behind\*. The high-performance 42 in. Gas Zero-Turn Riding Mower (Z3200) features a powerful 547cc single-cylinder engine designed for consistent mowing performance in thick, wet, heavy grass. Ideal for yards up to 2 acres, the 42 in. steel deck, robust steel frame, and dual hydrostatic transmissions offer ...

#### **V20\* System Cordless Power Tools | CRAFTSMAN**

Explore the CRAFTSMAN® V20\* System of cordless power tools and products. The V20\* System has the battery power, range and reliability to get your projects done.

Explore our detailed Craftsman LT1000 mower deck diagram for easy maintenance and repair. Discover how to optimize your mower's performance today!

[Back to Home](#)