

Craftsman Fs5500 Parts Diagram

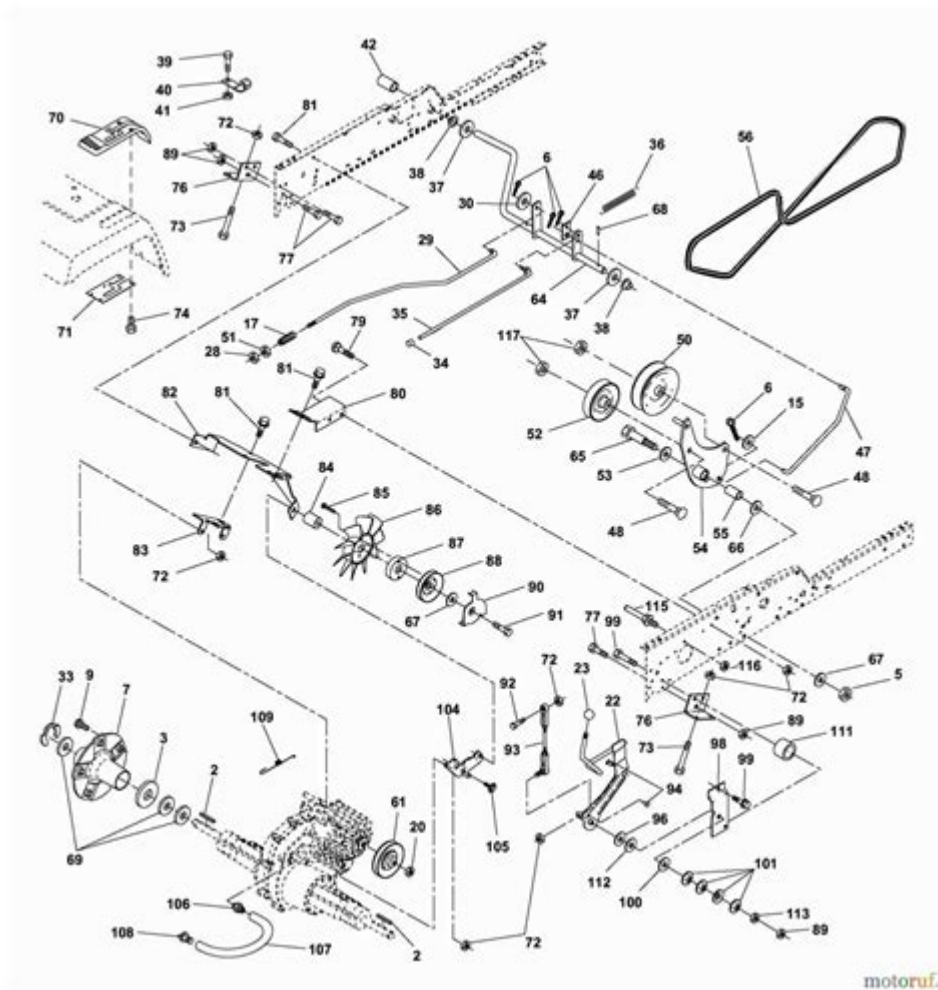

Craftsman FS5500 Parts Diagram is an essential resource for anyone who owns or operates this powerful and versatile equipment. The FS5500 is a popular model in the Craftsman lineup, known for its efficiency and durability in tackling various landscaping tasks. Understanding the parts diagram is critical for maintenance, troubleshooting, and repairs. This article delves into the various components of the Craftsman FS5500, how to interpret the parts diagram, and tips for effective maintenance.

Understanding the Craftsman FS5500

The Craftsman FS5500 is a robust lawn mower designed to handle large yards and tough mowing conditions. It is equipped with a powerful engine and a wide cutting deck, allowing for efficient grass cutting and yard maintenance. Knowing the parts and their functions can significantly enhance your experience with this machine.

Key Features of Craftsman FS5500

- **Powerful Engine:** The FS5500 typically features a reliable engine, providing sufficient horsepower for

demanding tasks.

- **Wide Cutting Deck:** The mower's cutting deck offers a wider cutting path, allowing for quicker mowing.
- **Adjustable Height Settings:** Users can adjust the height of the cutting deck to suit different grass types and preferences.
- **Durable Build:** Craftsman tools are known for their durability, and the FS5500 is no exception, making it a long-lasting investment for homeowners.

Parts of the Craftsman FS5500

To effectively operate and maintain the Craftsman FS5500, it's essential to familiarize yourself with its parts. Below is a breakdown of the major components typically found in the parts diagram.

Engine Components

The engine is the heart of the FS5500. Key parts include:

1. **Crankshaft:** Converts the linear motion of the pistons into rotational motion.
2. **Piston:** Moves up and down in the cylinder, creating the power stroke.
3. **Spark Plug:** Ignites the fuel-air mixture, starting the combustion process.
4. **Fuel Tank:** Stores gasoline required for engine operation.
5. **Air Filter:** Cleans the air entering the engine, preventing debris from causing damage.

Cutting Deck Components

The cutting deck is crucial for the mower's performance and includes:

- **Blades:** Sharp, rotating blades that cut grass at the desired height.
- **Deck Housing:** Encloses the blades and supports the overall structure of the cutting deck.
- **Height Adjustment Lever:** Allows users to change the cutting height.
- **Spindle Assembly:** Holds the blades in place and enables their rotation.

Transmission and Drive Components

The transmission system is responsible for transferring power from the engine to the wheels. Key parts include:

1. **Transmission Housing:** Encloses the gears and components that drive the mower.
2. **Drive Belt:** Transfers power from the engine to the wheels.
3. **Wheels:** Provide mobility and support the mower's weight.
4. **Axles:** Connect the wheels to the mower and allow for smooth rotation.

Interpreting the FS5500 Parts Diagram

The parts diagram for the Craftsman FS5500 is a visual representation of all the components, showing how they fit together. Here's how to interpret it:

Understanding Symbols and Labels

- Part Numbers: Each component is labeled with a unique part number for easy identification.
- Arrow Indicators: Arrows may show the direction of movement or assembly.
- Grouped Components: Related parts are often grouped together, indicating their function in the assembly.

How to Use the Parts Diagram for Repairs

Using the parts diagram effectively can simplify the repair process:

1. Identify the Failed Component: Use the diagram to locate the problematic part in your FS5500.
2. Note the Part Number: Write down the part number for ordering replacements.
3. Follow Assembly Instructions: Refer to the diagram to understand how to disassemble and reassemble parts.

Common Issues and Solutions

Despite its robust design, the Craftsman FS5500 may run into issues. Here are some common problems and their solutions:

Engine Won't Start

- Possible Causes: Empty fuel tank, clogged fuel filter, dead battery.
- Solutions:
 - Check and refill the fuel tank.
 - Replace or clean the fuel filter.
 - Test the battery and replace if necessary.

Uneven Cutting

- Possible Causes: Dull blades, uneven tire pressure, or a misaligned deck.
- Solutions:
 - Sharpen or replace the blades.
 - Check and adjust tire pressure.

- Level the cutting deck according to manufacturer specifications.

Excessive Vibration

- Possible Causes: Loose parts, unbalanced blades, or worn-out bearings.
- Solutions:
 - Tighten any loose screws or bolts.
 - Inspect the blades for balance and replace if necessary.
 - Check the bearings in the spindle assembly.

Maintenance Tips for Longevity

To ensure that your Craftsman FS5500 remains in prime condition, follow these maintenance tips:

1. Regular Oil Changes: Change the engine oil every 50 hours of operation or at the beginning of each season.
2. Clean the Air Filter: Check the air filter frequently and replace it as needed to ensure optimal engine performance.
3. Sharpen Blades: Keep the mower blades sharp to achieve a clean cut and maintain grass health.
4. Inspect Belts and Cables: Regularly check belts and cables for wear and tear, replacing them at the first sign of deterioration.
5. Store Properly: At the end of the mowing season, store the mower in a dry, sheltered area to protect it from the elements.

Where to Find Parts and Diagrams

Finding the right parts for your Craftsman FS5500 is crucial for repairs and maintenance. Here are some resources:

- Official Craftsman Website: Offers parts diagrams and ordering options for genuine Craftsman parts.
- Local Hardware Stores: Many carry Craftsman parts or can order them for you.
- Online Retailers: Websites like Amazon, eBay, and specialized gardening supply stores often have parts available.
- User Manuals: Check the user manual for specific diagrams and parts lists.

Conclusion

Understanding the Craftsman FS5500 Parts Diagram is vital for any owner looking to maintain their lawn mower efficiently. By familiarizing yourself with the various components, knowing how to interpret the parts diagram, and following maintenance tips, you can ensure that your FS5500 operates smoothly for years to come. With the right knowledge and resources, troubleshooting and repairs become manageable, allowing you to focus on what matters most: keeping your yard looking

its best.

Frequently Asked Questions

Where can I find the parts diagram for the Craftsman FS5500?

The parts diagram for the Craftsman FS5500 can typically be found on the official Craftsman website or through authorized dealers. You can also check online forums and parts retailers that specialize in Craftsman products.

What are the common replacement parts for the Craftsman FS5500?

Common replacement parts for the Craftsman FS5500 include the carburetor, spark plug, air filter, fuel lines, and various blades. The specific parts can be identified using the parts diagram.

How do I interpret the Craftsman FS5500 parts diagram?

To interpret the Craftsman FS5500 parts diagram, locate the part number you need and match it with the corresponding part on the diagram. Each part is usually labeled with a number that corresponds to a list of parts available for purchase.

Are there any aftermarket parts available for the Craftsman FS5500?

Yes, there are aftermarket parts available for the Craftsman FS5500. Many retailers offer compatible parts that can be used as substitutes. However, it's important to verify compatibility with the parts diagram before purchasing.

Can I get a digital copy of the Craftsman FS5500 parts diagram?

Yes, many websites provide downloadable PDF versions of the Craftsman FS5500 parts diagram. You can also find it in the product manual, which may be available online on the Craftsman website or through customer support.

Find other PDF article:

<https://soc.up.edu.ph/40-trend/pdf?dataid=OSv30-7965&title=mean-mode-median-range-worksheet.pdf>

Craftsman Fs5500 Parts Diagram

Official website for CRAFTSMAN®. Explore power tools, outdoor equipment, hand tools, storage products and more.

Find A Retailer | CRAFTSMAN

Find a CRAFTSMAN® authorized provider near you and discover who sells CRAFTSMAN® tools online or in a retail store near you.

Shop Parts | CRAFTSMAN

Sometimes products wear down and need repair or maintenance. Fortunately, you have several options to fix your products with Craftsman Parts & Service.

Power Tools and Accessories | CRAFTSMAN

Browse high-performance power tools and accessories, including drivers, impacts, saws and more. Get the best quality for the job from Craftsman.

V20* 5.0AH Lithium Ion Battery | CRAFTSMAN

This V20* 5.0Ah Lithium Ion Battery is compatible with the CRAFTSMAN® V20* cordless power tool and outdoor tool lineup. The professional grade high performance cells provide improved power and a longer cycle life.

Home & Outdoor - Garden Tools, Mowers & More | CRAFTSMAN

When it comes to shaping up your yard, look no further than CRAFTSMAN® to find the right equipment for you. Browse cordless and gas tools at CRAFTSMAN®. Take on large lawns and rough terrain with CRAFTSMAN® riding lawn mowers designed to ...

Shop All Mowers | CRAFTSMAN

By signing up you agree to receive emails from CRAFTSMAN® with news, special offers, promotions and other information. You can unsubscribe at any time. See our Privacy Policy or ...

Customer Support | CRAFTSMAN

Find out more information about CRAFTSMAN® tools, warranty, parts, service, and more with our customer support resources.

42 in. Gas Zero-Turn Riding Mower (Z3200) | CRAFTSMAN

Transform your yard and mow up to 3 times faster than a walk behind*. The high-performance 42 in. Gas Zero-Turn Riding Mower (Z3200) features a powerful 547cc single-cylinder engine designed for consistent mowing performance in thick, wet, heavy grass. Ideal for yards up to 2 acres, the 42 in. steel deck, robust steel frame, and dual hydrostatic transmissions offer ...

V20 System Cordless Power Tools | CRAFTSMAN*

Explore the CRAFTSMAN® V20* System of cordless power tools and products. The V20* System has the battery power, range and reliability to get your projects done.

Home | CRAFTSMAN®

Official website for CRAFTSMAN®. Explore power tools, outdoor equipment, hand tools, storage products and more.

Find A Retailer | CRAFTSMAN

Find a CRAFTSMAN® authorized provider near you and discover who sells CRAFTSMAN® tools online or in a retail store near you.

Shop Parts | CRAFTSMAN

Sometimes products wear down and need repair or maintenance. Fortunately, you have several options to fix your products with Craftsman Parts & Service.

Power Tools and Accessories | CRAFTSMAN

Browse high-performance power tools and accessories, including drivers, impacts, saws and more. Get the best quality for the job from Craftsman.

V20* 5.0AH Lithium Ion Battery | CRAFTSMAN

This V20* 5.0Ah Lithium Ion Battery is compatible with the CRAFTSMAN® V20* cordless power tool and outdoor tool lineup. The professional grade high performance cells provide improved ...

Home & Outdoor - Garden Tools, Mowers & More | CRAFTSMAN

When it comes to shaping up your yard, look no further than CRAFTSMAN® to find the right equipment for you. Browse cordless and gas tools at CRAFTSMAN®. Take on large lawns ...

Shop All Mowers | CRAFTSMAN

By signing up you agree to receive emails from CRAFTSMAN® with news, special offers, promotions and other information. You can unsubscribe at any time. See our Privacy Policy or ...

Customer Support | CRAFTSMAN

Find out more information about CRAFTSMAN® tools, warranty, parts, service, and more with our customer support resources.

42 in. Gas Zero-Turn Riding Mower (Z3200) | CRAFTSMAN

Transform your yard and mow up to 3 times faster than a walk behind*. The high-performance 42 in. Gas Zero-Turn Riding Mower (Z3200) features a powerful 547cc single-cylinder engine ...

V20* System Cordless Power Tools | CRAFTSMAN

Explore the CRAFTSMAN® V20* System of cordless power tools and products. The V20* System has the battery power, range and reliability to get your projects done.

Explore the detailed Craftsman FS5500 parts diagram to help you identify and order the right components. Learn more to keep your equipment running smoothly!

[Back to Home](#)