

Cub Cadet Ltx 1040 Deck Belt Diagram

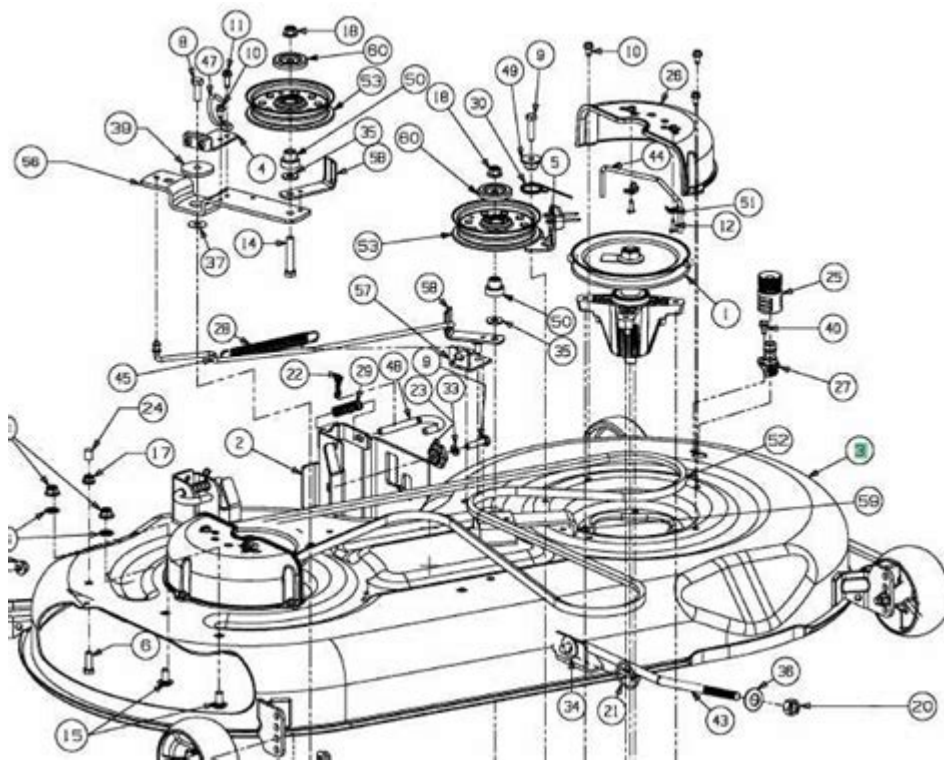

Cub Cadet LTX 1040 deck belt diagram is an essential topic for any owner or operator of this popular lawn tractor. Understanding how the deck belt fits into the overall mechanics of the LTX 1040 can greatly enhance your ability to maintain and troubleshoot the machine. This article will provide a comprehensive overview of the Cub Cadet LTX 1040, focusing on its deck belt diagram, installation, maintenance, and some common issues related to the deck belt.

Overview of Cub Cadet LTX 1040

The Cub Cadet LTX 1040 is a robust lawn tractor designed for residential use. It features a powerful 19 horsepower engine and a 42-inch cutting deck, making it suitable for medium to large lawns. The tractor is known for its ease of use, durability, and efficiency, which makes it a popular choice among homeowners.

Understanding the Deck Belt

The deck belt is a crucial component of the Cub Cadet LTX 1040. It transfers power from the engine to the cutting deck, enabling the blades to rotate and cut grass effectively. A well-maintained deck belt ensures that the mower operates smoothly and efficiently.

Importance of the Deck Belt

The deck belt plays several important roles:

- **Power Transmission:** It connects the engine to the cutting blades, allowing for efficient grass cutting.
- **Durability:** A high-quality deck belt withstands wear and tear, ensuring longevity.
- **Performance:** Properly functioning belts enhance overall mower performance, ensuring a clean cut.

Cub Cadet LTX 1040 Deck Belt Diagram

Having a clear understanding of the Cub Cadet LTX 1040 deck belt diagram is essential for installation and troubleshooting. The diagram illustrates the routing of the deck belt around various pulleys and components, making it easier to visualize where each part fits.

Components of the Deck Belt Diagram

The deck belt diagram typically includes the following components:

1. **Engine Pulley:** The engine pulley drives the belt, initiating the power transfer.
2. **Idler Pulley:** This component helps maintain tension on the belt, ensuring it stays in place during operation.
3. **Deck Pulleys:** These pulleys are attached to the cutting blades and allow them to rotate.
4. **Deck Belt:** The primary belt that connects various pulleys.

Viewing the Diagram

To view the deck belt diagram for the Cub Cadet LTX 1040, you can refer to:

- **Owner's Manual:** The owner's manual provides detailed diagrams and instructions.
- **Online Resources:** Websites like the Cub Cadet official site or forums dedicated to lawn care often have diagrams available.
- **Repair Guides:** Various online repair guides and videos can visually demonstrate the belt routing.

Installing the Deck Belt

Installing a new deck belt on the Cub Cadet LTX 1040 is a straightforward process if you follow the correct steps. Here's a step-by-step guide:

Tools Required

Before beginning the installation, ensure you have the following tools:

- Socket wrench set
- Flathead screwdriver
- Replacement deck belt
- Safety gloves

Installation Steps

1. Preparation:

- Turn off the engine and remove the key.
- Disconnect the battery to avoid accidental start-up.

2. Access the Deck:

- Use the socket wrench to remove the deck from the tractor. This usually involves removing several bolts and pins.

3. Remove the Old Belt:

- Locate the old belt and carefully remove it from the pulleys. Take note of how it is routed, as this will help in installing the new belt.

4. Install the New Belt:

- Begin by threading the new belt through the same path as the old one, following the deck belt diagram.
- Ensure the belt is seated correctly on all pulleys.

5. Reattach the Deck:

- Once the belt is in place, reattach the deck to the tractor, securing it with the bolts and pins you previously removed.

6. Reconnect the Battery:

- Reconnect the battery and start the engine to test the belt. Check for any unusual noises or vibrations.

Maintenance of the Deck Belt

Regular maintenance of the deck belt is crucial for the longevity and performance of your Cub Cadet LTX 1040. Here are some maintenance tips:

Inspecting the Belt

- Visual Inspection: Regularly check the belt for signs of wear, such as fraying or cracks.
- Tension Check: Ensure the belt maintains proper tension. A loose belt can slip off, while a tight belt can cause excessive wear.

Cleaning the Deck Area

Keeping the area around the deck clean helps prevent debris from getting caught in the belt, which can lead to damage. Use a brush or compressed air to clean off grass clippings and dirt.

Replacing the Belt

If you notice significant wear or if the belt has broken, it's essential to replace it immediately. Regularly scheduled checks can help identify issues before they lead to a complete failure.

Troubleshooting Common Deck Belt Issues

Even with proper maintenance, you might encounter issues with your deck belt. Here are some common problems and their solutions:

Slipping Belt

- Symptoms: The mower blades may not engage properly, or you may hear a slipping noise.
- Solution: Check the tension of the belt and adjust or replace if necessary.

Belt Breakage

- Symptoms: A broken belt will stop the blades from functioning entirely.
- Solution: Inspect for signs of excessive wear or misalignment. Replace the belt and ensure proper installation.

Pulley Misalignment

- Symptoms: Uneven cutting or the belt rubbing against components.
- Solution: Check the alignment of the pulleys and adjust as needed.

Conclusion

Understanding the **Cub Cadet LTX 1040 deck belt diagram** is vital for effective maintenance and troubleshooting of your lawn tractor. By familiarizing yourself with the components, installation process, and maintenance tips, you can ensure that your machine remains in optimal condition for years to come. Regular inspections and timely replacements will not only enhance performance but also extend the life of your Cub Cadet LTX 1040, making your lawn care tasks more efficient and enjoyable.

Frequently Asked Questions

What is the purpose of the deck belt on a Cub Cadet LTX 1040?

The deck belt on a Cub Cadet LTX 1040 drives the blades of the mower deck, enabling it to cut grass effectively.

Where can I find the deck belt diagram for a Cub Cadet LTX 1040?

The deck belt diagram can usually be found in the owner's manual, on the Cub Cadet website, or through various online forums and repair guides.

How do I replace the deck belt on a Cub Cadet LTX 1040?

To replace the deck belt, you should first remove the mower deck, then follow the belt diagram to install the new belt correctly around the pulleys.

What are the symptoms of a worn deck belt on a Cub Cadet LTX 1040?

Symptoms of a worn deck belt include squeaking noises, uneven cutting, or the blades not engaging properly.

Is there a specific part number for the Cub Cadet LTX 1040 deck belt?

Yes, the specific part number for the deck belt of the Cub Cadet LTX 1040 is typically 754-04060, but it's always best to verify with your local dealer.

Can I use a universal deck belt for my Cub Cadet LTX 1040?

While universal deck belts may fit, it is recommended to use the specific part designed for the Cub Cadet LTX 1040 to ensure proper performance and longevity.

What tools do I need to install a new deck belt on a Cub Cadet LTX 1040?

To install a new deck belt on a Cub Cadet LTX 1040, you typically need basic hand tools like a socket set, wrenches, and possibly a screwdriver.

Find other PDF article:
<https://soc.up.edu.ph/50-draft/Book?trackid=bxJ78-7110&title=refinement-and-repetition-dry-fire-dri-lls-for-dramatic-improvement.pdf>

Cub Cadet Ltx 1040 Deck Belt Diagram

cub -
Jul 13, 2024 · cubCUB1. CUB
...

PSB CUB FAB SB OB ...

