

Craftsman M215 Parts Diagram

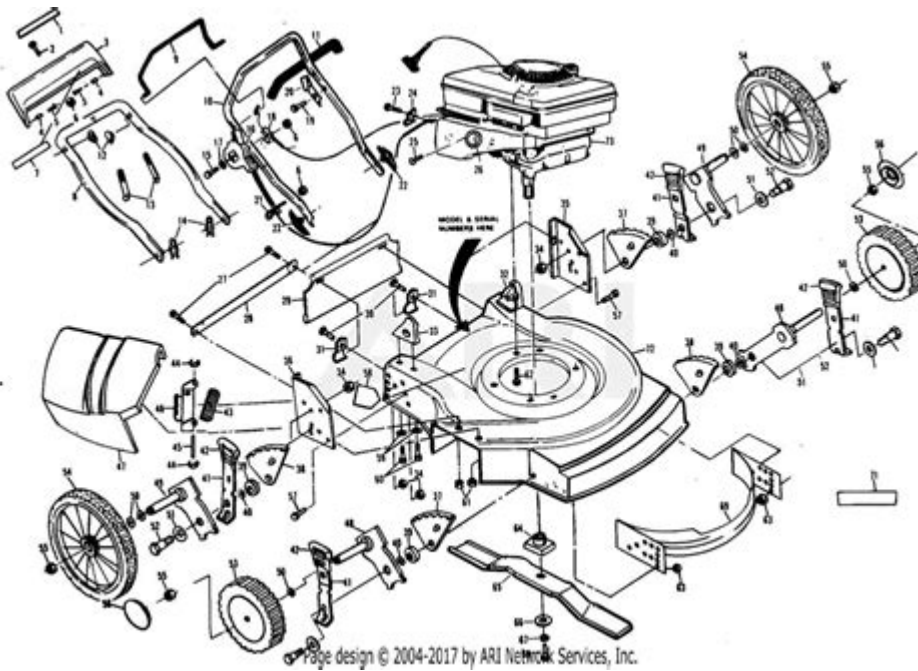

Craftsman M215 parts diagram is an essential tool for anyone looking to understand, repair, or maintain their Craftsman M215 lawn mower. This diagram provides a visual representation of the mower's components, making it easier to identify parts when performing repairs or ordering replacements. In this article, we will explore the various parts of the Craftsman M215, how to interpret the parts diagram, common issues, and maintenance tips to ensure your mower operates efficiently.

Understanding the Craftsman M215 Parts Diagram

The Craftsman M215 parts diagram is a detailed illustration that breaks down the entire mower into its individual components. Each part is labeled with a part number, making it easier for users to find and order specific pieces. Understanding this diagram is crucial for both novice and experienced users, particularly when troubleshooting issues or planning maintenance.

Key Components of the Craftsman M215

The Craftsman M215 consists of several critical components, each serving a specific function. Here are some of the major parts you will find in the parts diagram:

1. Engine Assembly
 - The heart of the mower, responsible for powering the blades.
 - Contains the carburetor, air filter, and spark plug.
2. Cutting Deck

- Houses the mower blades and is responsible for cutting the grass.
- Includes the deck housing and blade spindle.

3. Wheels and Axles

- Allows the mower to move smoothly across the lawn.
- Includes wheel hubs, tires, and axle shafts.

4. Handle Assembly

- Provides support and control for the user.
- Includes the throttle control and safety switch.

5. Fuel System

- Provides the engine with the necessary fuel to operate.
- Includes the fuel tank, fuel lines, and fuel filter.

6. Electrical Components

- Powers the electric starter and ignition system.
- Includes the battery, wiring harness, and starter motor.

Interpreting the Parts Diagram

To make the most out of the Craftsman M215 parts diagram, it's important to know how to read it effectively. Here's a step-by-step guide:

1. Locate the Legend

- Most diagrams include a legend that explains the symbols used. Familiarize yourself with these symbols for easier navigation.

2. Identify Major Sections

- The diagram is typically divided into sections like the engine, deck, wheels, and so forth. Start by identifying the section that pertains to your area of concern.

3. Find Part Numbers

- Each component will have a corresponding part number. When you find a part you need, note this number for ordering.

4. Use Reference Lines

- Diagrams often use lines to connect parts, showing how they fit together. Pay attention to these connections when disassembling or reassembling.

5. Check for Additional Notes

- Some diagrams include notes on maintenance or specific assembly instructions. These can be invaluable for ensuring correct operation.

Common Issues with the Craftsman M215

Understanding the common issues that can arise with the Craftsman M215 can help you quickly

identify what might be wrong with your mower. Here are some frequent problems and their potential causes:

1. Engine Won't Start

- Possible Causes:
- Empty fuel tank
- Clogged fuel lines or filter
- Dead battery or faulty starter motor
- Blocked spark plug

2. Uneven Cutting

- Possible Causes:
- Dull or damaged blades
- Uneven tire pressure
- Incorrect cutting height adjustment

3. Excessive Vibration

- Possible Causes:
- Loose or missing bolts in the deck assembly
- Unbalanced blades
- Worn-out bearings in the wheel assembly

4. Overheating

- Possible Causes:
- Clogged air filter
- Low oil levels
- Blocked cooling fins

Maintenance Tips for the Craftsman M215

Regular maintenance is crucial for prolonging the life of your Craftsman M215 and ensuring it runs efficiently. Here are some tips to keep your mower in top condition:

1. Regularly Check and Change the Oil

- Use high-quality engine oil and change it according to the manufacturer's recommendations.
- Check oil levels before each use and top off as needed.

2. Sharpen the Blades

- Dull blades can lead to uneven cuts and stress the engine. Sharpen the blades at least once a season or more frequently if you mow regularly.

3. Clean the Air Filter

- A clean air filter ensures proper airflow to the engine. Check it regularly and clean or replace it as necessary.

4. Inspect the Fuel System

- Check for leaks in fuel lines and ensure the fuel filter is clean. Use fresh fuel to prevent clogging.

5. Keep the Mower Clean

- After mowing, clean the underside of the deck to prevent grass buildup, which can affect performance.

Ordering Replacement Parts

When you need to order replacement parts for your Craftsman M215, the parts diagram becomes invaluable. Here's how to go about it:

1. Identify the Part Number

- Use the parts diagram to find the exact part number of the component you need.

2. Choose a Reliable Supplier

- Look for reputable retailers, either online or local, that specialize in lawn mower parts.

3. Verify Compatibility

- Ensure that the part is compatible with your specific model of the Craftsman M215.

4. Consider OEM vs. Aftermarket Parts

- Original Equipment Manufacturer (OEM) parts may be more expensive but are often more reliable. Aftermarket parts can be less costly but may vary in quality.

Conclusion

The Craftsman M215 parts diagram is an essential resource for anyone who owns this lawn mower. By understanding how to read and interpret the diagram, you can effectively maintain and troubleshoot your mower. Regular maintenance and quick identification of common issues will ensure that your Craftsman M215 continues to perform at its best. Whether you are a DIY enthusiast or someone looking for a quick fix, having this knowledge at your disposal will save you time and

effort in the long run.

Frequently Asked Questions

What is a Craftsman M215 parts diagram?

A Craftsman M215 parts diagram is a visual representation of the various components and parts of the Craftsman M215 lawn mower, helping users identify and locate specific parts for maintenance or replacement.

Where can I find the Craftsman M215 parts diagram?

The Craftsman M215 parts diagram can be found on the official Craftsman website, in the user manual, or through various online retailers and parts suppliers that sell Craftsman lawn mower parts.

Why is the Craftsman M215 parts diagram important?

The parts diagram is important because it helps users understand the mower's assembly, simplifies the process of ordering replacements, and assists in troubleshooting issues by identifying specific components.

How do I interpret the Craftsman M215 parts diagram?

To interpret the Craftsman M215 parts diagram, look for labeled parts, reference numbers, and corresponding descriptions, which will guide you in identifying each component and its function.

Can I order replacement parts using the Craftsman M215 parts diagram?

Yes, you can use the Craftsman M215 parts diagram to identify the exact parts you need and order them from authorized dealers or online parts suppliers.

What are common issues that might require consulting the Craftsman M215 parts diagram?

Common issues include engine problems, blade malfunctions, or starting difficulties, which may require specific parts to be replaced or repaired as indicated in the parts diagram.

Are there any specific tools needed to replace parts in the Craftsman M215?

Yes, basic tools such as wrenches, screwdrivers, and possibly a socket set are typically needed to replace parts in the Craftsman M215, as indicated in the parts diagram instructions.

Is there a difference between the Craftsman M215 parts

diagram and the owner's manual?

Yes, the parts diagram focuses specifically on the components and their arrangement, while the owner's manual provides broader operational instructions and maintenance tips.

How can I ensure I have the right parts for my Craftsman M215?

To ensure you have the right parts for your Craftsman M215, refer to the parts diagram for part numbers, consult your owner's manual, and verify compatibility with your specific mower model.

What should I do if I can't find the Craftsman M215 parts diagram?

If you can't find the Craftsman M215 parts diagram, contact Craftsman customer service, check online forums, or visit local repair shops that may have access to the necessary documentation.

Find other PDF article:

<https://soc.up.edu.ph/48-shade/Book?ID=QJY20-5662&title=principles-of-macroeconomics-7th-edition-mankiw.pdf>

Craftsman M215 Parts Diagram

Home | CRAFTSMAN®

Official website for CRAFTSMAN®. Explore power tools, outdoor equipment, hand tools, storage products and more.

Find A Retailer | CRAFTSMAN

Find a CRAFTSMAN® authorized provider near you and discover who sells CRAFTSMAN® tools online or in a retail store near you.

Shop Parts | CRAFTSMAN

Sometimes products wear down and need repair or maintenance. Fortunately, you have several options to fix your products with Craftsman Parts & Service.

Power Tools and Accessories | CRAFTSMAN

Browse high-performance power tools and accessories, including drivers, impacts, saws and more. Get the best quality for the job from Craftsman.

V20* 5.0AH Lithium Ion Battery | CRAFTSMAN

This V20* 5.0Ah Lithium Ion Battery is compatible with the CRAFTSMAN® V20* cordless power tool and outdoor tool lineup. The professional grade high performance cells provide improved ...

Home & Outdoor - Garden Tools, Mowers & More | CRAFTSMAN

When it comes to shaping up your yard, look no further than CRAFTSMAN® to find the right

equipment for you. Browse cordless and gas tools at CRAFTSMAN®. Take on large lawns ...

Shop All Mowers | CRAFTSMAN

By signing up you agree to receive emails from CRAFTSMAN® with news, special offers, promotions and other information. You can unsubscribe at any time. See our Privacy Policy or ...

Customer Support | CRAFTSMAN

Find out more information about CRAFTSMAN® tools, warranty, parts, service, and more with our customer support resources.

42 in. Gas Zero-Turn Riding Mower (Z3200) | CRAFTSMAN

Transform your yard and mow up to 3 times faster than a walk behind*. The high-performance 42 in. Gas Zero-Turn Riding Mower (Z3200) features a powerful 547cc single-cylinder engine ...

V20* System Cordless Power Tools | CRAFTSMAN

Explore the CRAFTSMAN® V20* System of cordless power tools and products. The V20* System has the battery power, range and reliability to get your projects done.

Home | CRAFTSMAN®

Official website for CRAFTSMAN®. Explore power tools, outdoor equipment, hand tools, storage products and more.

Find A Retailer | CRAFTSMAN

Find a CRAFTSMAN® authorized provider near you and discover who sells CRAFTSMAN® tools online or in a retail store near you.

Shop Parts | CRAFTSMAN

Sometimes products wear down and need repair or maintenance. Fortunately, you have several options to fix your products with Craftsman Parts & Service.

Power Tools and Accessories | CRAFTSMAN

Browse high-performance power tools and accessories, including drivers, impacts, saws and more. Get the best quality for the job from Craftsman.

V20* 5.0AH Lithium Ion Battery | CRAFTSMAN

This V20* 5.0Ah Lithium Ion Battery is compatible with the CRAFTSMAN® V20* cordless power tool and outdoor tool lineup. The professional grade high performance cells provide improved ...

Home & Outdoor - Garden Tools, Mowers & More | CRAFTSMAN

When it comes to shaping up your yard, look no further than CRAFTSMAN® to find the right equipment for you. Browse cordless and gas tools at CRAFTSMAN®. Take on large lawns ...

Shop All Mowers | CRAFTSMAN

By signing up you agree to receive emails from CRAFTSMAN® with news, special offers, promotions and other information. You can unsubscribe at any time. See our Privacy Policy or ...

Customer Support | CRAFTSMAN

Find out more information about CRAFTSMAN® tools, warranty, parts, service, and more with our customer support resources.

42 in. Gas Zero-Turn Riding Mower (Z3200) | CRAFTSMAN

Transform your yard and mow up to 3 times faster than a walk behind*. The high-performance 42 in. Gas Zero-Turn Riding Mower (Z3200) features a powerful 547cc single-cylinder engine ...

V20* System Cordless Power Tools | CRAFTSMAN

Explore the CRAFTSMAN® V20* System of cordless power tools and products. The V20* System has the battery power, range and reliability to get your projects done.

Explore our detailed Craftsman M215 parts diagram to easily identify and order the replacement components you need. Discover how to keep your mower running smoothly!

[Back to Home](#)