

Cub Cadet Z Force 48 Drive Belt Diagram

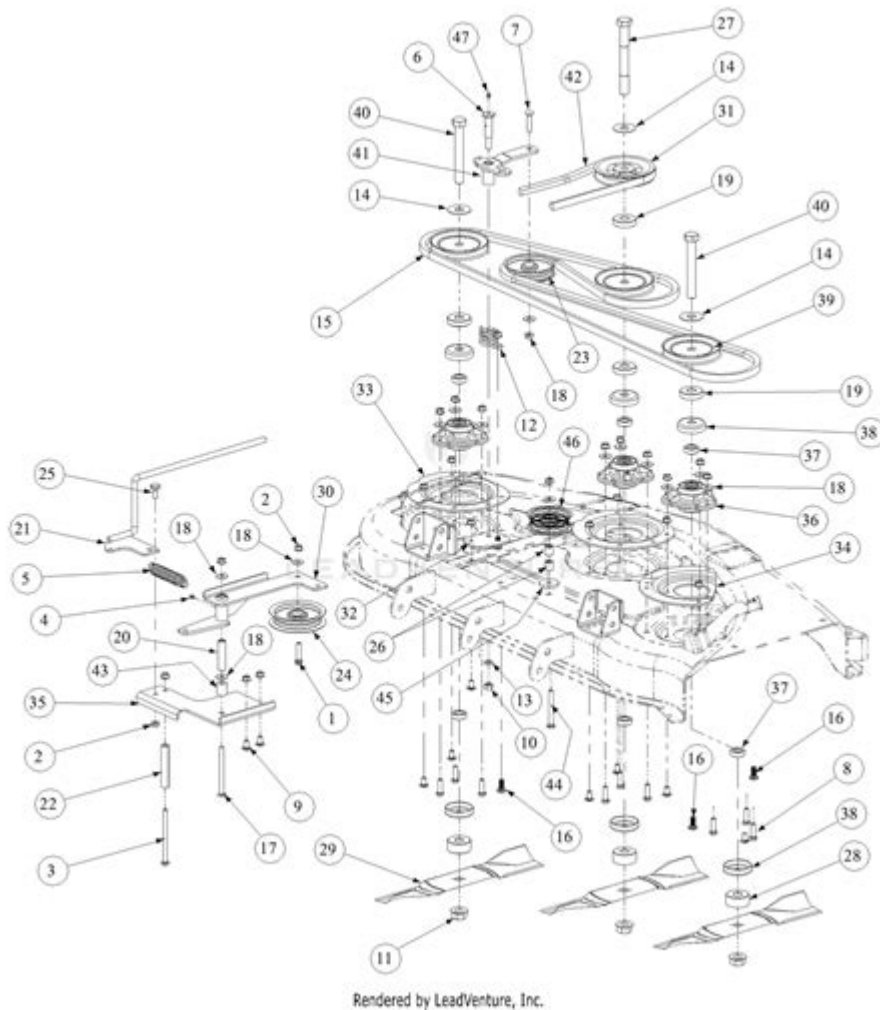

Cub Cadet Z Force 48 drive belt diagram is an essential component for maintaining the efficiency and performance of your Cub Cadet Z Force 48 lawn mower. Understanding how the drive belt operates and how to replace it can significantly extend the life of your mower and ensure a smooth, effective cutting experience. In this article, we will delve into the intricacies of the drive belt, its diagram, maintenance tips, and troubleshooting methods to ensure your Z Force 48 remains in peak condition.

Understanding the Drive Belt System

The drive belt in a lawn mower is a critical component that transfers power from the engine to the mower blades and wheels. In the case of the Cub Cadet Z Force 48, the drive belt system is designed to provide optimal performance and efficiency.

What is a Drive Belt?

A drive belt is typically made from durable rubber and is designed to withstand the wear and tear of continuous operation. It connects various components of the mower, including the engine, the transmission, and the mower blades, enabling them to work in unison.

Importance of the Drive Belt

The drive belt is crucial for several reasons:

1. **Power Transmission:** It effectively transfers power from the engine to the drive system.
2. **Control:** It allows for variable speed control, which is essential for adapting to different mowing conditions.
3. **Efficiency:** A well-maintained drive belt system can enhance fuel efficiency by ensuring that power is transmitted without unnecessary loss.

Components of the Drive Belt System

To understand the Cub Cadet Z Force 48 drive belt diagram, it's essential to recognize the various components involved in the system. Here are the primary components:

1. **Drive Belt:** The main belt that connects the engine to the drive system.
2. **Idler Pulley:** Helps maintain tension in the drive belt.
3. **Spindle Assembly:** Connects to the mower blades and receives power from the drive belt.
4. **Transmission:** Changes the speed and torque delivered to the wheels.
5. **Deck:** The housing that contains the mower blades.

Explaining the Diagram

The Cub Cadet Z Force 48 drive belt diagram provides a visual representation of how these components interact. It typically includes:

- The routing path of the drive belt.
- Locations of the idler pulley and spindle assembly.
- Directions for proper installation and tensioning.

Understanding this diagram is crucial for anyone looking to perform maintenance or repairs on their mower. It can often be found in the owner's manual or online on Cub Cadet's official website.

Steps to Replace the Drive Belt

Replacing the drive belt on your Cub Cadet Z Force 48 may seem daunting, but with a systematic

approach, it can be accomplished efficiently. Below are the steps you should follow:

Tools Needed

Before beginning, gather the following tools:

- Socket wrench set
- Screwdrivers (flathead and Phillips)
- Pliers
- Replacement drive belt
- Safety gloves
- Safety glasses

Step-by-Step Replacement Process

1. Safety First: Ensure the mower is on a flat surface, and disengage the spark plug to prevent accidental starting.

2. Remove the Deck:

- Use the socket wrench to remove the bolts securing the mower deck.
- Disconnect any electrical connections if applicable.
- Carefully lift the deck off the mower.

3. Locate the Old Drive Belt:

- Identify the routing path of the old drive belt using the diagram.
- Take note of how the belt is threaded around the pulleys.

4. Remove the Old Drive Belt:

- Release the tension on the idler pulley by using pliers to swing it away from the belt.
- Slide the old belt off the pulleys.

5. Install the New Drive Belt:

- Position the new belt according to the diagram.
- Ensure that the belt is correctly aligned with the pulleys.

6. Reapply Tension:

- Swing the idler pulley back into place to apply tension to the new belt.
- Double-check that the belt is properly seated on all pulleys.

7. Reattach the Deck:

- Align the deck back onto the mower.
- Secure it with the previously removed bolts and reconnect any electrical components.

8. Final Checks:

- Reconnect the spark plug.
- Start the mower to ensure the belt operates smoothly.

Maintenance Tips for the Drive Belt

Proper maintenance of your drive belt is crucial for the longevity and performance of your Cub Cadet Z Force 48. Consider the following tips:

1. Regular Inspections: Periodically check the drive belt for signs of wear, such as fraying or cracking.
2. Cleanliness: Keep the mower deck and surrounding areas clean to prevent debris from damaging the belt.
3. Tension Adjustments: Ensure that the belt maintains proper tension; a loose belt can slip, while a tight belt can lead to excessive wear.
4. Lubrication: Occasionally lubricate the pulleys and idler to reduce friction and wear.

Troubleshooting Common Drive Belt Issues

Even with proper maintenance, issues may arise with the drive belt system. Here are common problems and their solutions:

Signs of Drive Belt Problems

- Slipping: If the mower is not moving as it should, the drive belt may be slipping off the pulleys.
- Excessive Noise: Unusual squeaking or grinding noises can indicate a worn-out belt or misaligned components.
- Uneven Cutting: If the mower blades are not turning evenly, it could be due to a loose or damaged belt.

Solutions

1. Inspect for Wear: If you notice any signs of wear or damage, it may be time to replace the drive belt.
2. Check Alignment: Ensure that all components are properly aligned to prevent further issues.
3. Adjust Tension: If the belt appears loose, adjust the tensioner to tighten it appropriately.

Conclusion

In summary, the Cub Cadet Z Force 48 drive belt diagram is a crucial reference for anyone looking to maintain their mower effectively. By understanding the components of the drive belt system, following proper replacement procedures, and adhering to maintenance tips, you can ensure your mower operates at peak performance. Regular checks and timely replacements of the drive belt will help extend the life of your equipment, making your mowing experience smoother and more efficient. Whether you are a seasoned mower operator or a novice, knowledge of the drive belt system is invaluable for keeping your Cub Cadet Z Force 48 in top shape.

Frequently Asked Questions

What is the purpose of the drive belt in the Cub Cadet Z Force 48?

The drive belt in the Cub Cadet Z Force 48 transmits power from the engine to the transmission, allowing the mower to move and operate effectively.

Where can I find the drive belt diagram for the Cub Cadet Z Force 48?

The drive belt diagram for the Cub Cadet Z Force 48 can typically be found in the owner's manual, on the Cub Cadet website, or through online forums and repair guides.

How do I replace the drive belt on a Cub Cadet Z Force 48?

To replace the drive belt on a Cub Cadet Z Force 48, first, disconnect the battery, remove any covers obstructing access, note the belt routing using the diagram, replace the old belt with a new one, and reassemble the components.

What are common signs that the drive belt on a Cub Cadet Z Force 48 needs replacement?

Common signs include slipping, unusual noises, fraying, cracks in the belt, or if the mower fails to move forward or backward properly.

Can I use a generic drive belt for my Cub Cadet Z Force 48?

While generic drive belts may fit, it is recommended to use OEM (Original Equipment Manufacturer) belts to ensure optimal performance and longevity for your Cub Cadet Z Force 48.

Find other PDF article:

<https://soc.up.edu.ph/10-plan/Book?docid=lgp19-4347&title=bone-matrix-coloring-answer-key.pdf>

Cub Cadet Z Force 48 Drive Belt Diagram

cubcadet - 11/11/2024

Jul 13, 2024 · cubcadet CUB Cadet Z Force 48 1. CUB Cadet Z Force 48 Drive Belt Diagram ...

PSB CUB FAB SB OB 11/11/2024 ...

PSB CUB FAB SB OB 11/11/2024 PSB CUB FAB SB OB 11/11/2024

7 11/11/2024

HONDA Super Cub C125 [👉 ព័ត៌មានលម្អិត](#)

HONDA Super Cub C125 ឆ្នាំ 2019 ថ្លៃ 11 លានរៀល ប្រសិនបើលក់រួចហើយ Super Cub C125 ឆ្នាំ 1958 ថ្លៃ Super Cub C100 ប្រសិនបើលក់រួចហើយ ...

[លក់ម៉ូតូ N ឆ្នាំ Q R ប្រសិនបើលក់រួចហើយ? ព័ត៌មាន](#)

លក់ម៉ូតូ N ឆ្នាំ Q R ប្រសិនបើលក់រួចហើយ? N ឆ្នាំ 11 (ប្រសិនបើលក់រួចហើយ R ឆ្នាំ 11 Z ឆ្នាំ 11 Q ឆ្នាំ 11 Z* ឆ្នាំ 11 N* ប្រសិនបើលក់រួចហើយ ប្រសិនបើលក់រួចហើយ ...

លក់ម៉ូតូ HONDA X Hello Kitty ឆ្នាំ SUPER CUB 110

Mar 11, 2025 · ឆ្នាំ 2024 ថ្លៃ 50 លានរៀល HELLO KITTY ប្រសិនបើលក់រួចហើយ, ប្រសិនបើលក់រួចហើយ HONDA ថ្លៃ 50 លានរៀល HELLO KITTY ឆ្នាំ SUPER CUB 110 ; ប្រសិនបើលក់រួចហើយ ...

ប្រសិនបើលក់រួចហើយ $cu \cup b = cua \cap cub$ ប្រសិនបើលក់រួចហើយ ...

Mar 21, 2013 · ប្រសិនបើលក់រួចហើយ 3 លានរៀល 1 លានរៀល 2 លានរៀល ប្រសិនបើលក់រួចហើយ ប្រសិនបើលក់រួចហើយ a ឆ្នាំ 1 លានរៀល cua ឆ្នាំ a ប្រសិនបើលក់រួចហើយ ...

[wland ប្រសិនបើលក់រួចហើយ - ព័ត៌មាន](#)

Sep 6, 2024 · wland ប្រសិនបើលក់រួចហើយ Wland ប្រសិនបើលក់រួចហើយ 1. ** ប្រសិនបើលក់រួចហើយ ** ប្រសិនបើលក់រួចហើយ ...

[cub ប្រសិនបើលក់រួចហើយ - ព័ត៌មាន](#)

cub ប្រសិនបើលក់រួចហើយ CUB CENTER UTILITY BUILDING ប្រសិនបើលក់រួចហើយ ប្រសិនបើលក់រួចហើយ ប្រសិនបើលក់រួចហើយ ...

ប្រសិនបើលក់រួចហើយ **OEM** ប្រសិនបើលក់រួចហើយ **FOB** ប្រសិនបើលក់រួចហើយ **SKD** ប្រសិនបើលក់រួចហើយ **CKD** ប្រសិនបើលក់រួចហើយ

ប្រសិនបើលក់រួចហើយ OEM ប្រសិនបើលក់រួចហើយ FOB ប្រសិនបើលក់រួចហើយ SKD ប្រសិនបើលក់រួចហើយ CKD 1 លានរៀល OEM ប្រសិនបើលក់រួចហើយ ប្រសិនបើលក់រួចហើយ ប្រសិនបើលក់រួចហើយ ...

cub ប្រសិនបើលក់រួចហើយ (cub ប្រសិនបើលក់រួចហើយ) ប្រសិនបើលក់រួចហើយ

Apr 20, 2024 · cub ប្រសិនបើលក់រួចហើយ cub ប្រសិនបើលក់រួចហើយ B ប្រសិនបើលក់រួចហើយ B ប្រសិនបើលក់រួចហើយ CuB ប្រសិនបើលក់រួចហើយ U ប្រសិនបើលក់រួចហើយ B ប្រសិនបើលក់រួចហើយ A (CuB ប្រសិនបើលក់រួចហើយ AU (CuB), ប្រសិនបើលក់រួចហើយ B ...

cub ប្រសិនបើលក់រួចហើយ - ព័ត៌មាន

Jul 13, 2024 · cub ប្រសិនបើលក់រួចហើយ CUB ប្រសិនបើលក់រួចហើយ 1. CUB ប្រសិនបើលក់រួចហើយ ប្រសិនបើលក់រួចហើយ ប្រសិនបើលក់រួចហើយ ...

ប្រសិនបើលក់រួចហើយ PSB CUB FAB SB OB ប្រសិនបើលក់រួចហើយ ...

ប្រសិនបើលក់រួចហើយ PSB CUB FAB SB OB ប្រសិនបើលក់រួចហើយ PSB CUB FAB SB OB ប្រសិនបើលក់រួចហើយ ប្រសិនបើលក់រួចហើយ ប្រសិនបើលក់រួចហើយ 7 លានរៀល

HONDA Super Cub C125 [👉 ព័ត៌មានលម្អិត](#)

HONDA Super Cub C125 ឆ្នាំ 2019 ថ្លៃ 11 លានរៀល ប្រសិនបើលក់រួចហើយ Super Cub C125 ឆ្នាំ 1958 ថ្លៃ Super Cub C100 ប្រសិនបើលក់រួចហើយ ...

[លក់ម៉ូតូ N ឆ្នាំ Q R ប្រសិនបើលក់រួចហើយ? ព័ត៌មាន](#)

លក់ម៉ូតូ N ឆ្នាំ Q R ប្រសិនបើលក់រួចហើយ? N ឆ្នាំ 11 (ប្រសិនបើលក់រួចហើយ R ឆ្នាំ 11 Z ឆ្នាំ 11 Q ឆ្នាំ 11 Z* ឆ្នាំ 11 N* ប្រសិនបើលក់រួចហើយ ប្រសិនបើលក់រួចហើយ ...

លក់ម៉ូតូ HONDA X Hello Kitty ឆ្នាំ SUPER CUB 110

Mar 11, 2025 · ឆ្នាំ 2024 ថ្លៃ 50 លានរៀល HELLO KITTY ប្រសិនបើលក់រួចហើយ, ប្រសិនបើលក់រួចហើយ HONDA ថ្លៃ 50 លានរៀល HELLO KITTY ឆ្នាំ SUPER CUB 110 ; ប្រសិនបើលក់រួចហើយ ...

cu a ub = cua h cub ...
Mar 21, 2013 · 3 1 2 a 1 cua a
...

wland -
Sep 6, 2024 · wland Wland 1. **

cub -
cub CUB CENTER UTILITY BUILDING
...

OEM FOB SKD CKD _
OEM FOB SKD CKD 1 OEM
...

cub (cub)_
Apr 20, 2024 · cub cub B B CuB U B A (CuB
AU (CuB), ...

"Explore the Cub Cadet Z Force 48 drive belt diagram for easy maintenance and repairs. Discover how to optimize your mower's performance. Learn more now!"
[Back to Home](#)