

Coleman Evcon Furnace Manual 7655 856

Coleman 7600 Series Gas Furnace

HVACpartstore.com 605-229-2627

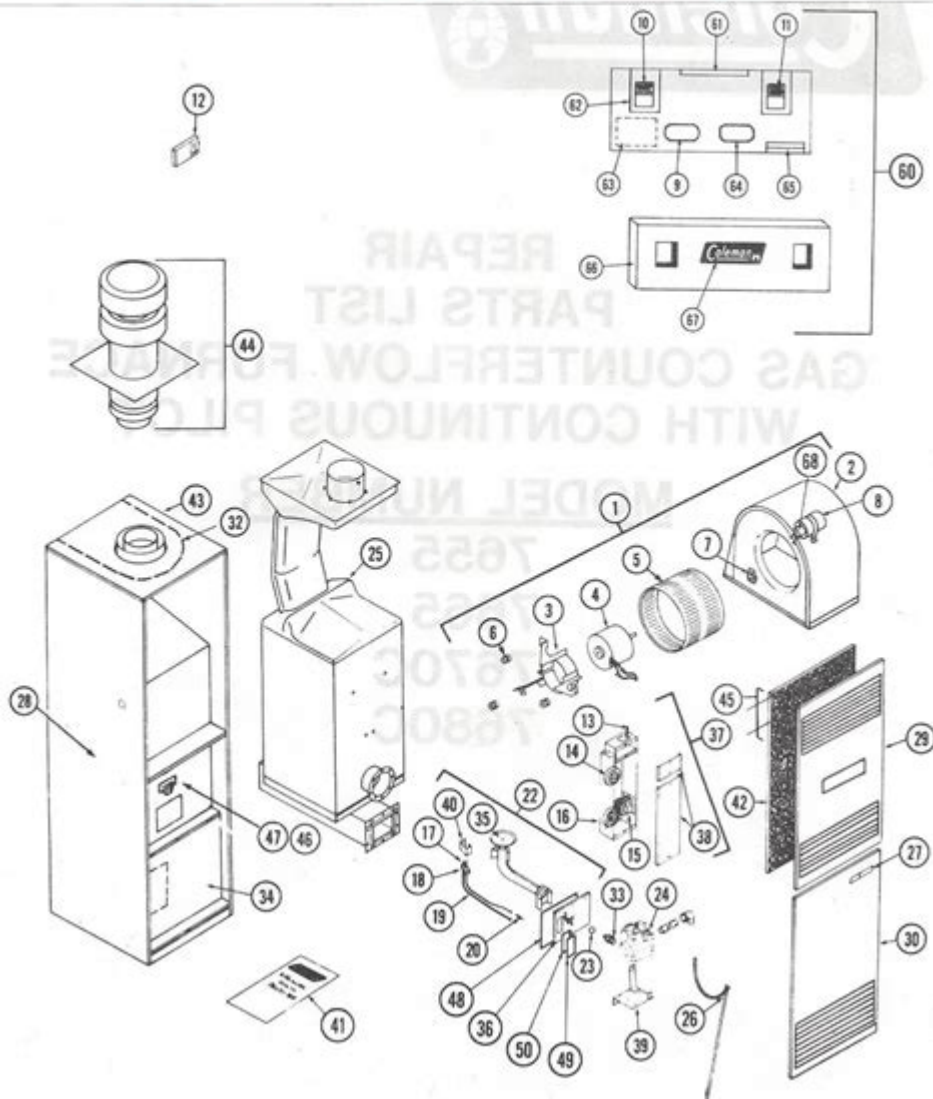

COLEMAN EVCON FURNACE MANUAL 7655 856 IS A CRUCIAL RESOURCE FOR HOMEOWNERS AND TECHNICIANS WHO WORK WITH COLEMAN EVCON HEATING SYSTEMS. THIS MANUAL PROVIDES DETAILED INSTRUCTIONS ON INSTALLATION, OPERATION, AND MAINTENANCE OF THE FURNACE, ENSURING THAT USERS CAN MAXIMIZE EFFICIENCY AND LONGEVITY WHILE MINIMIZING POTENTIAL ISSUES. IN THIS ARTICLE, WE WILL EXPLORE THE VARIOUS ASPECTS OF THE COLEMAN EVCON FURNACE MANUAL 7655 856, INCLUDING ITS FEATURES, TROUBLESHOOTING TIPS, MAINTENANCE GUIDELINES, AND FREQUENTLY ASKED QUESTIONS.

OVERVIEW OF COLEMAN EVCON FURNACES

COLEMAN EVCON IS A WELL-ESTABLISHED BRAND IN THE HVAC INDUSTRY, KNOWN FOR PRODUCING RELIABLE AND EFFICIENT HEATING AND COOLING SYSTEMS. THE COLEMAN EVCON FURNACE MODELS ARE DESIGNED TO PROVIDE OPTIMAL HEATING PERFORMANCE WHILE BEING ENERGY-EFFICIENT. THE 7655 856 MODEL IS ONE OF THEIR POPULAR OPTIONS, PARTICULARLY IN REGIONS THAT EXPERIENCE COLD WINTERS.

KEY FEATURES OF THE COLEMAN EVCON FURNACE 7655 856

THE COLEMAN EVCON 7655 856 FURNACE BOASTS SEVERAL NOTEWORTHY FEATURES:

- **HIGH EFFICIENCY:** THIS MODEL IS DESIGNED FOR MAXIMUM ENERGY EFFICIENCY, REDUCING OPERATING COSTS AND ENVIRONMENTAL IMPACT.
- **QUIET OPERATION:** WITH ADVANCED ENGINEERING, THE FURNACE OPERATES QUIETLY, MINIMIZING DISTURBANCES IN THE HOME.
- **DURABILITY:** BUILT WITH HIGH-QUALITY MATERIALS, THE 7655 856 IS DESIGNED TO WITHSTAND HARSH WEATHER CONDITIONS.
- **USER-FRIENDLY CONTROLS:** THE FURNACE COMES EQUIPPED WITH INTUITIVE CONTROLS, MAKING IT EASY FOR USERS TO ADJUST SETTINGS.
- **SAFETY FEATURES:** INCORPORATES SAFETY MECHANISMS, INCLUDING FLAME ROLLOUT SWITCHES AND LIMIT SWITCHES, TO PREVENT OVERHEATING AND ENSURE SAFE OPERATION.

INSTALLATION GUIDELINES

PROPER INSTALLATION IS CRUCIAL FOR THE OPTIMAL FUNCTIONING OF THE COLEMAN EVCON 7655 856 FURNACE. HERE ARE SOME KEY STEPS TO FOLLOW DURING INSTALLATION:

PREPARATION

1. **SELECT THE RIGHT LOCATION:** CHOOSE A LOCATION THAT ALLOWS FOR ADEQUATE AIRFLOW AND CLEARANCE FROM COMBUSTIBLE MATERIALS.
2. **GATHER NECESSARY TOOLS AND MATERIALS:** ENSURE YOU HAVE ALL NEEDED TOOLS, INCLUDING A SCREWDRIVER, WRENCH, AND PLIERS, AS WELL AS THE NECESSARY MATERIALS LIKE DUCTWORK AND VENTS.

INSTALLATION STEPS

1. **INSTALL THE BASE:** SECURE THE FURNACE ON A SOLID BASE THAT CAN SUPPORT ITS WEIGHT.
2. **CONNECT DUCTWORK:** ATTACH THE SUPPLY AND RETURN DUCTS, ENSURING AIRTIGHT CONNECTIONS TO MAXIMIZE EFFICIENCY.
3. **ELECTRICAL CONNECTIONS:** CONNECT THE ELECTRICAL WIRING ACCORDING TO THE WIRING DIAGRAMS PROVIDED IN THE MANUAL.
4. **GAS LINE CONNECTION:** IF APPLICABLE, CONNECT THE GAS LINE, ENSURING ALL CONNECTIONS ARE LEAK-FREE.
5. **VENTILATION:** INSTALL VENT PIPES AS PER THE MANUFACTURER'S SPECIFICATIONS TO ENSURE PROPER EXHAUST OF COMBUSTION GASES.

OPERATIONAL GUIDELINES

ONCE INSTALLED, OPERATING THE COLEMAN EVCON 7655 856 FURNACE IS STRAIGHTFORWARD. HERE ARE SOME OPERATIONAL GUIDELINES:

STARTING THE FURNACE

1. **THERMOSTAT SETTING:** SET THE THERMOSTAT TO YOUR DESIRED TEMPERATURE.
2. **POWER ON:** TURN ON THE POWER SUPPLY TO THE FURNACE.
3. **CHECK FOR GAS FLOW:** FOR GAS MODELS, ENSURE THAT THE GAS IS FLOWING CORRECTLY.
4. **IGNITION:** THE FURNACE SHOULD IGNITE AUTOMATICALLY. IF NOT, CONSULT THE TROUBLESHOOTING SECTION OF THE

ADJUSTING TEMPERATURE SETTINGS

- USE THE THERMOSTAT TO SET THE DESIRED TEMPERATURE.
- MONITOR ROOM TEMPERATURE AND ADJUST AS NEEDED FOR COMFORT.
- CONSIDER USING PROGRAMMABLE THERMOSTATS FOR ENERGY SAVINGS.

MAINTENANCE AND CARE

REGULAR MAINTENANCE IS VITAL TO KEEP THE COLEMAN EVCON 7655 856 FURNACE RUNNING EFFICIENTLY. HERE ARE SOME MAINTENANCE TASKS TO PERFORM:

FILTER REPLACEMENT

- CHECK THE AIR FILTER MONTHLY, ESPECIALLY DURING PERIODS OF HEAVY USE.
- REPLACE OR CLEAN THE FILTER EVERY 1-3 MONTHS TO ENSURE OPTIMAL AIRFLOW AND EFFICIENCY.

ANNUAL INSPECTION

1. PROFESSIONAL SERVICING: SCHEDULE AN ANNUAL INSPECTION BY A QUALIFIED HVAC TECHNICIAN.
2. INSPECT COMPONENTS: TECHNICIANS SHOULD CHECK THE HEAT EXCHANGER, BURNERS, AND ELECTRICAL CONNECTIONS FOR WEAR AND TEAR.

CLEANING THE FURNACE

- KEEP THE AREA AROUND THE FURNACE CLEAN AND FREE OF DEBRIS.
- VACUUM THE FURNACE CABINET PERIODICALLY TO REMOVE DUST AND DIRT.

TROUBLESHOOTING COMMON ISSUES

EVEN THE MOST RELIABLE FURNACES CAN EXPERIENCE ISSUES. HERE ARE COMMON PROBLEMS WITH THE COLEMAN EVCON 7655 856 AND THEIR SOLUTIONS:

FURNACE NOT IGNITING

- CHECK THERMOSTAT: ENSURE THE THERMOSTAT IS SET TO THE HEATING MODE AND THE DESIRED TEMPERATURE.
- INSPECT POWER SUPPLY: VERIFY THAT THE FURNACE IS RECEIVING POWER.
- EXAMINE GAS SUPPLY: FOR GAS MODELS, CHECK THE GAS SUPPLY TO ENSURE IT IS TURNED ON.

INADEQUATE HEATING

- DIRTY FILTERS: REPLACE OR CLEAN THE AIR FILTER AS DIRTY FILTERS CAN RESTRICT AIRFLOW.
- BLOCKED VENTS: ENSURE THAT SUPPLY AND RETURN VENTS ARE NOT OBSTRUCTED BY FURNITURE OR OTHER OBJECTS.
- DUCT LEAKS: INSPECT DUCTWORK FOR LEAKS AND SEAL ANY GAPS.

UNUSUAL NOISES

- RATTLING SOUNDS: CHECK FOR LOOSE COMPONENTS AND TIGHTEN AS NECESSARY.
- SQUEALING NOISES: THIS MAY INDICATE WORN FAN BELTS OR BEARINGS THAT NEED LUBRICATION OR REPLACEMENT.

FREQUENTLY ASKED QUESTIONS

WHAT IS THE WARRANTY ON THE COLEMAN EVCON 7655 856 FURNACE?

THE WARRANTY TYPICALLY COVERS PARTS FOR A SPECIFIED PERIOD, OFTEN 10 YEARS. CHECK THE WARRANTY DOCUMENTS FOR SPECIFIC DETAILS.

CAN I INSTALL THE FURNACE MYSELF?

WHILE SOME HOMEOWNERS MAY ATTEMPT DIY INSTALLATION, IT IS HIGHLY RECOMMENDED TO HIRE A LICENSED HVAC TECHNICIAN TO ENSURE SAFETY AND COMPLIANCE WITH LOCAL CODES.

HOW CAN I IMPROVE THE EFFICIENCY OF MY FURNACE?

- REGULAR MAINTENANCE, INCLUDING FILTER CHANGES AND DUCT SEALING.
- INSTALL A PROGRAMMABLE THERMOSTAT TO OPTIMIZE HEATING SCHEDULES.
- ENSURE PROPER INSULATION IN YOUR HOME TO REDUCE HEAT LOSS.

WHEN SHOULD I REPLACE MY FURNACE?

CONSIDER REPLACING YOUR FURNACE IF IT IS OVER 15-20 YEARS OLD, REQUIRES FREQUENT REPAIRS, OR IS INEFFICIENT COMPARED TO NEWER MODELS.

CONCLUSION

THE COLEMAN EVCON FURNACE MANUAL 7655 856 IS AN ESSENTIAL TOOL FOR ANYONE INVOLVED WITH THIS FURNACE MODEL. BY FOLLOWING THE GUIDELINES FOR INSTALLATION, OPERATION, MAINTENANCE, AND TROUBLESHOOTING, USERS CAN ENSURE THEIR FURNACE OPERATES EFFICIENTLY AND SAFELY. REGULAR CARE AND PROMPT ATTENTION TO ANY ISSUES WILL HELP EXTEND THE LIFE OF THE FURNACE AND MAINTAIN A COMFORTABLE INDOOR ENVIRONMENT. ALWAYS REFER TO THE MANUAL FOR SPECIFIC INSTRUCTIONS AND CONSULT A PROFESSIONAL WHEN IN DOUBT.

FREQUENTLY ASKED QUESTIONS

WHAT IS THE PURPOSE OF THE COLEMAN EVCON FURNACE MANUAL 7655 856?

THE COLEMAN EVCON FURNACE MANUAL 7655 856 PROVIDES ESSENTIAL INFORMATION FOR INSTALLATION, OPERATION, AND MAINTENANCE OF THE FURNACE MODEL, ENSURING OPTIMAL PERFORMANCE AND SAFETY.

WHERE CAN I FIND A DIGITAL COPY OF THE COLEMAN EVCON FURNACE MANUAL 7655 856?

YOU CAN OFTEN FIND A DIGITAL COPY OF THE COLEMAN EVCON FURNACE MANUAL 7655 856 ON THE OFFICIAL COLEMAN WEBSITE OR THROUGH HVAC SERVICE PROVIDER WEBSITES THAT OFFER DOWNLOADABLE MANUALS.

WHAT ARE THE COMMON TROUBLESHOOTING STEPS OUTLINED IN THE COLEMAN EVCON FURNACE MANUAL 7655 856?

COMMON TROUBLESHOOTING STEPS INCLUDE CHECKING THE THERMOSTAT SETTINGS, ENSURING THE POWER SUPPLY IS CONNECTED, INSPECTING FOR GAS LEAKS, AND CLEANING OR REPLACING THE AIR FILTERS.

WHAT TYPE OF MAINTENANCE IS RECOMMENDED IN THE COLEMAN EVCON FURNACE MANUAL 7655 856?

THE MANUAL RECOMMENDS REGULAR MAINTENANCE SUCH AS CHANGING AIR FILTERS, INSPECTING THE BLOWER MOTOR, CHECKING THE IGNITION SYSTEM, AND CLEANING THE FURNACE COMPONENTS TO ENSURE EFFICIENT OPERATION.

HOW DO I RESET MY COLEMAN EVCON FURNACE ACCORDING TO THE MANUAL 7655 856?

TO RESET YOUR COLEMAN EVCON FURNACE, TURN OFF THE POWER TO THE UNIT, WAIT FOR A FEW MINUTES, THEN TURN THE POWER BACK ON. THIS PROCESS MAY VARY, SO REFER TO THE SPECIFIC RESET INSTRUCTIONS IN THE MANUAL.

WHAT SAFETY PRECAUTIONS ARE MENTIONED IN THE COLEMAN EVCON FURNACE MANUAL 7655 856?

SAFETY PRECAUTIONS INCLUDE ENSURING PROPER VENTILATION, CHECKING FOR GAS LEAKS, USING THE FURNACE ONLY FOR ITS INTENDED PURPOSE, AND HAVING A QUALIFIED TECHNICIAN PERFORM REPAIRS.

CAN I INSTALL THE COLEMAN EVCON FURNACE MYSELF, ACCORDING TO THE MANUAL 7655 856?

WHILE THE MANUAL PROVIDES INSTALLATION INSTRUCTIONS, IT IS HIGHLY RECOMMENDED TO HAVE A QUALIFIED HVAC TECHNICIAN PERFORM THE INSTALLATION TO ENSURE SAFETY AND COMPLIANCE WITH LOCAL CODES.

WHAT ARE THE WARRANTY DETAILS FOR THE COLEMAN EVCON FURNACE AS PER MANUAL 7655 856?

THE WARRANTY DETAILS CAN VARY, BUT TYPICALLY INCLUDE A LIMITED WARRANTY ON PARTS FOR A SPECIFIC NUMBER OF YEARS. IT'S BEST TO CHECK THE MANUAL FOR THE EXACT TERMS AND CONDITIONS.

WHAT SHOULD I DO IF MY COLEMAN EVCON FURNACE IS MAKING UNUSUAL NOISES, BASED ON THE MANUAL 7655 856?

IF YOU'RE HEARING UNUSUAL NOISES, THE MANUAL SUGGESTS CHECKING FOR LOOSE COMPONENTS, ENSURING THE BLOWER MOTOR IS FUNCTIONING PROPERLY, AND CONTACTING A PROFESSIONAL IF THE ISSUE PERSISTS.

Find other PDF article:

<https://soc.up.edu.ph/24-mark/Book?trackid=Nqn14-3663&title=genki-workbook-answer-key-3rd-edition.pdf>

Coleman Evcon Furnace Manual 7655 856

2023 Kia K5 GT-Line Exhaust? : r/KiaK5 - Reddit

Sep 15, 2023 · 2023 Kia K5 GT-Line Exhaust? I'm interested in having an exhaust system on my K5 but I've noticed that my exhaust ports aren't even real exhausts lol. I was just wondering if ...

2025 EX or GT-line? : r/KiaK5 - Reddit

May 31, 2024 · A subreddit dedicated to the Kia K5/Optima sedan sold around the world

Kia K5 owners, what are your opinions on the car so far? : r/kia

Jan 20, 2021 · Hi Jakebass, I just purchased my Kia K5 GT-Line 2 days ago, same color, wolf grey + red interior, although mine is the AWD (2021). I'm having an issue trying to figure out ...

My underbody cover is falling apart and Kia wants \$600+ to

On my 22 GT line, I lost the liner for the rear axle somehow. And the lip on the front splitter, the black matte one you can barely see but will get caught on every curb known to man. I ripped off ...

GT Owners / tire recommendation : r/KiaK5 - Reddit

Sep 8, 2023 · trueA subreddit dedicated to the Kia K5/Optima sedan sold around the world

Anyone go for a Kia K5 EX instead of the Gt-Line? : r/kia - Reddit

The Gt-Line looks a little aggressive for my taste. I think the EX kind of tones down the rice factor and the interior feels more premium.

Is a Kia K5 Reliable? : r/kia - Reddit

Is a Kia K5 Reliable? I am coming from Honda's and Toyota's but looking to get something that is a bit cheaper than them. The K5 looks good but are they reliable?

Display Gauges on 2025 screen? : r/KiaK5 - Reddit

Display Gauges on 2025 screen? I've been highly considering purchasing a 2025 Kia K5 GT-Line, but one thing that really bothered me is that the speedometer and (realllly bothers me) the ...

2025 Kia K5 accessories : r/kia - Reddit

Jun 24, 2024 · Been trying to look for accessories for my new 2025 K5 GT-Line. Been looking on Amazon and really haven't found anything. Been looking for Mud Guards, all weather floor ...

Thoughts on the 2025 Model? : r/KiaK5 - Reddit

Thoughts on the 2025 Model? So I've been really looking into the 2024 K5 GT with the GT1 Package, I'm currently working on saving up a sizable down payment, I'd like to have around ...

E-cliente Occident - Portal digital para clientes

Conoce E-cliente, el portal para clientes de Occident en el que podrás gestionar y operar con tus seguros online.

Occident - Tu nueva compañía de seguros

Occident es la unión de Seguros Catalana Occidente, Plus Ultra Seguros y Seguros Bilbao. Con una gran implantación, es uno de los líderes del sector asegurador en España.

E-Cliente - Occident

Accede a E-Cliente de Occident para gestionar tus seguros y realizar trámites desde cualquier lugar.

Atención al cliente y teléfono - Occident

Contacta con Occident. Nuestro teléfono de atención al cliente, teléfono para asistencia en carretera y para declaración de siniestros.

Cuadro médico - Seguro salud | Occident

Con el seguro de salud Occident tienes acceso a un cuadro médico completo. Encuentra en tu comunidad el médico y la atención sanitaria que necesitas.

GCO E-cliente - Occident

Accede a E-Cliente de Occident para gestionar tus seguros y realizar trámites estés donde estés.

Profesionales médicos Occident

Si anteriormente estabas en el cuadro médico de Cosalud, también formas parte del cuadro médico de Occident. Si tienes dudas, puedes realizarnos cualquier consulta a través de este ...

Cuadro médico y dental Bienestar y salud - Occident

Accede al cuadro médico, dental y de servicios de bienestar del servicio Bienestar y salud de las pólizas de Occident.

Seguros de Salud - Información y precios | Occident

Occident te ofrece diferentes modalidades de seguros de salud con completas coberturas a través de su cuadro médico incorporando centros especializados en el cuidado personal y ...

GCO E-cliente

Acceso para clientes de Occident. Todas tus gestiones estés donde estés en E-Cliente

Find the complete Coleman Evcon furnace manual 7655 856 here. Get essential tips for installation

[Back to Home](#)