

Briggs And Stratton Ls45 Manual

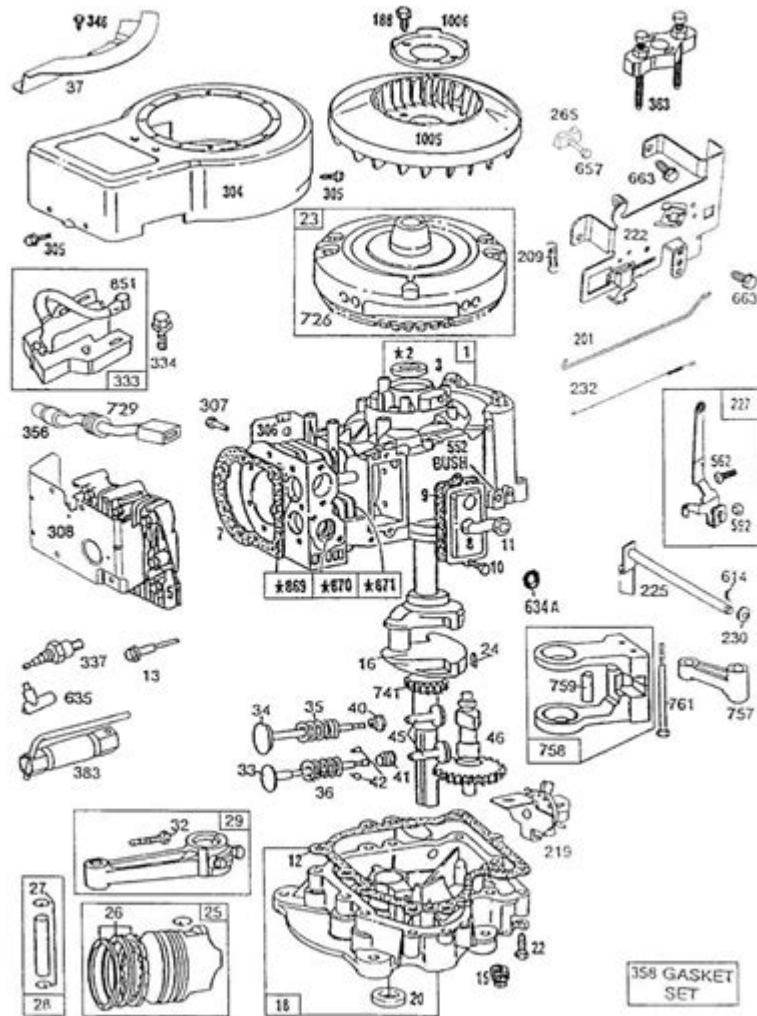

3/02

Briggs and Stratton LS45 Manual is an essential resource for anyone who owns or operates equipment powered by the LS45 engine from Briggs & Stratton. This comprehensive guide provides valuable insights into the engine's specifications, maintenance schedules, troubleshooting tips, and much more. Having access to the LS45 manual can greatly enhance the longevity and performance of your engine, ensuring that it runs smoothly for years to come. In this article, we will delve into the various aspects of the Briggs and Stratton LS45 manual, helping you make the most of your engine.

Understanding the Briggs and Stratton LS45 Engine

The Briggs and Stratton LS45 engine is a popular choice for many outdoor power equipment applications, including lawn mowers, pressure washers, and generators. Known for its durability and reliability, the LS45 engine is designed to provide optimal performance while requiring minimal

maintenance.

Specifications of the LS45 Engine

Before diving into the manual, it's crucial to understand the key specifications of the LS45 engine:

- Engine Type: Air-cooled, four-stroke engine
- Displacement: 4.5 horsepower
- Fuel Type: Unleaded gasoline
- Oil Capacity: 20 ounces
- Starting System: Recoil start

These specifications lay the foundation for understanding how to properly operate and maintain your LS45 engine.

Accessing the LS45 Manual

Obtaining a copy of the Briggs and Stratton LS45 manual is straightforward. It can be accessed in several ways:

1. Online Download: Visit the official Briggs and Stratton website to download a PDF version of the LS45 manual. This is often the most convenient option.
2. Retail Outlets: Many authorized dealers and retailers may have printed versions of the manual available for purchase.
3. Customer Support: If you encounter difficulties finding the manual, Briggs and Stratton's customer support can assist you in obtaining a copy.

Contents of the LS45 Manual

The LS45 manual is structured to provide all necessary information in an organized manner. Key sections include:

- Safety Information: Guidelines to ensure safe operation.
- Operating Instructions: Step-by-step instructions for starting and stopping the engine.
- Maintenance Guidelines: Recommended maintenance tasks and schedules to keep the engine in peak condition.
- Troubleshooting: Common issues and solutions to help users diagnose and fix problems.
- Parts List: A comprehensive list of parts for easy ordering and replacement.

Importance of Regular Maintenance

Regular maintenance is vital for extending the life of your Briggs and Stratton LS45 engine. The manual outlines a maintenance schedule that should be followed rigorously.

Key Maintenance Tasks

Here are some critical maintenance tasks recommended in the LS45 manual:

- Oil Changes:
 - Frequency: Every 50 hours of operation or at least once a season.
 - Type: Use high-quality detergent oil with a viscosity rating of SAE 30.
- Air Filter Cleaning:
 - Frequency: Every 25 hours of operation.
 - Method: Remove the air filter and clean it with mild detergent and water. Ensure it is thoroughly dried before reinstalling.
- Spark Plug Replacement:
 - Frequency: Every 100 hours of operation.
 - Tip: Use the recommended spark plug type as specified in the manual.
- Fuel System Maintenance:
 - Ensure that the fuel is fresh and free of contaminants.
 - Drain the fuel system if the engine will not be used for an extended period.

Troubleshooting Common Issues

Despite best efforts in maintenance, problems can still arise with the LS45 engine. The manual offers troubleshooting tips for some common issues:

Engine Won't Start

If your LS45 engine fails to start, consider the following steps:

1. Check Fuel Level: Ensure there is adequate fuel in the tank.
2. Inspect the Spark Plug: Remove the spark plug and check for wear or carbon buildup.
3. Examine the Air Filter: A clogged air filter can restrict airflow, affecting engine performance.

Engine Runs Rough

If the engine starts but runs roughly, try these troubleshooting techniques:

1. Clean or Replace the Air Filter: A dirty air filter can lead to poor engine performance.
2. Inspect Fuel Quality: Stale or contaminated fuel can cause rough running.
3. Check for Leaks: Look for fuel or oil leaks that could affect performance.

Conclusion

In summary, the **Briggs and Stratton LS45 manual** serves as an indispensable guide for anyone operating this robust engine. By following the operating instructions, maintenance schedules, and troubleshooting advice outlined in the manual, users can ensure their LS45 engine remains reliable and efficient. Whether you're a novice or an experienced operator, the LS45 manual equips you with the knowledge necessary to get the most out of your engine. Make it a point to keep this manual handy, as it will inevitably prove to be a valuable tool in your outdoor equipment maintenance arsenal.

Frequently Asked Questions

What is the purpose of the Briggs and Stratton LS45 manual?

The Briggs and Stratton LS45 manual provides essential information on the operation, maintenance, troubleshooting, and parts of the LS45 engine, ensuring optimal performance and longevity.

Where can I find a digital copy of the Briggs and Stratton LS45 manual?

A digital copy of the Briggs and Stratton LS45 manual can often be found on the official Briggs and Stratton website, or through authorized dealers and service centers.

What are the key maintenance tips outlined in the LS45 manual?

Key maintenance tips in the LS45 manual include regular oil changes, air filter cleaning or replacement, spark plug inspection, and ensuring all components are free of dirt and debris.

How do I troubleshoot common issues using the LS45 manual?

The LS45 manual includes a troubleshooting section that guides users through common problems, providing step-by-step instructions to diagnose issues related to starting, performance, and fuel supply.

Is it necessary to follow the LS45 manual for warranty coverage?

Yes, following the guidelines and maintenance schedule outlined in the LS45 manual is often necessary to maintain warranty coverage and ensure any repairs are covered.

Find other PDF article:

<https://soc.up.edu.ph/16-news/pdf?docid=qmP30-1699&title=danger-to-society-meaning.pdf>

Briggs And Stratton Ls45 Manual

French Product Registration | Briggs & Stratton

Register your Briggs & Stratton product to get faster and more efficient customer service for repair and parts.

Google Sitemap - briggsandstratton.ca

Find the right spark plug and gap for engine | Briggs & Stratton Troubleshooting small engine problems | Briggs & Stratton How to Clean a Carburetor? | Briggs & Stratton How to test and repair ignition system problems? | Briggs & Stratton What is the best fuel type for lawn mowers and small engines? | Briggs & Stratton

www.briggsandstratton.ca

Briggs Engine Series Elite Running Watts* 16 Volts 849 Running Amps 246 Surge Amps 564 Engine Displacement (cc) 56 OHV Engine true Fuel Tank Capacity (gal) 656 Oil Capacity (oz) 18.00 RPM / Hz 4500/60f Run Time 56 Alternator Included Start Type Choke Low Oil Shutdown Yes Automatic Idle Control Included Muffler Included Fuel Gauge 549 Hour ...

Small Engines and Lawn Mower Parts | Briggs & Stratton

Learn more about small engines and shop for Briggs engine parts, generators & outdoor power products.

Accessibility Statement

Briggs and Stratton has invested a significant amount of resources to help ensure that its website is made easier to use and more accessible for people with disabilities, with the strong belief that every person has the right to live with dignity, equality, comfort and independence.

FAQ & Safety Tips | Briggs & Stratton

Lawn mower or snow blower won't start? Use this Briggs & Stratton small engine repair guide for troubleshooting common problems & issues with small engines. [Read More](#)

Snow Blowers | Briggs & Stratton

Get outside and power through the cold quickly and effortlessly with a Briggs & Stratton® Snow Blower. With many models and features to choose from, you'll be equipped to take on Mother ...

Search - briggsandstratton.ca

Narrow your results to the desired language. All Languages All LanguagesAlbanianArabicAzerbaijaniBulgarianBurmeseChineseChinese ...

Please select your language - briggsandstratton.ca

Thank you for registering your Briggs & Stratton product (s). Click the buttons below to download or email a copy of your registration form.

Sélectionnez votre langue - briggsandstratton.ca

Renseignements pour les consommateurs * Indicates a required field Civilite Please Select Dr. M. Mlle. Mme. Rev. Prénom Nom de famille Rue Pays Province Please Select Alsace Aquitaine Auvergne Basse-Normandie Bourgogne Bretagne Centre Champagne-Ardenne Corse Franche-Comte Haute-Normandie Ile-de-France Languedoc-Roussillon Limousin Lorraine Midi ...

[French Product Registration | Briggs & Stratton](#)

Register your Briggs & Stratton product to get faster and more efficient customer service for repair and parts.

Google Sitemap - [briggsandstratton.ca](#)

Find the right spark plug and gap for engine | Briggs & Stratton Troubleshooting small engine problems | Briggs & Stratton How to Clean a Carburetor? | Briggs & Stratton How to test and repair ignition system problems? | Briggs & Stratton What is the best fuel type for lawn mowers and small engines? | Briggs & Stratton

[www.briggsandstratton.ca](#)

Briggs Engine Series Elite Running Watts* 16 Volts 849 Running Amps 246 Surge Amps 564 Engine Displacement (cc) 56 OHV Engine true Fuel Tank Capacity (gal) 656 Oil Capacity (oz) 18.00 RPM / Hz 4500/60f Run Time 56 Alternator Included Start Type Choke Low Oil Shutdown Yes Automatic Idle Control Included Muffler Included Fuel Gauge 549 Hour ...

[Small Engines and Lawn Mower Parts | Briggs & Stratton](#)

Learn more about small engines and shop for Briggs engine parts, generators & outdoor power products.

Accessibility Statement

Briggs and Stratton has invested a significant amount of resources to help ensure that its website is made easier to use and more accessible for people with disabilities, with the strong belief that every person has the right to live with dignity, equality, comfort and independence.

FAQ & Safety Tips | Briggs & Stratton

Lawn mower or snow blower won't start? Use this Briggs & Stratton small engine repair guide for troubleshooting common problems & issues with small engines. [Read More](#)

Snow Blowers | Briggs & Stratton

Get outside and power through the cold quickly and effortlessly with a Briggs & Stratton® Snow Blower. With many models and features to choose from, you'll be equipped to take on Mother ...

Search - [briggsandstratton.ca](#)

Narrow your results to the desired language. All Languages All LanguagesAlbanianArabicAzerbaijaniBulgarianBurmeseChineseChinese ...

Please select your language - [briggsandstratton.ca](#)

Thank you for registering your Briggs & Stratton product (s). Click the buttons below to download or email a copy of your registration form.

Sélectionnez votre langue - [briggsandstratton.ca](#)

Renseignements pour les consommateurs * Indicates a required field Civilite Please Select Dr. M. Mlle. Mme. Rev. Prénom Nom de famille Rue Pays Province Please Select Alsace Aquitaine Auvergne Basse-Normandie Bourgogne Bretagne Centre Champagne-Ardenne Corse Franche-Comte Haute-Normandie Ile-de-France Languedoc-Roussillon Limousin Lorraine Midi ...

Unlock the full potential of your engine with the Briggs and Stratton LS45 manual. Discover essential tips and maintenance advice. [Learn more now!](#)

[Back to Home](#)