

Briggs And Stratton 80232 Manual

GENERAC®
Portable Products

3000PSI

Pressure Washer Owner's Manual

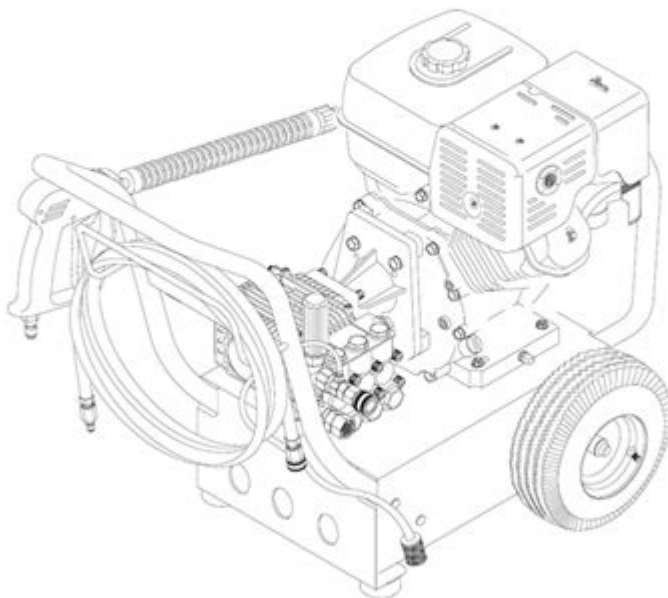

Generac Portable Products is a licensed trademark of Briggs & Stratton Power Products.

Questions? Help is just a moment away!

Call: Generac Pressure Washer Helpline - 1-800-270-1408 M-F 8-5 CT

Web: www.generac-portables.com

Model No. 1418-2 (3,000 PSI Pressure Washer) Manual No. 191658GS Revision I (03/05/2003)



Briggs and Stratton 80232 manual is an essential resource for anyone using or maintaining equipment powered by Briggs and Stratton engines. This manual provides detailed information on engine specifications, maintenance procedures, troubleshooting, and safety instructions. Understanding how to navigate this manual can help ensure the longevity and performance of your equipment. In this article, we will explore the key components of the Briggs and Stratton 80232 manual and highlight how to effectively utilize it for optimal engine care.

Overview of Briggs and Stratton

Briggs and Stratton is a well-known manufacturer of small engines, primarily used in lawn mowers, pressure washers, and other outdoor power equipment. Founded in 1908, the company has built a reputation for producing reliable, high-quality engines that are designed for ease of use and

maintenance. The 80232 model is one of the many manuals provided by Briggs and Stratton, specifically tailored to guide users in the upkeep and troubleshooting of their engines.

Importance of the Briggs and Stratton 80232 Manual

The Briggs and Stratton 80232 manual serves several important functions:

- **Maintenance Guidance:** It offers detailed instructions on how to maintain your engine, including oil changes, air filter replacements, and spark plug checks.
- **Troubleshooting Support:** The manual provides a troubleshooting section to help identify and resolve common problems.
- **Safety Information:** It outlines essential safety precautions to take while operating the engine to prevent accidents and injuries.
- **Part Specifications:** The manual includes information on parts and accessories, making it easier to find replacements when needed.

By familiarizing yourself with the contents of the 80232 manual, you can ensure that your Briggs and Stratton engine operates efficiently and effectively.

Contents of the Briggs and Stratton 80232 Manual

The 80232 manual is structured to provide users with easy access to the information they need. Here are some of the key sections typically included:

1. Engine Specifications

This section provides essential details about the engine, including:

- Engine model and type
- Horsepower rating
- Fuel type and capacity
- Oil type and capacity
- Dimensions and weight

Understanding these specifications helps users select the right fuel and oil, which is crucial for maintaining engine performance.

2. Safety Precautions

Safety is a top priority when operating any engine. The manual outlines important safety measures, such as:

- Always wear appropriate personal protective equipment (PPE).
- Keep hands and feet away from moving parts.
- Ensure the engine is off and cool before performing maintenance.
- Store fuel in a safe location away from ignition sources.

By following these safety precautions, users can minimize the risk of accidents and injuries while using their equipment.

3. Maintenance Procedures

Regular maintenance is vital for the longevity of your engine. The manual provides a comprehensive maintenance schedule, including:

1. **Daily Maintenance:** Check oil level, inspect air filter, and clean debris from the engine.
2. **Weekly Maintenance:** Change the oil and clean or replace the spark plug as needed.
3. **Seasonal Maintenance:** Perform a thorough inspection before and after the operating season, including checking fuel lines and battery connections.

Detailed step-by-step instructions for each task ensure that users can perform maintenance correctly, preventing costly repairs down the line.

4. Troubleshooting Guide

Even the best engines can encounter problems from time to time. The troubleshooting section provides solutions for common issues, such as:

- Engine won't start
- Rough idling
- Excessive smoke
- Loss of power

For each issue, the manual outlines potential causes and offers step-by-step instructions for resolving the problem, making it easier to get your engine back in working order.

5. Parts and Accessories

The 80232 manual includes a list of parts and accessories compatible with your engine. This section is invaluable when it comes time to replace worn or damaged components. It typically includes:

- Recommended oil and fuel filters
- Spark plugs
- Air filters
- Belts and blades (for lawn mowers)

By using the correct parts, you can ensure that your engine continues to perform at its best.

How to Access the Briggs and Stratton 80232 Manual

The Briggs and Stratton 80232 manual can be accessed in several ways:

- **Online:** The manual is available as a downloadable PDF from the official Briggs and Stratton website. This allows users to easily access the information on their computers or mobile devices.
- **Printed Copy:** If you prefer a physical copy, many hardware stores and equipment retailers offer printed versions of the manual.
- **Customer Service:** For those who have difficulty locating the manual, Briggs and Stratton's customer service can assist in providing the correct documentation.

Having access to the manual in either digital or print form ensures that users can refer to it whenever necessary.

Conclusion

In conclusion, the **Briggs and Stratton 80232 manual** is an indispensable tool for anyone who owns or operates equipment with a Briggs and Stratton engine. By providing detailed information on engine specifications, maintenance, troubleshooting, and safety, the manual helps users maximize the performance and longevity of their engines. Whether you are a seasoned professional or a first-time user, familiarizing yourself with the contents of the 80232 manual will empower you to care for your equipment effectively. Always remember to consult the manual before performing any maintenance or troubleshooting, and you'll be well on your way to ensuring your engine runs smoothly for years to come.

Frequently Asked Questions

What type of engines does the Briggs and Stratton 80232 manual cover?

The Briggs and Stratton 80232 manual covers a range of small engines typically found in lawn mowers, generators, and other outdoor power equipment.

Where can I find the Briggs and Stratton 80232 manual?

The Briggs and Stratton 80232 manual can be found on the official Briggs and Stratton website, in the support section, or through authorized dealers and distributors.

What are the key maintenance tips included in the Briggs and Stratton 80232 manual?

Key maintenance tips include regular oil changes, air filter cleaning or replacement, spark plug inspection, and ensuring the fuel system is clean and functional.

Is the Briggs and Stratton 80232 manual available in digital format?

Yes, the Briggs and Stratton 80232 manual is available in digital format as a PDF file for easy access and download from the official website.

What troubleshooting information can I find in the Briggs and Stratton 80232 manual?

The manual provides troubleshooting guidelines for common issues such as engine starting problems, poor performance, and maintenance-related concerns.

Does the Briggs and Stratton 80232 manual include safety recommendations?

Yes, the manual includes important safety recommendations to follow while operating and maintaining the engines to ensure user safety and prevent accidents.

Find other PDF article:

<https://soc.up.edu.ph/19-theme/Book?docid=Eer14-9104&title=eharmony-questions-and-answers.pdf>

Briggs And Stratton 80232 Manual

Register your Briggs & Stratton product to get faster and more efficient customer service for repair and parts.

[Google Sitemap - briggsandstratton.ca](#)

Find the right spark plug and gap for engine | Briggs & Stratton Troubleshooting small engine problems | Briggs & Stratton How to Clean a Carburetor? | Briggs & Stratton How to test and ...

www.briggsandstratton.ca

Briggs Engine Series Elite Running Watts* 16 Volts 849 Running Amps 246 Surge Amps 564 Engine Displacement (cc) 56 OHV Engine true Fuel Tank Capacity (gal) 656 Oil Capacity (oz) ...

Small Engines and Lawn Mower Parts | Briggs & Stratton

Learn more about small engines and shop for Briggs engine parts, generators & outdoor power products.

Accessibility Statement

Briggs and Stratton has invested a significant amount of resources to help ensure that its website is made easier to use and more accessible for people with disabilities, with the strong belief ...

FAQ & Safety Tips | Briggs & Stratton

Lawn mower or snow blower won't start? Use this Briggs & Stratton small engine repair guide for troubleshooting common problems & issues with small engines. [Read More](#)

[Snow Blowers | Briggs & Stratton](#)

Get outside and power through the cold quickly and effortlessly with a Briggs & Stratton® Snow Blower. With many models and features to choose from, you'll be equipped to take on Mother ...

Search - briggsandstratton.ca

Narrow your results to the desired language. All Languages All LanguagesAlbanianArabicAzerbaijaniBulgarianBurmeseChineseChinese ...

[Please select your language - briggsandstratton.ca](#)

Thank you for registering your Briggs & Stratton product (s). Click the buttons below to download or email a copy of your registration form.

Sélectionnez votre langue - briggsandstratton.ca

Renseignements pour les consommateurs * Indicates a required field Civilite Please Select Dr. M. Mlle. Mme. Rev. Prénom Nom de famille Rue Pays Province Please Select Alsace Aquitaine ...

French Product Registration | Briggs & Stratton

Register your Briggs & Stratton product to get faster and more efficient customer service for repair and parts.

Google Sitemap - briggsandstratton.ca

Find the right spark plug and gap for engine | Briggs & Stratton Troubleshooting small engine problems | Briggs & Stratton How to Clean a Carburetor? | Briggs & Stratton How to test and ...

[www.briggsandstratton.ca](#)

Briggs Engine Series Elite Running Watts* 16 Volts 849 Running Amps 246 Surge Amps 564 Engine Displacement (cc) 56 OHV Engine true Fuel Tank Capacity (gal) 656 Oil Capacity (oz) ...

Small Engines and Lawn Mower Parts | Briggs & Stratton

Learn more about small engines and shop for Briggs engine parts, generators & outdoor power products.

Accessibility Statement

Briggs and Stratton has invested a significant amount of resources to help ensure that its website is made easier to use and more accessible for people with disabilities, with the strong belief ...

FAQ & Safety Tips | Briggs & Stratton

Lawn mower or snow blower won't start? Use this Briggs & Stratton small engine repair guide for troubleshooting common problems & issues with small engines. [Read More](#)

Snow Blowers | Briggs & Stratton

Get outside and power through the cold quickly and effortlessly with a Briggs & Stratton® Snow Blower. With many models and features to choose from, you'll be equipped to take on Mother ...

Search - briggsandstratton.ca

Narrow your results to the desired language. All Languages All

LanguagesAlbanianArabicAzerbaijaniBulgarianBurmeseChineseChinese ...

Please select your language - briggsandstratton.ca

Thank you for registering your Briggs & Stratton product (s). Click the buttons below to download or email a copy of your registration form.

Sélectionnez votre langue - briggsandstratton.ca

Renseignements pour les consommateurs * Indicates a required field Civilite Please Select Dr. M. Mlle. Mme. Rev. Prénom Nom de famille Rue Pays Province Please Select Alsace Aquitaine ...

Get the essential Briggs and Stratton 80232 manual for maintenance tips and troubleshooting advice. Learn more to keep your engine running smoothly!

[Back to Home](#)