

# Briggs And Stratton 320421 Engine Manual

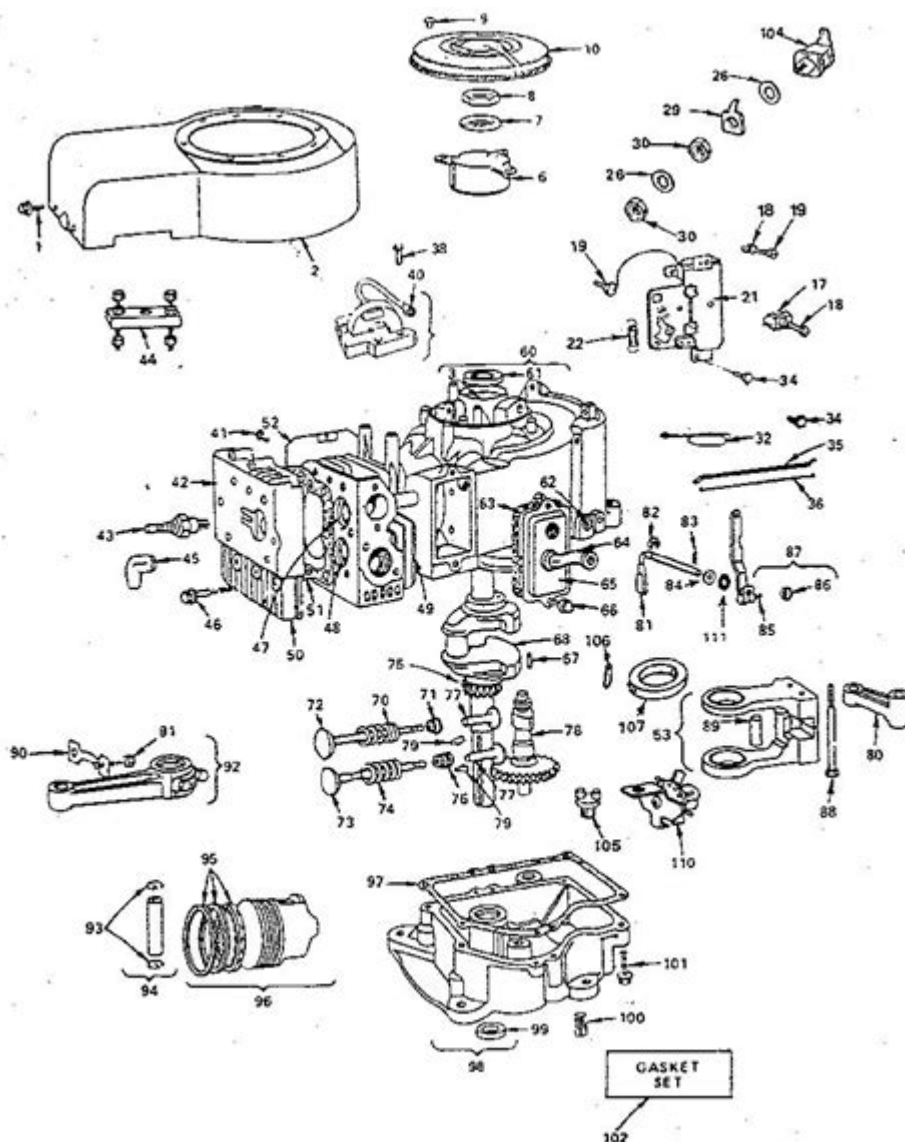

BRIGGS AND STRATTON 320421 ENGINE MANUAL IS AN ESSENTIAL RESOURCE FOR ANYONE LOOKING TO MAINTAIN, REPAIR, OR OPERATE THEIR BRIGGS AND STRATTON ENGINE EFFICIENTLY. THIS MANUAL PROVIDES COMPREHENSIVE INFORMATION ABOUT THE ENGINE'S SPECIFICATIONS, MAINTENANCE PROCEDURES, TROUBLESHOOTING TIPS, AND SAFETY INSTRUCTIONS. UNDERSTANDING THE CONTENT OF THE MANUAL CAN HELP USERS MAXIMIZE THE PERFORMANCE AND LIFESPAN OF THEIR ENGINE, ENSURING IT OPERATES SMOOTHLY FOR ALL APPLICATIONS, FROM LAWN MOWERS TO GENERATORS.

## OVERVIEW OF THE BRIGGS AND STRATTON 320421 ENGINE

THE BRIGGS AND STRATTON 320421 ENGINE IS A POWERFUL AND RELIABLE SMALL ENGINE USED IN VARIOUS APPLICATIONS. KNOWN FOR ITS DURABILITY AND PERFORMANCE, THIS ENGINE IS COMMONLY FOUND IN LAWN CARE EQUIPMENT, PRESSURE WASHERS, AND OTHER OUTDOOR POWER EQUIPMENT.

## KEY SPECIFICATIONS

- ENGINE TYPE: 4-CYCLE, AIR-COOLED
- DISPLACEMENT: 190 CC
- HORSEPOWER: 6.75 HP
- FUEL TYPE: UNLEADED GASOLINE
- OIL CAPACITY: 20 OUNCES
- STARTING SYSTEM: RECOIL START

THESE SPECIFICATIONS HIGHLIGHT THE ENGINE'S CAPABILITY AND SUITABILITY FOR DEMANDING TASKS, MAKING IT A POPULAR CHOICE AMONG BOTH HOMEOWNERS AND PROFESSIONALS.

## GETTING STARTED WITH THE ENGINE MANUAL

THE BRIGGS AND STRATTON 320421 ENGINE MANUAL IS STRUCTURED TO PROVIDE USERS WITH EASY ACCESS TO CRUCIAL INFORMATION. IT IS TYPICALLY DIVIDED INTO SEVERAL SECTIONS, EACH FOCUSING ON DIFFERENT ASPECTS OF ENGINE OPERATION AND MAINTENANCE.

## CONTENTS OF THE MANUAL

1. INTRODUCTION
  - OVERVIEW OF THE ENGINE
  - IMPORTANCE OF PROPER MAINTENANCE
2. SAFETY INFORMATION
  - GENERAL SAFETY GUIDELINES
  - PERSONAL PROTECTIVE EQUIPMENT (PPE) RECOMMENDATIONS
3. ENGINE SPECIFICATIONS
  - DETAILED SPECIFICATIONS
  - COMPONENT DESCRIPTIONS
4. OPERATING INSTRUCTIONS
  - STARTING AND STOPPING THE ENGINE
  - RECOMMENDED OPERATING PRACTICES
5. MAINTENANCE AND CARE
  - ROUTINE MAINTENANCE TASKS
  - OIL CHANGE PROCEDURES
  - AIR FILTER CLEANING AND REPLACEMENT
6. TROUBLESHOOTING GUIDE
  - COMMON ISSUES AND SOLUTIONS
  - DIAGNOSTIC FLOWCHARTS
7. PARTS AND SERVICE
  - REPLACEMENT PARTS INFORMATION
  - SERVICE CENTER LOCATIONS
8. WARRANTY INFORMATION
  - COVERAGE DETAILS
  - CLAIM PROCESS

# SAFETY PRECAUTIONS

SAFETY IS PARAMOUNT WHEN OPERATING ANY ENGINE, AND THE BRIGGS AND STRATTON 320421 ENGINE MANUAL EMPHASIZES THE IMPORTANCE OF FOLLOWING SAFETY GUIDELINES. HERE ARE SOME KEY SAFETY PRECAUTIONS TO CONSIDER:

- READ THE MANUAL: ENSURE YOU UNDERSTAND ALL INSTRUCTIONS BEFORE OPERATING THE ENGINE.
- USE PROPER PPE: ALWAYS WEAR SAFETY GOGGLES, GLOVES, AND EAR PROTECTION WHEN USING THE ENGINE.
- CHECK FOR LEAKS: INSPECT THE ENGINE FOR ANY FUEL OR OIL LEAKS BEFORE STARTING.
- WORK IN A VENTILATED AREA: ALWAYS OPERATE THE ENGINE OUTDOORS OR IN A WELL-VENTILATED SPACE TO AVOID CARBON MONOXIDE BUILDUP.
- SECURE LOOSE CLOTHING: AVOID WEARING LOOSE CLOTHING THAT COULD GET CAUGHT IN MOVING PARTS.

FOLLOWING THESE SAFETY PRECAUTIONS CAN HELP PREVENT ACCIDENTS AND INJURIES DURING OPERATION AND MAINTENANCE.

## OPERATING INSTRUCTIONS

UNDERSTANDING HOW TO OPERATE THE BRIGGS AND STRATTON 320421 ENGINE IS CRITICAL FOR EFFECTIVE PERFORMANCE. THE MANUAL PROVIDES DETAILED INSTRUCTIONS ON STARTING AND STOPPING THE ENGINE, ENSURING THAT USERS CAN OPERATE IT SAFELY AND EFFICIENTLY.

## STARTING THE ENGINE

1. PREPARATION:
  - ENSURE THE ENGINE IS ON A STABLE, LEVEL SURFACE.
  - CHECK THE OIL LEVEL AND ADD OIL IF NECESSARY.
  - FILL THE FUEL TANK WITH FRESH, UNLEADED GASOLINE.
2. CHOKE POSITION:
  - SET THE CHOKE LEVER TO THE 'CHOKE' POSITION FOR COLD STARTS.
3. STARTING:
  - FIRMLY GRIP THE STARTER HANDLE AND PULL IT SLOWLY UNTIL YOU FEEL RESISTANCE.
  - PULL THE STARTER HANDLE QUICKLY AND FIRMLY TO START THE ENGINE.
4. ADJUSTING CHOKE:
  - ONCE THE ENGINE STARTS, GRADUALLY MOVE THE CHOKE LEVER TO THE 'RUN' POSITION.

## STOPPING THE ENGINE

1. IDLE THE ENGINE:
  - ALLOW THE ENGINE TO RUN FOR A FEW MINUTES AT IDLE TO COOL DOWN.
2. STOP THE ENGINE:
  - TURN THE IGNITION SWITCH TO THE 'OFF' POSITION OR PRESS THE STOP BUTTON, DEPENDING ON THE MODEL.
3. SAFETY CHECK:
  - ENSURE THE AREA IS CLEAR OF DEBRIS AND THE ENGINE IS TURNED OFF BEFORE LEAVING THE WORK AREA.

# MAINTENANCE AND CARE

REGULAR MAINTENANCE IS CRUCIAL FOR THE LONGEVITY AND PERFORMANCE OF THE BRIGGS AND STRATTON 320421 ENGINE. THE BRIGGS AND STRATTON 320421 ENGINE MANUAL OUTLINES KEY MAINTENANCE TASKS THAT SHOULD BE PERFORMED REGULARLY.

## ROUTINE MAINTENANCE TASKS

- OIL CHANGES:
  - CHANGE THE OIL AFTER THE FIRST 5 HOURS OF OPERATION, THEN EVERY 50 HOURS OR ANNUALLY, WHICHEVER COMES FIRST.
- AIR FILTER MAINTENANCE:
  - CLEAN THE AIR FILTER EVERY 25 HOURS OF OPERATION.
  - REPLACE THE AIR FILTER AS NECESSARY, ESPECIALLY IF IT APPEARS DAMAGED OR EXCESSIVELY DIRTY.
- SPARK PLUG REPLACEMENT:
  - INSPECT THE SPARK PLUG EVERY 100 HOURS OF OPERATION AND REPLACE IT AS NEEDED.
- FUEL SYSTEM MAINTENANCE:
  - USE FRESH FUEL AND AVOID MIXING GASOLINE WITH OIL.
  - DRAIN THE FUEL SYSTEM IF THE ENGINE WILL NOT BE USED FOR AN EXTENDED PERIOD.
- INSPECT BELTS AND CABLES:
  - REGULARLY CHECK BELTS AND CABLES FOR WEAR OR DAMAGE, AND REPLACE THEM IF NECESSARY.

FOLLOWING THESE MAINTENANCE TASKS CAN HELP ENSURE THAT THE ENGINE PERFORMS OPTIMALLY AND LASTS FOR MANY YEARS.

## TROUBLESHOOTING COMMON ISSUES

EVEN WITH PROPER MAINTENANCE, ISSUES MAY ARISE DURING OPERATION. THE BRIGGS AND STRATTON 320421 ENGINE MANUAL INCLUDES A TROUBLESHOOTING GUIDE TO ASSIST USERS IN DIAGNOSING AND RESOLVING COMMON PROBLEMS.

## COMMON ISSUES AND SOLUTIONS

1. ENGINE WON'T START:
  - CHECK FUEL: ENSURE THE FUEL TANK IS FULL AND THAT THE FUEL IS FRESH.
  - INSPECT THE SPARK PLUG: REMOVE AND INSPECT THE SPARK PLUG FOR WEAR OR DAMAGE.
  - CHOKE POSITION: ENSURE THE CHOKE IS IN THE CORRECT POSITION FOR STARTING.
2. ENGINE RUNS ROUGH:
  - CLEAN AIR FILTER: A DIRTY AIR FILTER CAN RESTRICT AIRFLOW.
  - FUEL SYSTEM ISSUES: CHECK FOR CLOGGED FUEL LINES OR A DIRTY CARBURETOR.
3. EXCESSIVE VIBRATION:
  - LOOSE PARTS: INSPECT FOR LOOSE BOLTS OR COMPONENTS.
  - BLADE DAMAGE: CHECK THE BLADE FOR DAMAGE AND ENSURE IT IS BALANCED.
4. OVERHEATING:
  - CHECK OIL LEVEL: LOW OIL LEVELS CAN CAUSE OVERHEATING.
  - BLOCKED AIR VENTS: ENSURE THAT AIR VENTS ARE CLEAR OF DEBRIS.

BY FOLLOWING THE TROUBLESHOOTING STEPS OUTLINED IN THE MANUAL, USERS CAN OFTEN RESOLVE ISSUES WITHOUT NEEDING

PROFESSIONAL ASSISTANCE.

## PARTS AND SERVICE

MAINTAINING OPTIMAL PERFORMANCE OF THE BRIGGS AND STRATTON 320421 ENGINE MAY REQUIRE REPLACEMENT PARTS OVER TIME. THE BRIGGS AND STRATTON 320421 ENGINE MANUAL TYPICALLY INCLUDES INFORMATION ON WHERE TO FIND AUTHORIZED PARTS AND SERVICE CENTERS.

## REPLACEMENT PARTS INFORMATION

- AUTHORIZED DEALERS: LOCATE AN AUTHORIZED BRIGGS AND STRATTON DEALER FOR GENUINE PARTS.
- ONLINE RESOURCES: MANY PARTS CAN BE PURCHASED THROUGH THE BRIGGS AND STRATTON OFFICIAL WEBSITE OR OTHER REPUTABLE ONLINE RETAILERS.
- SERVICE CENTERS: THE MANUAL MAY PROVIDE A LIST OF LOCAL SERVICE CENTERS FOR PROFESSIONAL MAINTENANCE AND REPAIRS.

## CONCLUSION

THE BRIGGS AND STRATTON 320421 ENGINE MANUAL IS AN INVALUABLE TOOL FOR ANYONE WHO OWNS OR OPERATES THIS ENGINE. BY UNDERSTANDING THE SPECIFICATIONS, FOLLOWING SAFETY PRECAUTIONS, AND ADHERING TO THE MAINTENANCE GUIDELINES PROVIDED IN THE MANUAL, USERS CAN ENSURE THEIR ENGINE RUNS EFFICIENTLY AND LASTS FOR YEARS. WHETHER YOU ARE A SEASONED TECHNICIAN OR A CASUAL USER, HAVING ACCESS TO THIS MANUAL WILL EMPOWER YOU TO MANAGE YOUR ENGINE EFFECTIVELY AND TACKLE ANY CHALLENGES THAT ARISE DURING OPERATION.

## FREQUENTLY ASKED QUESTIONS

### WHERE CAN I FIND THE BRIGGS AND STRATTON 320421 ENGINE MANUAL?

THE BRIGGS AND STRATTON 320421 ENGINE MANUAL CAN BE FOUND ON THE OFFICIAL BRIGGS AND STRATTON WEBSITE UNDER THE 'SUPPORT' OR 'MANUALS' SECTION. YOU CAN ALSO CHECK AUTHORIZED RETAILERS OR FORUMS FOR DOWNLOADABLE PDFs.

### WHAT ARE THE KEY MAINTENANCE TIPS OUTLINED IN THE BRIGGS AND STRATTON 320421 ENGINE MANUAL?

KEY MAINTENANCE TIPS INCLUDE REGULARLY CHECKING AND CHANGING THE OIL, INSPECTING THE AIR FILTER, ENSURING THE SPARK PLUG IS IN GOOD CONDITION, AND CLEANING THE COOLING FINS TO PREVENT OVERHEATING.

### IS THE BRIGGS AND STRATTON 320421 ENGINE MANUAL AVAILABLE IN LANGUAGES OTHER THAN ENGLISH?

YES, THE BRIGGS AND STRATTON 320421 ENGINE MANUAL IS OFTEN AVAILABLE IN MULTIPLE LANGUAGES. CHECK THE MANUAL SECTION ON THEIR WEBSITE FOR LANGUAGE OPTIONS OR CONTACT CUSTOMER SUPPORT FOR ASSISTANCE.

### WHAT TROUBLESHOOTING STEPS ARE RECOMMENDED IN THE BRIGGS AND STRATTON 320421 ENGINE MANUAL?

THE MANUAL RECOMMENDS TROUBLESHOOTING STEPS SUCH AS CHECKING FUEL LEVELS, INSPECTING THE SPARK PLUG FOR WEAR OR DAMAGE, ENSURING THE AIR FILTER IS CLEAN, AND EXAMINING THE CARBURETOR FOR CLOGS.

## How can I download the Briggs and Stratton 320421 engine manual?

To download the Briggs and Stratton 320421 engine manual, visit the Briggs and Stratton website, navigate to the 'Manuals' section, enter the engine model number, and follow the prompts to download the PDF version.

Find other PDF article:

<https://soc.up.edu.ph/40-trend/Book?ID=Led95-3377&title=medical-terminology-in-a-flash-4th-edition-answer-key.pdf>

## Briggs And Stratton 320421 Engine Manual

### **French Product Registration | Briggs & Stratton**

Register your Briggs & Stratton product to get faster and more efficient customer service for repair and parts.

*Google Sitemap - briggsandstratton.ca*

Find the right spark plug and gap for engine | Briggs & Stratton Troubleshooting small engine ...

*www.briggsandstratton.ca*

Briggs Engine Series Elite Running Watts\* 16 Volts 849 Running Amps 246 Surge Amps 564 Engine Displacement (cc) 56 ...

### **Small Engines and Lawn Mower Parts | Briggs & Stratton**

Learn more about small engines and shop for Briggs engine parts, generators & outdoor power products.

### Accessibility Statement

Briggs and Stratton has invested a significant amount of resources to help ensure that its website is made easier ...

### **French Product Registration | Briggs & Stratton**

Register your Briggs & Stratton product to get faster and more efficient customer service for repair and parts.

**Google Sitemap - briggsandstratton.ca**

Find the right spark plug and gap for engine | Briggs & Stratton Troubleshooting small engine problems | Briggs & Stratton How to Clean a Carburetor? | Briggs & Stratton How to test and ...

*www.briggsandstratton.ca*

Briggs Engine Series Elite Running Watts\* 16 Volts 849 Running Amps 246 Surge Amps 564 Engine Displacement (cc) 56 OHV Engine true Fuel Tank Capacity (gal) 656 Oil Capacity (oz) ...

### **Small Engines and Lawn Mower Parts | Briggs & Stratton**

Learn more about small engines and shop for Briggs engine parts, generators & outdoor power products.

## **Accessibility Statement**

Briggs and Stratton has invested a significant amount of resources to help ensure that its website is made easier to use and more accessible for people with disabilities, with the strong belief ...

## **FAQ & Safety Tips | Briggs & Stratton**

Lawn mower or snow blower won't start? Use this Briggs & Stratton small engine repair guide for troubleshooting common problems & issues with small engines. [Read More](#)

### *Snow Blowers | Briggs & Stratton*

Get outside and power through the cold quickly and effortlessly with a Briggs & Stratton® Snow Blower. With many models and features to choose from, you'll be equipped to take on Mother ...

### *Search - [briggsandstratton.ca](#)*

Narrow your results to the desired language. All Languages All LanguagesAlbanianArabicAzerbaijaniBulgarianBurmeseChineseChinese ...

### *Please select your language - [briggsandstratton.ca](#)*

Thank you for registering your Briggs & Stratton product (s). Click the buttons below to download or email a copy of your registration form.

### Sélectionnez votre langue - [briggsandstratton.ca](#)

Renseignements pour les consommateurs \* Indicates a required field Civilite Please Select Dr. M. Mlle. Mme. Rev. Prénom Nom de famille Rue Pays Province Please Select Alsace Aquitaine ...

Unlock the full potential of your equipment with the Briggs and Stratton 320421 engine manual. Discover how to maintain and troubleshoot your engine effectively!

[Back to Home](#)