

Briggs And Stratton Plastic Carburetor Parts Diagram

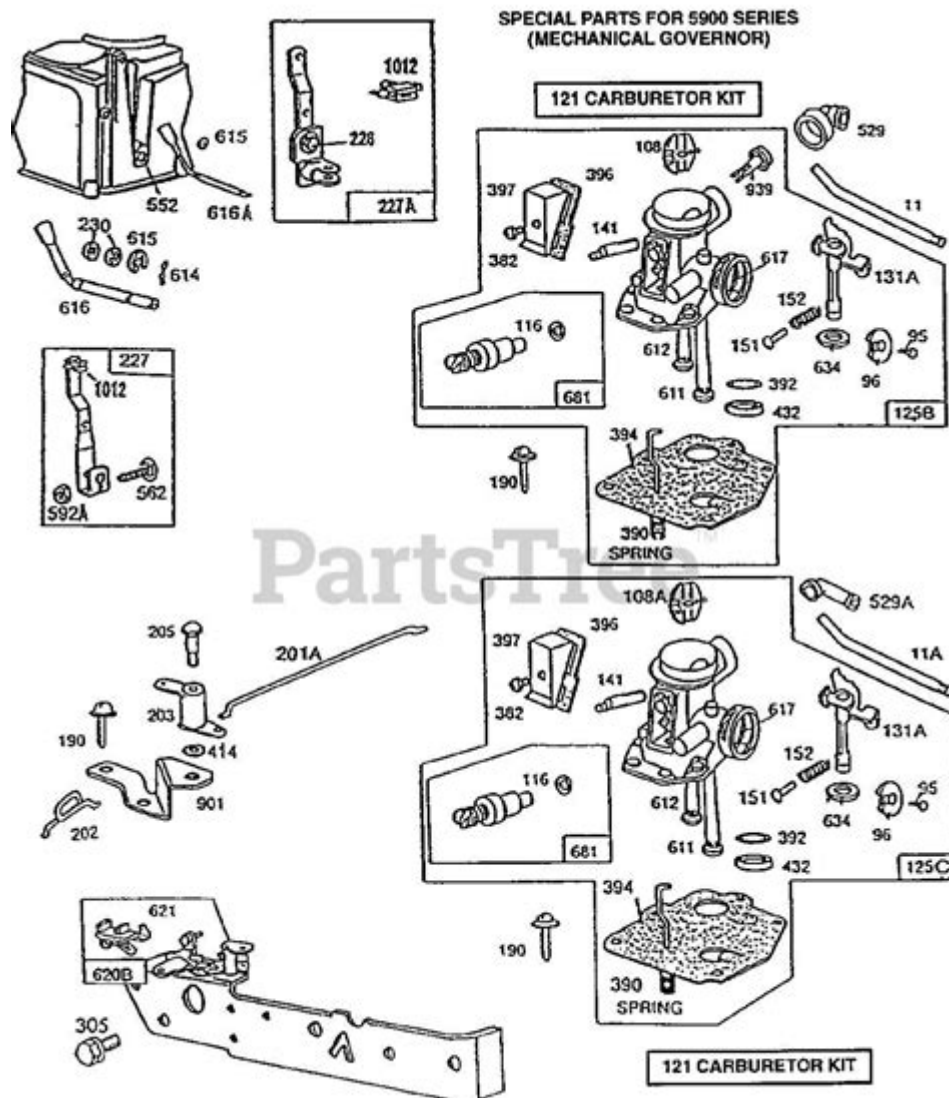

Briggs and Stratton plastic carburetor parts diagram is an essential resource for anyone looking to maintain or repair their small engine equipment. As a leading manufacturer of small engines, Briggs and Stratton has become synonymous with reliability and performance. Understanding the components of the carburetor, especially the plastic parts, can significantly enhance the longevity and efficiency of your engine. In this article, we will delve into the intricacies of the Briggs and Stratton plastic carburetor parts diagram, exploring its various components, functions, and the importance of proper maintenance.

Understanding the Carburetor's Role in Small Engines

The carburetor is a crucial component of any internal combustion engine. Its primary function is to mix air and fuel in the correct ratio for optimal combustion. In small engines, like those used in lawnmowers, generators, and other outdoor equipment, the efficiency of the carburetor directly affects the performance of the machine.

Key Functions of the Carburetor

1. **Air-Fuel Mixture:** The carburetor creates a precise mixture of air and fuel to ensure efficient combustion.
2. **Regulation of Engine Speed:** The carburetor controls the engine's speed by adjusting the air-fuel mixture.
3. **Starting the Engine:** It provides the necessary mixture to start the engine, especially in cold conditions.

Overview of Briggs and Stratton Plastic Carburetor Parts

The plastic parts of a Briggs and Stratton carburetor play a vital role in its overall functioning. These components are often lighter and resistant to corrosion, making them ideal for small engine applications.

Common Plastic Parts in Briggs and Stratton Carburetors

1. **Float:** The float regulates the fuel level in the carburetor bowl, ensuring a consistent supply of fuel to the engine.
2. **Float Chamber:** This part houses the float and helps maintain the fuel level.
3. **Air Filter Housing:** Although not solely a carburetor part, the air filter housing connects to the carburetor and helps filter out impurities from the air entering the engine.
4. **Throttle Plate:** This regulates the air-fuel mixture entering the engine, affecting performance and speed.
5. **Choke Plate:** The choke plate is vital for starting the engine, particularly in colder conditions. It enriches the fuel mixture for easier ignition.

Briggs and Stratton Plastic Carburetor Parts Diagram

A detailed diagram of the Briggs and Stratton plastic carburetor parts can provide a visual reference for understanding how these components fit together and function. Here's a simplified breakdown of what you might see in a typical diagram:

- Top Cover: Protects the internal components and aids in airflow.
- Float and Float Chamber: Illustrates the position of the float and its relationship with the fuel inlet.
- Venturi: The narrow passage that creates a vacuum to draw fuel into the airflow.
- Throttle and Choke Plates: Shows their position and how they control airflow and fuel mixture.

Benefits of Using a Diagram

- Enhanced Understanding: Visual aids help clarify how each component functions.
- Easier Troubleshooting: Identifying parts can simplify diagnosing issues.
- Streamlined Repairs: Knowing the layout speeds up the repair process.

Importance of Regular Maintenance

Proper maintenance of the carburetor can prolong the life of your Briggs and Stratton engine and ensure optimal performance. Neglect can lead to various issues, including poor engine performance, increased fuel consumption, and even engine failure.

Maintenance Tips for Your Carburetor

1. Regular Cleaning: Ensure that the carburetor is cleaned periodically to prevent buildup that can affect performance.
2. Check for Leaks: Inspect for any fuel leaks around the carburetor, which can indicate worn seals or gaskets.
3. Inspect Plastic Parts: Regularly check the condition of plastic components, as they can become brittle over time.
4. Adjust Carburetor Settings: Occasionally, adjustments may be necessary to ensure optimal air-fuel mixture.
5. Replace Worn Parts: If any components show signs of wear or damage, replace them promptly to maintain efficiency.

Common Issues with Plastic Carburetor Parts

While plastic parts are beneficial for their lightweight and corrosion-resistant properties, they can also present specific challenges over time.

Identifying Common Problems

1. Cracking: UV exposure and temperature fluctuations can cause plastic parts to crack.
2. Warping: Heat from the engine can warp plastic components, leading to improper fit and function.
3. Fuel Leaks: Old or damaged seals can lead to fuel leaks, affecting performance and safety.

Solutions and Replacements

- Regular Inspections: Conduct routine checks to catch issues early.
- Use OEM Parts: Always opt for Original Equipment Manufacturer (OEM) parts for replacements to ensure compatibility and quality.
- Consult the Diagram: Use the carburetor parts diagram to identify specific components that may need replacement.

Conclusion

In summary, the **Briggs and Stratton plastic carburetor parts diagram** is an invaluable tool for anyone involved in the maintenance or repair of small engines. By understanding the various components and their functions, as well as the importance of regular maintenance, you can ensure that your engine operates at peak performance. Whether you are a DIY enthusiast or a professional mechanic, having a solid grasp of carburetor components will lead to better repairs and a longer lifespan for your equipment. With proper care and attention, you can keep your Briggs and Stratton engine running smoothly for years to come.

Frequently Asked Questions

What is a Briggs and Stratton plastic carburetor parts diagram?

A Briggs and Stratton plastic carburetor parts diagram is a visual representation that outlines the components of the carburetor used in Briggs

and Stratton engines, showing how each part fits together and functions.

Where can I find a Briggs and Stratton plastic carburetor parts diagram?

You can find a Briggs and Stratton plastic carburetor parts diagram on the official Briggs and Stratton website, in repair manuals, or through various online forums and parts retailers.

Why is a parts diagram important for carburetor repairs?

A parts diagram is important for carburetor repairs because it helps users identify each component, understand their functions, and ensure proper reassembly after maintenance or replacement.

What are common issues that a Briggs and Stratton plastic carburetor might face?

Common issues include clogging due to dirt or debris, fuel leaks, improper fuel mixture, and issues with the float or needle valve that can affect engine performance.

How do I use a Briggs and Stratton plastic carburetor parts diagram for troubleshooting?

To use the diagram for troubleshooting, compare the actual parts of your carburetor with the diagram to identify any missing or damaged components, and ensure that everything is assembled correctly.

Are there different diagrams for different Briggs and Stratton engine models?

Yes, there are different diagrams for different Briggs and Stratton engine models, as each model may have variations in carburetor design and parts configuration.

Can I order replacement parts using the parts diagram?

Yes, you can use the parts diagram to identify specific components needed for replacement and order them from authorized dealers or online retailers.

What should I do if I can't find the correct parts diagram for my engine?

If you can't find the correct parts diagram, consider contacting Briggs and Stratton customer service or visiting a local authorized service center for assistance in identifying the right diagram and parts.

Find other PDF article:

<https://soc.up.edu.ph/02-word/pdf?docid=Mda34-1404&title=500-greatest-albums-of-all-time.pdf>

Briggs And Stratton Plastic Carburetor Parts Diagram

French Product Registration | Briggs & Stratton

Register your Briggs & Stratton product to get faster and more efficient customer service for repair and parts.

Google Sitemap - briggsandstratton.ca

Find the right spark plug and gap for engine | Briggs & Stratton Troubleshooting small engine problems | Briggs & Stratton How to Clean a Carburetor? | Briggs & Stratton How to test and repair ignition system problems? | Briggs & Stratton What is the best fuel type for lawn mowers and small engines? | Briggs & Stratton

www.briggsandstratton.ca

Briggs Engine Series Elite Running Watts* 16 Volts 849 Running Amps 246 Surge Amps 564 Engine Displacement (cc) 56 OHV Engine true Fuel Tank Capacity (gal) 656 Oil Capacity (oz) 18.00 RPM / Hz 4500/60f Run Time 56 Alternator Included Start Type Choke Low Oil Shutdown Yes Automatic Idle Control Included Muffler Included Fuel Gauge 549 Hour ...

Small Engines and Lawn Mower Parts | Briggs & Stratton

Learn more about small engines and shop for Briggs engine parts, generators & outdoor power products.

Accessibility Statement

Briggs and Stratton has invested a significant amount of resources to help ensure that its website is made easier to use and more accessible for people with disabilities, with the strong belief that every person has the right to live with dignity, equality, comfort and independence.

FAQ & Safety Tips | Briggs & Stratton

Lawn mower or snow blower won't start? Use this Briggs & Stratton small engine repair guide for troubleshooting common problems & issues with small engines. [Read More](#)

Snow Blowers | Briggs & Stratton

Get outside and power through the cold quickly and effortlessly with a Briggs & Stratton® Snow Blower. With many models and features to choose from, you'll be equipped to take on Mother ...

Search - briggsandstratton.ca

Narrow your results to the desired language. All Languages All
LanguagesAlbanianArabicAzerbaijaniBulgarianBurmeseChineseChinese ...

Please select your language - briggsandstratton.ca

Thank you for registering your Briggs & Stratton product (s). Click the buttons below to download or email a copy of your registration form.

Sélectionnez votre langue - briggsandstratton.ca

Renseignements pour les consommateurs * Indicates a required field Civilite Please Select Dr. M. Mlle. Mme. Rev. Prénom Nom de famille Rue Pays Province Please Select Alsace Aquitaine Auvergne Basse-Normandie Bourgogne Bretagne Centre Champagne-Ardenne Corse Franche-Comte Haute-Normandie Ile-de-France Languedoc-Roussillon Limousin Lorraine Midi ...

[French Product Registration | Briggs & Stratton](#)

Register your Briggs & Stratton product to get faster and more efficient customer service for repair and parts.

Google Sitemap - [briggsandstratton.ca](#)

Find the right spark plug and gap for engine | Briggs & Stratton Troubleshooting small engine problems | Briggs & Stratton How to Clean a Carburetor? | Briggs & Stratton How to test and ...

[www.briggsandstratton.ca](#)

Briggs Engine Series Elite Running Watts* 16 Volts 849 Running Amps 246 Surge Amps 564 Engine Displacement (cc) 56 OHV Engine true Fuel Tank Capacity (gal) 656 Oil Capacity (oz) ...

[Small Engines and Lawn Mower Parts | Briggs & Stratton](#)

Learn more about small engines and shop for Briggs engine parts, generators & outdoor power products.

[Accessibility Statement](#)

Briggs and Stratton has invested a significant amount of resources to help ensure that its website is made easier to use and more accessible for people with disabilities, with the strong belief ...

[FAQ & Safety Tips | Briggs & Stratton](#)

Lawn mower or snow blower won't start? Use this Briggs & Stratton small engine repair guide for troubleshooting common problems & issues with small engines. [Read More](#)

[Snow Blowers | Briggs & Stratton](#)

Get outside and power through the cold quickly and effortlessly with a Briggs & Stratton® Snow Blower. With many models and features to choose from, you'll be equipped to take on Mother ...

[Search - briggsandstratton.ca](#)

Narrow your results to the desired language. All Languages All LanguagesAlbanianArabicAzerbaijaniBulgarianBurmeseChineseChinese ...

[Please select your language - briggsandstratton.ca](#)

Thank you for registering your Briggs & Stratton product (s). Click the buttons below to download or email a copy of your registration form.

[Sélectionnez votre langue - briggsandstratton.ca](#)

Renseignements pour les consommateurs * Indicates a required field Civilite Please Select Dr. M. Mlle. Mme. Rev. Prénom Nom de famille Rue Pays Province Please Select Alsace Aquitaine ...

Explore our detailed Briggs and Stratton plastic carburetor parts diagram to understand your engine better. Learn more about maintenance and repair tips today!

[Back to Home](#)