

# Briggs And Stratton Intek 206 Parts Diagram

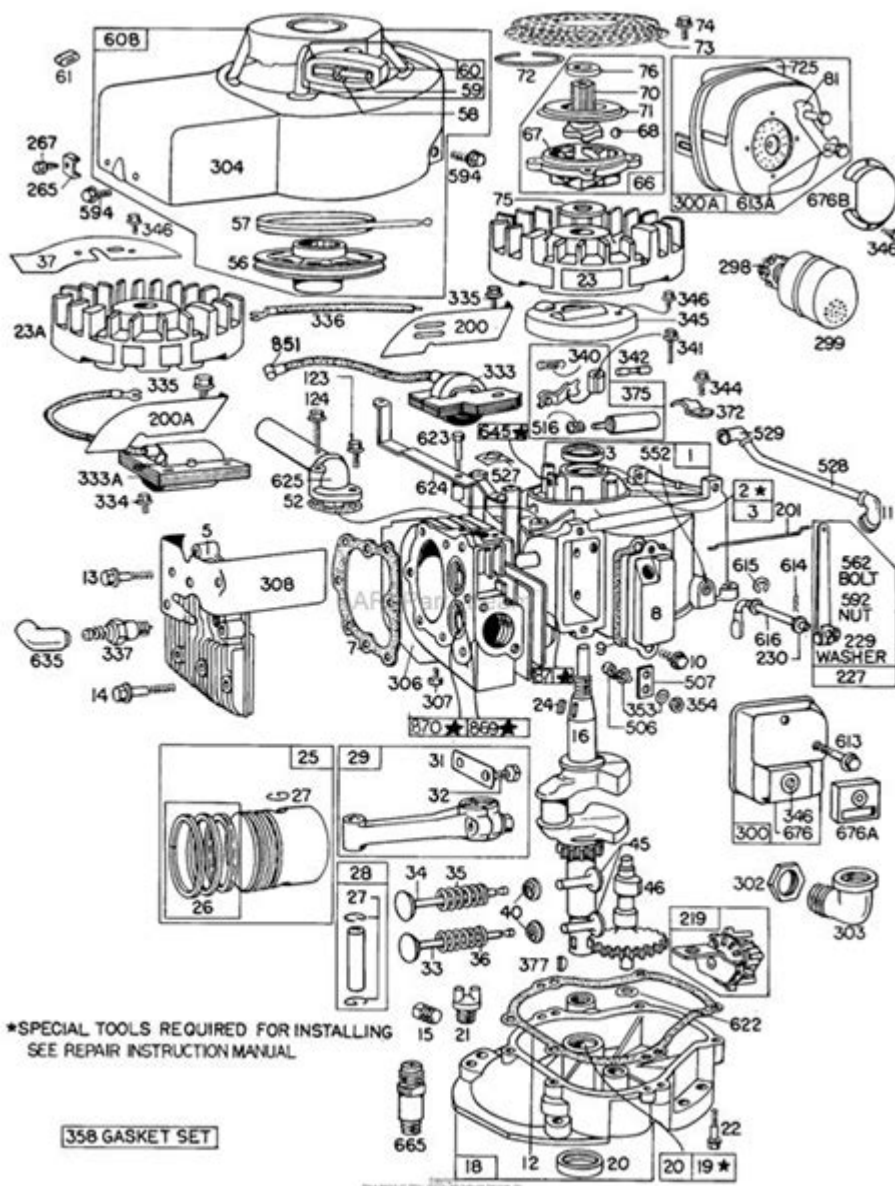

Briggs and Stratton Intek 206 parts diagram is an essential resource for anyone looking to understand the inner workings of this popular engine model. Known for its reliability and performance, the Intek 206 is widely used in various applications, including lawn mowers, generators, and other outdoor power equipment. Understanding the parts and their arrangement is crucial for maintenance, repairs, and upgrades. This article delves into the intricate details of the Intek 206 parts diagram, breaking down its components, functionality, and maintenance tips to ensure the longevity of your engine.

## Overview of the Briggs and Stratton Intek 206 Engine

The Briggs and Stratton Intek 206 is a four-stroke, single-cylinder engine that features an overhead valve (OHV) design. This engine is designed for durability and efficiency, making it a popular choice for homeowners and professionals alike. Its features include:

- Displacement: Approximately 206 cc
- Power Output: Around 6-7 horsepower
- Fuel Type: Gasoline
- Cooling System: Air-cooled
- Lubrication System: Splash lubrication

These characteristics contribute to the engine's versatility and make it suitable for various applications, from mowing lawns to powering utility vehicles.

## Understanding the Parts Diagram

To effectively utilize the Briggs and Stratton Intek 206 parts diagram, one must first understand the various components and their functions. The diagram typically includes a visual representation of the engine with labels identifying each part. Here are the main sections you'll find in the parts diagram:

### 1. Engine Block

The engine block is the core structure of the Intek 206, housing essential components like the cylinders and crankshaft. Key parts include:

- Cylinder: Contains the combustion chamber where fuel and air mix.
- Crankcase: Encloses the crankshaft and oil sump.
- Mounting Bracket: Provides attachment points for the engine to the chassis.

### 2. Fuel System

The fuel system is crucial for the engine's operation, ensuring that the correct mixture of fuel and air reaches the combustion chamber. Components include:

- Fuel Tank: Stores gasoline.
- Fuel Filter: Cleans fuel before it enters the carburetor.
- Carburetor: Mixes air with fuel for combustion.

### 3. Ignition System

The ignition system is responsible for igniting the air-fuel mixture. Key components are:

- Spark Plug: Creates a spark to ignite the mixture.
- Ignition Coil: Generates high voltage to power the spark plug.
- Flywheel: Assists in maintaining engine speed and charges the battery.

## 4. Cooling System

An efficient cooling system prevents overheating, ensuring the engine operates smoothly. Components include:

- Cooling Fins: Aid in dissipating heat from the engine block.
- Fan: Circulates air to cool the engine.
- Shroud: Directs airflow around the engine.

## 5. Lubrication System

Proper lubrication is essential for reducing friction and wear. Key components are:

- Oil Sump: Holds the engine oil.
- Oil Pump: Circulates oil throughout the engine.
- Oil Filter: Removes contaminants from the oil.

## 6. Exhaust System

The exhaust system directs harmful gases away from the engine. Components include:

- Exhaust Manifold: Collects exhaust gases from the cylinder.
- Muffler: Reduces noise produced by the engine.

## Maintenance Tips for the Intek 206 Engine

Regular maintenance is critical for the longevity and efficiency of the Briggs and Stratton Intek 206 engine. Here are some essential maintenance tips:

### 1. Regular Oil Changes

- Change the oil every 50 hours of operation or at least once a season.
- Use high-quality oil as specified in the owner's manual.

### 2. Clean or Replace the Air Filter

- Check the air filter regularly and clean it if it's dirty.
- Replace the air filter every season or as needed to maintain airflow.

### **3. Spark Plug Maintenance**

- Inspect the spark plug for wear and carbon buildup.
- Replace the spark plug annually for optimal ignition.

### **4. Fuel System Care**

- Use fresh fuel to prevent gumming in the carburetor.
- Add a fuel stabilizer if the engine will be stored for an extended period.

### **5. Inspect Belts and Cables**

- Check belts for wear or cracking and replace if necessary.
- Ensure cables are in good condition and properly connected.

### **6. Clean the Cooling System**

- Remove debris from cooling fins and shrouds to allow proper airflow.
- Inspect the fan for any damage or obstructions.

## **Finding Replacement Parts**

When it comes to replacing parts for the Briggs and Stratton Intek 206, it's essential to use genuine or high-quality aftermarket parts. Here are some tips on how to find the right components:

1. Consult the Parts Diagram: Use the parts diagram to identify the exact part number you need.
2. Visit Authorized Dealers: Briggs and Stratton authorized dealers can provide genuine parts and expertise.
3. Online Marketplaces: Websites like Amazon, eBay, and specialized small engine parts retailers often have a wide selection of parts.
4. Local Repair Shops: Reach out to local small engine repair shops; they may have parts in stock or can order them for you.

## **Conclusion**

Understanding the Briggs and Stratton Intek 206 parts diagram is invaluable for anyone who owns or operates this engine. With its robust design and reliable performance, the Intek 206 is a favorite among users of outdoor power equipment. By familiarizing yourself with the engine's components, performing regular maintenance, and knowing where to find replacement parts, you can ensure that your engine remains in peak condition for years to come. Whether you're a DIY enthusiast or a

professional technician, having access to this knowledge will help you maximize the performance and lifespan of your Briggs and Stratton Intek 206 engine.

## **Frequently Asked Questions**

### **What is the purpose of the parts diagram for the Briggs and Stratton Intek 206 engine?**

The parts diagram serves as a visual reference to identify and locate various components of the Briggs and Stratton Intek 206 engine, making it easier for users to understand the assembly and disassembly processes during maintenance or repairs.

### **Where can I find the official parts diagram for the Briggs and Stratton Intek 206?**

The official parts diagram for the Briggs and Stratton Intek 206 can typically be found on the Briggs and Stratton website, in the customer support or parts section, or through authorized dealers and service centers.

### **What are the most commonly replaced parts in the Briggs and Stratton Intek 206 engine?**

Commonly replaced parts in the Briggs and Stratton Intek 206 engine include the air filter, oil filter, spark plug, fuel filter, and various gaskets, all of which can be identified in the parts diagram.

### **How can I use the parts diagram to troubleshoot my Briggs and Stratton Intek 206 engine?**

To troubleshoot the engine using the parts diagram, compare the diagram with the physical engine to identify any missing or damaged parts. The diagram can help pinpoint issues related to assembly and functionality.

### **Are there any online forums or communities where I can discuss issues related to the Briggs and Stratton Intek 206 parts diagram?**

Yes, there are several online forums and communities, such as Reddit, small engine repair forums, and Facebook groups, where enthusiasts and professionals discuss issues related to the Briggs and Stratton Intek 206 and share insights about parts diagrams and repairs.

Find other PDF article:

<https://soc.up.edu.ph/38-press/pdf?trackid=met79-9060&title=love-you-the-way-you-are.pdf>

# **Briggs And Stratton Intek 206 Parts Diagram**

## *French Product Registration | Briggs & Stratton*

Register your Briggs & Stratton product to get faster and more efficient customer service for repair and parts.

## **Google Sitemap - [briggsandstratton.ca](http://briggsandstratton.ca)**

Find the right spark plug and gap for engine | Briggs & Stratton Troubleshooting small engine ...

## [www.briggsandstratton.ca](http://www.briggsandstratton.ca)

Briggs Engine Series Elite Running Watts\* 16 Volts 849 Running Amps 246 Surge Amps 564 Engine ...

## Small Engines and Lawn Mower Parts | Briggs & Stratton

Learn more about small engines and shop for Briggs engine parts, generators & outdoor power products.

## *Accessibility Statement*

Briggs and Stratton has invested a significant amount of resources to help ensure that its website is made ...

## French Product Registration | Briggs & Stratton

Register your Briggs & Stratton product to get faster and more efficient customer service for repair and parts.

## Google Sitemap - [briggsandstratton.ca](http://briggsandstratton.ca)

Find the right spark plug and gap for engine | Briggs & Stratton Troubleshooting small engine problems | Briggs & Stratton How to Clean a Carburetor? | Briggs & Stratton How to test and ...

## **[www.briggsandstratton.ca](http://www.briggsandstratton.ca)**

Briggs Engine Series Elite Running Watts\* 16 Volts 849 Running Amps 246 Surge Amps 564 Engine Displacement (cc) 56 OHV Engine true Fuel Tank Capacity (gal) 656 Oil Capacity (oz) ...

## **Small Engines and Lawn Mower Parts | Briggs & Stratton**

Learn more about small engines and shop for Briggs engine parts, generators & outdoor power products.

## Accessibility Statement

Briggs and Stratton has invested a significant amount of resources to help ensure that its website is made easier to use and more accessible for people with disabilities, with the strong belief ...

## FAQ & Safety Tips | Briggs & Stratton

Lawn mower or snow blower won't start? Use this Briggs & Stratton small engine repair guide for troubleshooting common problems & issues with small engines. Read More

## *Snow Blowers | Briggs & Stratton*

Get outside and power through the cold quickly and effortlessly with a Briggs & Stratton® Snow Blower. With many models and features to choose from, you'll be equipped to take on Mother ...

[Search - briggsandstratton.ca](#)

Narrow your results to the desired language. All Languages All

LanguagesAlbanianArabicAzerbaijaniBulgarianBurmeseChineseChinese ...

**Please select your language - briggsandstratton.ca**

Thank you for registering your Briggs & Stratton product (s). Click the buttons below to download or email a copy of your registration form.

**Sélectionnez votre langue - briggsandstratton.ca**

Renseignements pour les consommateurs \* Indicates a required field Civilite Please Select Dr. M.

Mlle. Mme. Rev. Prénom Nom de famille Rue Pays Province Please Select Alsace Aquitaine ...

Explore our detailed Briggs and Stratton Intek 206 parts diagram to easily identify components and streamline your repairs. Learn more for expert tips!

[Back to Home](#)