

Brightup Beard Trimmer Manual

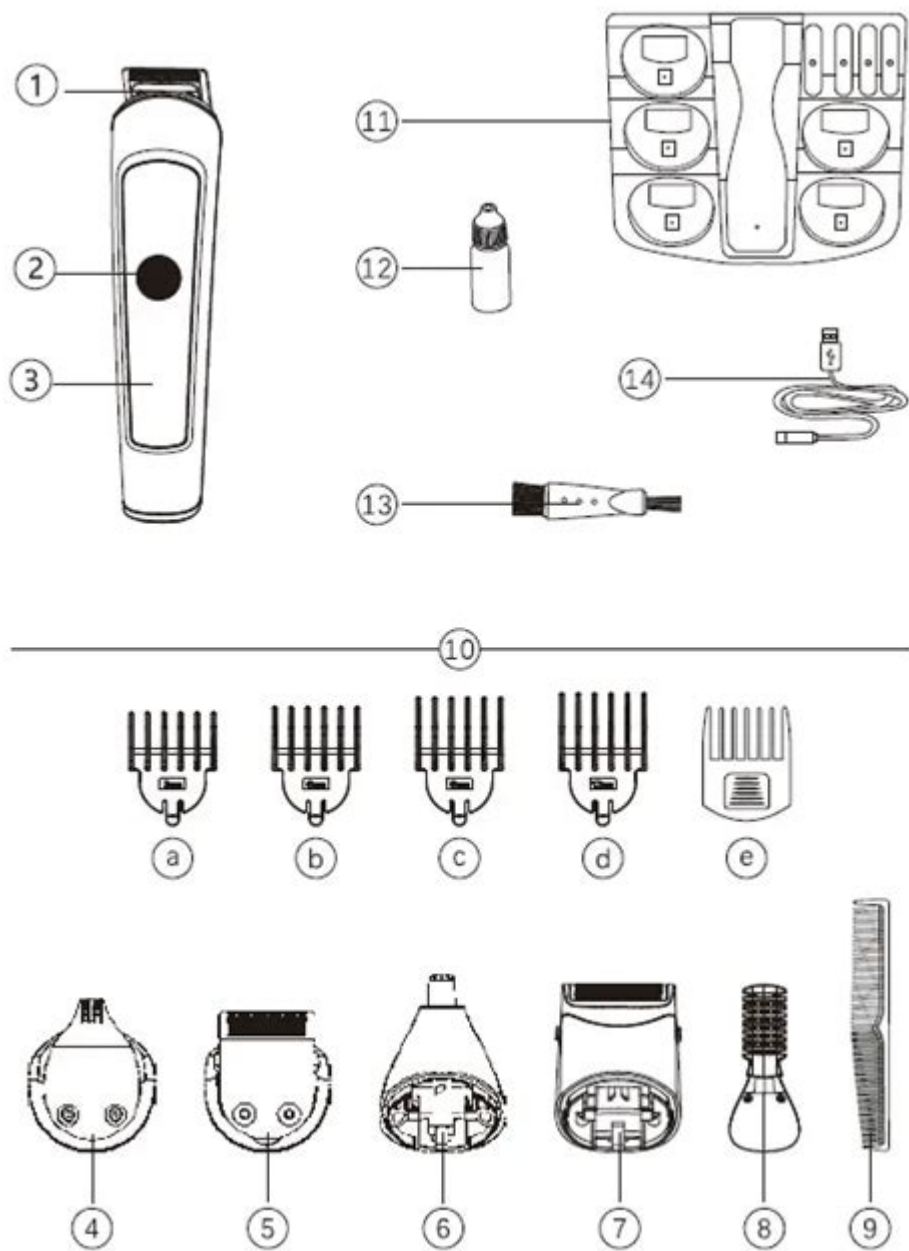

Brightup Beard Trimmer Manual

Maintaining a well-groomed beard is a vital aspect of personal grooming for many men. With the rise in popularity of various grooming tools, the Brightup Beard Trimmer stands out for its quality, versatility, and user-friendly features. This article serves as a comprehensive manual for the Brightup Beard Trimmer, guiding you through its features, usage instructions, maintenance tips, and more. Whether you are a grooming novice or an experienced user, you'll find valuable insights that will help

you achieve the perfect beard.

Introduction to the Brightup Beard Trimmer

The Brightup Beard Trimmer is designed to cater to different beard lengths and styles, providing precision and ease of use. Its sleek design, ergonomic grip, and advanced technology make it a top choice for beard enthusiasts. The trimmer is equipped with various attachments and settings, allowing users to customize their grooming experience.

Key Features of the Brightup Beard Trimmer

- Precision Blades: The trimmer features stainless steel blades that provide a clean and precise cut without irritating the skin.
- Adjustable Length Settings: With multiple length settings, users can choose the desired beard length to achieve the style they want.
- Cordless Operation: The rechargeable battery allows for cordless use, making it convenient for travel or use in various locations.
- Quick Charge Technology: The quick charge feature enables users to recharge the trimmer in a short amount of time, ensuring it's always ready for use.
- Easy Cleaning: The trimmer is designed for easy disassembly, allowing for straightforward cleaning and maintenance.
- Ergonomic Design: The trimmer's design fits comfortably in hand, reducing fatigue during extended grooming sessions.

Getting Started with Your Brightup Beard Trimmer

Before using your Brightup Beard Trimmer for the first time, it is essential to familiarize yourself with

the device and its components. Follow these steps to get started:

Unboxing Your Trimmer

Once you receive your Brightup Beard Trimmer, carefully unbox the product. Inside, you should find:

- The Brightup Beard Trimmer
- A charging cable
- Various comb attachments for different lengths
- A cleaning brush
- A user manual
- A warranty card

Charging Your Trimmer

To ensure optimal performance, charge the trimmer fully before its first use. Here's how to charge it:

1. Connect the charging cable to the trimmer.
2. Plug the other end into a power outlet.
3. Allow the trimmer to charge for at least 8 hours before first use.
4. A light indicator will show when the trimmer is charging and when it is fully charged.

Using the Brightup Beard Trimmer

Once your trimmer is charged, you can begin using it to groom your beard. Follow these steps for an efficient grooming session:

Choosing the Right Length Setting

1. Select the appropriate comb attachment based on the desired beard length.
2. Attach the comb securely to the trimmer.
3. Adjust the length setting using the dial or lever, depending on your model.

Trimming Your Beard

1. Start with clean, dry hair for the best results.
2. Turn on the trimmer and begin at the sides of your beard, moving in the direction of hair growth.
3. Use slow, even strokes for an even trim.
4. Regularly check your progress in the mirror to ensure consistency.
5. For detailing, remove the comb attachment and use the bare blades for precision trimming around the mustache and neckline.

Common Trimming Styles

Here are a few popular beard styles you can achieve with your Brightup Beard Trimmer:

- Stubble: Use the shortest length setting for a well-groomed stubble look.
- Short Beard: Opt for a medium length setting to maintain a neat short beard.
- Long Beard: For longer styles, use the longest comb attachment for trimming the bulk while maintaining length.
- Goatee: Detach the comb and meticulously trim the goatee area for a precise look.

Maintenance of Your Brightup Beard Trimmer

To ensure the longevity and performance of your Brightup Beard Trimmer, regular maintenance is essential. Follow these guidelines:

Cleaning Your Trimmer

1. After each use, detach the comb and brush off any hair clippings using the provided cleaning brush.
2. Rinse the blades under running water if your model is waterproof (check the user manual for specific instructions).
3. Allow the trimmer to dry completely before reassembling.

Oil the Blades

To maintain the sharpness and performance of the blades, it is advisable to oil them regularly. Here's how:

1. Apply a drop of trimmer oil to the blades.
2. Turn the trimmer on for a few seconds to distribute the oil evenly.
3. Wipe off any excess oil with a clean cloth.

Storing Your Trimmer

When not in use, store your Brightup Beard Trimmer in a cool, dry place. Use the provided storage pouch or case to protect it from dust and damage.

Troubleshooting Common Issues

Even with proper care, you may encounter some common issues with your trimmer. Here are solutions to potential problems:

Trimmer Won't Turn On

- Ensure the trimmer is fully charged.
- Check the connection between the charger and the trimmer.

Pulling Hair During Use

- Ensure the blades are clean and well-oiled.
- Replace the comb attachment if it is damaged.

Uneven Trimming

- Double-check the length setting and attachment.
- Maintain consistent pressure and speed while trimming.

Conclusion

The Brightup Beard Trimmer is an excellent investment for anyone looking to maintain a stylish and well-groomed beard. With its array of features, user-friendly operation, and easy maintenance, it makes the grooming process efficient and enjoyable. By following this manual, you can maximize the

use of your trimmer and achieve the perfect beard style that enhances your appearance. Remember to take good care of your trimmer, and it will serve you well for years to come. Whether you are preparing for a special occasion or simply maintaining your daily look, the Brightup Beard Trimmer is your reliable partner in grooming.

Frequently Asked Questions

How do I properly charge the BrightUp beard trimmer?

To charge the BrightUp beard trimmer, connect the provided charging cable to the trimmer and plug it into a power outlet. Allow it to charge for at least 1-2 hours for optimal performance.

What is the best way to clean the BrightUp beard trimmer?

To clean the BrightUp beard trimmer, remove the blade attachment and rinse it under running water. Use a brush to remove any hair and debris, then let it dry completely before reattaching.

Can I use the BrightUp beard trimmer while it's charging?

No, it is not recommended to use the BrightUp beard trimmer while it is charging. For safety and optimal performance, ensure the trimmer is fully charged before use.

How do I adjust the cutting length on the BrightUp beard trimmer?

To adjust the cutting length, use the adjustable comb attachment that comes with the trimmer. Slide the comb up or down to select your desired length setting.

Is the BrightUp beard trimmer waterproof?

Yes, the BrightUp beard trimmer is waterproof, allowing for easy cleaning under running water. However, avoid submerging it completely in water.

What should I do if my BrightUp beard trimmer is not turning on?

If your BrightUp beard trimmer is not turning on, first check if it is charged. If it is charged and still not working, try resetting the device or refer to the troubleshooting section of the manual.

Find other PDF article:

<https://soc.up.edu.ph/65-proof/files?trackid=vad39-0373&title=weichert-realtors-training-program.pdf>

Brightup Beard Trimmer Manual

Delta In-Flight Meal/Food Service: The Definitive Thread - FlyerTalk

Dec 30, 2024 · Delta Air Lines | SkyMiles - Delta In-Flight Meal/Food Service: The Definitive Thread — 2025 Edition - For a longish (but not transcon) domestic FC flight on Friday, I picked ...

Issues search a specific Delta flight- Error message - FlyerTalk

Apr 3, 2024 · Delta Air Lines | SkyMiles - Issues search a specific Delta flight- Error message - Good morning, I am trying to search a specific flight on Delta (I have been looking at flights for ...

Delta skymiles login issues - FlyerTalk Forums

Apr 12, 2024 · Delta Air Lines | SkyMiles - Delta skymiles login issues - Hello, I am unable to log into my Delta Skymiles account using a Windows based laptop. I can log in with no issues on ...

Oh no! We're sorry, but there was a problem processing your ...

Jan 22, 2022 · If you're checking in, an agent will be happy to assist you at the airport. If you're booking a flight or modifying an existing flight, please try again soon. For immediate ...

Delta In-Flight Meal/Food Service: The Definitive Thread - FlyerTalk

Jan 1, 2025 · Delta Air Lines | SkyMiles - Delta In-Flight Meal/Food Service: The Definitive Thread — 2025 Edition - Originally Posted by COEWR2587 First time in Delta F any recommendation ...

Delta app and website technical problems? - FlyerTalk Forums

Dec 6, 2024 · Delta Air Lines | SkyMiles - Delta app and website technical problems? - Is anyone else having issues with Delta's tech right now? This morning, it took me multiple attempts to ...

Delta In-Flight Meal/Food Service: The Definitive Thread - FlyerTalk

Aug 9, 2024 · Delta Air Lines | SkyMiles - Delta In-Flight Meal/Food Service: The Definitive Thread — 2024 Edition - On our Delta First Class Flights IAD > SEA Three Cheese Manicotti ...

Delta In-Flight Meal/Food Service: The Definitive Thread - FlyerTalk

Mar 16, 2025 · Delta Air Lines | SkyMiles - Delta In-Flight Meal/Food Service: The Definitive Thread — 2025 Edition - Originally Posted by BamaGirl Lucky you. I find the wild berry ...

Delta Offers \$30,000 to Toronto Crash Survivors - FlyerTalk

Feb 20, 2025 · Delta Air Lines says they will offer everyone aboard Delta Flight 4819 a \$30,000 payment that does not exclude them from any of their rights moving forward. Bloomberg ...

[Delta In-Flight Meal/Food Service: The Definitive Thread - FlyerTalk](#)

Jan 2, 2024 · Delta Air Lines | SkyMiles - Delta In-Flight Meal/Food Service: The Definitive Thread — 2024 Edition - Originally Posted by SkyTeam777 Is this an all egg dish or mostly tortilla ...

Thoughty2 videos are bad : r/unpopularopinion - Reddit

Sep 6, 2019 · Sources would help for those who can be bothered to go through them all, but being more careful about how he presents the information would go a long way and be ...

why does this MVP animation look so much like dio? #roblox

3 days ago · why does this MVP animation look so much like dio?[] #roblox #azurelatch #dio #mvp

Thoughty2 | Creating Mind-Blowing YouTube Videos | Patreon

Thoughty2 Creating Mind-Blowing YouTube Videos 1,633 members 587 posts Join for free

Thoughty2 | Chat with Thoughty2 AI Chatbot for a Unique ...

How does Thoughty2's approach to content creation achieve a balance between education and entertainment, particularly when tackling complex topics? What motivated the transition of the ...

[Thoughty2: Top 10 Must-Know Facts About YouTuber](#)

Thoughty2, best known for being a YouTuber, was born in England, United Kingdom on Wednesday, July 15, 1992. He has earned over 2.1 million subscribers on his popular ...

Thoughty2 Net Worth & Earnings (2025)

Jul 1, 2025 · Thoughty2 is the online alias of Arran Lomas, a British YouTuber known for his channel with over 5 million subscribers. He creates informative videos on a variety of topics, ...

how this youtuber made his videos? : r/NewTubers - Reddit

May 4, 2022 · He uses a lot of premade png's and some animations are pre made. then he just animate them . But his videos are so long. I think I would take 2 weeks to edit just 1 of his ...

Thoughty2 Net Worth: How Much Money He Makes On YouTube

Feb 1, 2024 · Thoughty2 is a British YouTuber whose real name is Arran. He has an estimated net worth of \$3.5 million. He describes himself as the gatekeeper of useless facts. His content ...

Clip Animation does not work correct in Accordion and Tabs

1 day ago · After some experiments with delay I found, that Clip respects it's delay settings, but the countdown (or, without delay, the animation) starts when Tabs / Accordion enters viewport ...

[Compatibility with 4.4 and 4.5? - Daz 3D Forums](#)

4 days ago · Does anyone know if the official DAZ Blender bridge is working with Blender 4.4 or 4.5? I tried installing it, but neither version of Blender can find the addon.

Discover how to achieve the perfect trim with our Brightup beard trimmer manual. Get tips

[Back to Home](#)