

# Belt Diagram John Deere D110

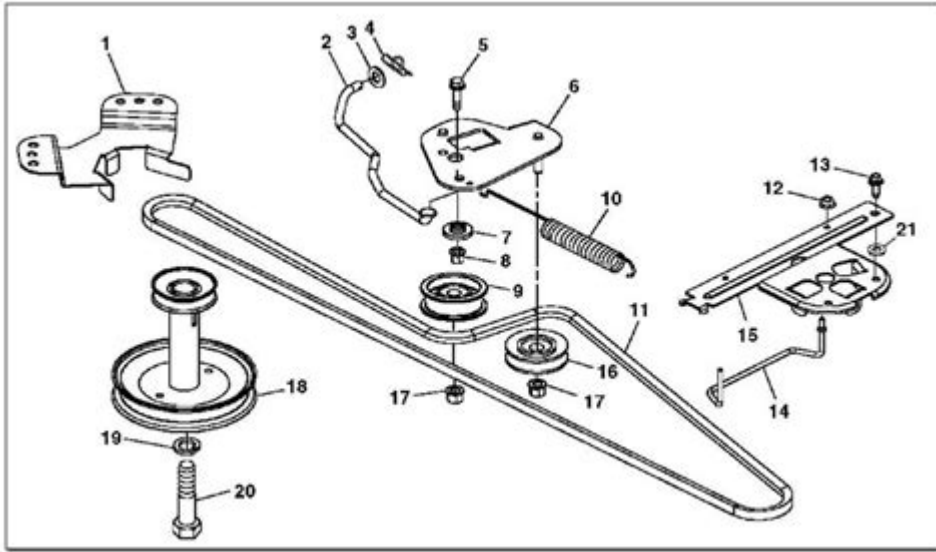

**Belt diagram John Deere D110** is an essential component for anyone looking to maintain or repair their John Deere D110 lawn tractor. Understanding the belt diagram is crucial for troubleshooting issues, replacing worn-out belts, and ensuring the overall performance of your machine. This guide will delve into the specifics of the belt diagram for the John Deere D110, helping you to navigate through its components, installation, and maintenance tips.

## Understanding the John Deere D110 Lawn Tractor

The John Deere D110 is a popular riding lawn mower known for its reliability and ease of use. With a powerful engine and user-friendly features, this model is ideal for homeowners looking to maintain their lawns with minimal effort. However, like any machinery, it requires regular maintenance to keep it running smoothly. One critical aspect of this maintenance is understanding the belt system, which drives the mower deck and provides the necessary power for cutting grass.

## Components of the Belt System

Before diving into the specifics of the belt diagram, it's essential to understand the components involved in the belt system of the John Deere D110. The primary components include:

- **Drive Belt:** This belt connects the engine to the transmission, transferring power from the engine to the wheels.

- **Deck Belt:** This belt powers the mower blades and is essential for cutting grass.
- **Pulleys:** These are the wheels around which the belts run, helping to change the direction of the power flow.
- **Idler Pulley:** This component helps to maintain tension on the belt, ensuring that it operates smoothly.

## The Importance of the Belt Diagram

The belt diagram serves as a visual guide to understanding how these components work together. It provides a roadmap for proper installation and replacement of the belts, reducing the risk of incorrect assembly, which can lead to further complications or damage.

## The Belt Diagram for John Deere D110

The belt diagram for the John Deere D110 is typically found in the owner's manual or can be accessed online. This diagram illustrates the routing of the drive and deck belts, showing how they loop around various pulleys and components.

## How to Read the Belt Diagram

When examining the belt diagram, keep these points in mind:

1. **Identify the Components:** Familiarize yourself with all the parts shown in the diagram. This includes the engine, pulleys, and the mower deck.
2. **Follow the Path:** Trace the path of the belts as they route around the pulleys. This will help you understand how the system operates.
3. **Look for Tension Points:** Note where the idler pulleys are located, as these are crucial for maintaining belt tension.

## Steps for Replacing the Belts

Replacing the belts on a John Deere D110 can seem daunting, but with the right approach, it can be done

efficiently. Here's a step-by-step guide:

1. **Gather Your Tools:** You will need basic hand tools, including wrenches, a socket set, and a screwdriver.
2. **Disconnect the Battery:** Safety first! Disconnect the battery to prevent any accidental starts.
3. **Remove the Mower Deck:** To access the deck belt, you will need to remove the mower deck. Follow the instructions in your owner's manual for this step.
4. **Inspect the Belts:** Before replacing, inspect the existing belts for wear and tear. This will help you determine if a replacement is necessary.
5. **Refer to the Belt Diagram:** Use the belt diagram to guide you in removing the old belts and installing the new ones.
6. **Install the New Belts:** Carefully route the new belts according to the diagram, ensuring that they sit properly on the pulleys.
7. **Reassemble the Mower Deck:** Once the new belts are installed, reattach the mower deck, ensuring all bolts and connections are secure.
8. **Reconnect the Battery:** Finally, reconnect the battery and test the mower to ensure everything is functioning correctly.

## Common Issues with Belts and Troubleshooting

Even with proper installation, you may encounter issues with the belts over time. Here are some common problems and their solutions:

### 1. Belt Slippage

- Symptoms: The mower blades may not engage properly, or you might notice a loss of power.
- Solution: Check the tension on the idler pulley and adjust or replace it if necessary.

## 2. Worn or Frayed Belts

- Symptoms: Visible signs of wear, cracking, or fraying on the belts.
- Solution: Replace the damaged belts immediately to avoid further damage.

## 3. Noise During Operation

- Symptoms: Unusual sounds coming from the mower when in use.
- Solution: Inspect the belts and pulleys for misalignment or debris that may be causing friction.

## Maintenance Tips for the Belt System

To prolong the life of your John Deere D110's belt system, consider the following maintenance tips:

- **Regular Inspections:** Periodically check the belts for wear and ensure they are properly aligned.
- **Clean the Mower Deck:** Keep the mower deck clean to prevent grass buildup that can strain the belts.
- **Check Tension:** Regularly check the tension on the belts and idler pulleys to ensure optimal performance.
- **Replace Worn Parts:** Don't wait until belts are severely worn. Replace them at the first sign of damage.

## Conclusion

The **belt diagram John Deere D110** is not just a technical drawing; it is a vital tool for any owner of this reliable lawn tractor. By understanding the belt system, following the replacement steps, and adhering to maintenance tips, you can ensure that your John Deere D110 will serve you well for years to come. Regular attention to the belt system will lead to a more efficient mower and a healthier lawn, making your investment worthwhile.

## Frequently Asked Questions

### What is a belt diagram for the John Deere D110 used for?

The belt diagram for the John Deere D110 shows the correct routing and placement of the drive belts in the mower, which is essential for proper operation and maintenance.

### Where can I find the belt diagram for my John Deere D110?

The belt diagram for the John Deere D110 can typically be found in the owner's manual, on the manufacturer's website, or on various repair and maintenance forums.

### What are the symptoms of a damaged belt on a John Deere D110?

Symptoms of a damaged belt on a John Deere D110 may include unusual noises, slippage, poor cutting performance, or the engine running without the blades engaging.

### How often should I check the belts on my John Deere D110?

It's recommended to check the belts on your John Deere D110 at the beginning of each mowing season and periodically throughout the season for any signs of wear or damage.

### Can I replace the belts on my John Deere D110 myself?

Yes, you can replace the belts on your John Deere D110 yourself if you have basic mechanical skills and follow the belt diagram for proper routing and installation.

### What tools do I need to replace the belts on a John Deere D110?

To replace the belts on a John Deere D110, you typically need a socket set, wrenches, a screwdriver, and possibly a belt tool for easier installation.

### How do I interpret the belt diagram for the John Deere D110?

To interpret the belt diagram for the John Deere D110, follow the arrows and labels that indicate the routing path of the belts around the pulleys and other components.

### What should I do if my John Deere D110 belt diagram is missing?

If your John Deere D110 belt diagram is missing, you can download a PDF version from the John Deere website, consult a local dealer, or find an online repair guide that includes the diagram.

Find other PDF article:

<https://soc.up.edu.ph/11-plot/Book?docid=qZp59-3321&title=career-as-an-event-planner.pdf>

## **Belt Diagram John Deere D110**

*Uber Eats Promo Code 2019 - couponsanddiscounts.com*

Get Deal Get Deal Get Deal \$10 off Get Deal \$10 off Get Deal Get Deal Aug 2, 2019 · The above promo code is valid on August 2, 2019, for a 50% discount (up to \$10 off) on the next Uber Eats ...

**?ber+eats+promo+code+2019**