

# Black Decker Instruction Manuals



## KEY INFORMATION YOU SHOULD KNOW:

- The guard must be installed before trimming or edging - if not, the motor will overheat.
- When replacing the line, use only .065" diameter ROUND line - otherwise the unit will not function properly.
- Do not bump the feed head against the ground - it will disrupt the feed mechanism.
- Angle tool slightly (5° to 10°) when trimming.

## SAVE THIS MANUAL FOR FUTURE REFERENCE.

VEA EL ESPAÑOL EN LA CONTRAPORTADA.

INSTRUCTIVO DE OPERACIÓN, CENTROS DE SERVICIO Y POLÍTICA DE GARANTÍA.

ADVERTENCIA: LEA ESTE INSTRUCTIVO ANTES DE USAR EL PRODUCTO.

Cat. No. GH600 Form No. 90512750 (USA, 107) Copyright © 2007 Black & Decker Printed in Mexico

## SAFETY GUIDELINES - DEFINITIONS

It is important for you to read and understand this manual. The information it contains relates to protecting YOUR SAFETY and PREVENTING PROBLEMS. The symbols below are used to help you recognize this information.

**⚠ DANGER:** Indicates an imminently hazardous situation which, if not avoided, will result in death or serious injury.

**⚠ WARNING:** Indicates a potentially hazardous situation which, if not avoided, could result in death or serious injury.

**⚠ CAUTION:** Indicates a potentially hazardous situation which, if not avoided, may result in minor or moderate injury.

**CAUTION:** Used without the safety alert symbol indicates potentially hazardous situation which, if not avoided, may result in property damage.

## ⚠ WARNING: IMPORTANT SAFETY WARNINGS AND INSTRUCTIONS

**⚠ WARNING:** When using gardening appliances, basic safety precautions should always be followed to reduce risk of fire, electric shock, and personal injury, including the following.

**⚠ WARNING:** Some dust created by this product contains chemicals known to the State of California to cause cancer, birth defects or other reproductive harm. Some examples of these chemicals are:

- compounds in fertilizers
- compounds in insecticides, herbicides and pesticides
- arsenic and chromium from chemically treated lumber

To reduce your exposure to these chemicals, wear approved safety equipment such as dust masks that are specially designed to filter out microscopic particles.

## READ AND UNDERSTAND ALL INSTRUCTIONS BEFORE USING.

- Before any use, be sure everyone using this garden appliance reads and understands all safety instructions and other information contained in this manual.
- Save these instructions and review frequently prior to use and in instructing others.

## ⚠ GENERAL SAFETY WARNINGS AND INSTRUCTIONS FOR ALL APPLIANCES

- **ALWAYS WEAR EYE PROTECTION** - Wear safety spectacles or goggles at all times when this tool is plugged in.
- **GUARD** - Do not use this tool without guard attached.
- **DRESS PROPERLY** - Do not wear loose clothing or jewelry. They can be caught in moving parts. Rubber gloves and substantial rubber soled footwear are recommended when working outdoors. Don't operate the tool when barefoot or wearing open sandals. Wear long pants to protect your legs. Wear protective hair covering to contain long hair.
- **NYLON LINE** - Keep face, hands and feet clear of rotating nylon line at all times.
- **THE ROTATING LINE PERFORMS A CUTTING FUNCTION** - Use care when trimming around screens and desirable plantings.
- **KEEP ALL BY-STANDERS AWAY** - at a safe distance from work area, especially children.
- **IMPORTANT WARNING** - When being used as an Edger, stones, pieces of metal and other objects can be thrown out at high speed by the line. The tool and guard are designed to reduce the danger. However, the following special precautions should be taken:
  - **MAKE SURE** that other persons and pets are at least 100 feet away.
  - **TO REDUCE THE RISK** of rebound (ricochet) injury, work going away from any nearby solid object such as wall, steps, large stone, tree, etc. Use great care when working close to solid objects and where necessary, do edging or trimming by hand.
- **AVOID ACCIDENTALLY STARTING** - Don't carry plugged-in tool with finger on trigger.
- **DO NOT FORCE THE TOOL** - at a rate faster than the rate at which it is able to cut effectively.
- **USE THE RIGHT TOOL** - Do not use this tool for any job except that for which it is intended.
- **DON'T OVERREACH** - Keep proper footing and balance at all times.
- **DON'T ABUSE CORD** - Don't yank cord from power supply. Keep cord from heat, oil, and sharp edges.
- **DAMAGE TO UNIT** - If you strike or become entangled with a foreign object, stop tool

immediately, unplug, check for damage and have any damage repaired before further operation is attempted. Do not operate with a broken hub or spool.

- **DAMAGE TO CORD** - Keep power cord away from rotating line. If you damage the cord, unplug it from the power supply before moving the tool or examining the damage. A damaged cord must be replaced before further use.

- **DISCONNECT TOOL** - when not in use, when replacing line, or prior to cleaning.

- **AVOID DANGEROUS ENVIRONMENTAL CONDITIONS** - Do not use electric tools in damp or wet locations. Follow all instructions in this Instruction Manual for proper operation of your tool. Don't use the tool in the rain.

- **DO NOT OPERATE** portable electric tools in gaseous or explosive atmospheres. Motors in these tools normally spark, and the sparks might ignite fumes.

- **STORE IDLE TOOLS Indoors** - When not in use, tools should be stored indoors in a dry, locked-up place out of reach of children.

- **GROUND FAULT CIRCUIT INTERRUPTER (GFCI)** protection should be provided on the circuits or outlets to be used for the gardening appliance. Receptacles are available having built in GFCI protection and may be used for this measure of protection.

- **SECURE EXTENSION CORD** using the cord retainer shown in Figure 5.

- **STAY ALERT** - Watch what you are doing. Use common sense. Do not operate tool when you are tired.

- **MAINTAIN APPLIANCES WITH CARE** - Follow instructions in maintenance section. Inspect extension cords periodically and replace if damaged. Keep handles dry, clean and free from oil and grease.

- **CHECK DAMAGED PARTS** - Before further use of the appliance, a guard or other part that is damaged should be carefully checked to determine that it will operate properly and perform its intended function. Check for alignment of moving parts, bending of moving parts, breakage of parts, mounting, and any other condition that may affect its operation. A guard or other part that is damaged should be properly repaired or replaced by an authorized service center unless otherwise indicated elsewhere in this manual.

- **⚠ WARNING:** When servicing double insulated tools, USE ONLY IDENTICAL REPLACEMENT PARTS. Replace or repair damaged cords.

- **⚠ WARNING:** To prevent electrical shock hazard, use only with an extension cord suitable for outdoor use. Always connect extension cords to a fused line or one protected by a circuit breaker.

## ⚠ SAFETY WARNINGS AND INSTRUCTIONS: POLARIZED PLUGS

To reduce the risk of electric shock, this equipment has a polarized plug (one blade is wider than the other) and will require the use of a polarized extension cord. The appliance plug will fit into a polarized extension cord only one way. If the plug does not fit fully into the extension cord, reverse the plug. If the plug still does not fit, obtain a correct polarized extension cord. A polarized extension cord will require the use of a polarized wall outlet. This plug will fit into the polarized wall outlet only one way. If the plug does not fit fully into the wall outlet, reverse the plug. If the plug still does not fit, contact a qualified electrician to install the proper wall outlet. Do not change the equipment plug, extension cord receptacle, or extension cord plug in any way.

## ⚠ SAFETY WARNINGS AND INSTRUCTIONS: EXTENSION CORDS

Make sure your extension cord is in good condition. When using an extension cord, be sure to use one heavy enough to carry the current your product will draw. An undersized cord will cause a drop in line voltage resulting in loss of power and overheating. The table shows the correct size to use depending on cord length and nameplate ampere rating. If in doubt, use the next heavier gauge. The smaller the gauge number, the heavier the cord. If the extension will be used outside, the cord must be suitable for outdoor work. The letters "WA" on the cord jacket indicate that the cord is suitable for outdoor use.

Voltage	Minimum Gauge for Cord Sets			
	Total Length of Cord in Feet	0-25 (0-7.5m)	26-50 (7.6-15.2m)	51-100 (15.3-30.4m)
Ampere Rating	More than	American Wire Gauge		
	Then			
120V	0 - 4	18	16	14
	6 - 10	16	14	12
	12 - 16	14	12	10
	18 - 24	12	10	8

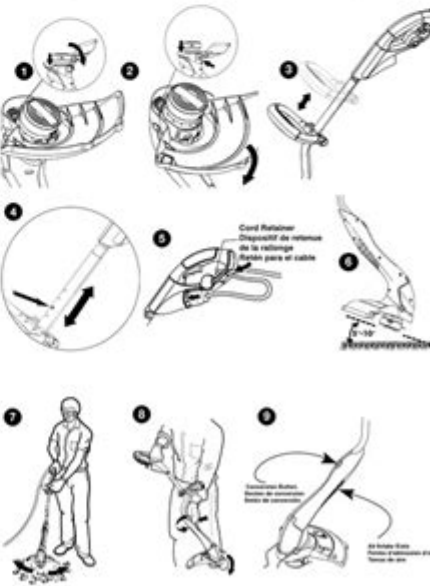

Black & Decker instruction manuals are essential resources for anyone looking to effectively operate and maintain their Black & Decker products. Renowned for their high-quality tools and appliances, Black & Decker provides a wide range of user manuals to ensure that customers can maximize the functionality and longevity of their purchases. This article delves into the various aspects of Black & Decker instruction manuals, including their significance,

how to access them, and tips for effective usage.

## **The Importance of Instruction Manuals**

Instruction manuals play a crucial role in the user experience, especially for tools and appliances that require specific operational knowledge. Here are several reasons why Black & Decker instruction manuals are invaluable:

### **1. Safety Guidelines**

- **Understanding Risks:** Many tools can be dangerous if not used correctly. Instruction manuals provide essential safety information to prevent accidents.
- **Proper Use:** They highlight the correct methods for handling equipment, which is vital to ensure user safety and to avoid damaging the product.

### **2. Product Features and Specifications**

- **Comprehensive Overview:** Manuals detail the specifications and features of the product, helping users understand all functionalities.
- **Optimizing Performance:** By understanding available features, users can enhance the performance and efficiency of their tools.

### **3. Maintenance and Care**

- **Longevity:** Regular maintenance tips included in the manuals help prolong the life of the product.
- **Troubleshooting:** Manuals often provide troubleshooting sections to help users resolve common issues quickly and efficiently.

### **4. Warranty and Support Information**

- **Warranty Guidelines:** Instruction manuals typically include information about product warranties, outlining what is covered and how to claim it.
- **Customer Support:** They provide contact information for customer service, ensuring users can get assistance when needed.

## **Accessing Black & Decker Instruction Manuals**

Finding the right instruction manual for your Black & Decker product is straightforward. Here are several ways to access these manuals:

## **1. Official Website**

- Online Database: The Black & Decker website features a dedicated section for user manuals. Users can search for their specific product by model number or name.
- PDF Downloads: Most manuals are available in PDF format, allowing users to download and print them for easy reference.

## **2. Packaging and Product Information**

- Included Manuals: Most Black & Decker products come with a physical instruction manual in the packaging. It's important to keep this manual for future reference.
- QR Codes: Some newer products may include QR codes that link directly to the online manual, providing quick access via mobile devices.

## **3. Customer Service**

- Direct Assistance: If a user cannot find their manual online, contacting Black & Decker customer service can be a helpful option. Representatives can often provide the necessary documentation or direct users to the right resources.

# **Using Black & Decker Instruction Manuals Effectively**

While accessing the manuals is essential, utilizing them effectively is equally important. Here are some tips to maximize the benefits of these resources:

## **1. Familiarize Yourself with the Manual Structure**

- Table of Contents: Start by reviewing the table of contents to understand the layout and locate the sections relevant to your needs.
- Index: Use the index at the back of the manual for quick reference to specific topics.

## **2. Follow Instructions Closely**

- Step-by-Step Guidance: Manuals provide step-by-step instructions for setup, operation, and troubleshooting. Following these closely will help avoid mistakes.
- Visual Aids: Many manuals include diagrams and illustrations. Pay attention to these, as they can clarify complex instructions.

### **3. Keep Manuals Handy**

- **Easy Access:** Store physical copies in a designated area or save digital copies on your devices for easy access when needed.
- **Regular Review:** Periodically reviewing the manual can refresh your memory on maintenance tasks or advanced features you may not use often.

### **4. Take Notes**

- **Personal Adjustments:** As you use your Black & Decker products, note any adjustments or personal tips that work for you, which can be helpful for future reference.
- **Highlight Important Sections:** Highlighting key areas in the manual can make it easier to find critical information quickly.

## **Common Products and Their Manuals**

Black & Decker manufactures a diverse array of products, including power tools, lawn care equipment, and household appliances. Here are some common categories and what to expect in their instruction manuals:

### **1. Power Tools**

- **Drills, Saws, and Sanders:** Manuals for power tools typically include safety guidelines, operational instructions, and maintenance tips. They often have diagrams showing part names and assembly instructions.
- **Battery Care:** For cordless tools, manuals will provide information on battery care and charging practices to prolong battery life.

### **2. Home Appliances**

- **Kitchen Gadgets:** Manuals for kitchen appliances like blenders, food processors, and coffee makers emphasize safety, usage tips, and cleaning guidelines.
- **Warranty Information:** Many appliance manuals include warranty details specific to electrical components.

### **3. Lawn and Garden Equipment**

- **Mowers and Trimmers:** Lawn care equipment manuals often include seasonal maintenance schedules and troubleshooting tips for common issues.
- **Safety Protocols:** Given the outdoor nature of these products, manuals emphasize safety precautions to prevent injury while operating machinery.

# Conclusion

Black & Decker instruction manuals are indispensable tools for ensuring safe, effective, and long-lasting use of their products. From understanding safety guidelines to accessing maintenance tips, these manuals empower users to get the most out of their purchases. By familiarizing yourself with the structure of these manuals, accessing them easily, and utilizing them effectively, you can enhance your overall experience with Black & Decker tools and appliances. Remember, these manuals are your best friend when navigating the world of DIY projects, home improvement, and gardening, ensuring that you operate your equipment safely and efficiently.

## Frequently Asked Questions

### **Where can I find Black & Decker instruction manuals online?**

You can find Black & Decker instruction manuals on their official website under the 'Support' section, where you can search for your specific product model.

### **Do Black & Decker instruction manuals include troubleshooting tips?**

Yes, most Black & Decker instruction manuals include a troubleshooting section that provides solutions for common issues encountered with their products.

### **Are Black & Decker instruction manuals available in multiple languages?**

Yes, many Black & Decker instruction manuals are available in multiple languages, including English, Spanish, and French, depending on the product and region.

### **What should I do if I lost my Black & Decker instruction manual?**

If you lost your Black & Decker instruction manual, you can download a PDF version from the official Black & Decker website by entering your product model number.

### **Can I get a printed version of my Black & Decker instruction manual?**

Black & Decker usually does not offer printed versions of manuals, but you

can print the PDF version from their website for personal use.

## Why are Black & Decker instruction manuals important?

Black & Decker instruction manuals are important because they provide essential information on product usage, safety guidelines, maintenance, and troubleshooting, ensuring optimal performance and safety.

Find other PDF article:

<https://soc.up.edu.ph/65-proof/files?ID=ctE44-4702&title=weiss-concise-trustee-handbook.pdf>

## Black Decker Instruction Manuals

Go Go -  
Go cgo window linux Go plan9 C  
C Go c C 2 Go ...

### Online Go Forum

5 days ago · Online Go Discussions

#### *Free Resources for Beginners - Online Go Forum*

Mar 12, 2016 · Online-Go The best place to play Go online! This is the interactive Learn to Play Go tutorial on the main OGS site. It has a clean, well-designed interface and is simple to use. It is worth checking out, even if you have already read another ...

### The 2025 US Go Congress is one month away!

Jun 13, 2025 · It's not too late to register for the 41st US Go Congress – the largest go-related activity in North America. Join us for an unforgettable week of intense competition, learning, and community-building for players of all levels! Dates: July ...

### 2025 US Go Congress - Announcements - Online Go Forum

Feb 7, 2025 · Visit the official Go Congress website at <https://www.gocongress.org> for full details on pricing, accommodations, and schedules. Whether you're a seasoned player or new to the game, the US Go Congress offers ...

### BLACK+DECKER

HELP CENTER Welcome to the Black & Decker Help Center. Here, you can connect with us, engage with fellow customers in our community section, and find answers to FAQs. We're ...

#### *Register your products | BLACK+DECKER*

Looking to register your products? Begin by starting an account on [blackanddecker.com](https://blackanddecker.com). Having an account on is like having a superpower for your BLACK+DECKER® tools and gadgets. You ...

### BLACK+DECKER

[illegible]

**Home | BLACK+DECKER**

## Workmate™ Portable Workbench, 425-To-550-Pound Capacity

## Car Vacuums | BLACK+DECKER

**Accessories + Parts | BLACK+DECKER**

## Electric Leaf Blowers | BLACK+DECKER

## Account | BLACK+DECKER

## Electric Lawn Mowers | BLACK+DECKER

Find the complete Black Decker instruction manuals you need for your tools and appliances. Get expert tips and troubleshooting advice. Learn more today!