

Badger 1 90 Manual

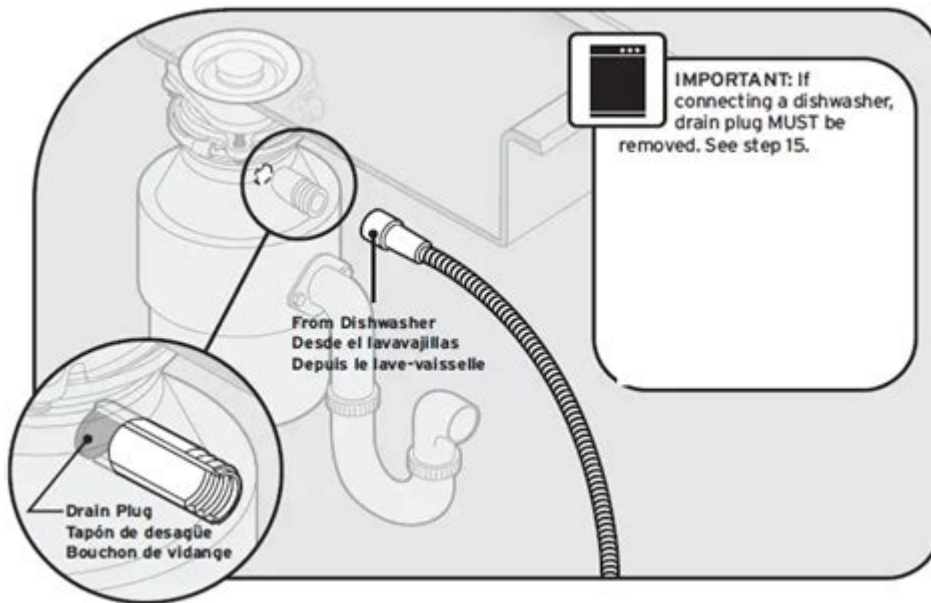

Badger 1 90 Manual is an essential resource for operators and technicians working with the Badger 1 90 series of equipment. This manual provides comprehensive guidelines, troubleshooting tips, and maintenance instructions that are crucial for ensuring the optimal performance and longevity of your machinery. In this article, we will delve into the features of the Badger 1 90, the significance of its manual, and how to effectively utilize it for better operational efficiency.

Overview of the Badger 1 90 Series

The Badger 1 90 series is designed for various applications, primarily in construction, landscaping, and municipal sectors. Its robust build and advanced technology make it a preferred choice among operators. The series is known for its versatility, efficiency, and user-friendly operation.

Key Features of the Badger 1 90

- **Powerful Engine:** The Badger 1 90 is equipped with a high-performance engine that provides ample power for demanding tasks.
- **Durable Construction:** Built with high-quality materials, the machine is designed to withstand harsh working conditions.
- **User-Friendly Interface:** Operators appreciate the intuitive controls and displays, which facilitate easy operation.
- **Versatility:** The Badger 1 90 can be used for various applications, including excavation, landscaping, and snow removal.

Importance of the Badger 1 90 Manual

The Badger 1 90 manual is not just a collection of instructions; it is a vital tool that enhances operational efficiency and safety. Here are several reasons why having this manual on hand is crucial:

1. Comprehensive Operational Guidelines

The manual provides detailed instructions on how to operate the machine effectively. This includes:

- Startup Procedures: Step-by-step guidance on starting the machine safely.
- Control Functions: An overview of the control panel and its functionalities.
- Operational Techniques: Best practices for various tasks to maximize efficiency.

2. Maintenance Tips

Regular maintenance is key to prolonging the life of the Badger 1 90. The manual includes:

- Scheduled Maintenance: A timeline for routine checks and services.
- Lubrication Points: Information on where and how to lubricate components.
- Parts Replacement: Guidance on when and how to replace worn-out parts.

3. Troubleshooting Assistance

Inevitably, machinery may encounter issues during operation. The Badger 1 90 manual offers:

- Common Problems: A list of frequent issues operators might face.
- Diagnostic Steps: A systematic approach to identify and resolve problems.
- Repair Guidance: Instructions on how to carry out minor repairs and adjustments.

How to Utilize the Badger 1 90 Manual Effectively

To get the most out of the Badger 1 90 manual, consider the following tips:

1. Familiarize Yourself with the Manual

Before operating the Badger 1 90, take the time to read through the manual thoroughly. Familiarity with the contents will help you understand the machine's capabilities and limitations.

2. Follow Safety Precautions

The manual includes important safety warnings and precautions. Always adhere to these guidelines to ensure your safety and that of those around you:

- Wear appropriate personal protective equipment (PPE).
- Keep the work area clear of obstacles.
- Ensure proper ventilation when operating in enclosed spaces.

3. Keep the Manual Accessible

Having the manual readily available during operation can be invaluable. Consider the following:

- Print a Copy: If possible, print a copy of essential sections for quick reference.
- Create a Digital Copy: Store a PDF version on your device for easy access.

Common Questions About the Badger 1 90 Manual

1. Where can I obtain a copy of the Badger 1 90 manual?

Copies of the Badger 1 90 manual can often be obtained from the manufacturer's website, authorized dealers, or by contacting customer support. Additionally, many online forums and communities may have downloadable versions shared by other users.

2. Is the Badger 1 90 manual available in multiple languages?

Many manufacturers provide manuals in various languages to accommodate a diverse user base. Check the official website or inquire with your dealer for availability.

3. Can I find troubleshooting guides online?

Yes, various online resources, including forums, user groups, and the manufacturer's website, often feature troubleshooting guides, FAQs, and community-generated content that can be helpful in resolving common issues.

Conclusion

In summary, the **Badger 1 90 manual** is an indispensable tool for anyone operating this series of machinery. By understanding its features, adhering to the operational guidelines, and utilizing the manual for maintenance and troubleshooting, operators can significantly enhance the performance and lifespan of their equipment. Make it a priority to familiarize yourself with the manual, and keep it accessible for any future reference. By doing so, you not only ensure efficient operation but also contribute to a safer working environment.

Frequently Asked Questions

What is the Badger 1 90 manual primarily used for?

The Badger 1 90 manual is primarily used for providing operational guidelines, maintenance instructions, and troubleshooting tips for the Badger 1 90 model equipment.

Where can I find a digital copy of the Badger 1 90 manual?

A digital copy of the Badger 1 90 manual can often be found on the manufacturer's official website or through authorized distributors. It may also be available in online forums or technical support websites.

What key maintenance tips are included in the Badger 1 90 manual?

The Badger 1 90 manual includes key maintenance tips such as regular oil changes, checking hydraulic fluid levels, inspecting wear parts, and keeping the equipment clean to ensure optimal performance.

Is the Badger 1 90 manual applicable to other models?

While the Badger 1 90 manual is specific to that model, some maintenance and operational guidelines may be similar across other Badger models. However, always refer to the specific manual for accurate information.

What troubleshooting steps does the Badger 1 90 manual suggest for hydraulic issues?

The Badger 1 90 manual suggests troubleshooting steps such as checking hydraulic fluid levels, inspecting for leaks, examining hoses and connections, and ensuring the pump is functioning properly.

Can I use the Badger 1 90 manual for training new operators?

Yes, the Badger 1 90 manual can be an excellent resource for training new operators, as it provides detailed operational procedures and safety guidelines necessary for effective equipment handling.

What safety precautions are highlighted in the Badger 1 90 manual?

The Badger 1 90 manual highlights safety precautions such as wearing appropriate personal protective equipment (PPE), ensuring the machine is stable before operation, and following lockout/tagout procedures during maintenance.

Find other PDF article:

<https://soc.up.edu.ph/53-scan/Book?trackid=TDK70-0107&title=short-folktales-from-around-the-world.pdf>

Badger 1 90 Manual

1st UMC JC - 1st UMC JC

Are You Getting Ready to Visit First Church? In addition to coming in person, you are invited to a virtual visit either by exploring the website, our Facebook page, or our YouTube channel.

Methodist Churches Johnson City, TN - Last Updated July 2025

Top 10 Best Methodist Churches in Johnson City, TN - July 2025 - Yelp - Bible Methodist Church Parsonage, First Broad Street United Methodist Church, Biltmore United Methodist Church, ...

Home | MunseyMemorial | Johnson City | Downtown JC

Munsey Memorial United Methodist Church located in Downtown Johnson City, Tennessee. We are an open and inclusive church that stresses Open Hearts, Open Minds and Open Doors.

Methodist Churches in Johnson City, TN - The Real Yellow Pages

Methodist Churches in Johnson City on YP.com. See reviews, photos, directions, phone numbers and more for the best Methodist Churches in Johnson City, TN.

Wesley Memorial United Methodist Church | inclusive church

Wesley Memorial United Methodist Church is open to all people. We offer both a contemporary and traditional worship service on Sunday mornings. We have learning opportunities and lots ...

[View Church Profile » Cherokee United Methodist Church 1904 Jamestown Rd Johnson City TN Tennessee](#) [View Church Profile » East Pine Grove Park United Methodist Church 2215 E ...](#)

The people of The United Methodist Church are putting our faith in action by making disciples of Jesus Christ for the transformation of the world.

Wesley Memorial UMC - Johnson City was live. The road that was traveled from the capital city of Jerusalem to Jericho was very dangerous. In 17 miles the road extended downward almost ...

Find Methodist churches in Johnson-City, Tennessee with our Local Church Finder. Church.org is the #1 platform that helps you connect with local Christian churches near you.

Top 10 Best Methodist churches in Johnson City, Tennessee - July 2025 - Bipper Media USA - Local Favorites, Top Rated Picks, Trusted Listings

Introducing Badger: A fast key-value store written natively in Go - Dgraph Blogdgraph-io/badger

Arctonyx collaris 6 ...

```

#####
[[Jesse]]Gus[[Michael]]S05E16: Fenale[[Badger]]Skinny Pete[[
[[...

```

Jun 30, 2025 · E-ATX ITX 360 ...

Dec 21, 2019 · black badger, ...

“CS400” + “Gary” ...

ISBN 0 00 000000 0

Nickname ##### Tigers ##### Bulldogs ##### Bears ...

Unlock the secrets of your Badger 1 90 with our comprehensive manual. Discover how to maximize performance and maintenance. Learn more today!

[Back to Home](#)