

# Audi Ake Engine Repair Manual

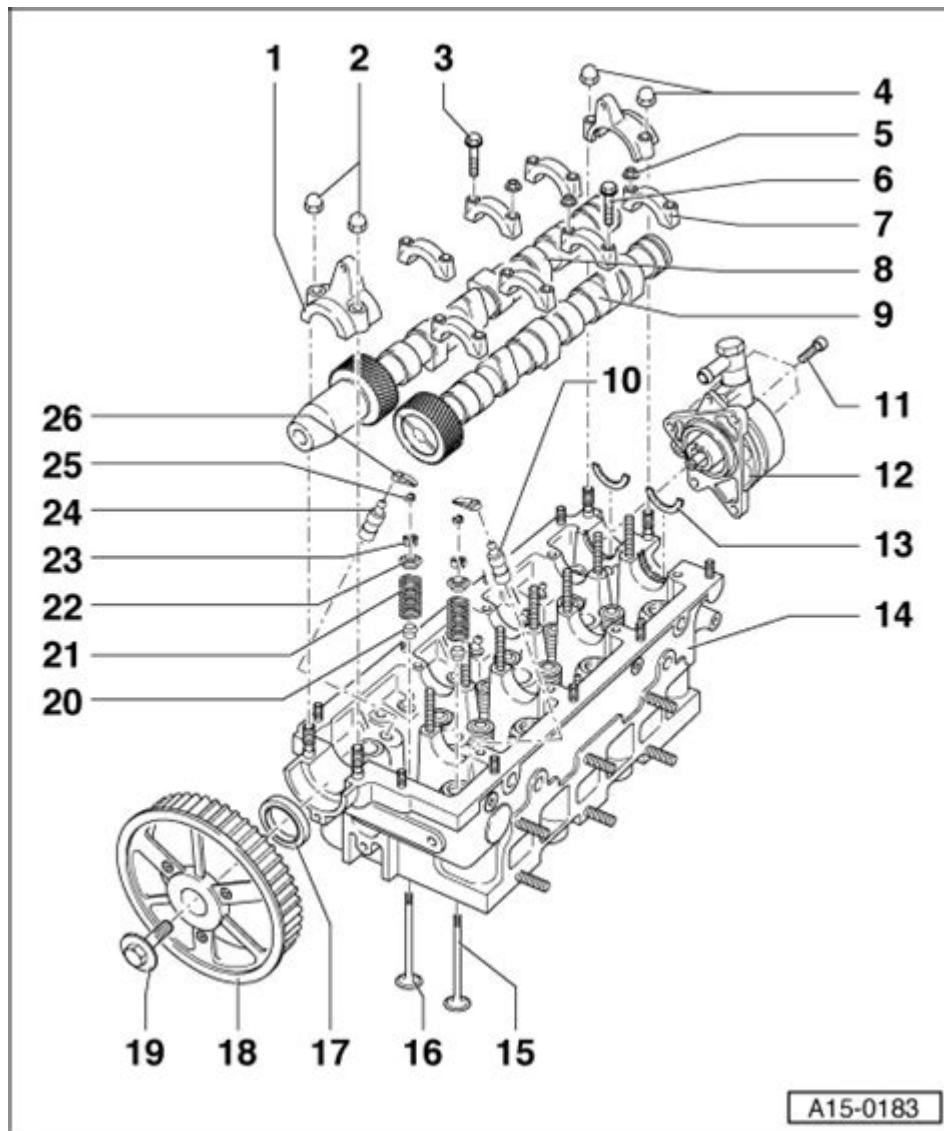

## Audi AKE Engine Repair Manual

The Audi AKE engine is a part of the renowned Audi family of engines, specifically designed for performance and reliability. As with any high-performance engine, it is crucial for owners and mechanics to have a comprehensive understanding of the repair and maintenance needs of the AKE engine. This article delves into the various aspects of the Audi AKE engine repair manual, covering essential information, common issues, repair procedures, and maintenance tips that will help you keep your engine running smoothly.

## Overview of the Audi AKE Engine

The Audi AKE engine is a 1.9 TDI (Turbocharged Direct Injection) diesel engine, known for its efficiency and power. This engine is particularly popular in models such as the Audi A4 and A6 from the early 2000s. Understanding the specifications and components of the AKE

engine is vital for any repair or maintenance tasks.

## **Specifications**

- Engine Type: 1.9-liter TDI diesel
- Power Output: Approximately 130 hp
- Torque: Up to 310 Nm
- Configuration: Inline 4-cylinder
- Fuel System: Direct injection
- Turbocharger: Yes, with intercooler

## **Common Applications**

The AKE engine is used in various Audi models as well as in some models of VW and Seat. Common applications include:

- Audi A4 (B6/B7)
- Audi A6 (C5/C6)
- VW Passat
- Seat Toledo

## **Common Issues with the AKE Engine**

Understanding common issues faced by the Audi AKE engine can help owners and mechanics proactively address potential problems. Here are some frequent concerns:

### **1. Injector Problems**

- Symptoms: Rough idling, decreased fuel efficiency, and increased emissions.
- Causes: Clogged or leaking fuel injectors.

### **2. Turbocharger Failure**

- Symptoms: Loss of power, excessive smoke, and whistling noises.
- Causes: Oil leaks, worn bearings, or foreign objects damaging the turbo.

### **3. Timing Belt Issues**

- Symptoms: Engine misfires, unusual noises, and poor performance.

- Causes: Worn or broken timing belt leading to timing issues.

## **4. EGR Valve Malfunction**

- Symptoms: Increased emissions and poor engine performance.
- Causes: Clogged EGR valve due to carbon buildup.

## **Repair Procedures**

Repairing the Audi AKE engine requires a systematic approach to ensure that all issues are addressed efficiently. Below is a detailed guide on some common repair procedures.

### **Replacing Fuel Injectors**

1. Preparation: Ensure the engine is cool and disconnect the battery.
2. Remove Engine Cover: Take off the plastic engine cover for access.
3. Disconnect Fuel Lines: Use the appropriate tools to detach fuel lines from the injectors.
4. Remove Old Injectors: Carefully extract the old injectors from their seats.
5. Install New Injectors: Insert new injectors with new O-rings and ensure a proper fit.
6. Reassemble: Reconnect fuel lines and replace the engine cover.
7. Testing: Reconnect the battery and start the engine, checking for leaks or irregularities.

### **Turbocharger Replacement**

1. Safety First: Disconnect the battery and let the engine cool.
2. Remove Air Intake: Detach the air intake hose from the turbo.
3. Disconnect Oil Lines: Carefully remove oil feed and return lines.
4. Unbolt Turbocharger: Unscrew the bolts holding the turbo in place and remove it.
5. Install New Turbo: Position the new turbocharger and secure it with bolts.
6. Reconnect Oil and Air Lines: Reattach the oil lines and air intake.
7. Final Checks: Reconnect the battery and start the engine, ensuring everything is functioning correctly.

### **Replacing the Timing Belt**

1. Preparation: Disconnect the battery and ensure the engine is cool.
2. Remove Accessory Belts: Take off the serpentine belts for better access.
3. Position Engine at TDC: Align the engine to top dead center (TDC).
4. Remove Timing Belt Cover: Unscrew and take off the timing belt cover.
5. Replace Timing Belt: Remove the old timing belt and install the new one, ensuring correct alignment.

6. Reassemble: Replace the timing cover and reattach accessory belts.
7. Testing: Start the engine and listen for unusual sounds, rechecking the timing if necessary.

## **Maintenance Tips**

Regular maintenance is key to prolonging the life of your Audi AKE engine. Here are some essential tips:

### **1. Regular Oil Changes**

- Change engine oil every 5,000 to 10,000 miles, depending on usage.
- Use high-quality synthetic oil to ensure optimal performance.

### **2. Monitor Coolant Levels**

- Check the coolant regularly and top it off as needed to prevent overheating.
- Flush the coolant system every two years to remove contaminants.

### **3. Air Filter Replacement**

- Replace the air filter every 15,000 to 30,000 miles to maintain airflow and engine efficiency.
- Inspect the filter more frequently if driving in dusty conditions.

### **4. Check and Replace Fuel Filters**

- Change the fuel filter as recommended by the manufacturer, typically every 30,000 miles.
- Ensure proper fuel flow and prevent contamination.

### **5. Inspect Belts and Hoses**

- Regularly check the condition of all belts and hoses for signs of wear or cracking.
- Replace any damaged components to avoid engine failure.

# Conclusion

The Audi AKE engine is a robust and efficient diesel engine that requires careful attention to maintenance and repair. Understanding common issues, following proper repair procedures, and adhering to a regular maintenance schedule will help ensure that your AKE engine operates at its best for years to come. Whether you're a DIY enthusiast or a professional mechanic, having access to a comprehensive repair manual for the Audi AKE engine is essential for troubleshooting and resolving issues effectively. By investing time and effort into understanding your engine, you can enhance its performance, reliability, and longevity.

## Frequently Asked Questions

### **What is the purpose of the Audi AKE engine repair manual?**

The Audi AKE engine repair manual provides detailed instructions for diagnosing, repairing, and maintaining the AKE engine, ensuring that technicians and DIY enthusiasts can effectively work on the engine.

### **Where can I find the Audi AKE engine repair manual?**

The Audi AKE engine repair manual can typically be found online through Audi's official website, automotive forums, or purchased from third-party retailers specializing in automotive repair manuals.

### **What are some common repairs covered in the Audi AKE engine repair manual?**

Common repairs covered in the Audi AKE engine repair manual include timing belt replacement, oil pump servicing, cylinder head repairs, and troubleshooting electrical issues.

### **Is the Audi AKE engine repair manual suitable for beginners?**

While the Audi AKE engine repair manual contains comprehensive information, it may be more suitable for those with some mechanical experience; beginners should approach repairs with caution or seek professional assistance.

### **Does the Audi AKE engine repair manual include wiring diagrams?**

Yes, the Audi AKE engine repair manual typically includes wiring diagrams, which are essential for understanding the electrical systems and troubleshooting any related issues.

Find other PDF article:

<https://soc.up.edu.ph/01-text/files?docid=NuT53-8524&title=2005-scion-tc-transmission-5-speed-manual.pdf>

## [Audi Ake Engine Repair Manual](#)

**Baidu** - 百度

About Baidu 百度 百度 11000002000001 ICP 030173 11220180008

百度

百度 百度 Baidu ICP 030173 11000002000001

百度\_百度

May 18, 2024 · <https://www.baidu.com/> 百度 ...

百度 - **Baidu**

百度

百度

百度

[Uranus in Gemini 101: Everything You Need to Know - Astrology ...](#)

Jun 30, 2025 · Uranus shifting into Gemini on July 7, 2025, ignites global change and personal transformation until 2033. Find out how to usher in this new era of change...

**Gemini Daily Horoscope - Astrology Answers**

Read your free online Gemini daily horoscope for today! Use these expert astrology predictions and discover what your daily horoscope has in store.

Gemini flash 2.5 -

gemini 2.0 flash: Gemini 2.5 Flash agent ide ...

**Google DeepMind Gemini 2.5** -

Gemini Gemini 200k ...

*Gemini Zodiac Sign - Astrology Answers*

Gemini has two sides. Such is the nature of the “twins,” the symbol that represents this sign. This sign has both plenty. of energy and stamina. Additionally, they’re very clever when it comes to ...

Gemini 2.0 Deep Research ...

Gemini 2.0 Flash Gemini Gemini 200k ...

#### 4. Gemini gemini AI Bard Gemini AI Transformer AI

Google [2] Gemini 2.0 Flash

👉 Gemini Cli 👉👉👉👉👉👉👉👉👉👉 Agent 👉👉👉 Claude Code 👉 Warp 👉👉👉👉👉👉👉👉👉 Gemini 2.5 pro 👉👉👉👉👉👉👉👉👉+👉 ...

Dec 12, 2024 ·  Gemini 2.0  12月11日  Gemini 2.0 

[Back to Home](#)