

# Arrma Kraton 6s Exb Parts Diagram

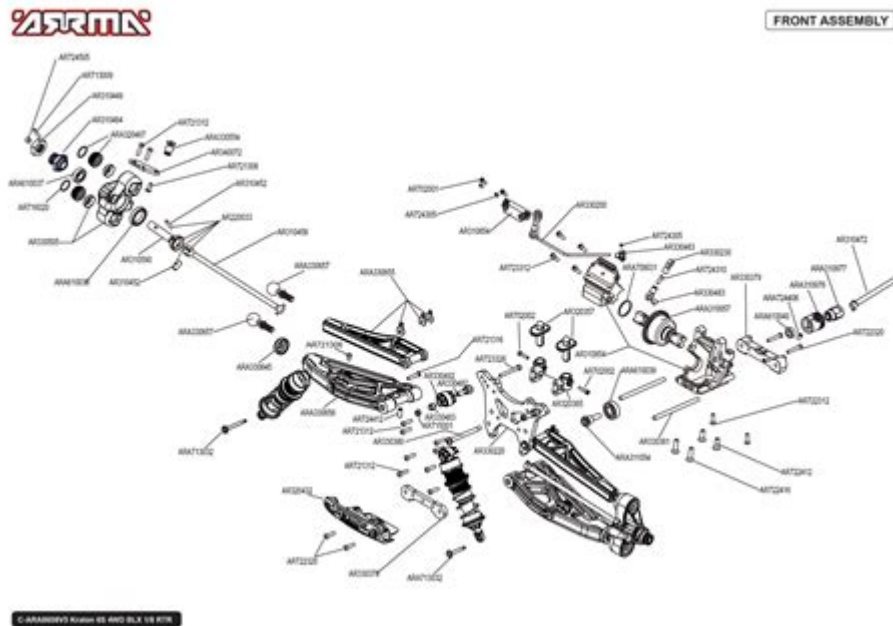

**ARRMA KRATON 6S EXB PARTS DIAGRAM** IS AN ESSENTIAL RESOURCE FOR HOBBYISTS AND ENTHUSIASTS LOOKING TO UNDERSTAND, MAINTAIN, OR UPGRADE THEIR ARRMA KRATON 6S EXB, A HIGH-PERFORMANCE, OFF-ROAD TRUCK RENOWNED FOR ITS DURABILITY AND SPEED. THIS ARTICLE WILL DELVE INTO THE VARIOUS COMPONENTS THAT COMPRISE THE KRATON 6S EXB, HOW TO INTERPRET THE PARTS DIAGRAM, AND TIPS FOR MAINTENANCE AND UPGRADES.

## UNDERSTANDING THE ARRMA KRATON 6S EXB

THE ARRMA KRATON 6S EXB (EXTREME BASH) IS A 1/8 SCALE ELECTRIC MONSTER TRUCK DESIGNED FOR EXTREME DURABILITY AND HIGH-SPEED PERFORMANCE. IT FEATURES A ROBUST CHASSIS, POWERFUL BRUSHLESS MOTOR, AND IS CAPABLE OF HANDLING VARIOUS TERRAINS, MAKING IT A FAVORITE AMONG RC ENTHUSIASTS. TO MAXIMIZE ITS PERFORMANCE AND LONGEVITY, UNDERSTANDING THE PARTS THAT MAKE UP THIS VEHICLE IS CRUCIAL.

## THE IMPORTANCE OF THE PARTS DIAGRAM

THE PARTS DIAGRAM OF THE ARRMA KRATON 6S EXB SERVES MULTIPLE PURPOSES:

- **IDENTIFICATION:** IT HELPS USERS IDENTIFY EACH COMPONENT OF THE TRUCK, MAKING IT EASIER TO PINPOINT PARTS THAT MAY NEED REPAIR OR REPLACEMENT.
- **MAINTENANCE:** UNDERSTANDING THE LAYOUT OF THE TRUCK CAN SIMPLIFY THE MAINTENANCE PROCESS, ALLOWING FOR EASIER ACCESS TO CRUCIAL AREAS.
- **UPGRADES:** FOR THOSE LOOKING TO ENHANCE THEIR VEHICLE'S PERFORMANCE, THE DIAGRAM PROVIDES INSIGHTS INTO COMPATIBLE UPGRADE PARTS.
- **ASSEMBLY:** IT IS INVALUABLE FOR THOSE ASSEMBLING THEIR TRUCK FROM SCRATCH OR AFTER DISASSEMBLY FOR REPAIRS.

# KEY COMPONENTS OF THE ARRMA KRATON 6S EXB

THE KRATON 6S EXB IS COMPOSED OF SEVERAL KEY PARTS, WHICH CAN BE CATEGORIZED AS FOLLOWS:

## 1. CHASSIS AND SUSPENSION

THE CHASSIS IS THE BACKBONE OF THE KRATON, PROVIDING STRUCTURAL SUPPORT AND HOUSING VARIOUS COMPONENTS. KEY PARTS INCLUDE:

- CHASSIS PLATE: MADE FROM DURABLE MATERIALS TO WITHSTAND IMPACTS.
- SUSPENSION ARMS: DESIGNED TO ABSORB SHOCKS AND PROVIDE STABILITY.
- SHOCK ABSORBERS: ESSENTIAL FOR DAMPENING THE EFFECTS OF ROUGH TERRAIN.

## 2. DRIVETRAIN

THE DRIVETRAIN IS CRUCIAL FOR POWER TRANSMISSION, ENSURING THAT THE VEHICLE CAN REACH HIGH SPEEDS AND HANDLE TOUGH TERRAINS. IMPORTANT COMPONENTS INCLUDE:

- MOTOR: THE BRUSHLESS MOTOR PROVIDES HIGH TORQUE AND SPEED.
- ESC (ELECTRONIC SPEED CONTROL): REGULATES THE MOTOR'S SPEED AND ENSURES SMOOTH OPERATION.
- DIFFERENTIAL GEARS: ALLOW FOR SMOOTH CORNERING BY ENABLING WHEELS TO ROTATE AT DIFFERENT SPEEDS.

## 3. WHEELS AND TIRES

THE WHEELS AND TIRES ARE VITAL FOR TRACTION AND STABILITY. KEY ELEMENTS INCLUDE:

- RIMS: LIGHTWEIGHT YET STRONG TO HANDLE ROUGH CONDITIONS.
- TIRES: DESIGNED WITH UNIQUE TREAD PATTERNS FOR VARIOUS TERRAINS, OFFERING GRIP AND CONTROL.

## 4. ELECTRONICS

THE ELECTRONICS OF THE KRATON 6S EXB ARE ESSENTIAL FOR ITS PERFORMANCE:

- RECEIVER: COMMUNICATES BETWEEN THE TRANSMITTER AND THE VEHICLE.
- SERVO: RESPONSIBLE FOR STEERING AND CONTROL.
- BATTERY: HIGH-CAPACITY LiPo BATTERIES PROVIDE THE NECESSARY POWER FOR EXTENDED RUNS.

## 5. BODY AND AESTHETICS

WHILE PERFORMANCE IS KEY, THE BODY DESIGN OF THE KRATON IS ALSO IMPORTANT:

- BODY SHELL: AERODYNAMIC DESIGN THAT PROTECTS INTERNAL COMPONENTS.
- PAINT AND DECALS: CUSTOMIZABLE OPTIONS TO PERSONALIZE THE TRUCK'S APPEARANCE.

# HOW TO READ THE PARTS DIAGRAM

UNDERSTANDING THE PARTS DIAGRAM IS STRAIGHTFORWARD BUT MAY REQUIRE SOME FAMILIARITY WITH RC TERMINOLOGY. HERE'S HOW TO INTERPRET IT EFFECTIVELY:

1. **LOCATE THE KEY:** MOST DIAGRAMS WILL HAVE A KEY OR LEGEND EXPLAINING THE SYMBOLS AND NUMBERS USED.
2. **IDENTIFY COMPONENTS:** EACH PART IS LABELED, USUALLY WITH A NUMBER CORRESPONDING TO A PARTS LIST.
3. **CHECK THE PARTS LIST:** THIS LIST PROVIDES DETAILED INFORMATION ABOUT EACH COMPONENT, INCLUDING PART NUMBERS AND DESCRIPTIONS.
4. **REFER TO MANUFACTURER RESOURCES:** FOR ADDITIONAL INFORMATION, REFER TO THE MANUFACTURER'S WEBSITE FOR MANUALS AND ASSEMBLY GUIDES.

## COMMON MAINTENANCE TIPS

REGULAR MAINTENANCE IS ESSENTIAL TO KEEP YOUR ARRMA KRATON 6S EXB RUNNING SMOOTHLY. HERE ARE SOME TIPS:

- **REGULAR CLEANING:** AFTER EACH RUN, CLEAN THE TRUCK TO REMOVE DIRT AND DEBRIS THAT CAN AFFECT PERFORMANCE.
- **CHECK FOR LOOSE PARTS:** INSPECT SCREWS AND BOLTS, ENSURING EVERYTHING IS TIGHT AND SECURE.
- **INSPECT THE BATTERY:** REGULARLY CHECK THE BATTERY FOR SIGNS OF WEAR AND ENSURE IT IS CHARGED CORRECTLY.
- **LUBRICATE MOVING PARTS:** USE APPROPRIATE LUBRICANTS ON GEARS AND BEARINGS TO REDUCE FRICTION AND WEAR.
- **MONITOR TIRE CONDITION:** REGULARLY INSPECT TIRES FOR WEAR AND REPLACE THEM AS NEEDED TO MAINTAIN TRACTION.

## UPGRADING YOUR ARRMA KRATON 6S EXB

UPGRADING SPECIFIC COMPONENTS OF YOUR KRATON CAN DRAMATICALLY ENHANCE ITS PERFORMANCE AND DURABILITY. HERE ARE SOME POPULAR UPGRADES:

### 1. MOTOR AND ESC UPGRADE

UPGRADING TO A HIGHER KV MOTOR OR A MORE ADVANCED ESC CAN INCREASE SPEED AND RESPONSIVENESS. ENSURE COMPATIBILITY WITH EXISTING PARTS.

### 2. SUSPENSION ENHANCEMENTS

CONSIDER UPGRADING TO ALUMINUM OR AFTERMARKET SUSPENSION ARMS FOR IMPROVED DURABILITY AND PERFORMANCE. ADJUSTABLE SHOCK ABSORBERS CAN ALSO PROVIDE BETTER HANDLING.

### 3. WHEEL AND TIRE UPGRADES

SWITCHING TO HIGH-PERFORMANCE TIRES CAN IMPROVE TRACTION AND HANDLING ON DIFFERENT TERRAINS. LIGHTWEIGHT RIMS CAN ALSO REDUCE ROTATIONAL MASS, ENHANCING ACCELERATION.

### 4. BATTERY IMPROVEMENTS

INVEST IN HIGH-CAPACITY LIPO BATTERIES FOR LONGER RUN TIMES AND INCREASED POWER DELIVERY. ENSURE THAT THE BATTERY FITS WITHIN THE TRUCK'S DESIGNATED SPACE.

## CONCLUSION

THE **ARRMA KRATON 6S EXB PARTS DIAGRAM** IS AN INVALUABLE TOOL FOR ANYONE LOOKING TO MAINTAIN OR UPGRADE THEIR RC TRUCK. BY UNDERSTANDING THE VARIOUS COMPONENTS AND HOW TO INTERPRET THE DIAGRAM, USERS CAN EFFECTIVELY TROUBLESHOOT ISSUES, PERFORM NECESSARY MAINTENANCE, AND EXPLORE POTENTIAL UPGRADES. WHETHER YOU'RE A SEASONED PRO OR JUST STARTING IN THE WORLD OF RC VEHICLES, HAVING A COMPREHENSIVE UNDERSTANDING OF YOUR KRATON WILL ENSURE AN ENJOYABLE AND HIGH-PERFORMANCE EXPERIENCE ON THE TRACK OR TRAIL.

## FREQUENTLY ASKED QUESTIONS

### WHAT IS THE PURPOSE OF THE PARTS DIAGRAM FOR THE ARRMA KRATON 6S EXB?

THE PARTS DIAGRAM PROVIDES A VISUAL REPRESENTATION OF ALL THE COMPONENTS OF THE ARRMA KRATON 6S EXB, HELPING USERS IDENTIFY PARTS FOR MAINTENANCE, REPAIR, OR UPGRADES.

### WHERE CAN I FIND THE OFFICIAL PARTS DIAGRAM FOR THE ARRMA KRATON 6S EXB?

THE OFFICIAL PARTS DIAGRAM CAN BE FOUND ON THE ARRMA WEBSITE OR IN THE USER MANUAL THAT COMES WITH THE VEHICLE.

### ARE THERE ANY COMMON UPGRADES AVAILABLE FOR THE ARRMA KRATON 6S EXB THAT ARE LISTED IN THE PARTS DIAGRAM?

YES, COMMON UPGRADES SUCH AS ALUMINUM PARTS, HIGH-PERFORMANCE SHOCK ABSORBERS, AND UPGRADED DRIVE SHAFTS ARE TYPICALLY DETAILED IN THE PARTS DIAGRAM AND AVAILABLE FOR PURCHASE.

### HOW CAN I USE THE PARTS DIAGRAM TO TROUBLESHOOT ISSUES WITH MY ARRMA KRATON 6S EXB?

YOU CAN USE THE PARTS DIAGRAM TO LOCATE SPECIFIC COMPONENTS THAT MAY BE MALFUNCTIONING, ALLOWING YOU TO IDENTIFY WHICH PARTS NEED INSPECTION OR REPLACEMENT.

### IS THE PARTS DIAGRAM FOR THE ARRMA KRATON 6S EXB AVAILABLE IN DIGITAL FORMAT?

YES, THE PARTS DIAGRAM IS OFTEN AVAILABLE IN PDF FORMAT FOR DOWNLOAD FROM THE ARRMA WEBSITE, MAKING IT EASY TO ACCESS AND PRINT.

## WHAT SHOULD I DO IF I CAN'T FIND A SPECIFIC PART IN THE ARRMA KRATON 6S EXB PARTS DIAGRAM?

IF YOU CAN'T FIND A SPECIFIC PART, YOU CAN CONTACT ARRMA CUSTOMER SUPPORT OR CHECK ONLINE FORUMS AND COMMUNITIES FOR ASSISTANCE FROM OTHER USERS.

Find other PDF article:

<https://soc.up.edu.ph/59-cover/files?dataid=FuA12-9021&title=the-enormous-egg-oliver-butterworth.pdf>

## [Arrma Kraton 6s Exb Parts Diagram](#)

### **ARRMA RC Forum**

Jul 10, 2025 · Arrma Forum is the #1 community for owners of the Arrma Granite, Kraton, Fury, Talion and the rest of the Arrma RC models!

#### Kraton - Newbie introduction | ARRMA RC Forum

Feb 12, 2022 · Hey all! First, this forum is awesome and has helped me greatly get my Kraton 6S EBX roller up and running. It was a Christmas present from my wife as my 30 year old Futaba Stadium Racer had to be put to rest. I am loving the Kraton 6S. I am using BLX185 ESC, GoolRC 4076 2000KV 4P motor...

### **Repository of Useful Free RC 3D Print Designs (Updated 05/2025)**

Mar 2, 2023 · I wanted to create a repository of free to use 3D designs that are in one organized place. I will do my best to update the thread as new designs are posted. One old thread was from 2020 so please be patient as I work through this and try to keep it maintained. I ...

#### Grom - Tire options | ARRMA RC Forum

Feb 6, 2024 · Are there any alternate tire options? Preferably 10-15mm larger and under \$40-\$50. So far I've put some lightning epx drift tires and those are fun to drift it with.

#### Gorgon - Gorgon Tips and Tricks | ARRMA RC Forum

Oct 28, 2023 · I've done a few things to my Gorgon, and figured I'd share a few things with you to make it easier if you want to do the same. 1. Mounting a different body. Many of you who already own other Arrmas, particularly 6s, will recognize these. They can be bought in many different lengths, and are...

#### Stock Gorgon Battery upgrade options - ARRMA RC Forum

Jan 5, 2024 · The stock battery and charger are sooo slow to charge and seems to give me only ten minutes of run time before I'm done bashing. Can someone suggest a lipo battery that I can use with this charger that would fit in the gorgon and give me a little more run time...

### **Grom - Typhon Grom Servo Upgrade | ARRMA RC Forum**

Apr 13, 2024 · Does anyone have any reasonably priced servo upgrade recommendations?

#### Fireteam - Battery question? | ARRMA RC Forum

Nov 27, 2022 · Hey guys just picked up a FIRETEAM!!!! I have a quick question, i have to buy a couple more 3s or 6s batteries. But my question is can i run on a single 3s until i get them or will it ruin anything?

### **Vorteks - Recommended servo upgrade | ARRMA RC Forum**

Dec 26, 2023 · Hi, After the first 6 months of fairly solid use, the servo on my son's Vorteks has stopped working (throttle and brakes still operate). Can anyone in the know, offer suggestions for a decent upgraded servo replacement from the standard factory-fitted servo? Thanks!

### **How to shim your diff (with pictures) - ARRMA RC Forum**

Aug 22, 2018 · 4 : Planetary and satellite shim We have already added one shim under the planetary (diffcup) at the previous step. It's a good starting point but maybe you will find that with more or less it's better for your diff. I replaced all the stock satellite shims 3.5x12 with the mugen ones. If you have different shims, try different combination to add a little more thickness to the ...

### **ARRMA RC Forum**

Jul 10, 2025 · Arrma Forum is the #1 community for owners of the Arrma Granite, Kraton, Fury, Talion and the rest of the Arrma RC models!

### *Kraton - Newbie introduction | ARRMA RC Forum*

Feb 12, 2022 · Hey all! First, this forum is awesome and has helped me greatly get my Kraton 6S EBX roller up and running. It was a Christmas present from my wife as my 30 year old Futaba ...

### **Repository of Useful Free RC 3D Print Designs (Updated 05/2025)**

Mar 2, 2023 · I wanted to create a repository of free to use 3D designs that are in one organized place. I will do my best to update the thread as new designs are posted. One old thread was ...

### Grom - Tire options | ARRMA RC Forum

Feb 6, 2024 · Are there any alternate tire options? Preferably 10-15mm larger and under \$40-\$50. So far I've put some lightning epx drift tires and those are fun to drift it with.

### Gorgon - Gorgon Tips and Tricks | ARRMA RC Forum

Oct 28, 2023 · I've done a few things to my Gorgon, and figured I'd share a few things with you to make it easier if you want to do the same. 1. Mounting a different body. Many of you who ...

### *Stock Gorgon Battery upgrade options - ARRMA RC Forum*

Jan 5, 2024 · The stock battery and charger are sooo slow to charge and seems to give me only ten minutes of run time before I'm done bashing. Can someone suggest a lipo battery that I ...

### *Grom - Typhon Grom Servo Upgrade | ARRMA RC Forum*

Apr 13, 2024 · Does anyone have any reasonably priced servo upgrade recommendations?

### **Fireteam - Battery question? | ARRMA RC Forum**

Nov 27, 2022 · Hey guys just picked up a FIRETEAM!!!! I have a quick question, i have to buy a couple more 3s or 6s batteries. But my question is can i run on a single 3s until i get them or ...

### **Vorteks - Recommended servo upgrade | ARRMA RC Forum**

Dec 26, 2023 · Hi, After the first 6 months of fairly solid use, the servo on my son's Vorteks has stopped working (throttle and brakes still operate). Can anyone in the know, offer suggestions ...

### **How to shim your diff (with pictures) - ARRMA RC Forum**

Aug 22, 2018 · 4 : Planetary and satellite shim We have already added one shim under the planetary (diffcup) at the previous step. It's a good starting point but maybe you will find that ...

Explore the Arrma Kraton 6S EXB parts diagram for detailed insights and troubleshooting tips. Discover how to enhance your RC experience today!

[Back to Home](#)