

# Arjo Maxi Move Repair Manual

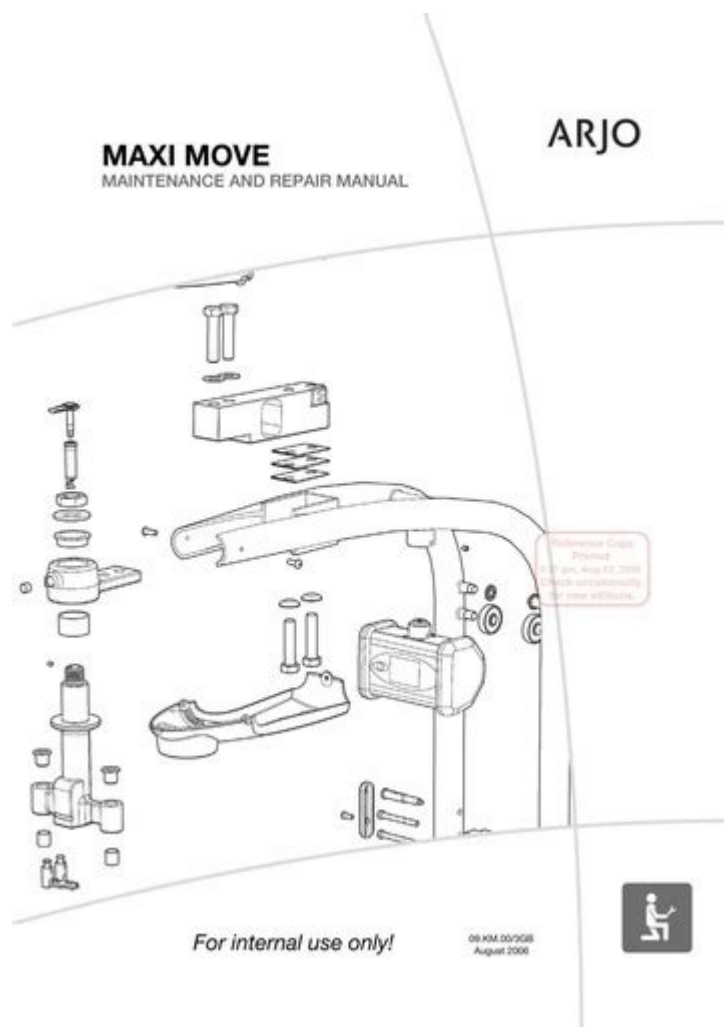

## Arjo Maxi Move Repair Manual

The Arjo Maxi Move is a versatile patient lift designed to enhance the safety and comfort of both patients and caregivers during mobility assistance. While these devices are built for durability and reliability, like any mechanical equipment, they may require maintenance and repairs at some point to ensure optimal performance. This comprehensive article serves as a guide to the Arjo Maxi Move repair manual, detailing common issues, maintenance tips, and repair procedures to help caregivers and technicians keep this important equipment in top working condition.

## Understanding the Arjo Maxi Move

The Arjo Maxi Move is engineered to support patients who require assistance with mobility due to medical conditions or disabilities. Its primary features include:

- **User-Friendly Controls:** Simple controls that allow caregivers to operate the lift smoothly and efficiently.

- Adjustable Sling Options: Various sling configurations to accommodate different patient sizes and conditions.
- Lifting Capacity: Typically can lift patients weighing up to 300 kg (660 lbs), depending on the model.
- Maneuverability: Designed for easy navigation in tight spaces, making it suitable for home care and hospital settings.

## **Importance of Regular Maintenance**

Regular maintenance ensures the longevity and reliability of the Arjo Maxi Move. Neglecting maintenance can lead to:

- Increased Wear and Tear: Components may wear out quicker without proper care.
- Safety Risks: Malfunctions can pose risks to both patients and caregivers.
- Increased Repair Costs: Addressing issues early can prevent more extensive damage and higher repair costs later.

## **Routine Maintenance Checks**

Perform routine checks on the Arjo Maxi Move to ensure it operates correctly and safely. Key areas to focus on include:

### **1. Battery and Charging System:**

- Regularly inspect the battery for signs of wear or damage.
- Ensure that the charger is functioning correctly and connections are secure.
- Charge the battery according to the manufacturer's recommendations.

### **2. Mechanical Components:**

- Check the lifting mechanism for smooth operation.
- Inspect joints and hinges for any signs of wear or corrosion.
- Ensure that wheels and casters are free from obstruction and move smoothly.

### **3. Sling and Safety Features:**

- Inspect slings for tears, fraying, or damage.
- Ensure safety straps and buckles are functional.
- Verify that emergency stop features are operational.

## **Troubleshooting Common Issues**

Even with regular maintenance, issues may arise. Here are some common problems with the Arjo Maxi Move and troubleshooting steps:

## 1. Device Not Lifting

If the lift fails to operate:

- Check the Battery: Ensure the battery is charged and properly connected.
- Inspect the Remote Control: Test the remote for functionality; replace batteries if necessary.
- Examine the Lift Mechanism: Look for any obstructions or mechanical failures.

## 2. Noisy Operation

If the lift makes unusual noises during operation:

- Check for Loose Parts: Inspect all screws and bolts to ensure they are tight.
- Lubricate Moving Parts: Apply appropriate lubricant to joints and hinges as needed.
- Inspect Wheels and Casters: Ensure they are free from debris that may cause noise.

## 3. Difficulty Maneuvering

If the lift is hard to move:

- Inspect the Wheels: Ensure they are clean and free from obstruction.
- Check Weight Distribution: Ensure that the patient is centered in the sling.
- Examine the Casters: Look for signs of wear or damage that may impede movement.

## Repair Procedures

In some cases, repairs may be necessary. Here are general guidelines for common repairs based on the Arjo Maxi Move repair manual.

### 1. Replacing the Battery

If the battery is no longer holding a charge, a replacement may be necessary.

- Step 1: Ensure the lift is turned off and unplugged from the power source.
- Step 2: Open the battery compartment, usually located at the base of the lift.
- Step 3: Disconnect the old battery by removing the terminal connectors.
- Step 4: Install the new battery by connecting the terminals securely.
- Step 5: Close the battery compartment and charge the new battery fully before use.

## 2. Repairing the Lift Mechanism

If the lift mechanism is not functioning correctly:

- Step 1: Turn off the device and disconnect from power.
- Step 2: Remove any covers to access the lifting mechanism.
- Step 3: Inspect cables and gears for signs of damage or wear.
- Step 4: Replace any damaged components following the manufacturer's specifications.
- Step 5: Reassemble the lift, ensuring all parts are securely in place.

## 3. Sling Replacement

If the sling is worn or damaged, it needs to be replaced.

- Step 1: Remove the old sling from the lift by detaching it from the hooks or loops.
- Step 2: Select the appropriate replacement sling based on the patient's needs.
- Step 3: Attach the new sling securely to the lift, ensuring it is positioned correctly.
- Step 4: Test the sling's security before use.

## Conclusion

The Arjo Maxi Move is an essential tool in patient care, providing comfort and safety during mobility assistance. Regular maintenance and troubleshooting can significantly reduce the likelihood of major repairs, ensuring that the device functions efficiently. By following the guidelines outlined in this repair manual, caregivers and technicians can effectively maintain and repair the Arjo Maxi Move, ensuring that it continues to serve its vital purpose in healthcare settings. Always refer to the specific repair manual provided by Arjo for detailed instructions and safety precautions tailored to your model. Regular training for caregivers on operating the lift and understanding its maintenance will further enhance its safety and efficiency in use.

## Frequently Asked Questions

### **What is the purpose of the Arjo Maxi Move repair manual?**

The Arjo Maxi Move repair manual provides detailed instructions for diagnosing, servicing, and repairing the Maxi Move patient lift, ensuring it operates safely and efficiently.

### **Where can I find the Arjo Maxi Move repair manual?**

The repair manual for the Arjo Maxi Move can typically be found on the official Arjo website, in the support section, or by contacting Arjo customer service for a copy.

## **What common issues does the Arjo Maxi Move repair manual address?**

The manual addresses common issues such as battery failures, mechanical malfunctions, and troubleshooting for error codes displayed on the device.

## **Is the Arjo Maxi Move repair manual available in multiple languages?**

Yes, the Arjo Maxi Move repair manual is often available in several languages to accommodate users in different regions.

## **Can I perform repairs on the Arjo Maxi Move without professional training?**

While some minor maintenance tasks can be performed without professional training, it is recommended to have a qualified technician handle repairs to ensure safety and compliance with regulations.

## **What safety precautions should I follow when using the Arjo Maxi Move repair manual?**

Always ensure the device is powered off, use appropriate personal protective equipment, and follow the detailed safety guidelines outlined in the repair manual.

## **How often should I refer to the Arjo Maxi Move repair manual?**

It is advisable to refer to the repair manual whenever servicing the device or when encountering issues to ensure proper maintenance and troubleshooting.

## **Does the Arjo Maxi Move repair manual include troubleshooting tips?**

Yes, the repair manual includes a troubleshooting section that provides tips for diagnosing and resolving common problems with the Maxi Move lift.

## **What tools are recommended for repairs as per the Arjo Maxi Move repair manual?**

The manual typically recommends basic hand tools like screwdrivers, wrenches, and pliers, as well as specialized tools for specific repairs, which are outlined in the manual.

Find other PDF article:

<https://soc.up.edu.ph/01-text/pdf?dataid=sqP76-2372&title=1998-jeep-grand-cherokee-radio-wiring-diagram.pdf>

# [Arjo Maxi Move Repair Manual](#)

## **ARJO B | 0,23% - Avanza**

Arjo är verksamt inom medicinteknikbranschen och fokuserar på utveckling, tillverkning och distribution av medicinsk utrustning för patienthantering och rehabilitering. Bolagets produkter ...

## **Aktiescreener - Avanza**

Hitta och köp aktier från aktielistor och jämför aktiekurser på Stockholmsbörsen och andra börser i världen. Välj bland ett stort utbud till ett lågt courtage.

## **Lannebo Sustainable Corporate Bond A SEK - Avanza**

Lannebo Sustainable Corporate Bond är en aktivt förvaltd räntefond som huvudsakligen investerar i företagsobligationer utgivna av företag i Norden och till viss del i övriga Europa. ...

## **She Invest Sweden - handla fonden | Avanza**

Handla fonden She Invest Sweden hos oss. Vi har över 1200 fonder att välja bland. Bli kund gratis på 3 min med BankID!

## *Strand Småbolagsfond - handla fonden | Avanza*

Handla fonden Strand Småbolagsfond hos oss. Vi har över 1200 fonder att välja bland. Bli kund gratis på 3 min med BankID!

## **Uppdaterade belåningsvärden svenska aktier höst 2022 - Avanza**

Uppdaterade belåningsvärden svenska aktier höst 2022

## **Blankningsbara värdepapper - Avanza**

Avanza erbjuder ett enklare sparande i fonder och aktier. Kom igång med ett sparande på 3 minuter. Välkommen till Avanza - en bank som den borde vara.

## **ARJO B | 0,23% - Avanza**

Arjo är verksamt inom medicinteknikbranschen och fokuserar på utveckling, tillverkning och distribution av medicinsk utrustning för patienthantering och rehabilitering. Bolagets produkter riktar sig till sjukvårdsinstitutioner och vårdhem. Verksamheten är global med en huvudsaklig närvaro i Europa, Nordamerika och Asien.

## **Aktiescreener - Avanza**

Hitta och köp aktier från aktielistor och jämför aktiekurser på Stockholmsbörsen och andra börser i världen. Välj bland ett stort utbud till ett lågt courtage.

## *Lannebo Sustainable Corporate Bond A SEK - Avanza*

Lannebo Sustainable Corporate Bond är en aktivt förvaltd räntefond som huvudsakligen investerar i företagsobligationer utgivna av företag i Norden och till viss del i övriga Europa. Fonden investerar i gröna obligationer\*, obligationer utgivna av företag som bedöms vara hållbara eller som producerar varor eller tjänster som syftar till att lösa hållbarhetsutmaningar. Det ...

## [She Invest Sweden - handla fonden | Avanza](#)

Handla fonden She Invest Sweden hos oss. Vi har över 1200 fonder att välja bland. Bli kund gratis på 3 min med BankID!

### **Strand Småbolagsfond - handla fonden | Avanza**

Handla fonden Strand Småbolagsfond hos oss. Vi har över 1200 fonder att välja bland. Bli kund gratis på 3 min med BankID!

### *Uppdaterade belåningsvärden svenska aktier höst 2022 - Avanza*

Uppdaterade belåningsvärden svenska aktier höst 2022

### *Blankningsbara värdepapper - Avanza*

Avanza erbjuder ett enklare sparande i fonder och aktier. Kom igång med ett sparande på 3 minuter. Välkommen till Avanza – en bank som den borde vara.

"Need help with your Arjo Maxi Move? Access our comprehensive repair manual for step-by-step guidance. Learn more to keep your equipment in top shape!"

[Back to Home](#)