

American Range Parts Diagram

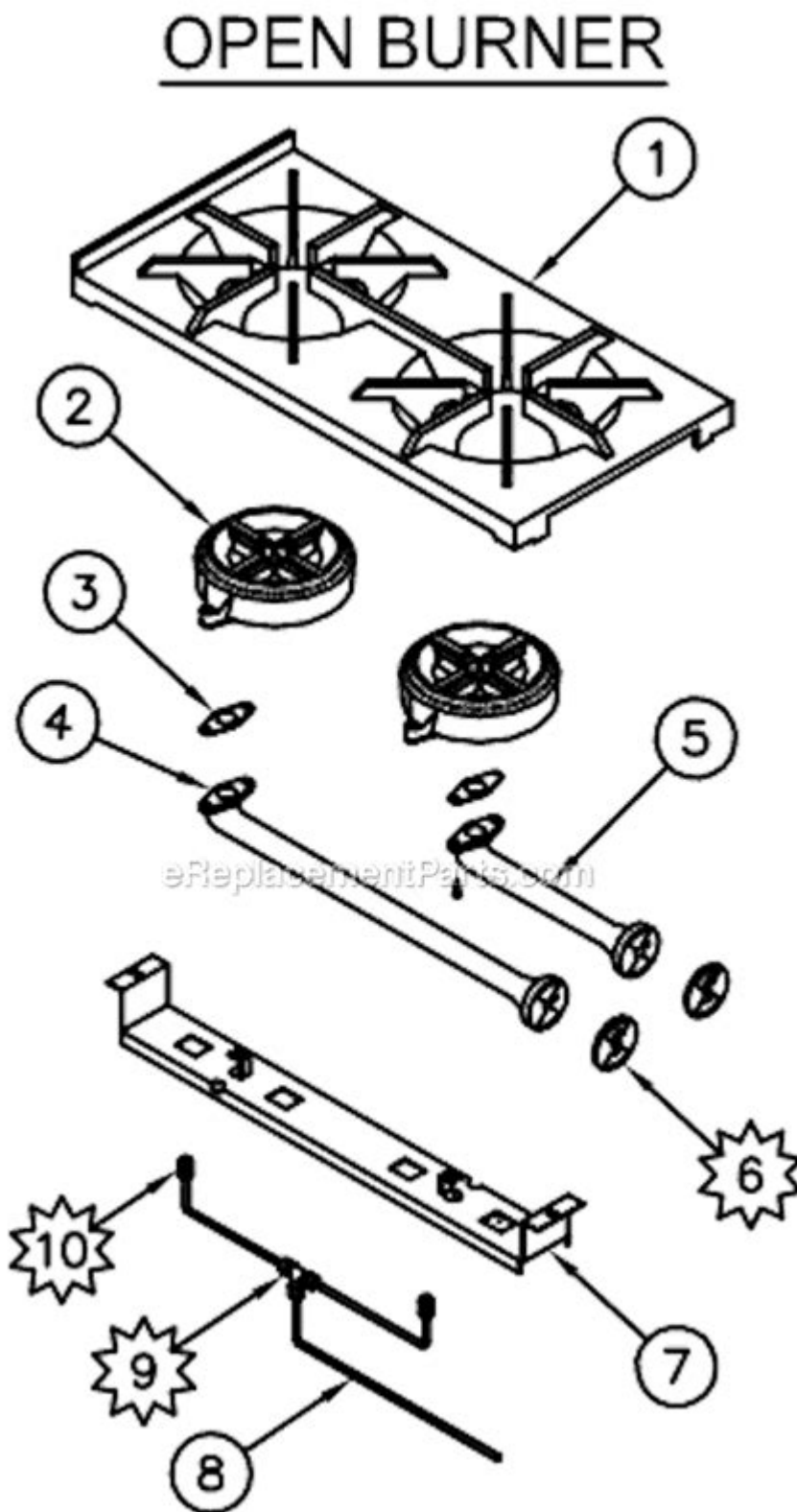

American range parts diagram is an essential tool for anyone involved in the maintenance, repair, or operation of American-made cooking equipment. As these appliances play a critical role in both

residential and commercial kitchens, understanding their components is crucial for ensuring optimal performance and longevity. In this article, we will explore the various aspects of American range parts diagrams, including their importance, how to read and interpret them, and where to find them.

The Importance of American Range Parts Diagrams

American range parts diagrams serve several key purposes:

- **Identification of Parts:** A parts diagram provides a visual representation of the appliance, making it easier to identify individual components.
- **Guidance for Repairs:** When troubleshooting issues, a detailed diagram can help pinpoint which parts may need repair or replacement.
- **Maintenance Reference:** Diagrams serve as a reference for routine maintenance, ensuring that all parts are functioning correctly and are well-maintained.
- **Ordering Replacement Parts:** With a clear diagram, it becomes simpler to order the correct parts when replacements are needed.

Understanding American Range Parts Diagrams

Interpreting a parts diagram can seem daunting at first, but with some knowledge, it becomes manageable. Here are some key aspects to consider when looking at an American range parts diagram:

1. Component Labels

Each part in the diagram is labeled with a unique identifier, often a number or letter. These identifiers correspond to a parts list, which usually accompanies the diagram. Understanding how to read these labels is crucial for effective communication when ordering parts.

2. Assembly Layout

Diagrams typically show the assembly layout of the range, meaning they illustrate how various components fit together. This is particularly helpful when reassembling the appliance after repair or maintenance.

3. Exploded Views

Many diagrams offer exploded views of certain sections, showing parts separated as if they were exploded outward. This view can help you see how individual pieces interact with one another and the overall structure of the appliance.

4. Color Coding

Some diagrams may use color coding to differentiate between types of components, such as electrical parts, gas components, or structural elements. This can make it easier to locate specific parts at a glance.

Common Components in American Range Parts Diagrams

Understanding the common components found in American range parts diagrams is also essential. Here are several parts that you may frequently encounter:

1. **Burners:** The heating elements located on the top surface of the range.
2. **Oven Thermostat:** Regulates the temperature inside the oven.
3. **Ignitor:** Responsible for lighting the burners and oven.
4. **Control Knobs:** Allow users to set heat levels for the burners and oven.
5. **Grates:** Provide a stable platform for pots and pans on top of the burners.
6. **Fan Assembly:** Circulates air in the oven for even cooking.
7. **Drip Tray:** Catches spills and drips from the burners.
8. **Door Seal:** Helps maintain oven temperature by sealing the door.

Where to Find American Range Parts Diagrams

Finding the correct American range parts diagram is crucial for effective maintenance and repair. Here are several resources where you can locate these diagrams:

1. Manufacturer's Website

The first place to look for a parts diagram is the manufacturer's website. American Range typically provides detailed product information, including parts diagrams and manuals for their appliances.

2. User Manuals

If you have a user manual for your range, it often contains a parts diagram. User manuals can sometimes be downloaded from the manufacturer's website if you don't have a physical copy.

3. Online Retailers

Many online retailers that sell replacement parts for kitchen appliances also provide parts diagrams. Websites like Parts Town, Appliance Parts Pros, or Repair Clinic often have comprehensive resources, including diagrams.

4. Appliance Repair Forums

Online forums and communities dedicated to appliance repair can be a valuable resource. Members often share diagrams, troubleshooting tips, and experiences that can help you find the information you need.

How to Use American Range Parts Diagrams for Maintenance and Repairs

Utilizing a parts diagram effectively can streamline your maintenance and repair processes. Here's a step-by-step guide to using these diagrams:

1. Identify the Problem

Start by diagnosing the issue with your range. Is it not heating properly? Are there any strange noises? Understanding the problem will help you focus your search on specific components.

2. Locate the Relevant Section on the Diagram

Once you have identified the issue, refer to the parts diagram to locate the relevant section for the components involved in that issue.

3. Cross-Reference with the Parts List

Use the corresponding parts list to find the exact part numbers needed for replacement or repair. Make sure to note any specifications, such as size or type, that could affect compatibility.

4. Order Replacement Parts

With the part numbers in hand, you can confidently order the replacement parts from a reputable supplier. Ensure that you are purchasing genuine parts to maintain the integrity of your appliance.

5. Perform Repairs

Once you receive the new parts, follow the diagram to assist you in disassembling the appliance, making the necessary repairs, and reassembling everything correctly.

Conclusion

In conclusion, understanding the **American range parts diagram** is invaluable for anyone who owns or works with these essential kitchen appliances. By familiarizing yourself with how to read and interpret these diagrams, you can efficiently troubleshoot issues, perform necessary repairs, and maintain your range in optimal condition. Remember to utilize the resources available to you, from manufacturer websites to online forums, to ensure that you have all the necessary information at your fingertips. Proper knowledge and use of parts diagrams can lead to a longer lifespan for your American range and a more efficient kitchen experience overall.

Frequently Asked Questions

What is an American Range parts diagram used for?

An American Range parts diagram is used to identify, locate, and understand the various components of American Range appliances, aiding in repairs and maintenance.

Where can I find an American Range parts diagram?

You can find American Range parts diagrams on the manufacturer's official website, through authorized dealers, or in the appliance's user manual.

How do I interpret an American Range parts diagram?

To interpret an American Range parts diagram, refer to the legend or key that explains the symbols and numbers used to denote different parts, and match them to the components in your appliance.

Are parts diagrams available for all American Range models?

Most American Range models have parts diagrams available, but availability may vary; it's best to check the specific model on the manufacturer's website.

Can I order parts directly from the American Range parts diagram?

Yes, once you identify the part you need from the American Range parts diagram, you can typically order it through the manufacturer's website or an authorized parts supplier.

Is it necessary to use a parts diagram for repairs?

While not strictly necessary, using a parts diagram is highly recommended for accurate repairs, ensuring you have the correct parts and understanding their placement.

What common parts can I find in an American Range parts diagram?

Common parts include burners, knobs, igniters, grates, and control panels, which are essential for the functionality of the range.

Can I get a printed version of the American Range parts diagram?

Yes, many manufacturers provide printable versions of parts diagrams; you can typically download and print them from their website.

What should I do if I can't find the parts diagram for my American Range model?

If you can't find the parts diagram for your American Range model, contact customer support or an authorized service center for assistance in locating the correct diagram.

Find other PDF article:

<https://soc.up.edu.ph/27-proof/Book?ID=ibv43-8938&title=heart-of-darkness-study-guide-answers.pdf>

American Range Parts Diagram

“american megatrends”_

Aug 29, 2024 · “american megatrends” “American Megatrends” POST
BIOS BIOS

US **USA** **America** [_](#) [_](#)

US USA America 1 America “” “” USA
US America ...

SCI -

Aug 20, 2024 · SCI JACS applied materials & interfaces ACS Appl. Mater. Interfaces
ACS Catalysis ACS Catal. ACS Applied Nano Materials ...

APA -

Dec 20, 2023 · American Psychological Association 121,000
 ...

American Megatrends [bios_](#)

American Megatrends [bios](#) BIOS DEL F2 F10
F12 BIOS

JACS Angew NC ...

NC JACS Angew NC
 ...

-

·Journal Of The American Mathematical Society 1988
32 ...

"Explore our comprehensive American range parts diagram to identify components easily. Enhance your appliance repair skills today! Learn more for expert tips."

[Back to Home](#)