

# Acura Rdx Parts Diagram

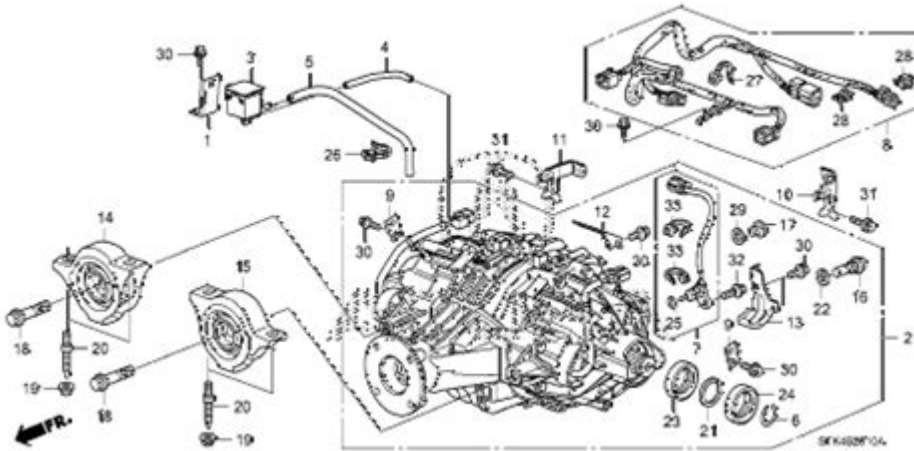

**Acura RDX Parts Diagram** is an essential tool for both car enthusiasts and professionals who wish to understand the intricate workings of this popular luxury SUV. The Acura RDX, known for its reliability, performance, and comfort, has garnered a loyal following since its introduction. Understanding the parts diagram provides valuable insights into maintenance, repairs, and upgrades. In this article, we will explore the various components of the Acura RDX, their functions, and how the parts diagram can aid in keeping this vehicle in optimal condition.

## Overview of the Acura RDX

The Acura RDX is a compact luxury crossover SUV, first introduced in 2006. It has evolved through multiple generations, each bringing enhancements in technology, design, and performance. The RDX is known for its:

- All-Wheel Drive (AWD) capabilities
- Turbocharged engines for improved performance
- Advanced safety features and technology
- Spacious interior and cargo capacity

Understanding its parts and their layout is crucial for both DIY maintenance and professional repairs.

## Importance of a Parts Diagram

A parts diagram serves several critical functions:

- **Visual Representation:** It provides a clear visual layout of components, making it easier to identify parts.

- Simplifies Repairs: Mechanics and DIY enthusiasts can quickly locate parts when making repairs or replacements.
- Improves Maintenance: Regular maintenance can be performed effectively with a clear understanding of where components are located.
- Helps in Ordering Parts: When ordering replacement parts, having a diagram ensures that the correct components are sourced.

## **Key Components of the Acura RDX**

To better understand the parts diagram, let's break down the major components of the Acura RDX:

### **1. Engine Components**

The engine is the heart of the RDX. Key parts include:

- Engine Block: Houses the cylinders and is essential for combustion.
- Cylinder Head: Contains the intake and exhaust valves.
- Timing Belt: Synchronizes the rotation of the crankshaft and camshaft.
- Intake Manifold: Distributes air to the engine cylinders.

### **2. Transmission System**

The transmission is crucial for power delivery. Important parts include:

- Transmission Fluid Pan: Holds the transmission fluid.
- Torque Converter: Allows the engine to continue running while the vehicle is stopped.
- Transmission Control Module (TCM): Manages the shifting of gears.

### **3. Suspension System**

The suspension system ensures a smooth ride and stability. Key components are:

- Shock Absorbers: Help control vehicle movement.
- Struts: Provide structural support and absorb shock.
- Control Arms: Connect the wheel hub to the vehicle's frame.

### **4. Brake System**

The brake system is vital for safety. Important parts include:

- Disc Brakes: Provide stopping power through friction.
- Brake Pads: Press against the disc to slow down the vehicle.
- Brake Calipers: House the brake pads and apply pressure to the discs.

## **5. Electrical System**

The electrical system powers various functions in the RDX. Key components include:

- Battery: Stores electrical energy for starting the vehicle.
- Alternator: Charges the battery while the engine runs.
- Fuses and Relays: Protect electrical circuits and components.

## **Understanding the Parts Diagram**

The parts diagram for the Acura RDX is typically divided into sections corresponding to the components mentioned above. Each section features labeled parts, which makes it easier to find specific components. Here's how to read and utilize the diagram effectively:

### **1. Identify Sections**

The diagram is usually segmented into different areas, such as:

- Engine Compartment: Contains the engine and related components.
- Underbody: Includes suspension and drivetrain parts.
- Interior: Displays components related to the dashboard and controls.
- Exterior: Features body parts and lighting systems.

### **2. Use Part Numbers**

Each part is usually assigned a unique part number. This number is essential when ordering replacements, ensuring you get the correct item.

### **3. Refer to Service Manuals**

While the parts diagram is invaluable, it is often accompanied by service manuals that provide further details on each part's function, maintenance tips, and replacement procedures.

# Common Maintenance and Repair Tasks

Understanding the parts diagram can help with common maintenance tasks, such as:

- Oil Changes: Familiarize yourself with the oil filter location and oil pan.
- Brake Pad Replacement: Locate brake calipers and pads for easy access.
- Battery Replacement: Identify the battery location and terminals.
- Air Filter Changes: Find the air intake system and filter housing.

## Where to Find Parts Diagrams

Finding an accurate parts diagram for the Acura RDX can be done through several resources:

- Official Acura Service Manuals: These often contain detailed diagrams and repair procedures.
- Online Auto Parts Retailers: Many websites provide diagrams alongside parts listings.
- Automotive Forums: Communities of Acura enthusiasts often share diagrams and repair tips.
- Dealerships: Authorized Acura dealerships can provide official diagrams and parts information.

## Tips for Using Parts Diagrams Effectively

To maximize the effectiveness of using parts diagrams, consider the following tips:

1. Keep a Digital Copy: Save diagrams to your devices for easy access during repairs.
2. Label Parts: If you are disassembling components, label parts and take photos to aid in reassembly.
3. Cross-Reference: Use service manuals alongside diagrams for comprehensive understanding.
4. Join Forums: Engage with other Acura owners to share experiences and gather insights on repairs.

## Conclusion

The Acura RDX parts diagram is an invaluable resource for anyone involved in the maintenance or repair of this luxury SUV. By understanding the various components, their functions, and how to navigate the diagram, owners can

ensure their RDX remains in peak condition. Whether you're a seasoned mechanic or a DIY enthusiast, utilizing a parts diagram will simplify your work, enhance your understanding, and ultimately contribute to the longevity of your Acura RDX.

## **Frequently Asked Questions**

### **What is the purpose of an Acura RDX parts diagram?**

An Acura RDX parts diagram provides a visual representation of the vehicle's components, helping technicians and owners identify and locate parts for maintenance and repairs.

### **Where can I find an accurate parts diagram for my Acura RDX?**

You can find an accurate parts diagram for your Acura RDX in the owner's manual, dealership service departments, or online resources like Acura's official website and automotive repair platforms.

### **Are parts diagrams the same for all model years of the Acura RDX?**

No, parts diagrams can vary between different model years of the Acura RDX. It's important to use a diagram that corresponds to the specific model year of your vehicle.

### **How can a parts diagram help with DIY repairs on an Acura RDX?**

A parts diagram can assist DIYers by providing a clear layout of components, making it easier to identify which parts need to be replaced or serviced, and ensuring proper reassembly.

### **What should I do if I can't find a parts diagram for my Acura RDX?**

If you can't find a parts diagram, consider contacting an Acura dealership for assistance, checking automotive forums, or purchasing a repair manual that includes diagrams.

### **Can I use a Honda parts diagram for my Acura RDX?**

While some parts may be similar due to shared platforms, it's best to use an Acura-specific parts diagram to ensure compatibility and accuracy for your RDX.

## Are there online tools available for viewing Acura RDX parts diagrams?

Yes, there are several online tools and websites, such as OEM parts suppliers and repair databases, that allow users to view and interact with Acura RDX parts diagrams.

## What are common parts included in an Acura RDX parts diagram?

Common parts in an Acura RDX parts diagram include the engine, transmission, suspension components, electrical systems, and interior parts like seats and dashboards.

## How do I read an Acura RDX parts diagram?

To read an Acura RDX parts diagram, familiarize yourself with the symbols and labels, which indicate different parts and their locations, and refer to accompanying parts lists for details.

Find other PDF article:

<https://soc.up.edu.ph/48-shade/pdf?trackid=OqP64-7199&title=pride-and-prejudice-1995-watch-online.pdf>

## [Acura Rdx Parts Diagram](#)

2015 Acura RDX parts diagram - PDF  
2015 Acura RDX parts diagram ...

Acura CDX parts diagram - PDF  
Acura CDX, parts diagram ...

2017 Acura RDX parts diagram - PDF  
2017 Acura RDX parts diagram ...

2017 Acura RDX parts diagram - PDF  
2017 Acura RDX parts diagram ...

2017 Acura RDX parts diagram - PDF  
2017 Acura RDX parts diagram ...

2015 Acura RDX parts diagram - PDF  
2015 Acura RDX parts diagram ...

Acura CDX -

Acura CDX, ...

-

cdx17Glaqx30glaq3  
X12.0 ...

/ ...

Oct 27, 2020 · TLXinspireinspireinspireplus  
Tlxinspire TLX ...

RDX -

RDX ...

-

Lexus ...

CDX -

cdx900NVH ...

IntegraAcura ...

AcuraA [ ] 7

CDX -

—Acura

-

...

Explore our comprehensive Acura RDX parts diagram to easily identify components and enhance your vehicle's performance. Discover how to optimize your ride today!

[Back to Home](#)