

# 2011 Chevy Malibu Parts Diagram

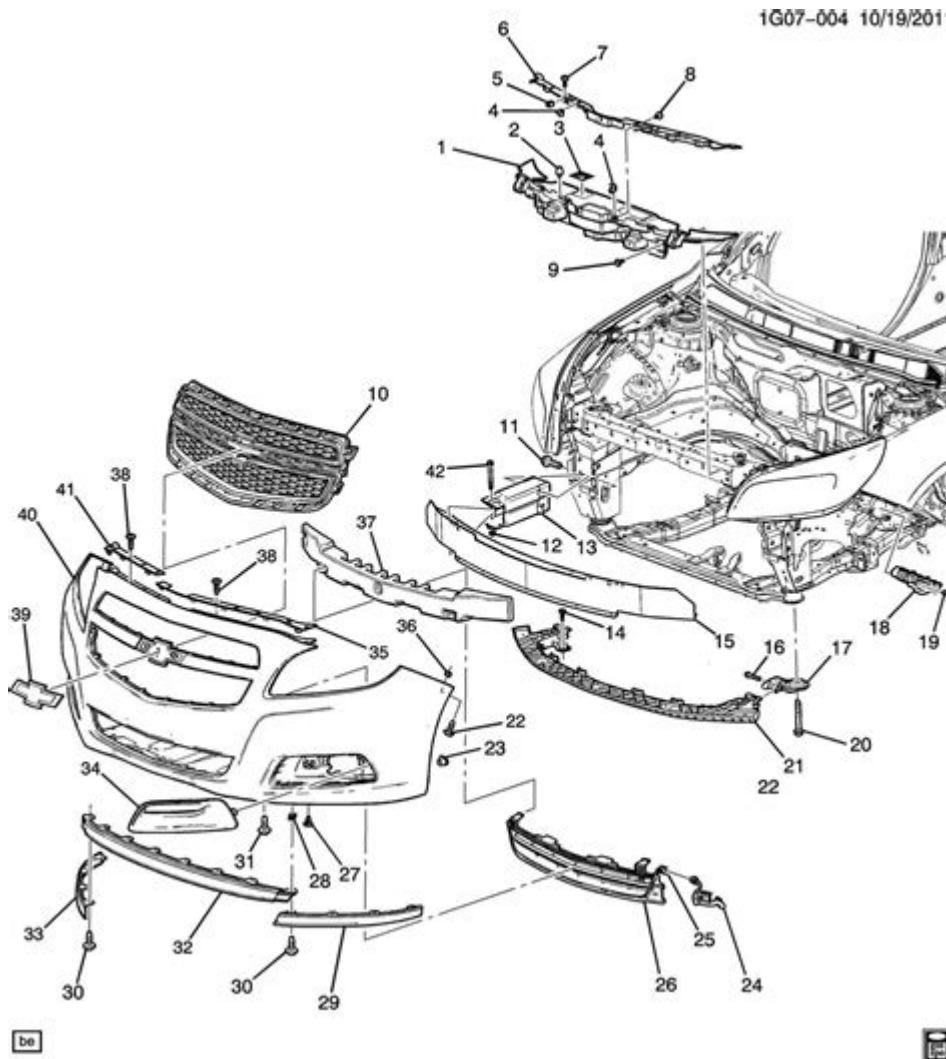

**2011 Chevy Malibu parts diagram** is an essential resource for anyone looking to understand the components of this popular mid-size sedan. The Chevy Malibu has been a staple in the Chevrolet lineup since its inception in the 1960s, and the 2011 model is noted for its blend of style, performance, and comfort. Whether you're a DIY enthusiast, a mechanic, or simply a Malibu owner wanting to learn more about your vehicle, understanding the parts diagram can help you in various ways, from maintenance to repair.

## Overview of the 2011 Chevy Malibu

The 2011 Chevy Malibu comes with several configurations, including different trim levels such as the LS, LT, and LTZ. It features a sleek design, spacious interior, and a range of engine options. The model is equipped with a 2.4L four-cylinder engine or an available 3.6L V6 engine, both of which contribute to its performance and fuel efficiency.

Some key specifications of the 2011 Chevy Malibu include:

- Engine Options: 2.4L four-cylinder and 3.6L V6
- Transmission: 6-speed automatic transmission
- Fuel Economy: Up to 33 MPG on the highway
- Seating Capacity: 5 passengers
- Cargo Space: 15.1 cubic feet

Understanding the parts diagram of the Malibu can help you identify components for replacement or repair, ensuring that your vehicle remains in top condition.

## Importance of the Parts Diagram

A parts diagram is a visual representation that helps illustrate the various components of a vehicle. Here are some reasons why the 2011 Chevy Malibu parts diagram is vital:

- **Identification of Parts:** A diagram helps you quickly identify specific parts, making it easier to locate them for repairs or upgrades.
- **Understanding Layout:** It provides a clear layout of how different components are arranged, aiding in troubleshooting and diagnostics.
- **Facilitating Repairs:** Knowing where each part is located can save time during repairs and maintenance tasks.
- **Safety:** Understanding the parts can help you ensure that all components are functioning properly, contributing to overall vehicle safety.

## Components of the 2011 Chevy Malibu Parts Diagram

The parts diagram for the 2011 Chevy Malibu can be divided into several key sections, each containing a variety of components. Below is an overview of these sections:

### 1. Engine Compartment

The engine compartment houses critical components that keep your vehicle running smoothly.

- **Engine:** The heart of your vehicle, available in either a four-cylinder or V6 option.
- **Alternator:** Charges the battery and powers electrical systems when the engine is running.
- **Radiator:** Helps cool the engine by dissipating heat from the coolant.
- **Air Filter:** Filters the air entering the engine for combustion.
- **Battery:** Provides the electrical energy needed to start the engine and power accessories.

## 2. Transmission and Drive Train

The transmission and drivetrain are essential for delivering power from the engine to the wheels.

- **Transmission:** The 6-speed automatic transmission that enables smooth gear shifts.
- **Driveshaft:** Transfers power from the transmission to the wheels.
- **Axles:** Connects the wheels to the drivetrain, allowing for movement.

## 3. Suspension System

A well-functioning suspension system is crucial for maintaining ride comfort and vehicle control.

- **Shocks and Struts:** Absorb bumps and provide stability.
- **Control Arms:** Connect the wheels to the vehicle's frame.
- **Sway Bar:** Reduces body roll during turns.

## 4. Brake System

The brake system is vital for vehicle safety and performance.

- **Brake Pads:** Press against the rotors to create friction and stop the vehicle.
- **Brake Rotors:** The disc that the brake pads clamp down on to slow the vehicle.
- **Brake Lines:** Carry brake fluid to the calipers.

## 5. Electrical System

The electrical system powers everything from the engine to the entertainment system.

- **Fuses:** Protect electrical circuits from overload.
- **Wiring Harness:** Connects various electrical components throughout the vehicle.
- **ECU (Engine Control Unit):** Manages engine performance and efficiency.

## How to Use the Parts Diagram

Using a parts diagram can be straightforward, but it's essential to approach it methodically. Here are some steps to help you utilize the diagram effectively:

1. **Gather Necessary Tools:** Ensure you have the right tools for any repairs or replacements.
2. **Identify the Problem:** Determine which part needs attention, whether it's due to wear, damage, or malfunction.
3. **Refer to the Diagram:** Use the diagram to locate the specific part you need to work on.
4. **Remove the Part:** Follow appropriate procedures for removing the part,

ensuring you take safety precautions.

5. **Replace or Repair:** Install a new part or make necessary repairs, referring back to the diagram as needed.

## Where to Find the Parts Diagram

The parts diagram for the 2011 Chevy Malibu can be found in several places:

- **Owner's Manual:** Your vehicle's owner's manual often contains diagrams and information on various components.
- **Online Resources:** Websites like GM's official site or automotive forums often provide detailed diagrams.
- **Service Manuals:** Purchasing a service manual for your specific model year can offer comprehensive diagrams and repair instructions.
- **Auto Parts Stores:** Many auto parts retailers provide access to parts diagrams for vehicle repairs.

## Conclusion

The **2011 Chevy Malibu parts diagram** serves as an invaluable tool for understanding your vehicle's components and systems. Whether you are performing routine maintenance, troubleshooting issues, or engaging in more extensive repairs, having a clear visual reference can significantly enhance your efficiency and effectiveness. By familiarizing yourself with the parts diagram and understanding the roles of various components, you can ensure that your Chevy Malibu continues to perform at its best.

## Frequently Asked Questions

### Where can I find a detailed parts diagram for a 2011 Chevy Malibu?

You can find a detailed parts diagram for a 2011 Chevy Malibu on websites like AutoZone, RockAuto, or the official Chevrolet service manuals.

## **What are the common replacement parts for a 2011 Chevy Malibu?**

Common replacement parts for a 2011 Chevy Malibu include brake pads, air filters, water pumps, and batteries.

## **Is there a specific resource for DIY repairs on a 2011 Chevy Malibu?**

Yes, resources like YouTube tutorials, repair manuals, and forums like Chevy Malibu Owners can provide valuable DIY repair information.

## **How do I interpret the parts diagram for my 2011 Chevy Malibu?**

To interpret the parts diagram, start by identifying the section relevant to your repair, then match the labeled parts with their corresponding numbers to understand their placement and function.

## **Are there any recalls affecting parts of the 2011 Chevy Malibu?**

Yes, it's advisable to check the National Highway Traffic Safety Administration (NHTSA) website for any recalls related to the 2011 Chevy Malibu, as they can affect parts and safety.

Find other PDF article:

<https://soc.up.edu.ph/35-bold/files?trackid=pPF42-3463&title=john-philip-sousa-the-stars-and-stripes-forever.pdf>

## **[2011 Chevy Malibu Parts Diagram](#)**

### [2011 - Wikipedia](#)

2011 (MMXI) was a common year starting on Saturday of the Gregorian calendar, the 2011th year of the Common Era (CE) and Anno Domini (AD) designations, the 11th year of the 3rd ...

### *2011: Facts & Events That Happened in This Year - The Fact Site*

Discover the world-changing events that shaped 2011, from the death of Osama bin Laden, to natural disasters, technological milestones, and so much more!

### [What Happened in 2011 - On This Day](#)

What happened and who was famous in 2011? Browse important and historic events, world leaders, famous birthdays and notable deaths from the year 2011.

*What Happened In 2011 - Historical Events 2011 - EventsHistory*

What happened in the year 2011 in history? Famous historical events that shook and changed the world. Discover events in 2011.

*2011's top stories worldwide: Bin Laden, Gadhafi, tsunami and ...*

Dec 20, 2011 · From the Arab spring to the death of Osama bin Laden, 2011 was filled with landmark events the world over.

### **Major Events of 2011 - Historical Moments That Defined the ...**

Sep 25, 2024 · From political shifts and technological advancements to cultural breakthroughs, these events shape the world and influence the future. In this comprehensive overview, we'll ...

### **2011 - Simple English Wikipedia, the free encyclopedia**

The movie *Revengers Tragedy* (2003) is set in a dystopian Liverpool in the year 2011, following the aftermath of a natural disaster which has destroyed the southern half of Great Britain.

2011 - Wikipedia

2011 (MMXI) was a common year starting on Saturday of the Gregorian calendar, the 2011th year of the Common Era (CE) and Anno Domini (AD) designations, the 11th year of the 3rd ...

### **2011: Facts & Events That Happened in This Year - The Fact Site**

Discover the world-changing events that shaped 2011, from the death of Osama bin Laden, to natural disasters, technological milestones, and so much more!

*What Happened in 2011 - On This Day*

What happened and who was famous in 2011? Browse important and historic events, world leaders, famous birthdays and notable deaths from the year 2011.

*What Happened In 2011 - Historical Events 2011 - EventsHistory*

What happened in the year 2011 in history? Famous historical events that shook and changed the world. Discover events in 2011.

### **2011's top stories worldwide: Bin Laden, Gadhafi, tsunami and ...**

Dec 20, 2011 · From the Arab spring to the death of Osama bin Laden, 2011 was filled with landmark events the world over.

### **Major Events of 2011 - Historical Moments That Defined the ...**

Sep 25, 2024 · From political shifts and technological advancements to cultural breakthroughs, these events shape the world and influence the future. In this comprehensive overview, we'll ...

2011 - Simple English Wikipedia, the free encyclopedia

The movie *Revengers Tragedy* (2003) is set in a dystopian Liverpool in the year 2011, following the aftermath of a natural disaster which has destroyed the southern half of Great Britain.

Explore our comprehensive 2011 Chevy Malibu parts diagram to find the right components for your vehicle. Discover how to enhance your ride today!

[Back to Home](#)