

2004 Hyundai Sonata Rear Suspension Diagram

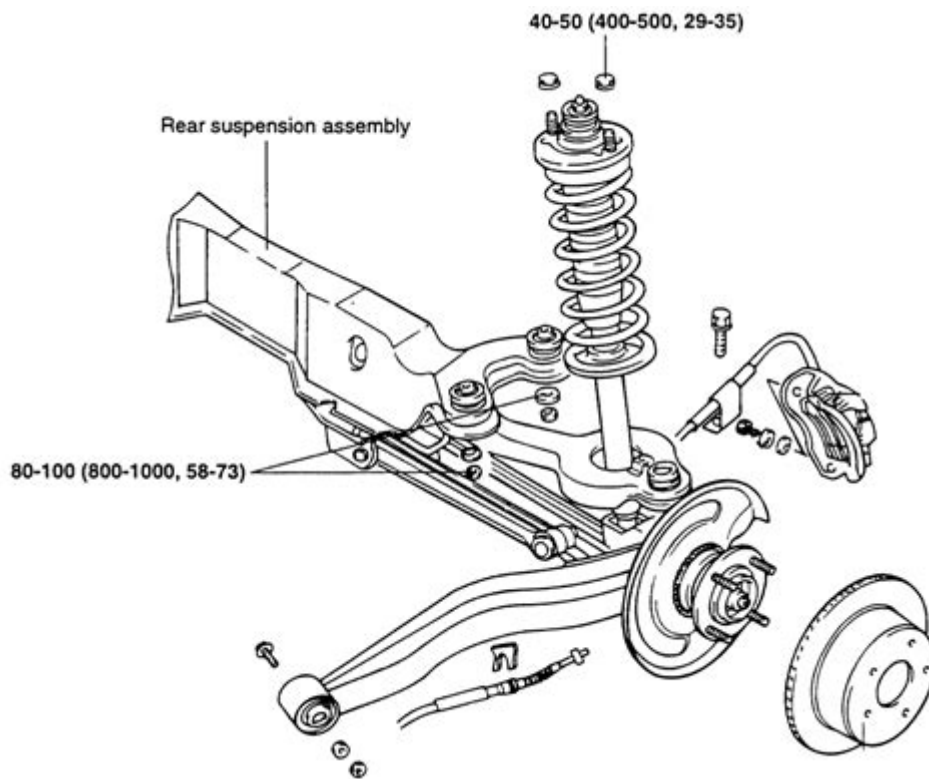

2004 Hyundai Sonata Rear Suspension Diagram

The rear suspension of a vehicle plays a crucial role in ensuring ride quality, stability, and handling characteristics. Understanding the components and layout of the rear suspension system can help in diagnosing issues, performing maintenance, and enhancing the overall driving experience. The 2004 Hyundai Sonata is equipped with a rear suspension system designed to provide a balance between comfort and performance. This article will delve into the details of the rear suspension diagram, its components, and how they contribute to the Sonata's handling.

Overview of the 2004 Hyundai Sonata

The 2004 Hyundai Sonata is a mid-size sedan that earned a reputation for its affordability, reliability, and strong features. With a sleek design and a comfortable interior, it appealed to a wide variety of consumers. The rear suspension system is particularly important in enhancing the driving dynamics of the Sonata.

Suspension Type

The 2004 Sonata utilizes a multi-link rear suspension system. This design is favored in many modern

vehicles due to its ability to provide better handling and ride comfort compared to older designs like leaf springs or solid axles. The multi-link system allows for independent movement of the wheels, which improves traction and stability, particularly during cornering and uneven road conditions.

Components of the Rear Suspension

Understanding the various components of the rear suspension is critical for maintenance and repair. The key components of the 2004 Hyundai Sonata's rear suspension system include:

1. Control Arms:

- Upper Control Arm
- Lower Control Arm

2. Shock Absorbers:

- Dampen road vibrations and provide stability.

3. Coil Springs:

- Support the vehicle's weight and absorb shocks from the road.

4. Rear Subframe:

- A structural component that houses the suspension elements.

5. Stabilizer Bar (Sway Bar):

- Reduces body roll during cornering.

6. Bushings:

- Rubber or polyurethane components that provide cushioning between metal parts, reducing noise and vibrations.

Understanding the Rear Suspension Diagram

The rear suspension diagram for the 2004 Hyundai Sonata visually represents the arrangement and relationship between the various components. It typically includes labels and arrows indicating movement and load paths.

Key Features of the Diagram

- **Component Identification:** Each part of the suspension is labeled for easy identification.
- **Orientation:** The diagram shows how components are oriented in relation to each other, assisting in understanding the layout.
- **Movement Arrows:** Arrows can indicate how components interact under different driving conditions, helping to visualize load transfer.

Importance of Each Component

1. Control Arms:

- Control arms connect the chassis to the wheels, allowing for vertical movement while keeping the wheels aligned with the body of the car. They are crucial for maintaining proper wheel geometry.

2. Shock Absorbers:

- These dampen the oscillations created by the springs, ensuring that the vehicle does not bounce excessively after hitting a bump. Proper functioning shock absorbers are essential for ride comfort and safety.

3. Coil Springs:

- Springs absorb the impact from the road, allowing for a smoother ride. Worn-out springs can lead to decreased ride quality and increased wear on other suspension components.

4. Rear Subframe:

- This is the backbone of the rear suspension system. It provides a rigid structure for mounting the suspension components and helps distribute loads evenly.

5. Stabilizer Bar:

- The stabilizer bar helps to minimize body roll during turns, improving handling and responsiveness. It connects the left and right sides of the suspension, ensuring that both sides work together.

6. Bushings:

- These are critical for isolating road noise and vibrations. Over time, bushings can wear out, leading to increased noise and a rough ride.

Common Issues with the Rear Suspension

Like any mechanical system, the rear suspension of the 2004 Hyundai Sonata can experience problems over time. Some common issues include:

1. Worn Shock Absorbers:

- Symptoms: Excessive bouncing, a rough ride, or fluid leaks.
- Solution: Replace shock absorbers.

2. Sagging Springs:

- Symptoms: The rear of the car sits lower than normal and may bottom out over bumps.
- Solution: Inspect and replace springs if necessary.

3. Damaged Control Arms:

- Symptoms: Clunking noises when going over bumps or during turns.
- Solution: Inspect for bends or cracks and replace if damaged.

4. Worn Bushings:

- Symptoms: Noisy suspension, decreased handling, and increased vibrations.
- Solution: Replace worn bushings to restore ride quality.

5. Sway Bar Issues:

- Symptoms: Increased body roll during cornering.
- Solution: Inspect and replace sway bar links or bushings as needed.

Maintenance Tips for the Rear Suspension

Regular maintenance can significantly extend the life of the rear suspension components and ensure optimal performance. Here are some tips:

1. Routine Inspections:

- Regularly check for signs of wear or damage, particularly on bushings and control arms.

2. Check Alignment:

- Ensure that the wheel alignment is correct to prevent uneven tire wear and handling issues.

3. Monitor Tire Condition:

- Keep an eye on tire wear patterns to identify any underlying suspension issues.

4. Replace Worn Components Promptly:

- Address any signs of wear as soon as possible to prevent further damage and maintain safety.

5. Professional Assessments:

- Consider having a professional inspect the suspension system during routine service intervals.

Conclusion

The rear suspension of the 2004 Hyundai Sonata is a vital component that contributes significantly to the vehicle's handling, comfort, and overall performance. Understanding the rear suspension diagram and the role of each component can empower car owners to perform better maintenance and repairs. By being aware of common issues and adhering to maintenance tips, owners can ensure that their Sonata continues to deliver a smooth and reliable driving experience for years to come.

Frequently Asked Questions

What type of rear suspension does the 2004 Hyundai Sonata have?

The 2004 Hyundai Sonata features a multi-link rear suspension system, which provides improved handling and ride quality.

Where can I find a detailed rear suspension diagram for a

