

# 2002 Arctic Cat 400 4x4 Service Manual



CH0800A

■ **NOTE:** Clean up any excess oil after removing the filter.

6. Apply oil to the O-rings and check to make sure they are positioned correctly in the cover and crankcase; then with the open end of the filter element directed toward the center of the engine, install the element making sure the spring is between the cover and the element.

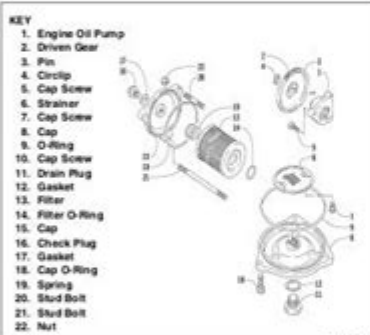

0733-752

## CAUTION

If the oil filter element is installed backwards, engine damage will occur due to lack of oil flow.

7. Place the filter cover in position and secure with the nut. Tighten securely.
8. Install the engine drain plug and tighten to 2.2 kg-m (16 ft-lb). Pour 3.9 L (4.1 U.S. qt) for the 250 or 3.4 L (3.5 U.S. qt) for the 300 of the recommended oil in the filler hole; then install the filler plug.

**CAUTION**

Any oil used in place of the recommended oil could cause serious engine damage. Do not use oils which contain graphite or molybdenum additives. These oils can adversely affect clutch operation. Also, not recommended are racing, vegetable, non-detergent, and castor-based oils.

9. Start the engine (while the ATV is outside on level ground) and allow it to idle for a few minutes.
10. Turn the engine off and wait approximately one minute. Recheck the oil level in the engine oil inspection window. The oil level should be visible through the window. If oil is not visible, add recommended oil until the oil level is visible between the lines of the window.

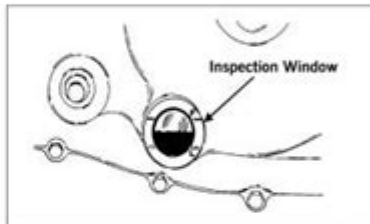

ATV-0074

11. Inspect the area around the drain plug and oil filter for leaks.

## STRAINER

To check the oil strainer, use the following procedure.

1. Remove the skid plate.
2. Remove the Phillips-head cap screws securing the oil strainer cap; then remove the cap. Note the directional arrow on the cap for assembly purposes.



CC4420A

3. Remove the Phillips-head screws securing the strainer; then remove the strainer.

2002 Arctic Cat 400 4x4 service manual is an essential resource for owners and mechanics looking to maintain and repair this versatile all-terrain vehicle (ATV). This manual provides detailed information on the operation, maintenance, and repair procedures specific to the 2002 Arctic Cat 400 4x4 model. Having access to a comprehensive service manual can ensure that you keep your ATV in optimal condition, prolonging its lifespan and enhancing your riding experience. In this article, we will explore the importance of the service manual, key features of the 2002 Arctic Cat 400 4x4, maintenance and repair procedures, and where to find this valuable resource.

## Importance of the 2002 Arctic Cat 400 4x4 Service Manual

A service manual is crucial for several reasons:

- **Comprehensive Guidance:** The manual provides step-by-step instructions for maintenance and repair tasks, making it easier for both beginners and experienced mechanics to understand the processes.
- **Safety:** It highlights safety precautions that should be taken when working on the ATV, helping to prevent accidents and injuries.
- **Problem Diagnosis:** The manual includes troubleshooting sections that can help identify issues based on symptoms, allowing for more efficient repairs.
- **Parts Information:** It lists part numbers and specifications, which is essential for ordering the correct replacement parts.

## Key Features of the 2002 Arctic Cat 400 4x4

The 2002 Arctic Cat 400 4x4 was designed for both recreational and utility purposes, making it a popular choice among ATV enthusiasts. Here are some of its standout features:

### Engine and Performance

- **Engine Type:** The 2002 model is powered by a 366cc, liquid-cooled, single-cylinder, four-stroke engine.
- **Horsepower:** It delivers approximately 24 horsepower, providing a good balance of power and efficiency.
- **Transmission:** The ATV features an automatic transmission with high, low, neutral, and reverse gears, allowing for smooth shifting and versatile use in various terrains.

### Drive System

- **4x4 Capability:** The 2002 Arctic Cat 400 comes with a selectable 4x4 drive system, which enhances traction and stability on challenging surfaces.
- **Differential Lock:** This feature allows the rider to lock the front and rear differentials for improved control in slippery conditions.

### Suspension and Handling

- **Front Suspension:** The ATV features independent double-wishbone front suspension, providing improved handling and comfort.
- **Rear Suspension:** The rear suspension consists of a swingarm design, which contributes to a smoother ride over rough terrain.

## Braking System

- Brakes: The 2002 Arctic Cat 400 is equipped with hydraulic disc brakes on both the front and rear, ensuring effective stopping power and control.

## Maintenance Procedures for the 2002 Arctic Cat 400 4x4

Regular maintenance is vital for keeping your ATV in excellent condition. Below are some essential maintenance tasks outlined in the service manual:

### Routine Maintenance Schedule

It's important to follow a routine maintenance schedule to ensure optimal performance. Here's a general outline:

#### 1. Every 50 Hours or 6 Months:

- Change engine oil and filter.
- Check and clean air filter.
- Inspect brake fluid level.
- Check tire pressure and tread wear.

#### 2. Every 100 Hours or Annually:

- Inspect and adjust drive belts.
- Check battery condition and clean terminals.
- Inspect wheel bearings and grease as needed.

#### 3. Every 200 Hours:

- Flush and replace coolant.
- Check and adjust valve clearance.
- Inspect and replace spark plug if necessary.

## Oil Change Procedure

Changing the engine oil is one of the most critical maintenance tasks:

### 1. Preparation:

- Warm up the engine for a few minutes to thin the oil.
- Park the ATV on a level surface and turn off the engine.

### 2. Draining Oil:

- Remove the oil drain plug and allow the old oil to drain completely into a container.
- Replace the drain plug once the oil has drained.

### 3. Replacing Oil Filter:

- Remove the old oil filter using an oil filter wrench.
- Apply a thin coat of new oil to the rubber gasket of the new filter and install it.

### 4. Adding New Oil:

- Pour the recommended type and amount of oil into the oil fill cap.
- Start the engine and let it run for a minute, then check the oil level and add more if necessary.

## Common Repairs and Troubleshooting

The service manual also includes troubleshooting sections for common issues. Here are some frequent problems and their solutions:

### Starting Issues

- Symptoms: The engine cranks but does not start.
- Solutions:
  - Check the battery; ensure it is charged and terminals are clean.
  - Inspect the fuel system for clogged filters or bad fuel.
  - Ensure the kill switch is in the "run" position.

### Overheating

- Symptoms: The engine temperature gauge rises above normal.
- Solutions:
  - Check the coolant level and top up if necessary.
  - Inspect the radiator for obstructions and clean if needed.
  - Ensure the fan is operating correctly.

## Where to Find the 2002 Arctic Cat 400 4x4 Service Manual

The 2002 Arctic Cat 400 4x4 service manual can be found in several locations:

- **Online Retailers:** Websites such as Amazon or eBay may sell physical or digital copies of the manual.
- **Official Arctic Cat Website:** The manufacturer may offer downloadable versions of the manual or direct links to authorized dealers.
- **ATV Forums and Communities:** Often, fellow Arctic Cat enthusiasts share resources or links to the service manual.

## Conclusion

Owning a 2002 Arctic Cat 400 4x4 can be a rewarding experience, provided you keep up with maintenance and repairs. The **2002 Arctic Cat 400 4x4 service manual** serves as an invaluable tool in this process, offering insights into the machine's operation and guidance on troubleshooting and repairs. By utilizing this manual, you can ensure your ATV remains in peak condition, allowing for many enjoyable rides in the great outdoors.

## Frequently Asked Questions

### What is the primary purpose of the 2002 Arctic Cat 400 4x4 service manual?

The primary purpose of the service manual is to provide detailed instructions for maintenance, repair, and troubleshooting of the 2002 Arctic Cat 400 4x4 ATV.

### Where can I find a digital copy of the 2002 Arctic Cat 400 4x4 service manual?

A digital copy can often be found on Arctic Cat's official website, third-party ATV forums, or through online retailers specializing in ATV manuals.

### What types of maintenance tasks are covered in the service manual?

The service manual covers routine maintenance tasks such as oil changes, air filter replacements, brake adjustments, and tire maintenance.

### Does the service manual include troubleshooting guides for common issues?

Yes, the service manual includes troubleshooting guides that help diagnose and resolve common issues such as starting problems and electrical failures.

### Are there safety precautions mentioned in the service manual?

Yes, the service manual includes safety precautions to follow while performing maintenance and repairs to ensure user safety and prevent damage.

to the ATV.

# Can the service manual assist with engine repair for the 2002 Arctic Cat 400 4x4?

Yes, the service manual provides detailed procedures for engine repair, including disassembly, reassembly, and adjustments.

Is there a section on wiring diagrams in the service manual?

Yes, the service manual typically includes wiring diagrams that illustrate the electrical system, which is useful for troubleshooting and repairs.

How often should I refer to the service manual for maintenance?

It is advisable to refer to the service manual for maintenance at regular intervals as specified in the manual, as well as before and after significant use of the ATV.

What tools are recommended for servicing the 2002 Arctic Cat 400 4x4 according to the manual?

The service manual lists specific tools required for servicing, which may include basic hand tools, torque wrenches, and specialized tools for certain repairs.

Find other PDF article:

<https://soc.up.edu.ph/48-shade/files?ID=mNO40-7437&title=principles-of-service-marketing-and-management.pdf>

# 2002 Arctic Cat 400 4x4 Service Manual

**(2002)-**

(TPE:2002)- - (2002)

**2002**□□□□□□ □□ - □□□□

2002

2002年12月10日 星期三

2002 1. 2002 1 1 — (WTO) 2. 2 8 24 — 2002 3. 2 17 ...

□□□□□□□□**2000**□□**2001**□□**2002.....**□□□□□□□□

2000 2001 2002..... 1



Apr 16, 2025 · Arctic Cat 400 4x4 (2002) service manual for maintenance and repairs. Get expert tips and tricks! Learn more to keep your ATV running smoothly.

Arctic Cat (2002) service manual | PDF - PDF - PDF  
Arctic Cat (2002) service manual for maintenance and repairs. Get expert tips and tricks! Learn more to keep your ATV running smoothly.

Arctic Cat 400 4x4 (2002) service manual - PDF  
Arctic Cat 400 4x4 (2002) service manual for maintenance and repairs. Get expert tips and tricks! Learn more to keep your ATV running smoothly.

Find the complete 2002 Arctic Cat 400 4x4 service manual for maintenance and repairs. Get expert tips and tricks! Learn more to keep your ATV running smoothly.

[Back to Home](#)