

2008 Ford Escape Exhaust Diagram

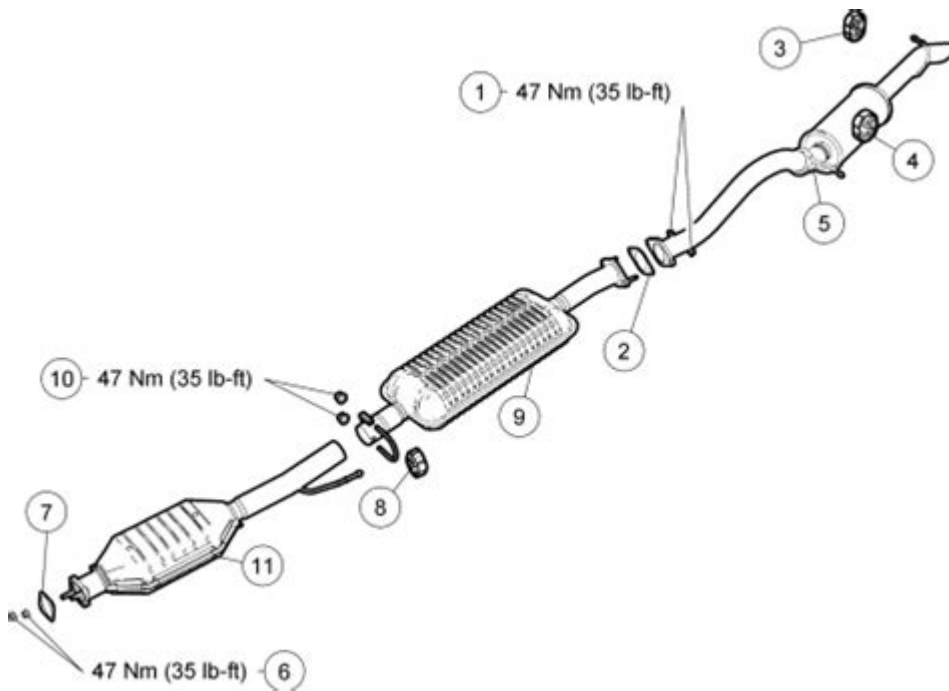

2008 Ford Escape Exhaust Diagram: Understanding the exhaust system of your vehicle is crucial for maintaining its performance and longevity. The exhaust system plays a vital role in directing harmful gases away from the engine and reducing emissions. The 2008 Ford Escape, a popular compact SUV, features a well-designed exhaust system that requires a comprehensive understanding for effective maintenance and troubleshooting. This article will provide a detailed overview of the exhaust system in the 2008 Ford Escape, including its components, layout, and common issues.

Overview of the 2008 Ford Escape Exhaust System

The exhaust system in the 2008 Ford Escape is designed to manage exhaust gases produced by the engine. It includes several components, each performing a specific function. The primary purpose of this system is to ensure a smooth and efficient expulsion of exhaust gases while minimizing noise and harmful emissions.

Key Components of the Exhaust System

The exhaust system of the 2008 Ford Escape comprises several key components:

- 1. Exhaust Manifold:** This is the first part of the exhaust system that collects exhaust gases from the engine's cylinders. In the 2008 Ford Escape, the exhaust manifold is typically made from cast iron or stainless steel for

durability.

2. Catalytic Converter: Located downstream of the exhaust manifold, the catalytic converter is crucial for reducing harmful emissions. It converts harmful gases (like carbon monoxide and nitrogen oxides) into less harmful substances before they exit the vehicle.

3. Oxygen Sensors: These sensors are placed before and after the catalytic converter. They monitor the levels of oxygen in the exhaust gases and help the engine control unit (ECU) adjust the air-fuel mixture for optimal combustion.

4. Exhaust Pipes: These pipes carry the exhaust gases from the engine to the rear of the vehicle. The pipes are typically made from stainless steel or aluminized steel to resist corrosion.

5. Muffler: The muffler is designed to reduce noise produced by the engine's exhaust gases. It contains various chambers and baffles that help dampen sound.

6. Exhaust Tip: This is the final part of the exhaust system, where the gases exit the vehicle. It can also serve an aesthetic purpose, adding to the vehicle's overall appearance.

Exhaust Diagram of the 2008 Ford Escape

Understanding the layout of the exhaust system is crucial for maintenance and repairs. The exhaust diagram provides a visual representation of how the components are arranged and connected.

Diagram Overview

The exhaust diagram for the 2008 Ford Escape typically consists of the following sections:

- Exhaust Manifold: Positioned at the engine's front, it connects directly to the engine's cylinder head.
- Catalytic Converter: Located a short distance from the exhaust manifold, it is secured to the vehicle's undercarriage.
- Oxygen Sensors: The upstream sensor is placed before the catalytic converter, while the downstream sensor is located after it.
- Exhaust Pipes: These run along the vehicle's underside, connecting the catalytic converter to the muffler.
- Muffler: Positioned near the rear of the vehicle, this component is connected to the exhaust pipes leading to the exhaust tip.
- Exhaust Tip: The final exit point for exhaust gases, typically located at the rear end of the vehicle.

Common Issues with the Exhaust System

As with any vehicle, the exhaust system can encounter various issues that may affect performance and emissions. Here are some common problems associated with the exhaust system in the 2008 Ford Escape:

1. Exhaust Leaks

Exhaust leaks can occur at various points in the system, often due to rust or damage. Symptoms include:

- Loud noises from the exhaust system
- Decreased fuel efficiency
- Strong exhaust odors inside the cabin

2. Faulty Oxygen Sensors

Oxygen sensors play a critical role in monitoring the exhaust gases. A faulty sensor can lead to poor engine performance and increased emissions. Symptoms include:

- Check engine light activation
- Poor fuel economy
- Rough idling

3. Catalytic Converter Failure

The catalytic converter can become clogged or damaged over time, leading to decreased engine performance and increased emissions. Symptoms include:

- Loss of power during acceleration
- Rattling noise from the converter
- Check engine light illumination

4. Muffler Damage

The muffler can become damaged due to road debris or corrosion. Symptoms include:

- Excessive noise from the exhaust
- Rust or holes in the muffler

Maintenance Tips for the Exhaust System

Regular maintenance of the exhaust system is essential for ensuring optimal performance and longevity. Here are some tips to keep your 2008 Ford Escape's exhaust system in good condition:

1. Regular Inspections

Perform routine inspections of the exhaust system every 6 months or as part of your vehicle's regular maintenance schedule. Look for signs of rust, leaks, or damage to the components.

2. Address Issues Promptly

If you notice any unusual noises, odors, or warning lights, address the issues promptly. Ignoring these problems can lead to more significant damage and costly repairs.

3. Keep the Underbody Clean

Road salt and debris can cause corrosion to the exhaust system. Regularly wash the underbody of your vehicle, especially during winter months, to reduce the risk of rust.

4. Use Quality Parts

If you need to replace any components of the exhaust system, opt for high-quality parts to ensure durability and optimal performance. OEM (Original Equipment Manufacturer) parts are often the best choice.

Conclusion

The exhaust system of the 2008 Ford Escape is a critical component that ensures the vehicle runs efficiently while minimizing harmful emissions. Understanding the exhaust diagram, key components, common issues, and maintenance tips can help you maintain your vehicle's performance and extend its lifespan. Regular inspections and timely repairs are essential in keeping the exhaust system functioning correctly, ensuring a safe and enjoyable driving experience. By taking care of the exhaust system, vehicle owners can contribute to a cleaner environment and prevent costly repairs in the future.

Frequently Asked Questions

What is the purpose of the exhaust system in a 2008 Ford Escape?

The exhaust system in a 2008 Ford Escape is designed to route exhaust gases away from the engine, reduce emissions, and minimize noise. It includes components like the exhaust manifold, catalytic converter, and muffler.

Where can I find a detailed exhaust diagram for a 2008 Ford Escape?

You can find a detailed exhaust diagram for a 2008 Ford Escape in the vehicle's service manual, on automotive websites, or through online forums dedicated to Ford vehicles. Additionally, repair shops may provide access to this information.

What are common issues related to the exhaust system in a 2008 Ford Escape?

Common issues include exhaust leaks, a failing catalytic converter, rust or corrosion on exhaust pipes, and problems with the oxygen sensors. These issues can lead to reduced performance and increased emissions.

How do I troubleshoot exhaust problems in my 2008 Ford Escape?

To troubleshoot exhaust problems, start by checking for visible leaks or damage in the exhaust pipes and connections. Listen for unusual noises, check the check engine light for codes related to the exhaust system, and consider inspecting the catalytic converter and oxygen sensors.

Is it necessary to replace the entire exhaust system if there's a small leak in the 2008 Ford Escape?

Not necessarily. A small leak may often be repaired by replacing a section of the exhaust pipe or a gasket. However, if there is significant corrosion or multiple leaks, it might be more cost-effective to replace larger sections or the entire system.

Find other PDF article:

<https://soc.up.edu.ph/17-scan/Book?dataid=oLX99-3794&title=diary-of-a-wimpy-kid-whole-collection.pdf>

2008 Ford Escape Exhaust Diagram

Exhaust Diagram? - 2008 Ford Escape Exhaust Diagram ...

2008 Ford Escape Exhaust Diagram
May 13, 2025 · 2008 Ford Escape Exhaust Diagram 1945 ...

Exhaust Diagram - 2008 Ford Escape Exhaust Diagram ...

Exhaust Diagram - 2008 Ford Escape Exhaust Diagram
Dec 21, 2022 · 2008 Ford Escape Exhaust Diagram 1 ...

Exhaust Diagram - 2008 Ford Escape Exhaust Diagram
Mar 22, 2024 · 2008 Ford Escape Exhaust Diagram 1 ...

Exhaust Diagram? - 2008 Ford Escape Exhaust Diagram ...

2008 Ford Escape Exhaust Diagram
May 13, 2025 · 2008 Ford Escape Exhaust Diagram 1945 ...

Exhaust Diagram - 2008 Ford Escape Exhaust Diagram ...

Exhaust Diagram - 2008 Ford Escape Exhaust Diagram
Dec 21, 2022 · 2008 Ford Escape Exhaust Diagram 1 ...

Exhaust Diagram - 2008 Ford Escape Exhaust Diagram
Mar 22, 2024 · 2008 Ford Escape Exhaust Diagram 1 ...

Exhaust Diagram Microsoft Visual C++ Exhaust Diagram
Exhaust Diagram vc Exhaust Diagram 2008 Exhaust Diagram ...

Exhaust Diagram - 2008 Ford Escape Exhaust Diagram
Dec 15, 2023 · 2008 Ford Escape Exhaust Diagram 1 ...

Exhaust Diagram - 2008 Ford Escape Exhaust Diagram
Exhaust Diagram 1921 7 23 31 2 1922 7 16 23 3 1923 6 12 20 4 1925 1 11 22 5 ...

PDF GENERATED BY PDF ELEMENTS 2020-01-14 14:14:14

Jun 11, 2025 · □□□□□ 2008 □□□□□□□□□□□□□□□□□□□□ □□□□□□□□□□ □□□□□□□□□□□□□□□□□□□□
□□

[Back to Home](#)