

# 2002 Chevy Silverado Parts Diagram

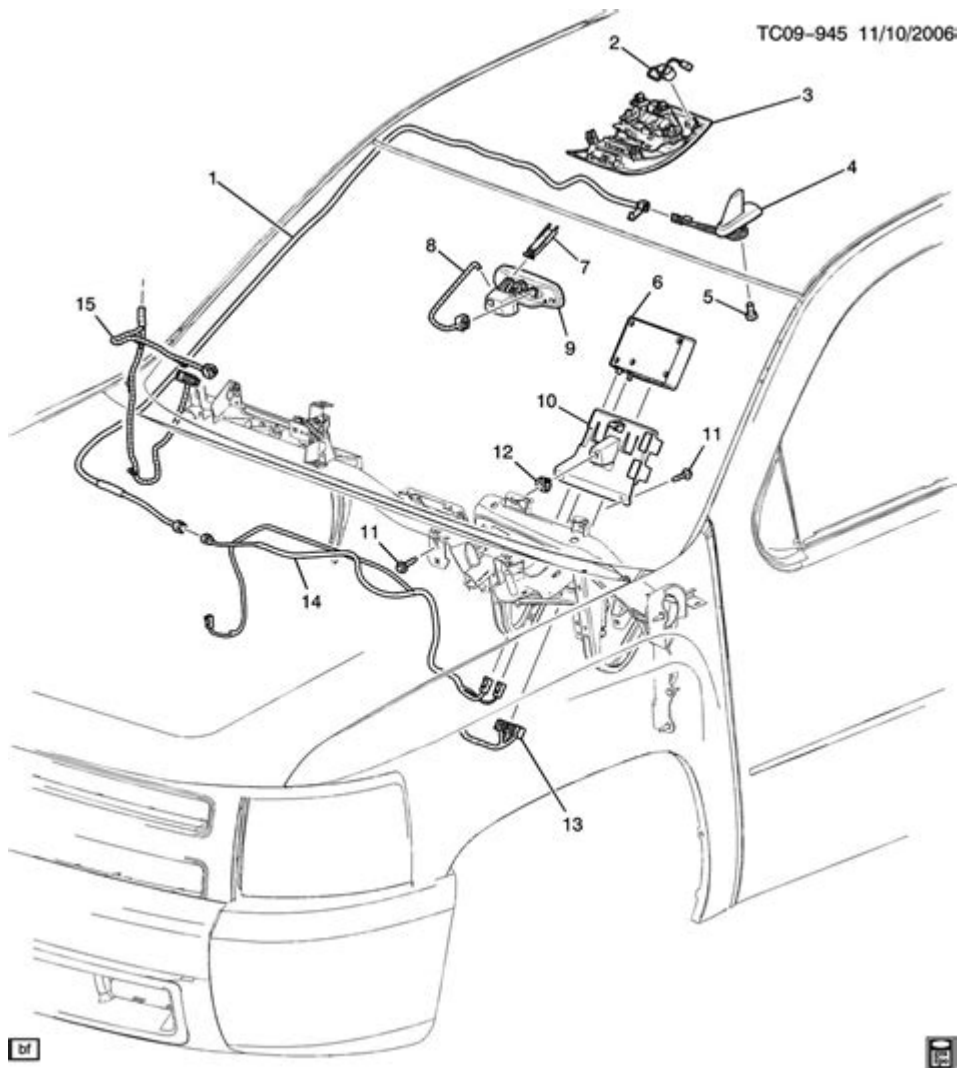

2002 Chevy Silverado parts diagram is an essential resource for anyone looking to maintain, repair, or upgrade their vehicle. Understanding the layout and function of various components can significantly simplify the process of troubleshooting, ensuring that repairs are done correctly and efficiently. The 2002 Chevy Silverado is a popular full-size pickup truck known for its reliability and versatility, making it a favorite among truck enthusiasts and everyday drivers alike. In this article, we'll delve into a comprehensive examination of the parts diagram for the 2002 Chevy Silverado, discussing key components, their functions, and common issues, along with tips on maintenance and replacement.

## Overview of the 2002 Chevy Silverado

The 2002 Chevy Silverado is part of the GMT800 platform, which General Motors produced from 1999 to 2006. It offers a range of configurations, including different cab styles, bed lengths, and engine options. The Silverado is known for its robust performance and capability, making it suitable for both work and recreational purposes.

The parts diagram for this model provides a visual representation of the truck's various systems, including the engine, transmission, suspension, electrical, and more. Each section of the diagram helps users identify parts for maintenance or replacement.

## Understanding the Parts Diagram

To effectively utilize the 2002 Chevy Silverado parts diagram, it's crucial to understand the different sections and how they relate to the vehicle's overall functionality. Here are some key areas covered in the diagram:

### 1. Engine Components

The engine is the heart of the Silverado, and understanding its components is vital for proper maintenance. The parts diagram includes:

- Engine Block: The main structure that houses the cylinders and other key components.
- Cylinder Heads: Cover the top of the engine block and house the intake and exhaust valves.
- Camshaft: Controls the opening and closing of the valves.
- Crankshaft: Converts the linear motion of the pistons into rotational motion.
- Oil Pan: Stores engine oil and aids in lubrication.

### 2. Transmission Parts

The transmission is crucial for transferring power from the engine to the wheels. The parts diagram typically lists:

- Transmission Case: The outer shell housing the internal components.
- Torque Converter: Connects the engine to the transmission and allows for smooth gear changes.
- Planetary Gear Sets: Responsible for gear ratios and shifting.
- Valve Body: Controls the flow of transmission fluid and gear selection.

### 3. Suspension System

The suspension system impacts ride quality and handling. Important components include:

- Shock Absorbers: Dampen the impact of bumps and irregularities on the road.
- Struts: Support the vehicle's weight and help maintain alignment.
- Control Arms: Connect the wheel assembly to the vehicle frame.
- Leaf Springs: Provide support and flexibility, particularly for trucks.

## 4. Electrical System

The electrical system powers various components in the Silverado. Key parts include:

- Battery: Supplies electrical power to start the engine and run accessories.
- Alternator: Charges the battery and powers electrical systems when the engine is running.
- Starter Motor: Engages the engine to start it.
- Fuses and Relays: Protect electrical circuits and control the flow of electricity.

## 5. Body and Interior Components

The body and interior parts contribute to both aesthetics and functionality. Notable components include:

- Doors: Provide access to the cab and rear area.
- Dashboard: Houses controls and displays for the driver.
- Seats: Provide comfort and support for passengers.
- Windshield and Windows: Protect against weather while providing visibility.

## Common Issues and Solutions

With any vehicle, certain issues may arise over time. Understanding these problems can guide you in using the 2002 Chevy Silverado parts diagram effectively for repairs.

### 1. Engine Problems

Common engine issues include:

- Oil Leaks: Often occur at the oil pan or around gaskets. Solution: Inspect gaskets and seals for wear and replace as necessary.
- Overheating: Can be caused by a faulty thermostat or coolant leaks. Solution: Check coolant levels and replace the thermostat if needed.

### 2. Transmission Troubles

Transmission problems can manifest as:

- Slipping Gears: Often indicates low transmission fluid or internal wear. Solution: Check fluid levels and inspect for leaks.
- Harsh Shifting: May be due to a malfunctioning valve body. Solution: Diagnostic testing can identify the issue; a rebuild may be necessary.

### 3. Suspension Concerns

Suspension-related issues often include:

- Bouncing or Rough Ride: Indicates worn shock absorbers or struts. Solution: Inspect and replace worn components.
- Uneven Tire Wear: Suggests alignment issues. Solution: Have the alignment checked and adjusted as necessary.

### 4. Electrical Failures

Electrical issues can be frustrating. Common problems include:

- Battery Drain: Often caused by parasitic draws or a failing alternator. Solution: Test the battery and alternator to identify the problem.
- Flickering Lights: May indicate a bad alternator or loose connections. Solution: Inspect wiring and connections for security and wear.

## Maintenance Tips

Regular maintenance can prevent many issues associated with the 2002 Chevy Silverado. Here are some tips:

- Regular Oil Changes: Change the oil and filter every 3,000 to 5,000 miles to ensure engine longevity.
- Check Fluids: Regularly inspect and top off fluids, including transmission fluid, brake fluid, and coolant.
- Inspect Brakes: Have your brake system checked regularly for wear and replacement of pads and rotors as needed.
- Tire Maintenance: Rotate tires every 5,000 miles and ensure proper inflation for optimal performance and safety.
- Electrical System Checks: Inspect battery terminals and wiring for corrosion or damage to maintain electrical reliability.

## Conclusion

In summary, the 2002 Chevy Silverado parts diagram is an invaluable tool for anyone looking to work on their vehicle. By understanding the various components and their functions, you can efficiently address maintenance and repair needs. From engine and transmission to suspension and electrical systems, knowing where to look and what to replace can save you time and money. Regular maintenance is key to keeping your Silverado in top condition, enabling you to enjoy the reliability and performance that this truck has to offer for years to come. Whether you're a DIY enthusiast or a professional mechanic, a solid grasp of the parts diagram will enhance your ability to keep the Silverado running smoothly.



2002年... 2002年...

2002年... 2002年... 1. 2002年1月1日——世界贸易组织 (WTO) 2. 2月8日24日——2002年... 3. 2月17日——2002年... 500...

2000年2001年2002..... 2000年2001年2002..... 1...

(2002) Apr 17, 2025 · (2002) ...

(2002) Apr 17, 2025 · (2002) https://pan.baidu.com/s/14VRv86bwtd31Rk\_nwCDKgwpwd=1234 (2002) ...

“ ” IP 110

(2002) Apr 16, 2025 · (2002) “ ”

(2002) | - - (2002)

- 2002年... 2002年... 2002年...

(2002)- ... (TPE:2002)- - (2002)

2002年... 2002年... ...

2002年... 2002年... 1. 2002年1月1日——世界贸易组织 (WTO) 2. 2月8日24日——2002年... 3. 2月17日 ...

2000年2001年2002..... 2000年2001年2002..... 1...

(2002) Apr 17, 2025 · (2002) ...

2002 (2002) -  
Apr 17, 2025 · (2002)  
https://pan.baidu.com/s/14VRv86bwtd31Rk\_nwCDKgwpwd=1234 (2002) ...

-  
“” IP110

(2002)\_  
Apr 16, 2025 · (2002) “”  
...

(2002) | - -  
(2002)

-  
 ...

Explore our comprehensive 2002 Chevy Silverado parts diagram to identify the components you need. Learn more about maintenance and upgrades today!

[Back to Home](#)