

# 2002 Chevy Silverado Brake Line Diagram

2000 Chevy Truck C 1500 Truck 2WD V8-4.8L VIN V

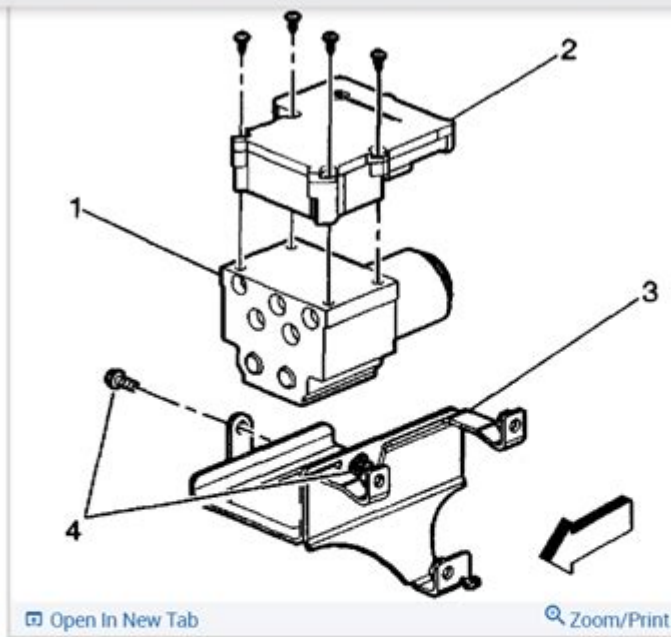

7. Remove the 2 bolts (4) securing the BPMV mounting bracket (3) to the BPMV (1).
8. Disconnect the 2 way [ABS pump motor](#) connector.
9. Remove the four T-25 TORX bolts from the EBCM (2).

**Important:**

- Do not use a tool to pry the EBCM or the BPMV. Excessive force will damage the EBCM.
- Do not reuse the EBCM mounting bolts. Always install NEW bolts.

10. Remove the EBCM (2) from the BPMV (1). Removal may require a light amount of force.

**2002 Chevy Silverado brake line diagram** is an essential tool for anyone looking to maintain or repair their vehicle's braking system. Understanding the layout and functionality of the brake lines is crucial for safe driving and effective braking performance. The 2002 Chevy Silverado, a robust and popular pickup truck, features a complex brake system that requires proper maintenance to ensure optimal performance. This article will delve into the specifics of the brake line system in the 2002 Chevy Silverado, including the layout, materials, common issues, tips for maintenance, and the relevance of having an accurate brake line diagram.

## Understanding the Brake System in the 2002 Chevy Silverado

The braking system in the 2002 Chevy Silverado is a hydraulic system that relies on brake fluid to transmit force from the brake pedal to the brake components at each wheel. This system includes various components such as

brake lines, calipers, rotors, and master cylinders.

## **Key Components of the Brake System**

1. **Brake Lines:** These are tubes that carry brake fluid from the master cylinder to the brake calipers or wheel cylinders.
2. **Master Cylinder:** This component generates the hydraulic pressure needed to activate the brakes.
3. **Brake Calipers:** These clamp the brake pads against the rotors to create friction and slow down the vehicle.
4. **Brake Rotors:** These are discs that the brake pads clamp down on to create stopping power.
5. **Brake Pads:** These are the friction materials that press against the rotors to slow or stop the vehicle.

## **The Importance of the Brake Line Diagram**

A brake line diagram serves as a visual guide to the layout and connections within the braking system. Understanding this diagram can help diagnose issues, facilitate repairs, and enhance maintenance practices. Here are some reasons why having a brake line diagram is vital:

- **Identification of Components:** It allows easy identification of each component and its connection within the system.
- **Troubleshooting:** When experiencing brake issues, a diagram can help pinpoint the source of the problem, such as leaks or blockages.
- **Installation and Replacement:** When replacing parts, knowing the correct routing of brake lines helps ensure proper installation.
- **Safety:** Properly functioning brakes are critical for vehicle safety. A diagram assists in ensuring all components are connected correctly.

## **Brake Line Diagram for the 2002 Chevy Silverado**

The brake line diagram for the 2002 Chevy Silverado provides a detailed view of the entire brake line system. It typically includes the following elements:

- **Routing of Brake Lines:** Shows the path the brake lines take from the master cylinder to each wheel.
- **Connections:** Details the connection points to the master cylinder, calipers, and any junction blocks.
- **Component Locations:** Highlights the locations of major components like the ABS module (if equipped) and the brake booster.
- **Brake Fluid Flow:** Illustrates how brake fluid flows through the system to engage brakes.

For a comprehensive understanding, it is advisable to refer to the vehicle's service manual or professional repair guides that include diagrams specific to the 2002 Chevy Silverado.

## Common Brake Line Issues

1. Rust and Corrosion: Brake lines are often made of steel, making them susceptible to rust, especially in areas with salty road conditions.
2. Leaks: A damaged brake line can lead to fluid leaks, resulting in brake failure.
3. Crimping or Kinking: Improper installation or wear can cause brake lines to kink, affecting fluid flow.
4. Contamination: Dirt and moisture can enter the brake lines, leading to brake fluid contamination and reduced braking performance.

## Maintenance Tips for Brake Lines

Regular maintenance of the brake lines is essential for the longevity and safety of the braking system. Here are some tips for maintaining the brake lines in your 2002 Chevy Silverado:

- Regular Inspections: Periodically check the brake lines for signs of rust, leaks, or damage. This is especially important before long trips or after harsh weather conditions.
- Flush Brake Fluid: Brake fluid should be flushed and replaced at regular intervals to prevent contamination and moisture buildup.
- Protective Coating: Applying a protective coating to exposed brake lines can help prevent rust.
- Avoid Road Salt: If possible, limit exposure to road salt, which can accelerate corrosion. After winter, wash the undercarriage of your vehicle to remove any salt residue.
- Professional Checkups: Schedule regular maintenance checkups with a professional mechanic to ensure all components of the brake system are functioning correctly.

## Conclusion

A solid understanding of the 2002 Chevy Silverado brake line diagram is crucial for any owner or mechanic involved in the maintenance or repair of this popular pickup truck. The brake system is one of the most vital components of vehicle safety, and ensuring it operates correctly can prevent accidents and ensure longevity. By familiarizing yourself with the layout and potential issues, you empower yourself to keep your vehicle in top condition.

In summary, the brake line diagram is not just a schematic; it is a roadmap

to better vehicle maintenance. Regular inspections, proper care, and timely repairs can significantly enhance the performance and safety of the braking system. Having this knowledge equips you to tackle brake-related issues with confidence, ensuring peace of mind on the road.

## **Frequently Asked Questions**

### **What is the purpose of the brake line diagram for a 2002 Chevy Silverado?**

The brake line diagram helps identify the routing and connections of the brake lines, ensuring proper installation and troubleshooting of the braking system.

### **Where can I find a reliable brake line diagram for my 2002 Chevy Silverado?**

Reliable brake line diagrams can be found in the vehicle's service manual, online automotive forums, or websites dedicated to Chevrolet truck repairs.

### **What should I do if the brake line diagram for my 2002 Chevy Silverado is missing?**

If the diagram is missing, consider purchasing a repair manual, accessing online resources, or consulting a professional mechanic for assistance.

### **Are there common issues indicated by the brake line diagram for a 2002 Chevy Silverado?**

Common issues include rust or corrosion in the brake lines, improper routing causing kinks, and loose connections leading to leaks.

### **Can I replace the brake lines on my 2002 Chevy Silverado without the diagram?**

While it's possible to replace the brake lines without the diagram, having it greatly simplifies the process and helps avoid mistakes in routing and connections.

### **What tools are necessary to follow the brake line diagram for a 2002 Chevy Silverado?**

Essential tools include a wrench set, line wrenches for brake lines, a brake line cutter, brake line flaring tools, and possibly a jack and jack stands for vehicle elevation.

<https://soc.up.edu.ph/65-proof/files?trackid=xic46-3838&title=what-is-a-null-hypothesis-in-biology.pdf>

臺灣(2002)-臺灣省縣市政府 ...  
 臺灣 (TPE:2002)-臺灣-臺灣-臺灣縣市政府 (2002) 臺灣縣市政府

2002年1月1日——世界贸易组织 (WTO) 2. 2002年8月24日——2002年世界贸易组织 3. 2017 ...

[Apr 17, 2025 · 書籍 書籍 \(2002\) 書籍](#)

[illegible][illegible]

(2002)-...  
 (TPE:2002)- (2002)

2002年...  
...

**2002年...**  
2002年... 1. 2002年1月1日——... (WTO) 2. 2月8日24日——2002年...  
3. 2月17 ...

2000年2001年2002.....  
2000年2001年2002..... 1 ...  
...

(2002) -  
Apr 17, 2025 · (2002) ...  
...

(2002) -  
Apr 17, 2025 · (2002)  
[https://pan.baidu.com/s/14VRv86bwtd31Rk\\_nwCDKgW?pwd=1234](https://pan.baidu.com/s/14VRv86bwtd31Rk_nwCDKgW?pwd=1234) (2002) ...

-  
“” IP 110

(2002) -  
Apr 16, 2025 · (2002) “”  
...

(2002) | - -  
(2002)

-  
...  
...

"Looking for a 2002 Chevy Silverado brake line diagram? Our detailed guide provides clear diagrams and expert tips. Learn more to keep your truck in top shape!"

[Back to Home](#)