

# 2001 Dodge Ram 1500 Brake Line Diagram

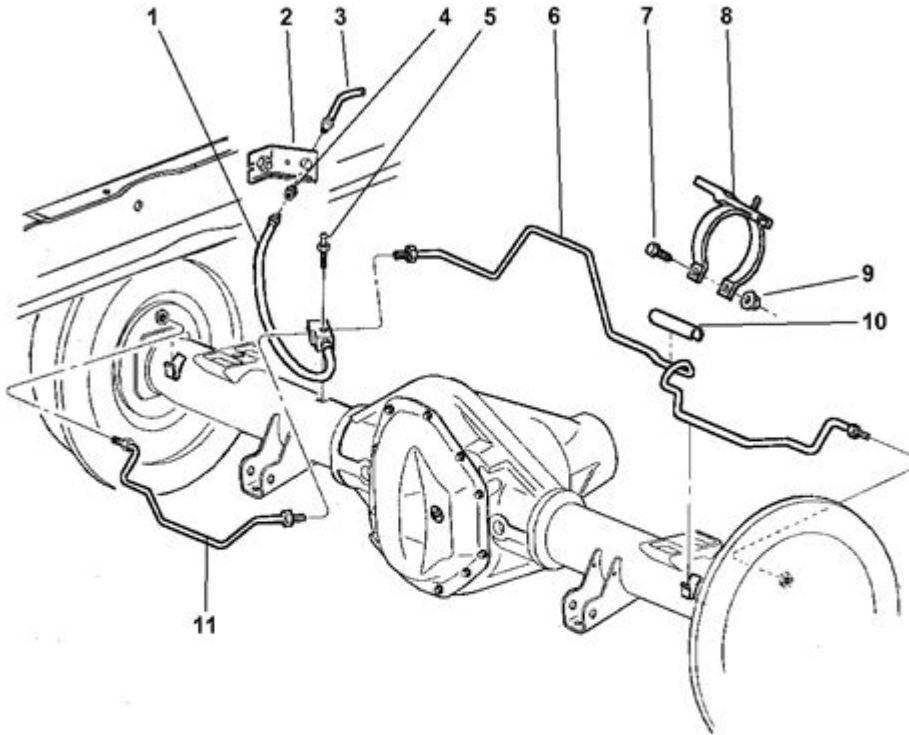

**2001 Dodge Ram 1500 brake line diagram** is an essential resource for any Dodge Ram owner or mechanic looking to maintain or repair the braking system of this iconic truck. Understanding the layout and function of the brake lines is crucial for ensuring the safety and effectiveness of the vehicle's braking system. In this article, we will explore the brake line diagram of the 2001 Dodge Ram 1500, discuss the components involved, and provide tips for maintenance and repair.

## Understanding Brake Lines

Brake lines are vital components of a vehicle's braking system, responsible for delivering hydraulic fluid from the master cylinder to the brake calipers at each wheel. The 2001 Dodge Ram 1500 uses a complex network of brake lines, which can be challenging to navigate without a clear diagram.

# Types of Brake Lines

- **Steel Brake Lines:** These are typically used for the primary brake lines due to their durability and resistance to corrosion. However, they can be prone to rust if not properly maintained.
- **Rubber Brake Hoses:** These are flexible hoses that connect the rigid brake lines to the brake calipers. They allow for movement of the suspension components while maintaining the hydraulic connection.

## Brake Line Diagram Overview

The brake line diagram for the 2001 Dodge Ram 1500 illustrates the configuration and routing of the brake lines throughout the vehicle. The diagram will usually include the following components:

- **Master Cylinder:** This is the starting point for brake fluid distribution.
- **Brake Lines:** Rigid steel lines that connect the master cylinder to the brake hoses.
- **Brake Hoses:** Flexible lines that connect to the brake calipers.
- **Brake Calipers:** The component that houses the brake pads and applies pressure to the brake rotors.

## Key Components in the Brake Line System

1. **Master Cylinder:** Located on the driver's side of the engine bay, it holds the brake fluid and generates the hydraulic pressure needed for braking.
2. **ABS Module:** If equipped with Anti-lock Brake System (ABS), the ABS module plays a crucial role in preventing wheel lock-up during braking.
3. **Brake Proportioning Valve:** This valve ensures an appropriate brake force distribution between the front and rear wheels.
4. **Front and Rear Brake Lines:** The front brake lines run from the master cylinder to the front brake calipers, while the rear lines extend to the rear brakes, which may include drums on some models.
5. **Brake Calipers:** Located at each wheel, these clamp down on the brake rotors to create friction, slowing the vehicle.

# Reading the Brake Line Diagram

Understanding how to read the brake line diagram is crucial for effective maintenance and repairs. Here are some tips for interpreting the diagram:

- Orientation: The diagram may be oriented from the driver's perspective, meaning the left side of the diagram corresponds to the left side of the vehicle.
- Color Coding: Some diagrams include color codes for different brake lines. For instance, red may indicate the supply line, while blue might denote return lines.
- Line Routing: Pay attention to how the lines run along the chassis. This can help in identifying potential areas of wear or damage.

## Common Problems with Brake Lines

1. Corrosion: Especially in areas with harsh weather conditions, brake lines can corrode and develop leaks.
2. Cracking: Rubber hoses can crack due to age, heat, and exposure to the elements.
3. Loose Connections: Over time, connections can become loose, leading to leaks or reduced braking performance.

## Maintenance Tips for Brake Lines

Keeping the brake lines in good condition is essential for safe driving. Here are some maintenance tips:

- Regular Inspections: Periodically check for signs of wear, corrosion, or leaks. It's best to perform these checks during routine maintenance.
- Fluid Checks: Ensure that the brake fluid is at the appropriate level and that it is clean. Contaminated fluid can lead to brake failure.
- Replace Worn Parts: If cracks or leaks are found in the brake lines or hoses, replace them immediately to avoid safety hazards.
- Flush Brake Fluid: Flushing the brake fluid every two years can help prevent moisture buildup, which can cause corrosion within the brake lines.

# Troubleshooting Brake Line Issues

If you suspect there is an issue with your brake lines, it's important to troubleshoot effectively:

1. **Visual Inspection:** Start with a thorough visual inspection of the brake lines for any signs of leaks or damage.
2. **Brake Pedal Feel:** Pay attention to how the brake pedal feels. A spongy brake pedal may indicate air in the lines or a leak.
3. **Fluid Leaks:** Look for any puddles of brake fluid under the vehicle, which could indicate a leak in the system.
4. **Check for ABS Alerts:** If your vehicle is equipped with ABS, any warning lights on the dashboard should be addressed. They could indicate issues with the brake system.

## Conclusion

The 2001 Dodge Ram 1500 brake line diagram is a fundamental tool for understanding the braking system of this robust truck. By familiarizing yourself with the components, reading the diagram correctly, and following proper maintenance protocols, you can ensure your brake system remains in optimal condition. Always prioritize safety and consult a professional mechanic if you're unsure about any repairs or maintenance procedures. Properly functioning brake lines are essential for the safe operation of your vehicle, making it crucial to address any issues promptly.

## Frequently Asked Questions

### **What is the purpose of the brake line diagram for a 2001 Dodge Ram 1500?**

The brake line diagram illustrates the layout and routing of the brake lines in the vehicle, helping with maintenance and repairs.

### **Where can I find a detailed brake line diagram for a 2001 Dodge Ram 1500?**

You can find detailed brake line diagrams in repair manuals, online automotive forums, or websites specializing in Dodge truck resources.

## **How do I interpret the brake line diagram for my 2001 Dodge Ram 1500?**

To interpret the diagram, identify the components like the master cylinder, brake lines, and wheel cylinders, and follow the lines to understand their connections.

## **Are there common issues related to the brake lines on a 2001 Dodge Ram 1500?**

Yes, common issues include rusted or corroded brake lines, leaks, and improper routing during repairs or replacements.

## **Can I replace the brake lines on my 2001 Dodge Ram 1500 without a diagram?**

While it's possible to replace brake lines without a diagram, having one significantly aids in ensuring proper routing and connections.

## **What tools do I need to follow the brake line diagram for a 2001 Dodge Ram 1500?**

You'll need basic hand tools such as wrenches, pliers, and possibly a brake line flare tool, along with replacement brake lines.

## **Is it safe to drive a 2001 Dodge Ram 1500 with a damaged brake line?**

No, driving with a damaged brake line is unsafe as it can lead to brake failure, resulting in a serious accident.

## **What should I do if I can't find the brake line diagram for my 2001 Dodge Ram 1500?**

If you can't find the diagram, consider contacting a Dodge dealership, searching online forums, or consulting a professional mechanic for assistance.

Find other PDF article:

<https://soc.up.edu.ph/06-link/Book?dataid=JUi74-1515&title=animal-life-cycle-worksheets.pdf>

## **[2001 Dodge Ram 1500 Brake Line Diagram](#)**

Search the world's information, including webpages, images, videos and more. Google has many special features to help you find exactly what you're looking for.

### Google Translate

Google's service, offered free of charge, instantly translates words, phrases, and web pages between English and over 100 other languages.

### **Google Afbeeldingen**

Google Afbeeldingen. De grootste zoekmachine voor afbeeldingen op internet.

### **Google Images**

Google Images. The most comprehensive image search on the web.

### **Google als Startseite festlegen - Google Suche-Hilfe**

Startseite zurücksetzen: Wählen Sie einen der obigen Browser aus und folgen Sie dann der Anleitung, um eine andere Website als Google als Startseite festzulegen.

### **Google**

Werbeprogramme Über Google Google.com in English © 2025 - Datenschutzerklärung - Nutzungsbedingungen

### **Google Functies**

Google doorbreekt de taalbarrière met een nieuwe vertaalmogelijkheid. Gebruik makend van vertaaltechnologie, maakt Google het mogelijk Engelstalige sprekers toegang te geven tot niet ...

### **Google - Apps op Google Play**

De Google-app houdt je op de hoogte van de dingen waarin je bent geïnteresseerd. Vind snelle antwoorden, verken je interesses en ontvang een feed met updates over onderwerpen die je ...

### **Über Google: Unsere Produkte, Technologien und das ...**

Alles rund um Google: Unsere innovativen KI-Produkte und -Dienste – und wie unsere Technologien Menschen auf der ganzen Welt helfen.

### **Zoeken op Google**

Voor veel zoekopdrachten biedt Google antwoorden rechtstreeks in de zoekresultaten. Sommige functies, zoals informatie over sportteams, zijn niet in alle regio's beschikbaar.

### **twitch**

Feb 29, 2024 · Twitch 2011 6 Twitch

### **twitch**

Dec 12, 2024 · twitch Twitch

### **twitch**

Dec 9, 2024 · Twitch 2011 Twitch RTS

### **twitch-twitch**

Oct 20, 2024 · twitch-twitch twitch "twitch" twitch

**steam** -

Mar 11, 2023 · steam 1 Steam 2 Steam “ ” 3 “ ”

**Twitch** -

Mar 17, 2024 · Twitch Twitch Twitch ...

**twitch** -

Twitch 3800 2000 1.5 28

-

1 “Internet ” 2

**twitch**-**twitch** -

Oct 25, 2024 · twitch-twitch twitch “twitch” twitch twitch

**twitch** -

Jan 24, 2024 · twitch twitch twitch twitch twitch twitch twitch ...

Discover the 2001 Dodge Ram 1500 brake line diagram to simplify your brake repair. Get the detailed guide and tips you need. Learn more now!

[Back to Home](#)