

# 2002 Dodge Intrepid Service Engine Light

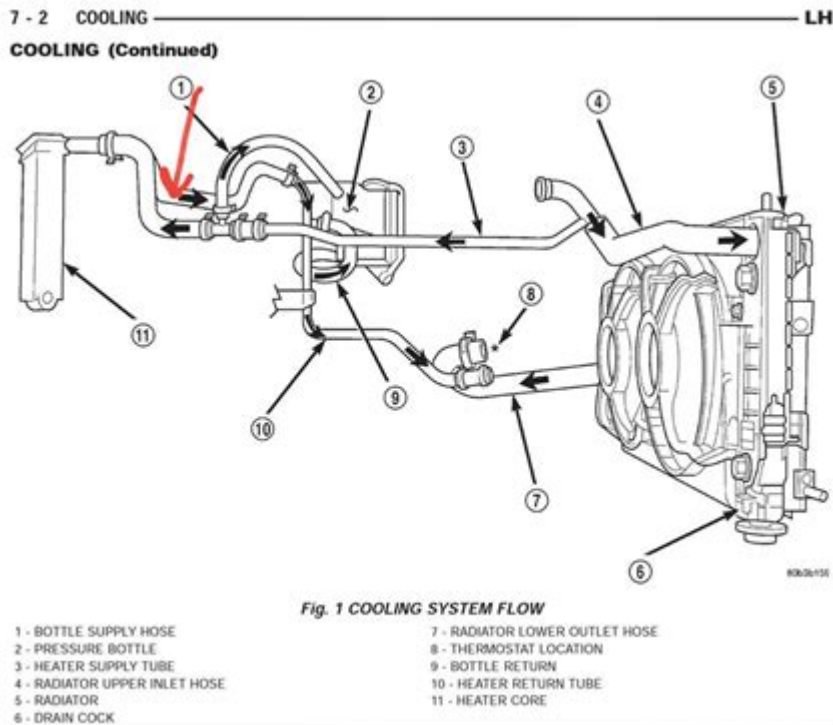

**2002 Dodge Intrepid service engine light** is a common concern for many owners of this mid-size sedan. The service engine light, also known as the check engine light, can illuminate for a myriad of reasons, ranging from minor issues to more serious mechanical failures. Understanding the potential causes of this warning light and how to address them not only helps in maintaining the vehicle's performance but also ensures safety on the road. In this article, we will delve into the common reasons for the service engine light activation, troubleshooting steps, and how to keep your 2002 Dodge Intrepid running smoothly.

## Understanding the Service Engine Light

The service engine light on your 2002 Dodge Intrepid is part of the vehicle's onboard diagnostics system. This system is designed to monitor various components of the engine and emissions control systems. When the onboard computer detects an issue that affects performance, fuel efficiency, or emissions, it triggers the service engine light.

## What Does the Service Engine Light Mean?

The service engine light can indicate several potential issues, which can be categorized into two main types:

1. Minor Issues: These may not necessarily affect immediate drivability but should be

addressed to maintain performance.

2. Major Issues: These can lead to significant engine damage or safety hazards if not resolved quickly.

## Common Causes of the Service Engine Light in a 2002 Dodge Intrepid

When the service engine light comes on, it's crucial to identify the underlying cause. Here are some common reasons specific to the 2002 Dodge Intrepid:

- **Loose or Damaged Gas Cap:** A loose or damaged gas cap can cause fuel vapors to leak, leading to the service engine light activation.
- **Faulty Oxygen Sensors:** Oxygen sensors monitor the amount of unburned oxygen in the exhaust. If they malfunction, it can affect fuel efficiency and emissions.
- **Malfunctioning Catalytic Converter:** The catalytic converter helps reduce harmful emissions. A malfunction can lead to decreased performance and increased emissions.
- **Defective Spark Plugs or Wires:** Worn or damaged spark plugs can lead to misfires, impacting engine performance and efficiency.
- **Engine Vacuum Leaks:** Leaks in the vacuum system can cause the engine to run lean, triggering the service engine light.
- **Faulty Mass Airflow Sensor:** This sensor measures the amount of air entering the engine. If it fails, it can disrupt the air-fuel mixture.

## Troubleshooting the Service Engine Light

If your 2002 Dodge Intrepid's service engine light comes on, follow these troubleshooting steps to identify and potentially resolve the issue:

### Step 1: Check for Diagnostic Trouble Codes (DTC)

The first step in troubleshooting is to read the diagnostic trouble codes. You can do this by:

1. Visiting a professional mechanic who has the necessary diagnostic tools.
2. Using an OBD-II scanner, which you can purchase or rent from auto parts stores.

Once you retrieve the codes, you can look them up to understand what issues your vehicle is experiencing.

## **Step 2: Inspect the Gas Cap**

A loose or damaged gas cap is one of the simplest fixes. Inspect the gas cap for any cracks or damage and ensure it is securely tightened. If the cap appears worn, replace it and see if the service engine light turns off after a few drive cycles.

## **Step 3: Check for Vacuum Leaks**

Inspect the vacuum hoses connected to the intake manifold. Look for any cracks or disconnections. A vacuum leak can cause the engine to run inefficiently and trigger the service engine light.

## **Step 4: Examine Spark Plugs and Wires**

Check the condition of the spark plugs and wires. If they appear worn or corroded, replace them. New spark plugs can improve fuel efficiency and engine performance.

## **Step 5: Test the Oxygen Sensors**

If the diagnostic trouble codes indicate an issue with the oxygen sensors, they should be tested for functionality. Replacing a faulty sensor can restore proper fuel mixture balance and improve performance.

## **When to Seek Professional Help**

While some issues may be resolved with basic troubleshooting, others require professional intervention. Here are scenarios when it's best to consult a mechanic:

- If the service engine light remains illuminated after attempting fixes.
- If the vehicle exhibits unusual symptoms, such as rough idling, stalling, or reduced power.
- If you are unable to diagnose the issue using a scanner.

# Preventive Maintenance Tips for Your 2002 Dodge Intrepid

To minimize the risk of the service engine light coming on, it's essential to follow a regular maintenance schedule. Here are some tips:

1. **Regular Oil Changes:** Change the engine oil and filter as per the manufacturer's recommendations to ensure optimal engine performance.
2. **Inspect and Replace Air Filters:** A clean air filter contributes to better air intake and engine efficiency.
3. **Monitor Fluid Levels:** Regularly check and maintain proper levels of coolant, brake fluid, and transmission fluid.
4. **Routine Inspections:** Schedule periodic inspections to catch potential issues early before they escalate.
5. **Use Quality Fuel:** Using quality fuel can prevent deposits from forming in the engine and fuel system.

## Conclusion

The **2002 Dodge Intrepid service engine light** can be triggered by various issues, ranging from minor to severe. Understanding the potential causes and addressing them promptly can save you from costly repairs and ensure your vehicle runs efficiently. Regular maintenance and timely diagnostics are key to keeping your Intrepid in excellent condition. If in doubt, don't hesitate to seek professional help to maintain the longevity and performance of your vehicle.

## Frequently Asked Questions

### What does the service engine light indicate on a 2002 Dodge Intrepid?

The service engine light on a 2002 Dodge Intrepid indicates that the vehicle's onboard diagnostic system has detected a problem with the engine or emission control system.

### What are common reasons for the service engine light

## **to come on in a 2002 Dodge Intrepid?**

Common reasons include a loose or damaged gas cap, faulty oxygen sensors, bad spark plugs, or issues with the catalytic converter.

## **How can I reset the service engine light on my 2002 Dodge Intrepid?**

You can reset the service engine light by disconnecting the battery for about 15 minutes or using an OBD-II scanner to clear the trouble codes.

## **Is it safe to drive my 2002 Dodge Intrepid with the service engine light on?**

While it may be safe to drive in some cases, it is recommended to have the vehicle checked as soon as possible to avoid potential damage or safety issues.

## **How do I diagnose the issue if the service engine light is on in my 2002 Dodge Intrepid?**

You can diagnose the issue by using an OBD-II scanner to read the trouble codes, which will provide specific information about the problem.

## **What should I do if the service engine light comes on after a recent repair on my 2002 Dodge Intrepid?**

If the light comes on after a repair, check that the repairs were done correctly and that no new issues have arisen. It may be wise to return to the mechanic for further inspection.

## **Can I continue driving my 2002 Dodge Intrepid if the service engine light is flashing?**

No, if the service engine light is flashing, it indicates a severe issue, possibly related to misfires. You should stop driving immediately and have the vehicle inspected.

Find other PDF article:

<https://soc.up.edu.ph/37-lead/files?dataid=Zdm02-8222&title=lego-building-instructions-30641.pdf>

## **2002 Dodge Intrepid Service Engine Light**

2002 Dodge Intrepid Service Engine Light...

2002 Dodge Intrepid Service Engine Light (TPE:2002)-2002 Dodge Intrepid Service Engine Light (2002)...

2002 Dodge Intrepid Service Engine Light - 2002

2002年...  
...

2002年...  
2002年... 1. 2002年1月1日—... (WTO) 2. 2月8日24日—2002年...  
... 3. 2月17日 ...

2000年2001年2002年.....  
2000年2001年2002年..... 1 ...  
...

(2002) -  
Apr 17, 2025 · (2002) ...  
...

(2002) -  
Apr 17, 2025 · (2002) ...  
[https://pan.baidu.com/s/14VRv86bwtd31Rk\\_nwCDKgW?pwd=1234](https://pan.baidu.com/s/14VRv86bwtd31Rk_nwCDKgW?pwd=1234) (2002) ...

-  
“” IP 110 ...

(2002) -  
Apr 16, 2025 · (2002) “” ...  
...

(2002) | - -  
(2002) ...

-  
...  
...

(2002)-CMoney  
(TPE:2002)- (2002) ...

2002 -  
2002 ...  
...

2002 -  
2002年... 1. 2002年1月1日—... (WTO) 2. 2月8日24日—2002年...  
... 3. 2月17日— ...

2000年2001年2002年.....  
2000年2001年2002年..... 1 ...  
...

(2002) -  
Apr 17, 2025 · (2002) ...  
...

Is your 2002 Dodge Intrepid's service engine light on? Discover how to diagnose and fix the issue effectively. Learn more to keep your vehicle running smoothly!

[Back to Home](#)