

2006 Honda Rancher 350 Parts Diagram

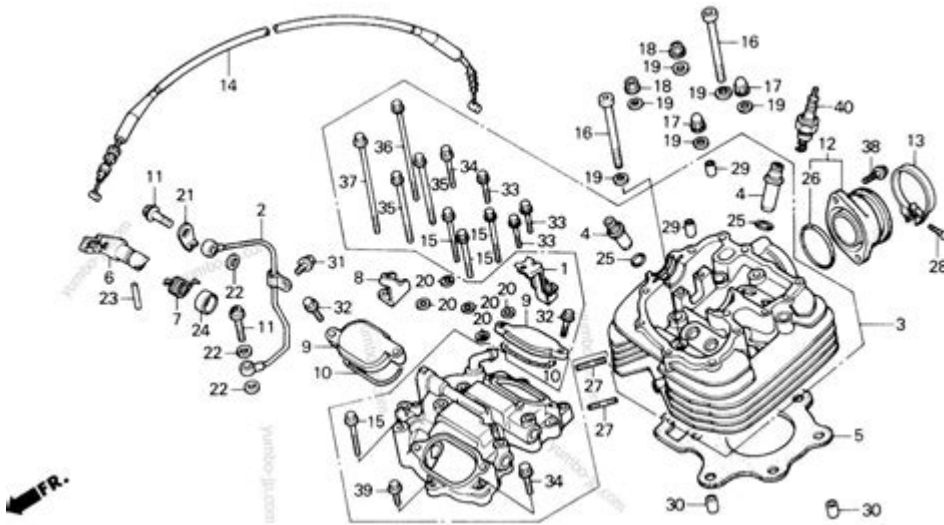

2006 Honda Rancher 350 Parts Diagram

The 2006 Honda Rancher 350 is a versatile all-terrain vehicle (ATV) that has garnered acclaim for its reliability and performance. Understanding its components and assembly is crucial for maintenance, repairs, and upgrades. A comprehensive parts diagram serves as a valuable reference for both enthusiasts and those new to ATV ownership. This article will delve into the various components of the 2006 Honda Rancher 350, offering insights into the parts diagram, their functions, and tips for maintenance.

Overview of the 2006 Honda Rancher 350

The Honda Rancher 350 is part of Honda's popular Rancher series, known for their durability and capability in various terrains. This model is equipped with a 347cc air-cooled, four-stroke engine, and features a robust chassis designed for both recreational and utility purposes. The Rancher 350 is available in two-wheel drive and four-wheel drive configurations, making it suitable for different riding conditions.

Key Features

- Engine: 347cc air-cooled, four-stroke single-cylinder engine
- Transmission: Available in both manual and automatic options
- Drive Type: Two-wheel drive (2WD) and four-wheel drive (4WD) options
- Suspension: Independent front and rear suspension for improved handling
- Brakes: Front disc brakes and rear drum brakes
- Towing Capacity: Capable of towing up to 1,500 lbs

Parts Diagram Overview

The parts diagram for the 2006 Honda Rancher 350 serves as a visual representation of the various components and their arrangement. This diagram can be an essential tool for identifying parts during maintenance or repair tasks. Understanding the parts diagram can help riders troubleshoot issues more effectively.

Importance of the Parts Diagram

- Identification: Easily identify parts and their specific locations.
- Maintenance: Streamlines the process of replacing or repairing components.
- Compatibility: Ensures that replacement parts are compatible with the model.
- Visual Reference: Offers a clear visual representation that can simplify complex repairs.

Key Components of the 2006 Honda Rancher 350

The parts diagram of the 2006 Honda Rancher 350 includes a variety of components, each serving a unique purpose. Below are some of the key components, along with their functions:

1. Engine Components

- Cylinder Head: Houses the valves and camshaft; vital for engine performance.
- Piston: Converts fuel energy into mechanical energy; essential for the engine's operation.
- Crankshaft: Transforms the linear motion of the piston into rotational motion.
- Camshaft: Regulates the opening and closing of the engine's valves.

2. Transmission Components

- Gearbox: Houses the gears that control the ATV's speed and torque.
- Clutch: Engages and disengages the engine power to the wheels.
- Shift Lever: Allows the rider to change gears smoothly.

3. Electrical System

- Battery: Provides the electrical energy required to start the engine.
- Starter Motor: Engages the engine to facilitate starting.
- Wiring Harness: Connects various electrical components, ensuring proper functionality.

4. Suspension and Chassis

- Front Shocks: Absorb impacts from uneven terrain, improving ride comfort.
- Rear Shocks: Work with the rear suspension system to provide stability.
- Frame: The foundational structure that supports all other components.

5. Wheels and Tires

- Rims: Provide a structure for mounting tires and maintaining tire integrity.
- Tires: Designed for traction and stability on various terrains.

Common Replacement Parts

As with any vehicle, certain parts may need replacement over time due to wear and tear. Understanding which parts are commonly replaced can help in planning maintenance schedules.

1. Air Filter

- Function: Filters out dirt and debris from entering the engine.
- Replacement Frequency: Every 50 to 100 hours of use, or as needed.

2. Oil Filter

- Function: Keeps engine oil clean for optimal performance.
- Replacement Frequency: Every oil change, typically every 100 hours.

3. Brake Pads

- Function: Essential for safe stopping; worn pads can reduce braking efficiency.

- Replacement Frequency: Inspect regularly; replace when worn down.

4. Tires

- Function: Provide traction and support for the ATV.
- Replacement Frequency: Inspect for wear; replace as needed.

5. Battery

- Function: Powers the electrical systems and starts the engine.
- Replacement Frequency: Typically every 2-3 years, depending on usage and care.

Maintenance Tips for the 2006 Honda Rancher 350

Regular maintenance is crucial for ensuring the longevity and performance of the 2006 Honda Rancher 350. Here are some essential maintenance tips:

1. Regular Oil Changes

- Change the engine oil every 100 hours of operation or at least once a year.
- Use the manufacturer-recommended oil type to ensure optimal performance.

2. Check the Tire Pressure

- Maintain proper tire pressure for better handling and fuel efficiency.
- Inspect tires for wear and replace them when necessary.

3. Inspect Brake System

- Regularly check brake pads and fluid levels.
- Replace worn pads to ensure safe operation.

4. Clean the Air Filter

- Inspect and clean the air filter regularly to prevent engine damage.
- Replace it if it is excessively dirty or damaged.

5. Battery Maintenance

- Keep the battery clean and free from corrosion.
- Check the connections and ensure they are tight.

Conclusion

The 2006 Honda Rancher 350 is a robust and reliable ATV, suitable for a variety of applications. A comprehensive understanding of its parts diagram can significantly aid in maintenance and repairs. By familiarizing oneself with the key components, common replacement parts, and best maintenance practices, owners can ensure their ATV remains in excellent condition for years to come. Whether you're an experienced rider or a novice, knowing your vehicle's anatomy will enhance your riding experience and extend the life of your Honda Rancher 350.

Frequently Asked Questions

What is the best source for a 2006 Honda Rancher 350 parts diagram?

The best source for a 2006 Honda Rancher 350 parts diagram is the official Honda website, authorized dealers, or reputable online ATV parts retailers.

How can I use a parts diagram for my 2006 Honda Rancher 350?

You can use a parts diagram to identify specific components, understand assembly, and find part numbers for ordering replacements or upgrades.

Are there different versions of the parts diagram for the 2006 Honda Rancher 350?

Yes, there may be different versions of the parts diagram based on model variations, such as the manual shift versus automatic versions.

Can I find a downloadable PDF version of the 2006 Honda Rancher 350 parts diagram?

Yes, many websites offer downloadable PDF versions of the 2006 Honda Rancher 350 parts diagram that can be printed for easier reference.

What should I do if I can't find a specific part on the 2006 Honda Rancher 350 parts diagram?

If you can't find a specific part, consider contacting a Honda dealer or a specialized ATV parts supplier who can assist you in locating it.

Is the parts diagram for the 2006 Honda Rancher 350 the same as other Honda Rancher models?

No, the parts diagram for the 2006 Honda Rancher 350 may differ from other models. Always refer to the specific diagram for accurate information.

What kind of information can I expect to find in the parts diagram for the 2006 Honda Rancher 350?

You can expect to find labeled parts, part numbers, and sometimes exploded views that show how components fit together.

How do I read the parts diagram for my 2006 Honda Rancher 350?

To read the parts diagram, start by locating the section relevant to your repair, then match the labeled parts with their corresponding part numbers for ordering.

Can I use the parts diagram to perform maintenance on my 2006 Honda Rancher 350?

Yes, the parts diagram is a helpful tool for performing maintenance, as it shows the location and assembly of various components.

Where can I find community support for questions about the 2006 Honda Rancher 350 parts diagram?

Community support can often be found on ATV forums, Facebook groups, and online motorcycle forums where enthusiasts share information and advice.

Find other PDF article:

<https://soc.up.edu.ph/13-note/pdf?dataid=VNo23-0906&title=christmas-trivia-questions-and-answers-printable.pdf>

[2006 Honda Rancher 350 Parts Diagram](#)

Dec 4, 2024 · * 日本代表 - 日本 3-1 日本 * 日本 - 日本 6-4 日本代表代表 日本2006 FIFA 日本代表代表 日本代表
日本代表32日本代表 ...

□□□□(2006)-□□□□□□□□□□□□CMoney □□□□ ...

□□□(2006)-□□□□□□□□□□□□□□□□□□□□(2006)□□□□□□□□□□□□□□□ ...

□□□□ (2006)□□□□□□□□□□□□ - □□□□

Apr 28, 2025 · □□□□ (2006)□□□□□□□□□□

□https://pan.baidu.com/s/1bVrNh_wzHu3p03of9XnsZg?pwd=1234□□□ □□□□ (2006)□□ ...

2006□□□□□□□□ - □□□□

2006 2006

□□□ (2006) □□□□□□□□□□□□ - □□□□

Apr 13, 2025 · 11:11 (2006) 11:11

□https://pan.baidu.com/s/1TyME8dhCntIEFP_8VDxjEQ?pwd=1234□□□ □□□ (2006)□□ ...

□□□□(2006)-□□□□□□□□□□□□□□□□□□ ...

(TPE;2006)- - (2006)

□□□□□□ (2006) □□□□□□□□□□□□ □□□□

May 25, 2025 · 中国中央电视台 (2006) 中国中央电视台 CCTV-10 中国中央电视台

$\square \square \square \square \square$ $\square \square \square \square \square \square$...

□□□ Silent Hill (2006) □□□□□□□□□□ □□□□

Apr 11, 2025 · Silent Hill (2006)

□□□□ (2006)□□□□□□□□□□□□ - □□□□

May 14, 2025 · 0000 (2006)0000000000 00 00 1000

□□□□ **Cars (2006)** □□□□□□□□□□ □□□□

[illegible]

□□□“□□”□“□□”□□□...

2006年10月1日 - 10月31日

Dec 4, 2024 · * 000000 - 00 3-1 000 * 000 - 000 6-4 0000000000 0002006FIFA0000000000 000000

□□□□□□□32□□□□□□ ...

□□□□(2006)-□□□□□□□□□□□□□□□□*CMoney* □□□□ ...

□□□□(2006)-□□□□□□□□□□□□□□□□□□□□(2006)□□□□□□□□□□□□□□□□ ...

□□□□ (2006)□□□□□□□□□□□□ - □□□□

Apr 28, 2025 · □□□□ (2006)□□□□□□□□□□

□https://pan.baidu.com/s/1bVrNh_wzHu3p03of9XnsZg?pwd=1234□□□ □□□□ (2006)□□ ...

2006□□□□□□□□ - □□□□

2006 2006

□□□ (2006)□□□□□□□□□□□□ - □□□□

Apr 13, 2025 · 11:11 (2006) 11:11:11

https://pan.baidu.com/s/1TyME8dhCntIEFP_8VDxjEQ?pwd=1234 (2006) ...

(2006)-...
(TPE:2006)- (2006)

(2006)_
May 25, 2025 · (2006) CCTV-10 ...

Silent Hill (2006)_
Apr 11, 2025 · Silent Hill (2006) Rose• ...

(2006) -
May 14, 2025 · (2006) 1

Cars (2006)_
Apr 15, 2025 · Cars (2006) “”
“”“”“” ...

Explore our comprehensive 2006 Honda Rancher 350 parts diagram to easily identify components and find the right parts for your ATV. Learn more today!

[Back to Home](#)